

Beautiful Ranch Style Home on 7.5+/- Acres OkTibbeha County, MS



\$499,900

Dream home for horse lovers! Completely redone! This custom home has everything, and it's all on one level! Beautiful chef's kitchen with upgraded appliances, wine cooler, gas stove with wall mount pot filler, granite island, soft close cabinets, open floor plan, oversized laundry room, full house water filtration system, two tankless water heaters with dual service panel, coffered ceilings, shiplap, built in office or study space, four stall horse barn with tack room and hot/cold water, two fenced in areas for horses with self -watering system. Tree house for adventures.

Directions from Starkville: Travel west on HWY 12, then travel 4 miles past the HWY 25 intersection and house will be on the right. Driveway is at the end of the fence. No sign on property.



Call me today!

KIM MARTINEZ, REALTOR®
Kim@TomSmithHomes.com
662.268.6333 **office** | 662.435.4046 **cell**



TomSmithLandandHomes.com

Information is believed to be accurate but not guaranteed.

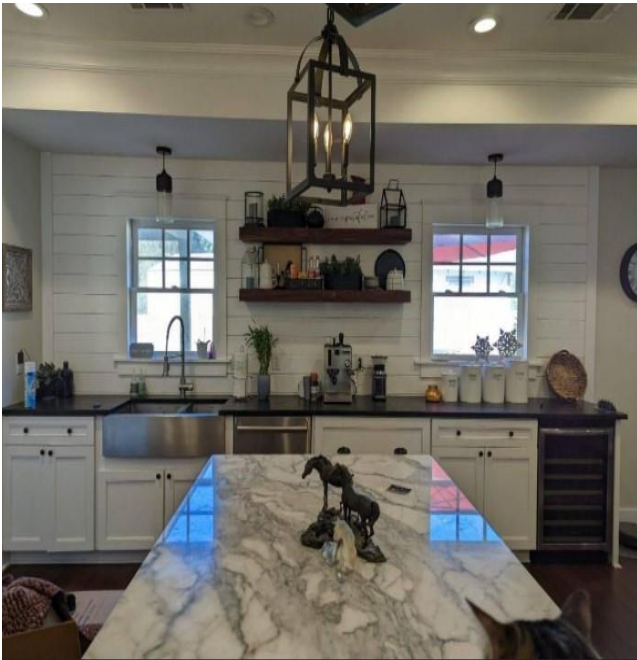

Call me today!

KIM MARTINEZ, REALTOR®

Kim@TomSmithHomes.com

662.268.6333 office | 662.435.4046 cell



Expect More. Get More.

TomSmithLandandHomes.com

Information is believed to be accurate but not guaranteed.





Call me today!

KIM MARTINEZ, REALTOR®
Kim@TomSmithHomes.com

662.268.6333 office | 662.435.4046 cell



Expect More. Get More.



TomSmithLandandHomes.com

Information is believed to be accurate but not guaranteed.



Call me today!

KIM MARTINEZ, REALTOR®

Kim@TomSmithHomes.com

662.268.6333 office | 662.435.4046 cell



Expect More. Get More.

TomSmithLandandHomes.com

Information is believed to be accurate but not guaranteed.



Aerial Map



7.5+/- Acres

12

33.4124, -88.9064



Call me today!

KIM MARTINEZ, REALTOR®

Kim@TomSmithHomes.com

662.268.6333 office | 662.435.4046 cell



Expect More. Get More.

TomSmithLandandHomes.com

Information is believed to be accurate but not guaranteed.



Ownership Map

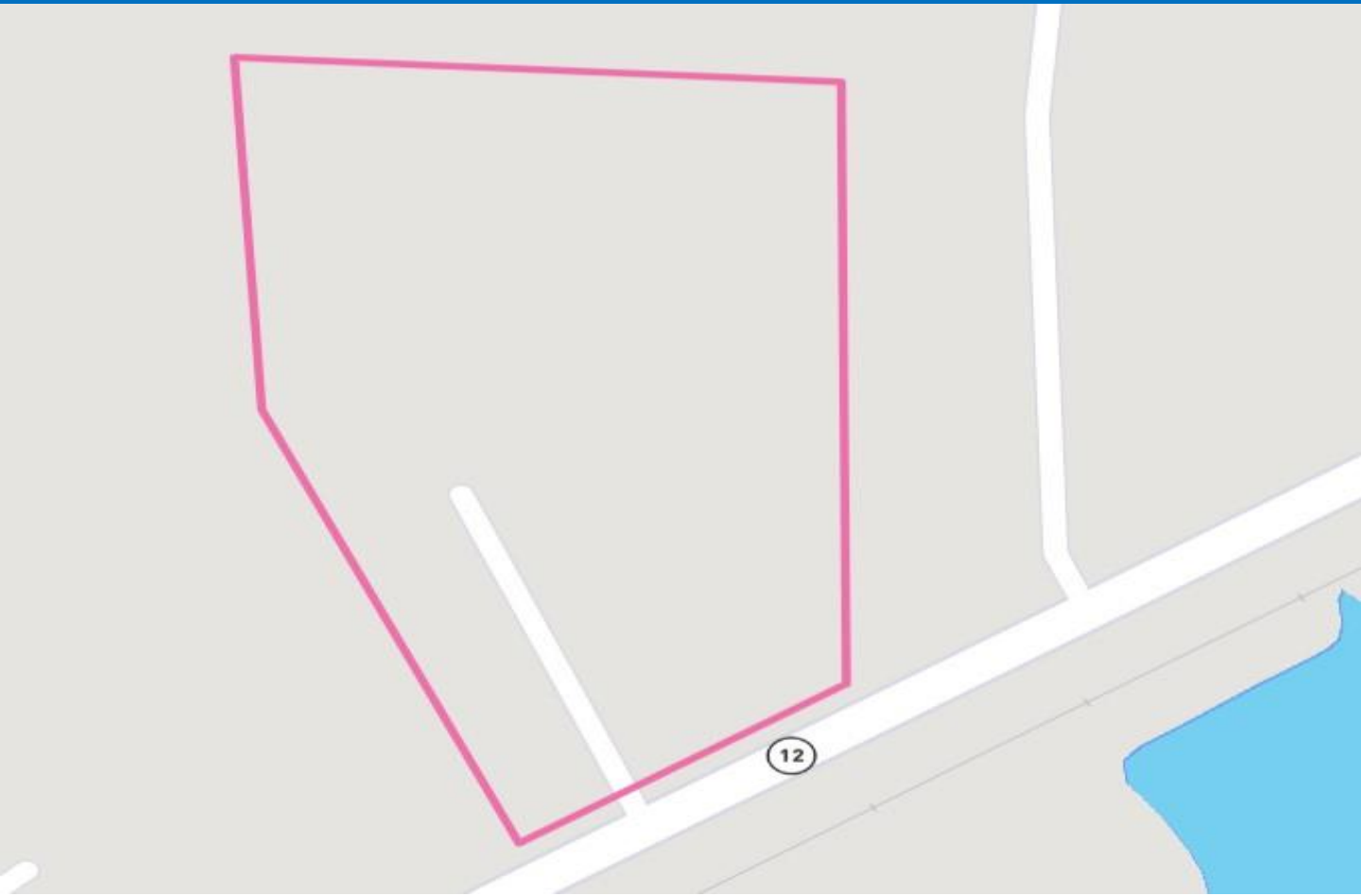

Call me today!

KIM MARTINEZ, REALTOR®

Kim@TomSmithHomes.com

662.268.6333 office | 662.435.4046 cell



Expect More. Get More.

TomSmithLandandHomes.com

Information is believed to be accurate but not guaranteed.



Directional Map

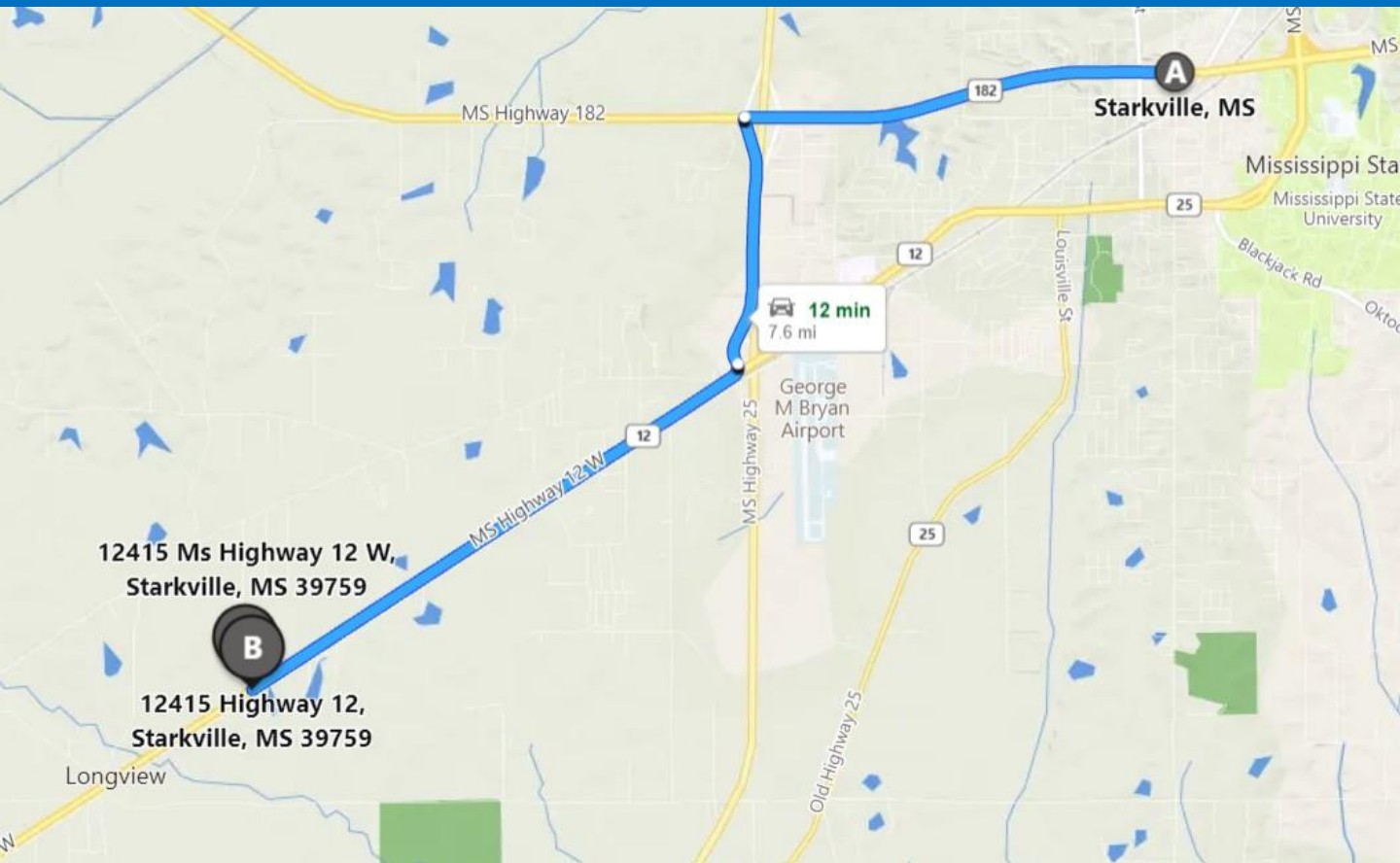

12415 Ms Highway 12 W,
Starkville, MS 39759

12415 Highway 12,
Starkville, MS 39759

Directions from Starkville: See front.



Call me today!

KIM MARTINEZ, REALTOR®

Kim@TomSmithHomes.com

662.268.6333 office | 662.435.4046 cell



Expect More. Get More.

TomSmithLandandHomes.com

Information is believed to be accurate but not guaranteed.