

Abundant Wildlife on 46 +/- Acres in Chickasaw County, MS



This 46 +/- acre tract in Chickasaw County features abundant wildlife and beautiful views. This property has gravel road frontage with timber that is mostly hardwoods with some pine. With views overlooking the creek bottom, it would make a great place to set up camp or to build your dream home. Not far from the Natchez Trace, you will find this property is in the perfect location! Don't miss this deal, call Tom today!!

Directions: From Houston, MS travel 6 miles north on Hwy 15 to CR 115. Turn east on CR 115 and drive 1.5 miles to CR 118. Continue east on CR 118 4.5 miles to property on left.

Address is County Road 118 Houlka, MS 38850



Call me today!

TOM WISEMAN, MANAGING BROKER
TWiseman@TomSmithLand.com
662.317.0467



TomSmithLandandHomes.com

Information is believed to be accurate but not guaranteed.



TOM WISEMAN, MANAGING BROKER
TWiseman@TomSmithLand.com
662.317.0467



TomSmithLandandHomes.com

Information is believed to be accurate but not guaranteed.

AERIAL MAP



TOM WISEMAN, MANAGING BROKER
TWiseman@TomSmithLand.com
662.317.0467



TomSmithLandandHomes.com

Information is believed to be accurate but not guaranteed.

TOPO MAP



TOM WISEMAN, MANAGING BROKER
TWiseman@TomSmithLand.com
662.317.0467



TomSmithLandandHomes.com

Information is believed to be accurate but not guaranteed.

SOIL MAP



SOIL CODE	SOIL DESCRIPTION	ACRES	%	CAP
Le	Leeper silty clay loam	0.6	1.2%	3w
CaF	Cahaba fine sandy loam, 12 to 35 percent slopes (smithdale)	24.1	48.8%	7e
DkE3	Demopolis-Kipling complex, 8 to 25 percent slopes, severely eroded	20.5	41.6%	7e
RuB	Ruston fine sandy loam, 2 to 5 percent slopes	4.1	8.4%	3e



TOM WISEMAN, MANAGING BROKER
 TWiseman@TomSmithLand.com
 662.317.0467



TomSmithLandandHomes.com

Information is believed to be accurate but not guaranteed.

DIRECTIONAL MAP

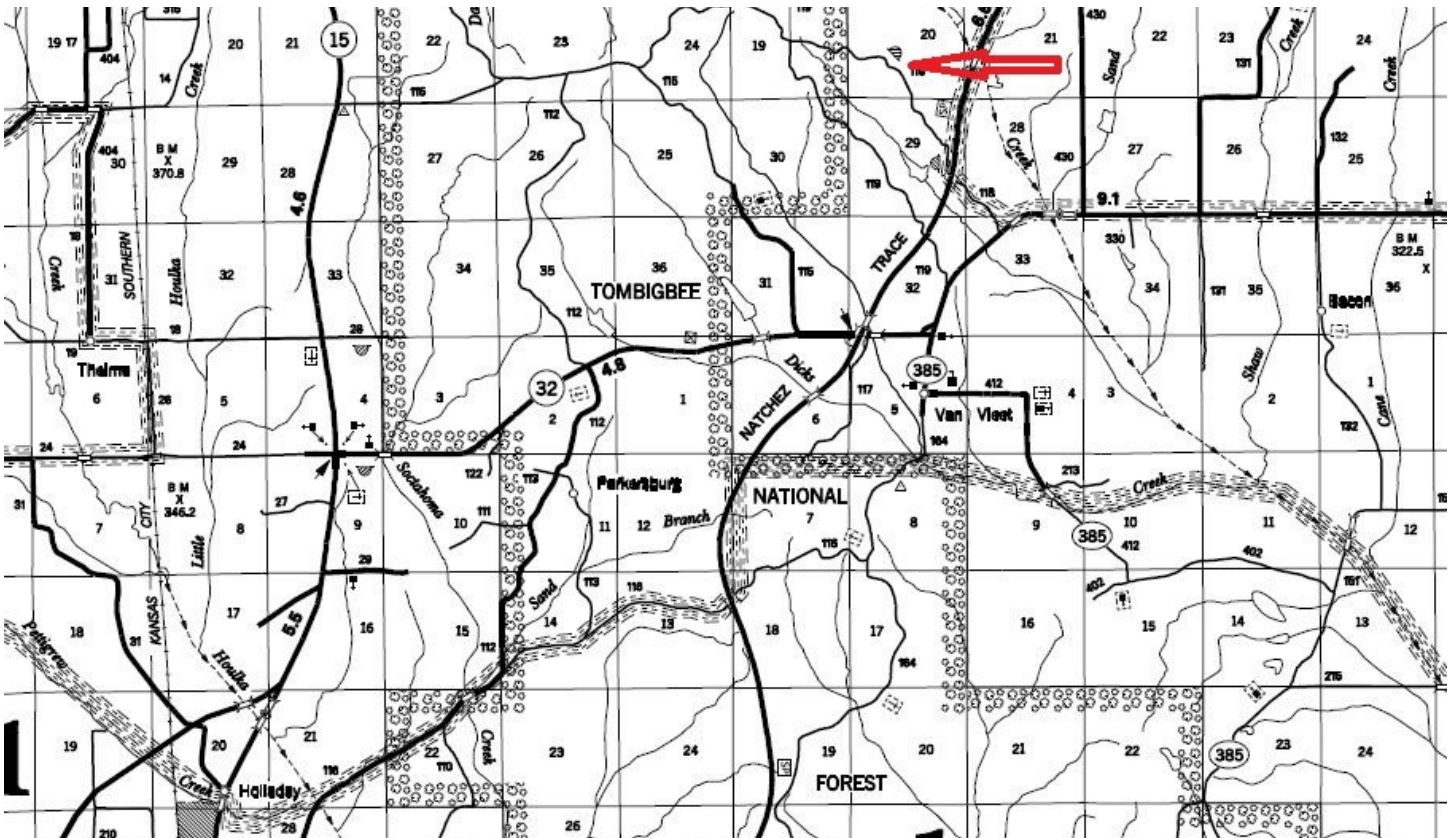

Directions: From Houston, MS travel 6 miles north on Hwy 15 to CR 115. Turn east on CR 115 and drive 1.5 miles to CR 118. Continue east on CR 118 4.5 miles to property on left.

Address is County Road 118 Houlika, MS 38850



TOM WISEMAN, MANAGING BROKER
TWiseman@TomSmithLand.com
662.317.0467



TomSmithLandandHomes.com

Information is believed to be accurate but not guaranteed.