

# 1+/- Acre Home Site in Covered Bridge Cove Subdivision Pearl River County, MS



Have you been dreaming of building your home in a private lake community? This 1 +/- acre lot in Covered Bridge Cove Subdivision in Pearl River County, MS, may be just what you are looking for. This private neighborhood in Carriere is accessed by one of the only covered bridges in Mississippi. Upon entering the community, you will travel through the covered bridge, which crosses a running stream. This lot is located in Pearl River County School District on a quiet street and has lake views, great road frontage and a home site to build your dream home on a hill. It's less than ten miles from I59 which offers convenient access to New Orleans, the Gulf Coast, and Hattiesburg. Restrictions include a minimum of 1,600 square feet heated and cooled home and no mobile homes. This well-priced lot will go fast. Call Tara today to schedule a viewing!

Directions from exit 10 on I-59 S in Carriere, MS: Take the exit and stay right onto W Union Road. Travel 2.3 miles and turn left onto Anchor Lake Road. Travel 279 feet and turn right onto Old Hwy 11 N. Travel 0.3 miles and turn left onto Picayune Street. Travel 272 feet and continue onto George Ford Road. Travel 3.5 miles and turn right onto Rock Ranch Road. Travel 1.3 miles and turn left onto Covered Bridge Road. Travel 0.2 miles and continue straight on Covered Bridge Road. The property will be on your right in approximately 100 feet.



*Call me today!*

**TARA WALKER SMITH, REALTOR®**  
Tara@TomSmithHomes.com  
601.990.5070 **office** | 601.407.4315 **cell**



**TomSmithLandandHomes.com**

Information is believed to be accurate but not guaranteed.



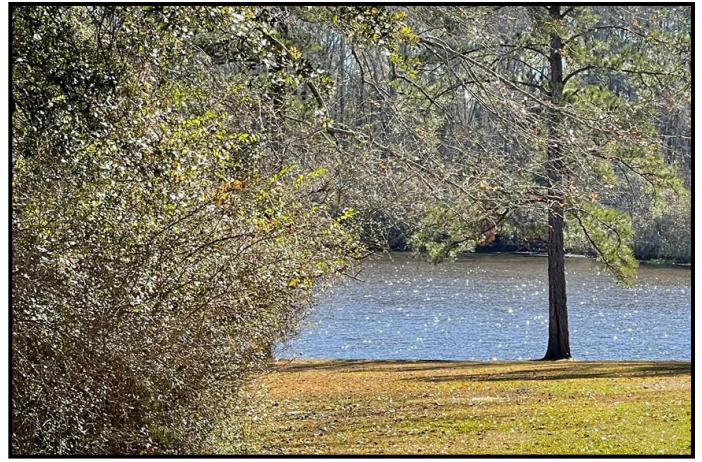
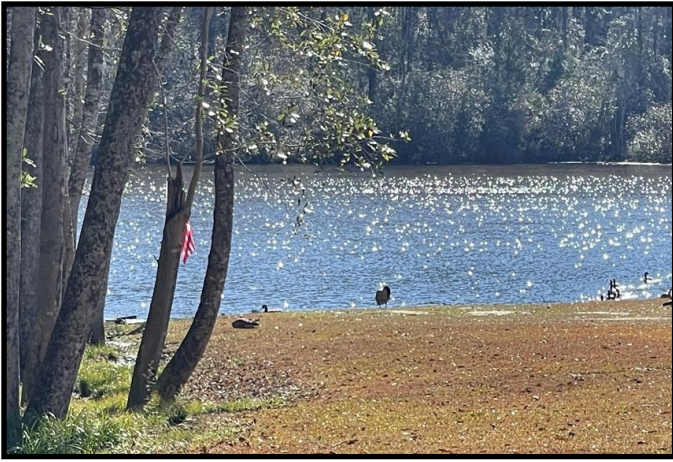

LandReport  
2011-2021  
FRANCHISE  
**BEST**  
BROKERAGES

*Call me today!*

**TARA WALKER SMITH, REALTOR®**  
Tara@TomSmithHomes.com  
601.990.5070 office | 601.407.4315 cell



Expect More. Get More.

**TomSmithLandandHomes.com**

Information is believed to be accurate but not guaranteed.



# Aerial Map



## INTERACTIVE MAP



*Call me today!*

**TARA WALKER SMITH, REALTOR®**  
Tara@TomSmithHomes.com  
601.990.5070 office | 601.407.4315 cell



**TomSmithLandandHomes.com**

Information is believed to be accurate but not guaranteed.

# Ownership Map

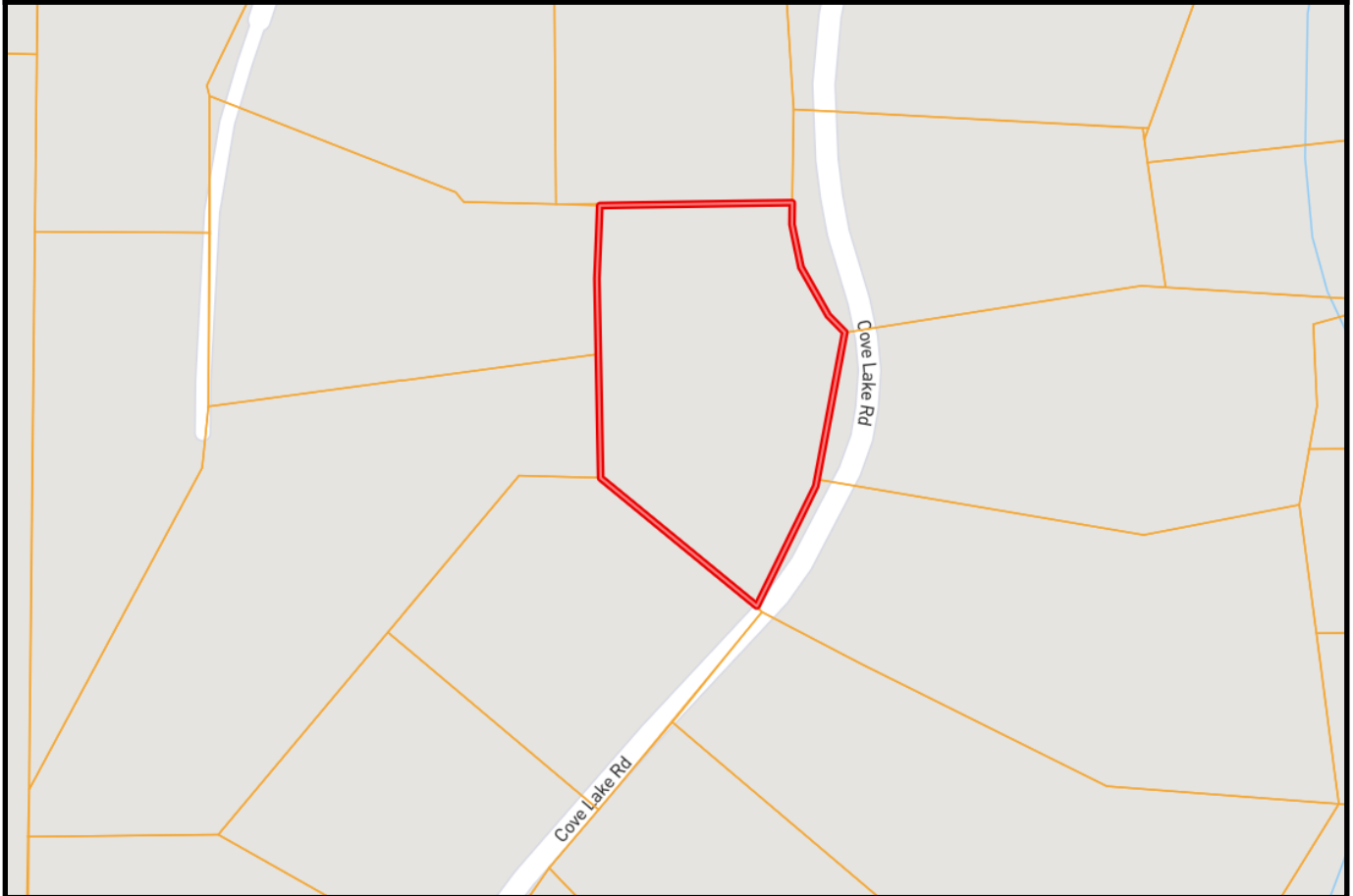

2011-2021  
NATIONAL  
**BEST**  
BROKERAGES

*Call me today!*

**TARA WALKER SMITH, REALTOR®**  
Tara@TomSmithHomes.com  
601.990.5070 **office** | 601.407.4315 **cell**



Expect More. Get More.

**TomSmithLandandHomes.com**

Information is believed to be accurate but not guaranteed.

# Directional Map

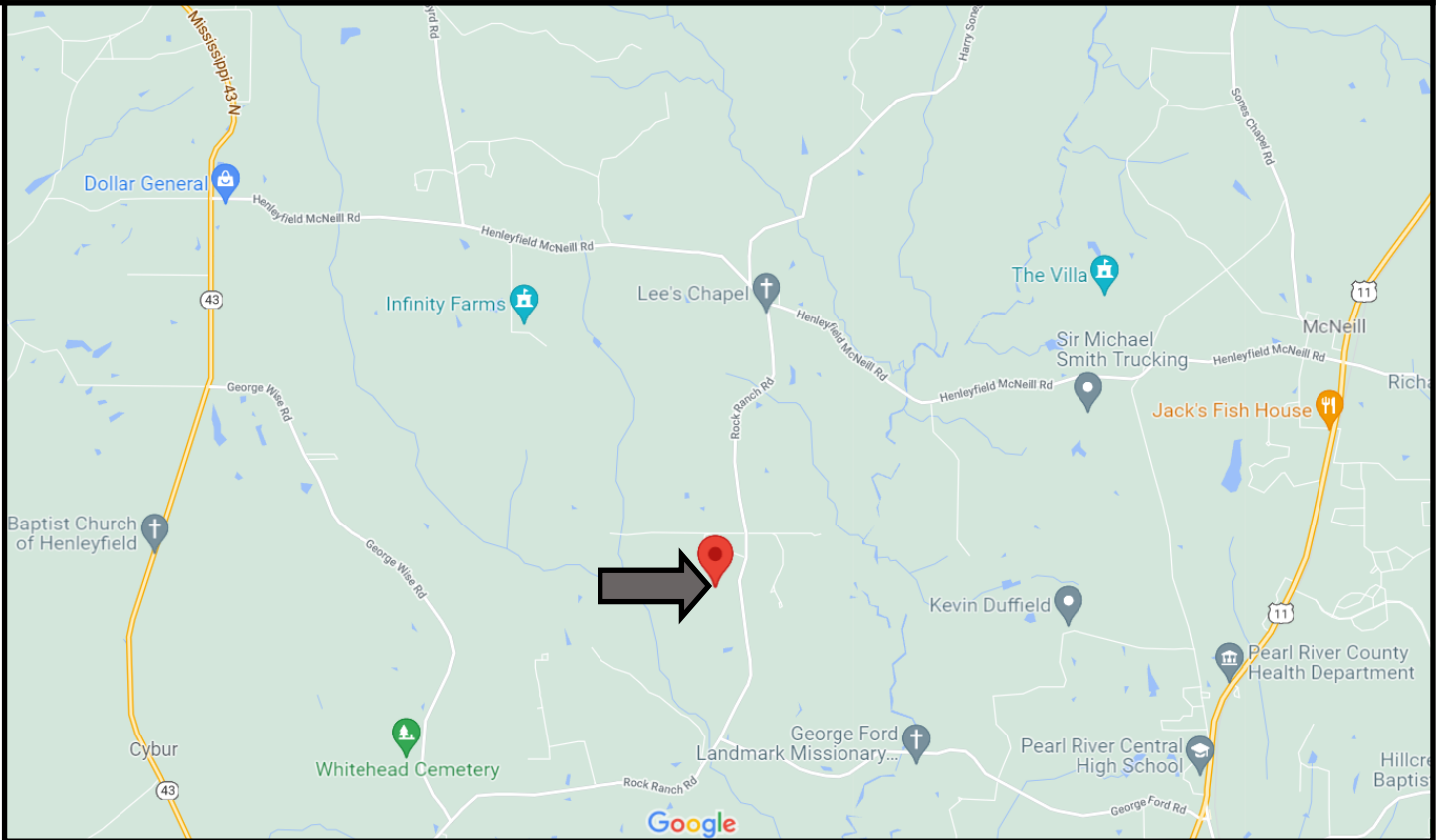

Directions from exit 10 on I-59 S in Carriere, MS: Take the exit and stay right onto W Union Road. Travel 2.3 miles and turn left onto Anchor Lake Road. Travel 279 feet and turn right onto Old Hwy 11 N. Travel 0.3 miles and turn left onto Picayune Street. Travel 272 feet and continue onto George Ford Road. Travel 3.5 miles and turn right onto Rock Ranch Road. Travel 1.3 miles and turn left onto Covered Bridge Road. Travel 0.2 miles and continue straight on Covered Bridge Road. The property will be on your right in approximately 100 feet.



*Call me today!*

**TARA WALKER SMITH, REALTOR®**  
Tara@TomSmithHomes.com  
601.990.5070 office | 601.407.4315 cell



**TomSmithLandandHomes.com**

Information is believed to be accurate but not guaranteed.