

Humphries Cove Lot 255

CLAY COUNTY, MS



River Life is calling! This 0.75+/- acre lot in Humphries Cove is the perfect place to build a river house! This lot is situated near the Clay County line, only 16 minutes from West Point, MS and 20 minutes from downtown Columbus. So whether you are looking for a weekend homesite close to the river or a permanent home on an affordably priced lot, look no further! Enjoy the Tombigbee River with two boat ramps, one within walking distance. HOA fees, covenants, and sqft restrictions apply. With too many features to name, you have to come see it for yourself!

Directions from the intersection of MS-50 & HWY 45 ALT in Clay county, MS: Travel east on MS-50 for 9.6 miles. Turn right on Pate Rd and travel 0.3 miles. Turn left on Humphries Cove Rd and travel 0.7 miles. Turn right on Nelda Dr and travel .1 miles; the property will be on the right.



call me today!

JOHN DEL PAPA, REALTOR®

John@TomSmithHomes.com

662.268.6333 office | 662.788.2455 cell



Expect More. Get More.

TomSmithLandandHomes.com

Information is believed to be accurate but not guaranteed.



call me today!

JOHN DEL PAPA, REALTOR®
John@TomSmithHomes.com
662.268.6333 **office** | 662.788.2455 **cell**



TomSmithLandandHomes.com

Information is believed to be accurate but not guaranteed.

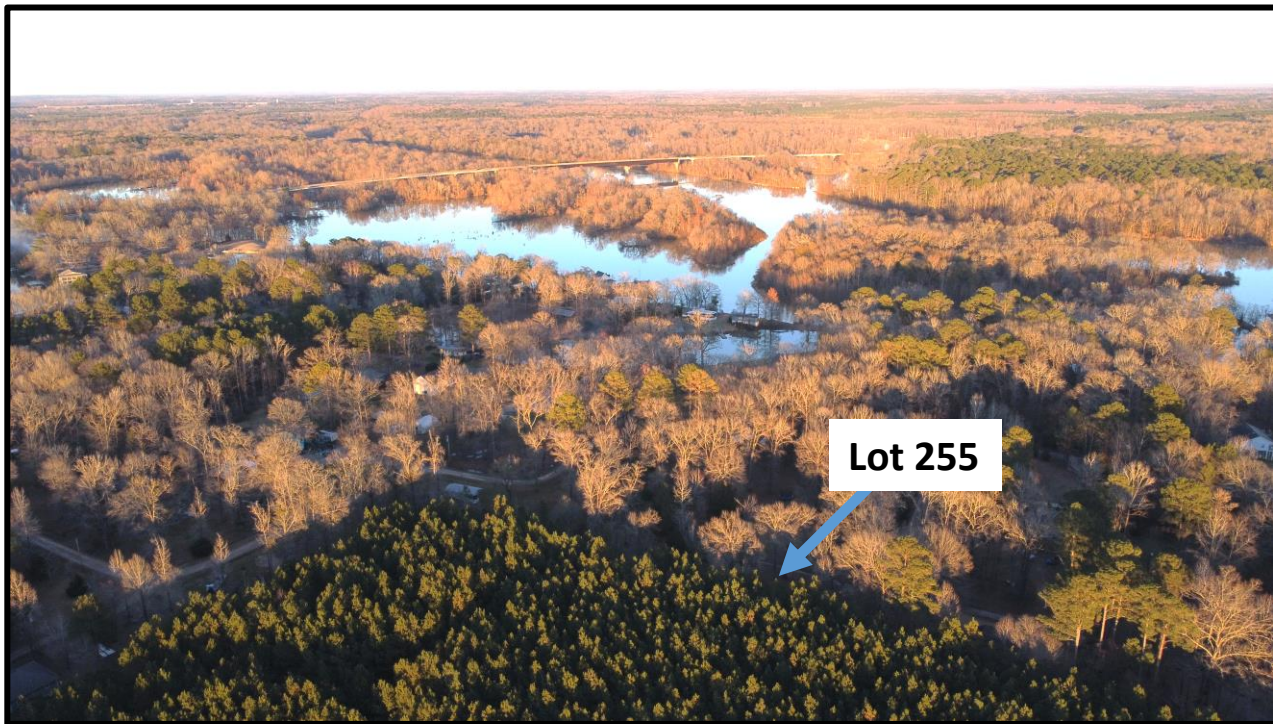

call me today!

JOHN DEL PAPA, REALTOR®

John@TomSmithHomes.com

662.268.6333 office | 662.788.2455 cell



Expect More. Get More.

TomSmithLandandHomes.com

Information is believed to be accurate but not guaranteed.



call me today!

JOHN DEL PAPA, REALTOR®
John@TomSmithHomes.com
662.268.6333 office | 662.788.2455 cell



TomSmithLandandHomes.com

Information is believed to be accurate but not guaranteed.

Ownership Map

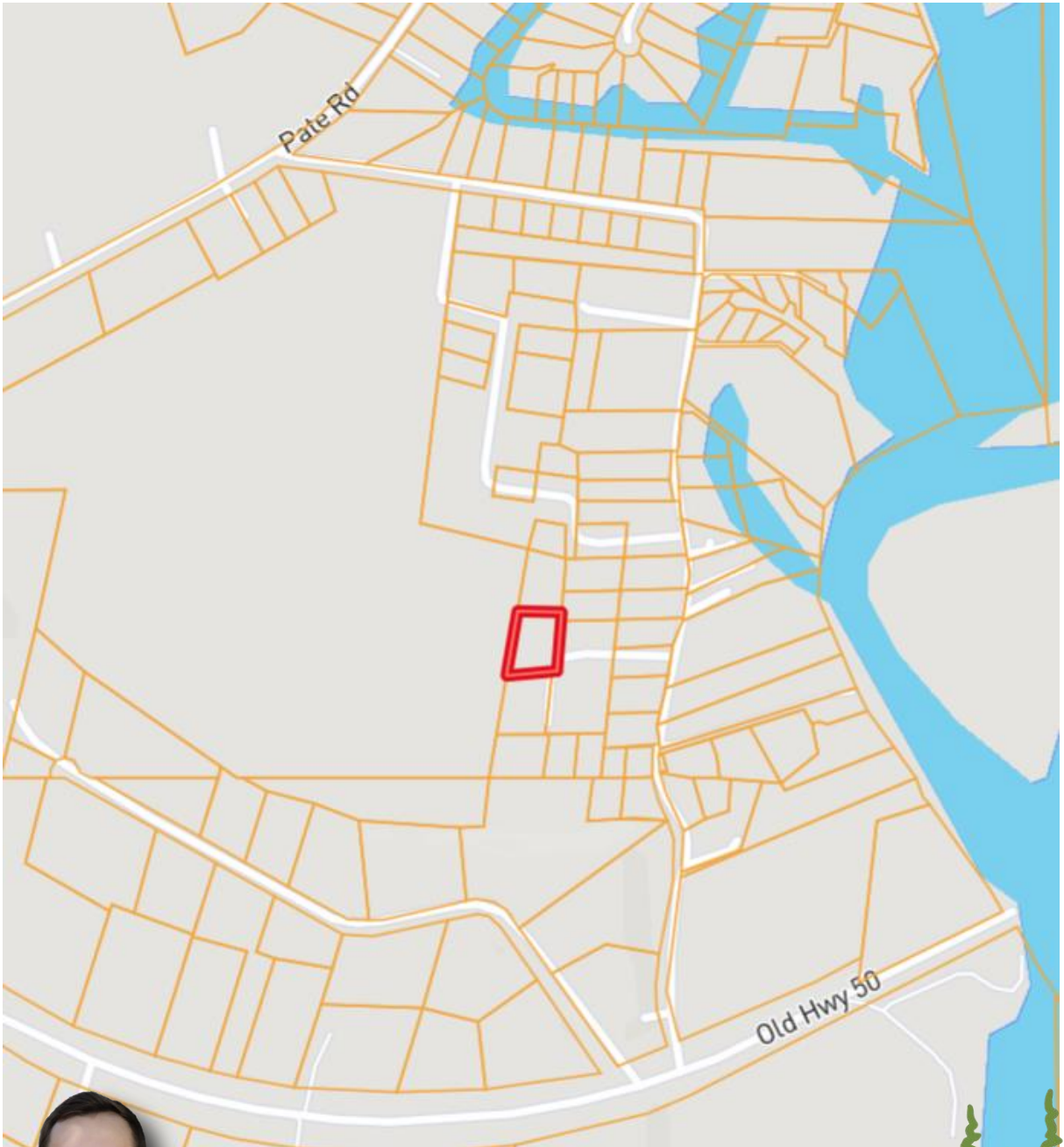

call me today!

JOHN DEL PAPA, REALTOR®

John@TomSmithHomes.com

662.268.6333 office | 662.788.2455 cell



Expect More. Get More.

TomSmithLandandHomes.com

Information is believed to be accurate but not guaranteed.

Aerial Map



call me today!

JOHN DEL PAPA, REALTOR®

John@TomSmithHomes.com

662.268.6333 office | 662.788.2455 cell



Expect More. Get More.

TomSmithLandandHomes.com

Information is believed to be accurate but not guaranteed.

Directional Map

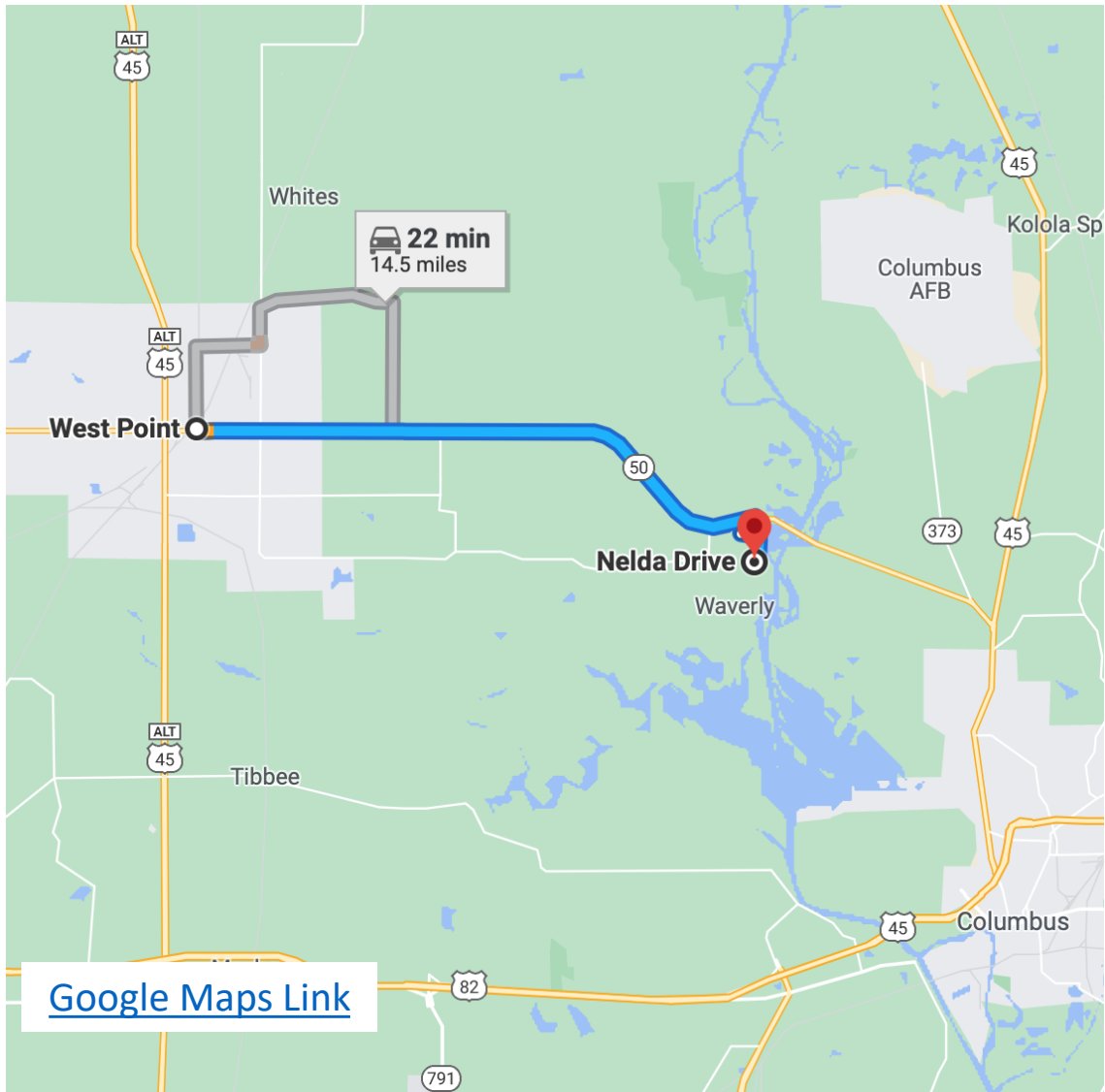

[Google Maps Link](#)

Directions from the intersection of MS-50 & HWY 45 ALT in Clay county, MS: Travel east on MS-50 for 9.6 miles. Turn right on Pate Rd and travel 0.3 miles. Turn left on Humphries Cove Rd and travel 0.7 miles. Turn right on Nelda Dr and travel .1 miles; the property will be on the right.



call me today!

JOHN DEL PAPA, REALTOR®

John@TomSmithHomes.com

662.268.6333 office | 662.788.2455 cell



Expect More. Get More.

TomSmithLandandHomes.com

Information is believed to be accurate but not guaranteed.