

3 Bedroom / 2 Bath Home in Hinds County, MS



750 Woody Drive
Jackson, MS 39212

\$100,000

Check out this fantastic opportunity in Hinds County, MS. This fabulous three-bedroom, three bath home on a half acre in Jackson, MS, is an opportunity to own one of the largest homes on Woody Drive. This 2800+/- square foot home is a blank slate for your renovation. The home features a spacious kitchen, large dining and living rooms, fireplace, three car garage, and each bedroom has its own bathroom. There is work to be done, but the opportunities are endless. Whether you are an investor or are looking for your forever home, you need to see this property! Call Clif Cannon to schedule a showing today.

Directions from the intersection of Interstate 55 and East McDowell Road in Jackson, MS: Travel west on East McDowell road for .4 miles. Turn left onto Terry Road and travel for .8 miles. Turn right onto Woody Drive and travel for 1.2 miles. The property will be on the right.

Address: 750 Woody Drive, Jackson, MS 39212



call me today!

CLIF CANNON, REALTOR®
Clif@TomSmithLand.com
601.990.5070 office | 601.565.1070 cell



TomSmithLandandHomes.com

Information is believed to be accurate but not guaranteed.



CLIF CANNON, REALTOR®

Clif@TomSmithLand.com

601.990.5070 office | 601.565.1070 cell



TomSmithLandandHomes.com

Information is believed to be accurate but not guaranteed.



CLIF CANNON, REALTOR®

Clif@TomSmithLand.com

601.990.5070 office | 601.565.1070 cell



Expect More. Get More.

TomSmithLandandHomes.com

Information is believed to be accurate but not guaranteed.



.6+/- Acres

← 32.2577, -90.2421

WOODY DR

Aerial Map

CLIF CANNON, REALTOR®

Clif@TomSmithLand.com

601.990.5070 office | 601.565.1070 cell



Expect More. Get More.



TomSmithLandandHomes.com

Information is believed to be accurate but not guaranteed.

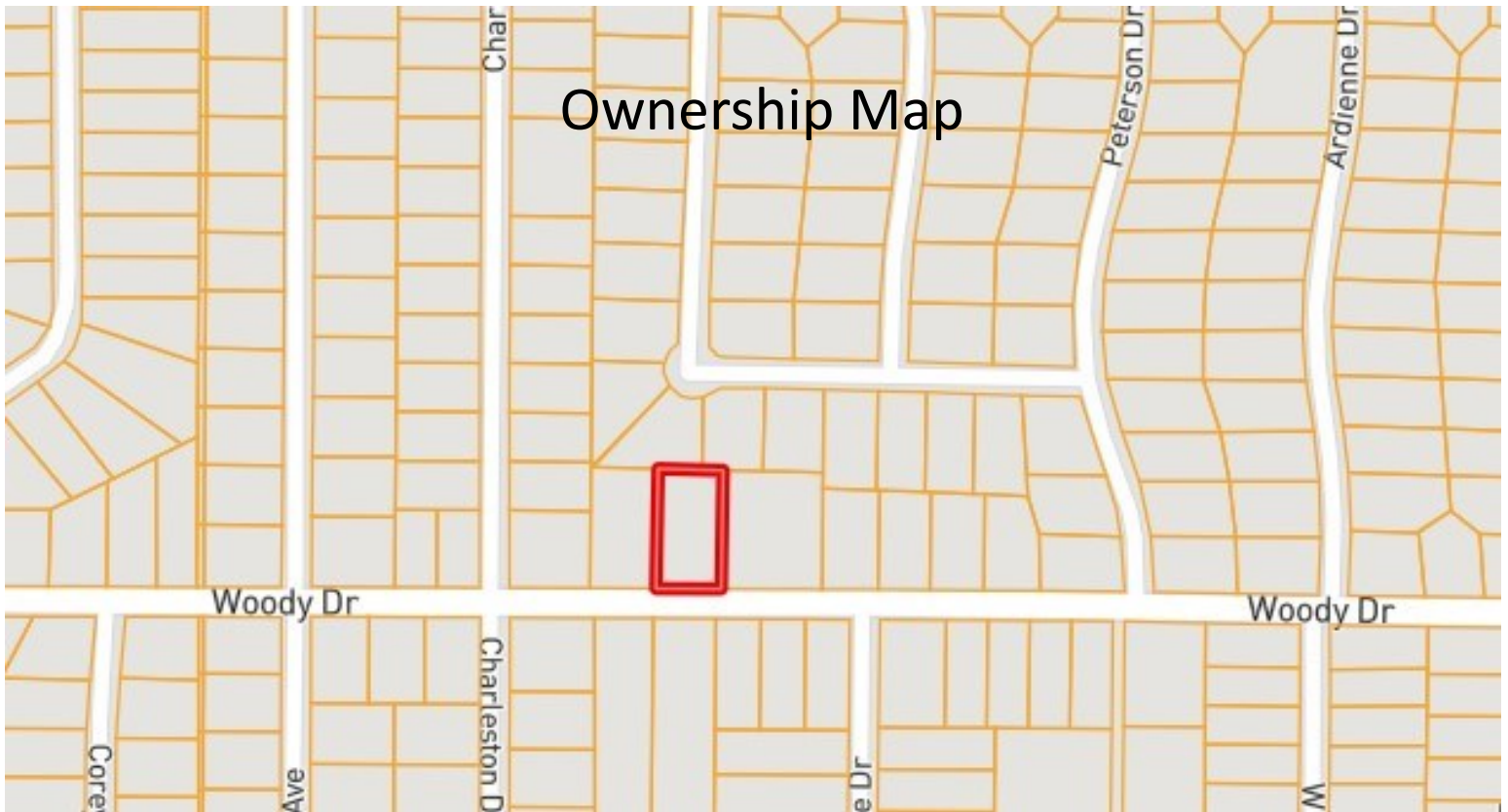

Ownership Map



Flood Map



CLIF CANNON, REALTOR®
Clif@TomSmithLand.com
601.990.5070 office | 601.565.1070 cell



TomSmithLandandHomes.com

Information is believed to be accurate but not guaranteed.

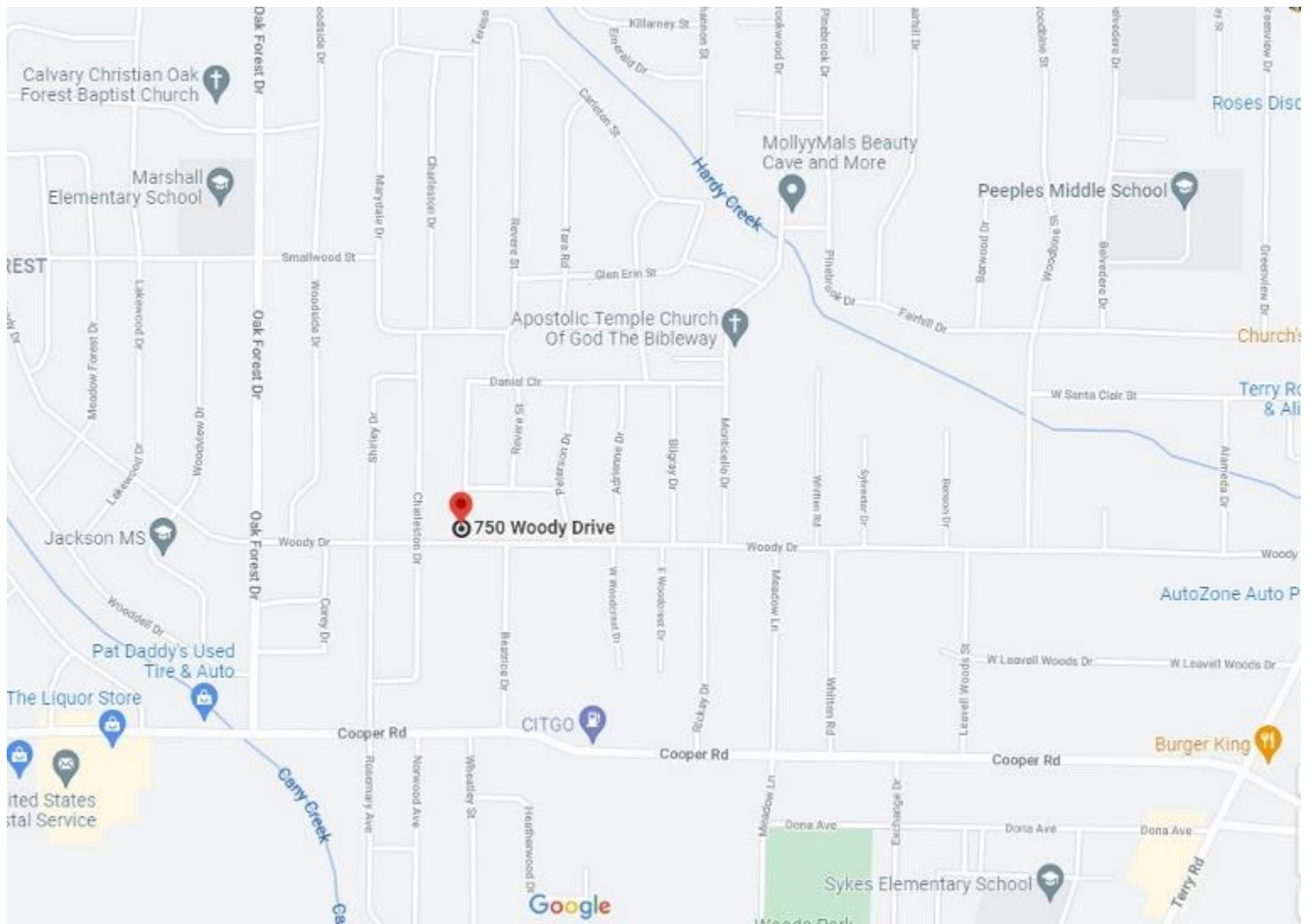

Directional Map

Directions from the intersection of Interstate 55 and East McDowell Road in Jackson, MS: Travel west on East McDowell road for .4 miles. Turn left onto Terry Road and travel for .8 miles. Turn right onto Woody Drive and travel for 1.2 miles. The property will be on the right.

Address: 750 Woody Drive, Jackson, MS 39212



CLIF CANNON, REALTOR®
Clif@TomSmithLand.com
601.990.5070 office | 601.565.1070 cell



TomSmithLandandHomes.com

Information is believed to be accurate but not guaranteed.