

32+/- Acres of Pastureland in Lawrence County, MS



000 Smith Ferry Road
Sontag, MS 39665

\$112,000

If you are looking for pastureland, then look no further than this 32+/- acres parcel in the Sontag community of Lawrence County, MS. Featuring over 1,500+/- feet of road frontage on Smith Ferry Road, this excellent tract is divided into three pastures and has two stock tanks on it. The thick grass will provide plenty of forage for livestock. The old barn is still serviceable and will keep the hay dry and the equipment safe. Utilities are available and this property would make a great homesite. Call Clif Cannon to Schedule a showing today!

Directions from the intersection of MS-27 and US-84 in Monticello, MS: Travel north on MS-27 for 5.2 miles. Turn right onto Smith Ferry Road and travel for 1.6 miles. The property will be on the left.



call me today!

CLIF CANNON, REALTOR®
Clif@TomSmithLand.com
601.990.5070 office | 601.565.1070 cell



TomSmithLandandHomes.com

Information is believed to be accurate but not guaranteed.



CLIF CANNON, REALTOR®
 Clif@TomSmithLand.com
 601.990.5070 office | 601.565.1070 cell



TomSmithLandandHomes.com

Information is believed to be accurate but not guaranteed.



32+/- Acres

Aerial Map



CLIF CANNON, REALTOR®
Clif@TomSmithLand.com
601.990.5070 office | 601.565.1070 cell



TomSmithLandandHomes.com

Information is believed to be accurate but not guaranteed.

Topographic Map

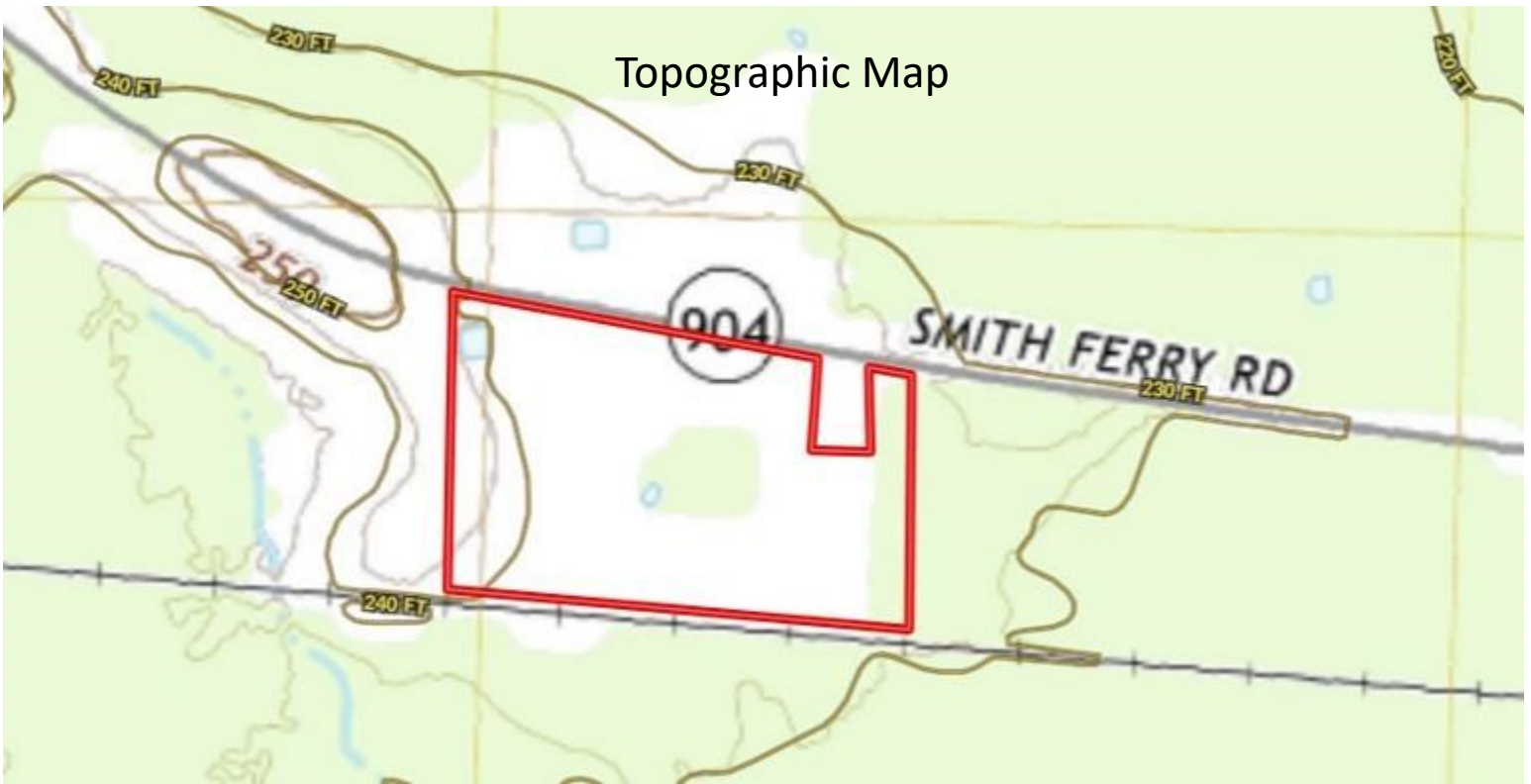

Flood Map



CLIF CANNON, REALTOR®

Clif@TomSmithLand.com

601.990.5070 office | 601.565.1070 cell



Expect More. Get More.



TomSmithLandandHomes.com

Information is believed to be accurate but not guaranteed.

Ownership Map



CLIF CANNON, REALTOR®

Clif@TomSmithLand.com

601.990.5070 office | 601.565.1070 cell



Expect More. Get More.



TomSmithLandandHomes.com

Information is believed to be accurate but not guaranteed.

Directional Map



Directions from the intersection of MS-27 and US-84 in Monticello, MS: Travel north on MS-27 for 5.2 miles. Turn right onto Smith Ferry Road and travel for 1.6 miles. The property will be on the left.



CLIF CANNON, REALTOR®
Clif@TomSmithLand.com
601.990.5070 office | 601.565.1070 cell



TomSmithLandandHomes.com

Information is believed to be accurate but not guaranteed.