

# .33± ACRE COMMERCIAL LOT IN HINDS COUNTY, MS



**\$51,500**

.33± acre commercial lot, zoned C-3, in South Jackson, MS, in Hinds County. This lot sits on McDowell Road, just minutes from I-55. This property would be excellent for a number of potential businesses. Located just south of the I-55/I-20 split, this property has quick access to interstates both north and south bound, and east and west bound. Come take a look and see what potential this lot has. Utilities are available nearby!

*Directions from Downtown Jackson, MS: Head west on E Pearl St toward S Lamar St, in .5 miles, use the left 2 lanes to turn slightly left at Dr Robert Smith Sr Pkwy, in 482ft at the traffic circle, take the 2nd exit onto University Blvd, in 1.1 miles, continue onto Terry Rd, in 1.5 miles, turn left onto E McDowell Rd, in 466ft the property will be on the right.*



*Call me today!*

**PRESTON SMITH**, MANAGING BROKER  
Preston@TomSmithLand.com  
601.990.5070 office | 601.209.7150 cell



**TomSmithLandandHomes.com**

Information is believed to be accurate but not guaranteed.



**PRESTON SMITH**, MANAGING BROKER  
 Preston@TomSmithLand.com  
 601.990.5070 office | 601.209.7150 cell



**TomSmithLandandHomes.com**

Information is believed to be accurate but not guaranteed.

# Aerial Map



**PRESTON SMITH**, MANAGING BROKER  
Preston@TomSmithLand.com  
601.990.5070 office | 601.209.7150 cell



**TomSmithLandandHomes.com**

Information is believed to be accurate but not guaranteed.

# Ownership Map

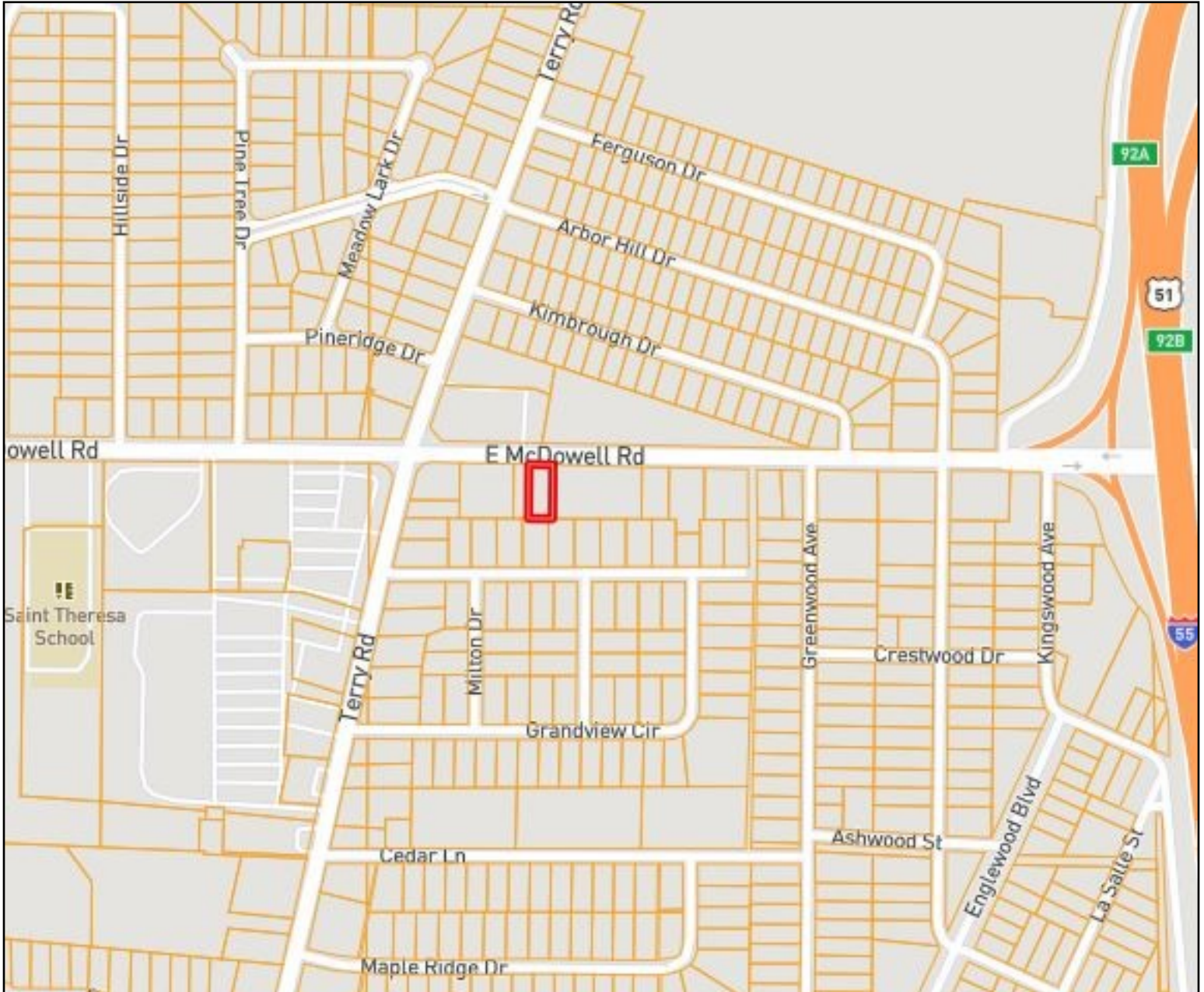

**PRESTON SMITH**, MANAGING BROKER  
Preston@TomSmithLand.com  
601.990.5070 office | 601.209.7150 cell



**TomSmithLandandHomes.com**

Information is believed to be accurate but not guaranteed.

# Directional Map

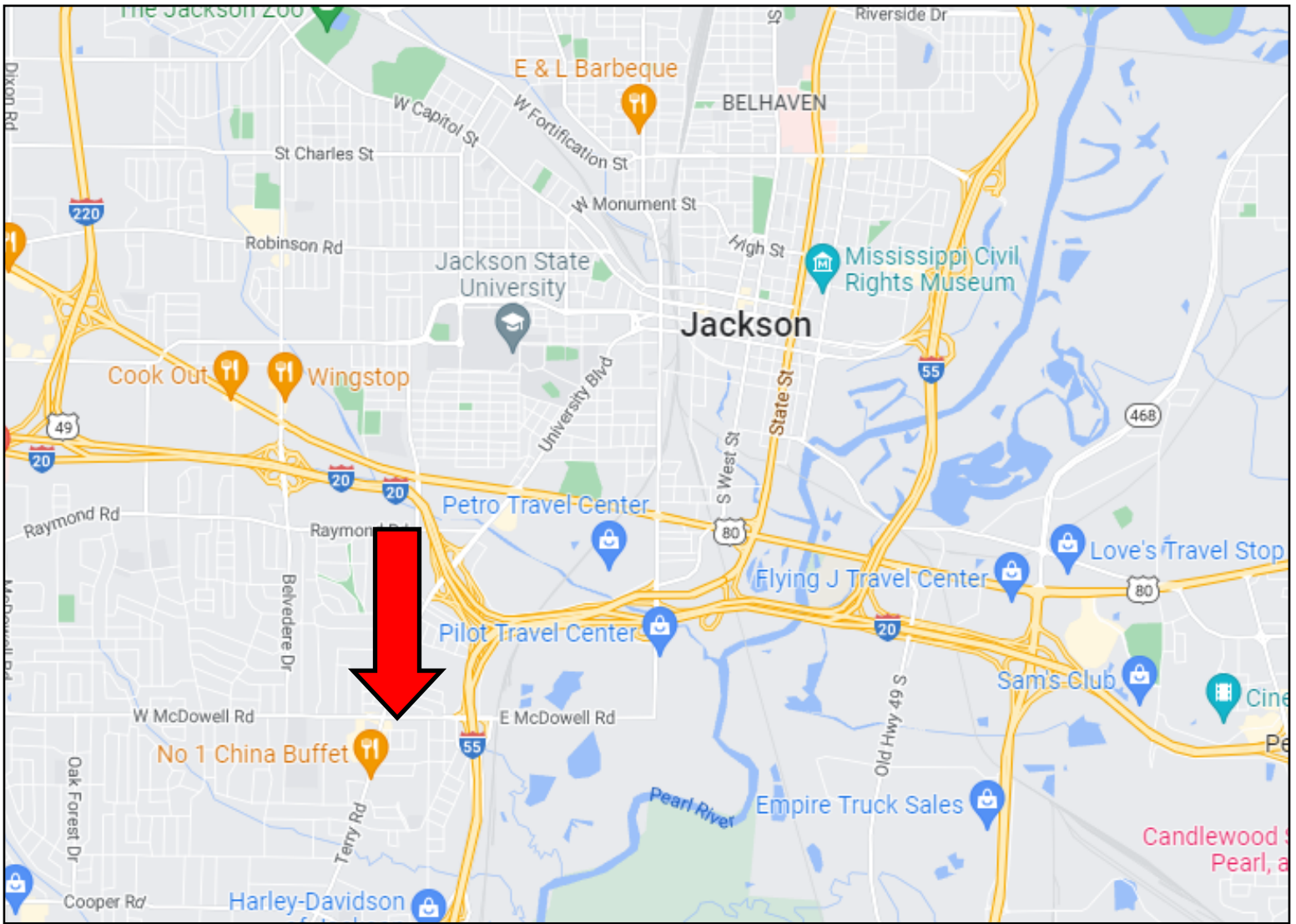

*Directions from Downtown Jackson, MS: Head west on E Pearl St toward S Lamar St, in .5 miles, use the left 2 lanes to turn slightly left at Dr Robert Smith Sr Pkwy, in 482ft at the traffic circle, take the 2nd exit onto University Blvd, in 1.1 miles, continue onto Terry Rd, in 1.5 miles, turn left onto E McDowell Rd, in 466ft the property will be on the right.*



**PRESTON SMITH**, MANAGING BROKER  
Preston@TomSmithLand.com  
601.990.5070 office | 601.209.7150 cell



**TomSmithLandandHomes.com**

Information is believed to be accurate but not guaranteed.