

34+/- Acre Homesite and Recreational Property Webster County, MS

3272 Grady Road
Eupora, Mississippi 39744

\$130,000



This 34+/- acre property is located 4 miles West of Eupora, Mississippi, in the Grady community. The property consists of 33 +/- acres of one year old cutover and a one-acre homesite. An older home on the property could be renovated into a rental property or camp house. No value is being placed on the home. This property also features paved road frontage on Grady Road. Utilities include Tomnolen Water Association and Natchez Trace EPA. The current owner will implement a few improvements, such as establishing a boundary trail and clearing the homesite. This property would be a great place to build that dream home and have plenty of extra room for recreational activities. For more information or to schedule a showing, call Harper Day today!

Directions from the intersection of Hwy 82 and Hwy 9 in Eupora, MS: Travel West on Hwy 82 for 3.1 miles. Turn slightly right onto Grady Road and travel 0.8 miles. The property will be on your left. Property address is 3272 Grady Road in Eupora, Mississippi.



call me today!

HARPER DAY, REALTOR®
Harper@TomSmithLand.com
662.268.6333 office | 662.694.9751 cell



Expect More. Get More.

TomSmithLandandHomes.com

Information is believed to be accurate but not guaranteed.



call me today!

HARPER DAY, REALTOR®
Harper@TomSmithLand.com
662.268.6333 office | 662.694.9751 cell



TomSmithLandandHomes.com

Information is believed to be accurate but not guaranteed.



2010-2021
ANNUAL
BEST
BROKERAGES

call me today!

HARPER DAY, REALTOR®
Harper@TomSmithLand.com
662.268.6333 office | 662.694.9751 cell



Expect More. Get More.

TomSmithLandandHomes.com

Information is believed to be accurate but not guaranteed.

Ownership Map

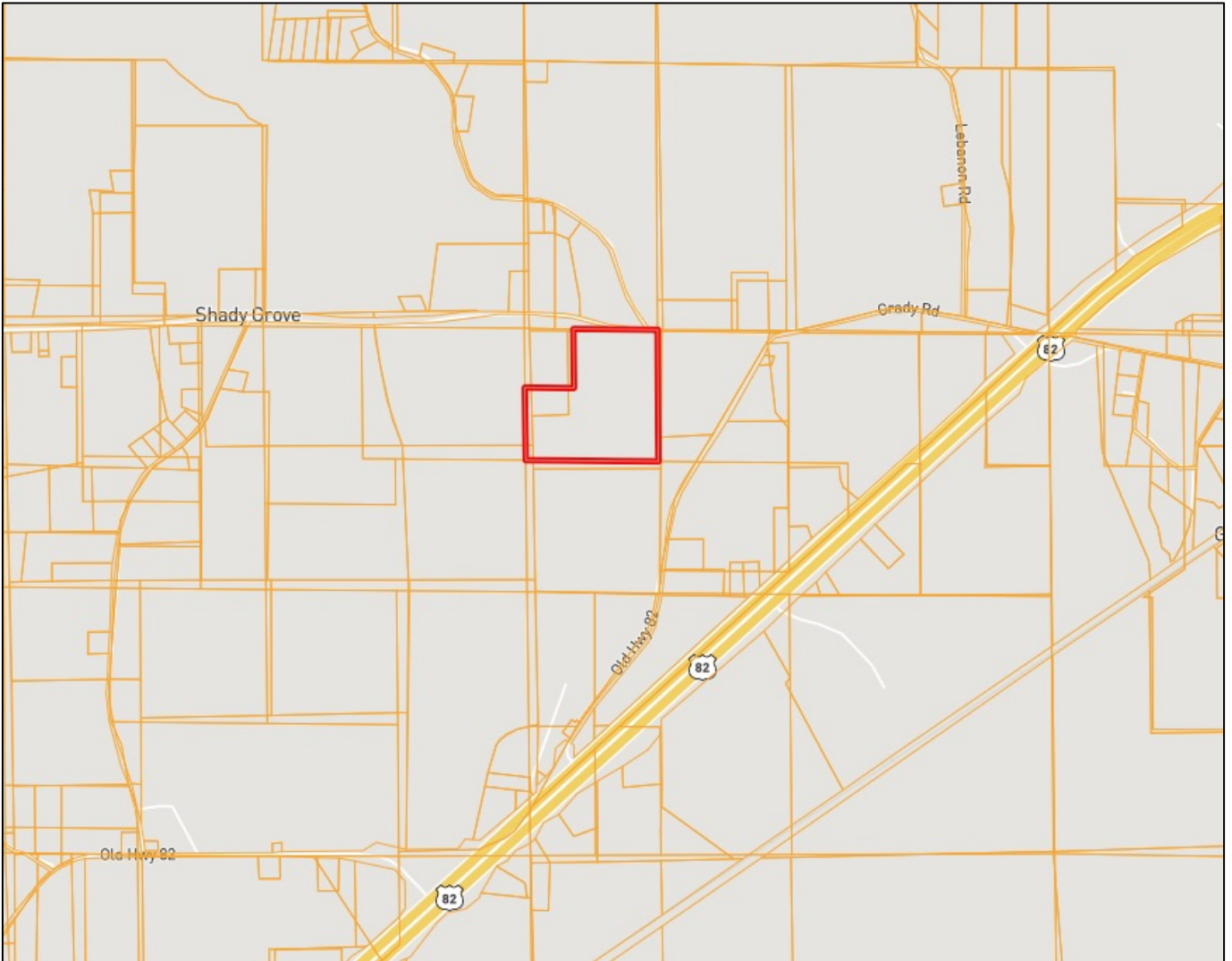

call me today!

HARPER DAY, REALTOR®
Harper@TomSmithLand.com
662.268.6333 office | 662.694.9751 cell



TomSmithLandandHomes.com

Information is believed to be accurate but not guaranteed.

Aerial Map



call me today!

HARPER DAY, REALTOR®
Harper@TomSmithLand.com
662.268.6333 office | 662.694.9751 cell



TomSmithLandandHomes.com

Information is believed to be accurate but not guaranteed.

Water Feature and Flood Map



call me today!

HARPER DAY, REALTOR®
Harper@TomSmithLand.com
662.268.6333 office | 662.694.9751 cell



TomSmithLandandHomes.com

Information is believed to be accurate but not guaranteed.

Topo Map

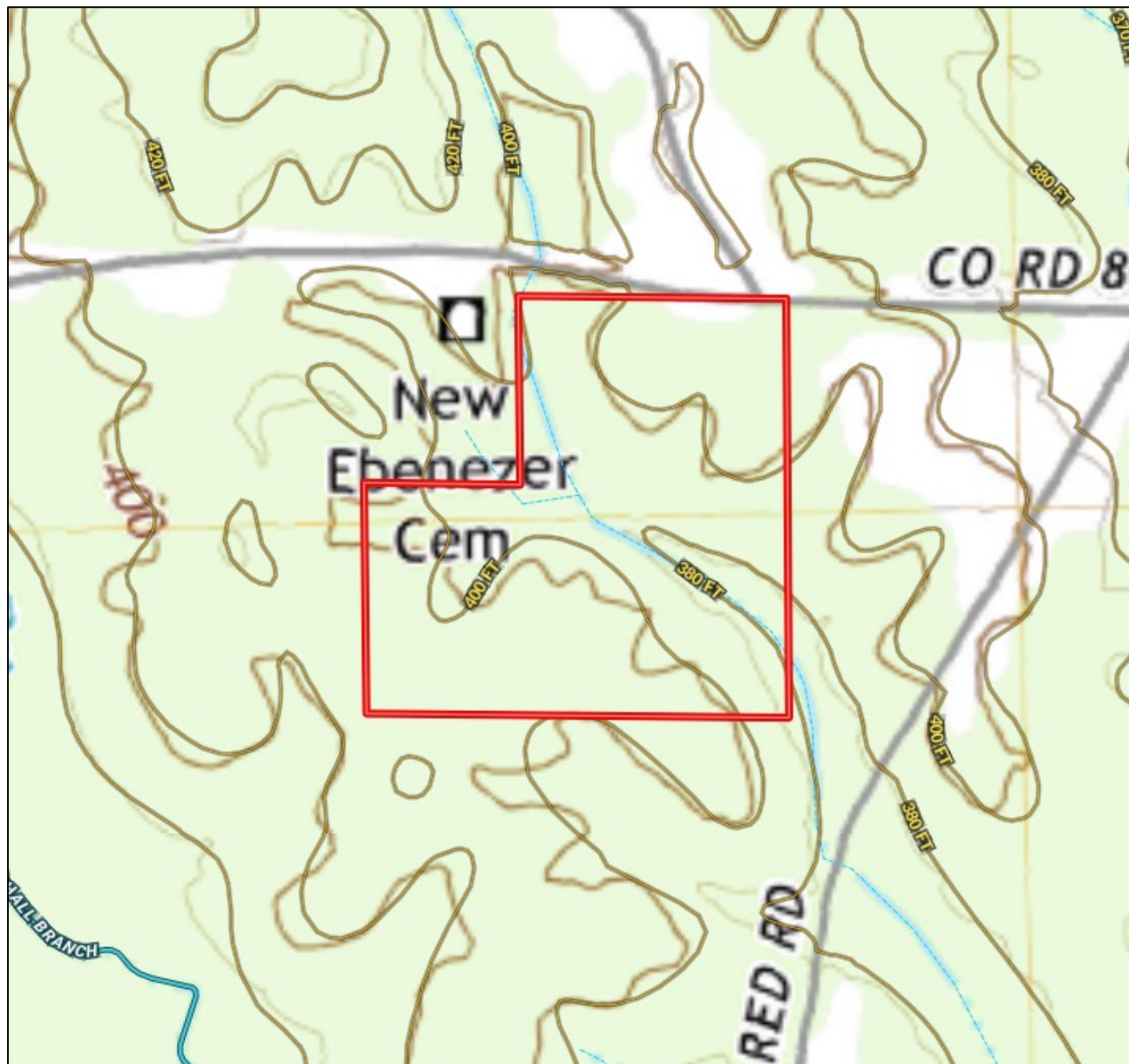

call me today!

HARPER DAY, REALTOR®
Harper@TomSmithLand.com
662.268.6333 office | 662.694.9751 cell



TomSmithLandandHomes.com

Information is believed to be accurate but not guaranteed.

Directional Map

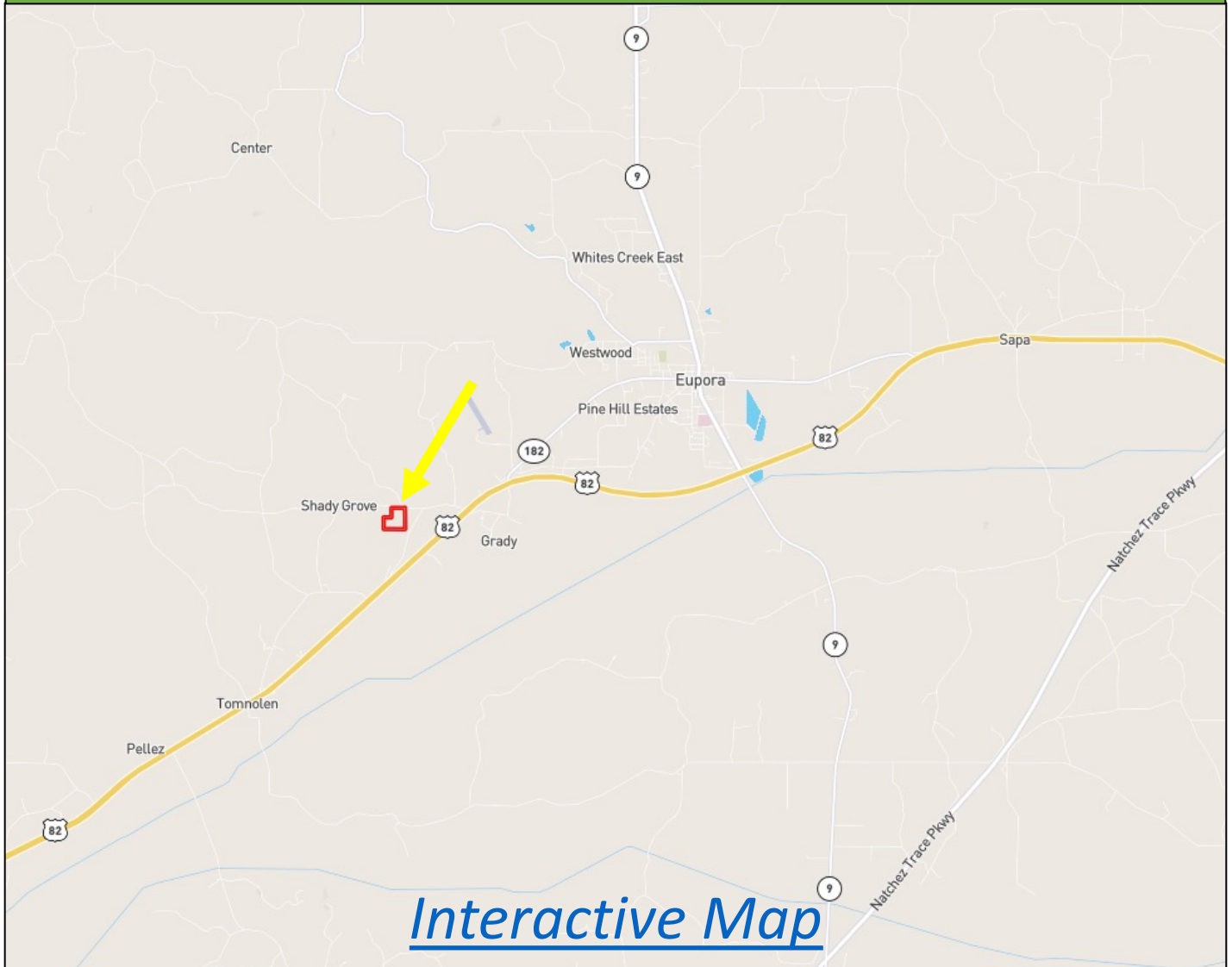

[Interactive Map](#)

Directions from the intersection of Hwy 82 and Hwy 9 in Eupora, MS:

Travel West on Hwy 82 for 3.1 miles. Turn slightly right onto Grady Road and travel 0.8 miles. The property will be on your left.

3272 Grady Road
Eupora, Mississippi 39744



call me today!

HARPER DAY, REALTOR®
Harper@TomSmithLand.com
662.268.6333 office | 662.694.9751 cell



TomSmithLandandHomes.com

Information is believed to be accurate but not guaranteed.