

Residential Lot in Cleveland

Bolivar County, MS



212 North Third Ave, Cleveland, MS

\$19,500

Are you looking for a lot in Bolivar County? Take a look at this residential lot in the middle of Cleveland, MS. The lot is approximately 75'W x 150'D. This lot is priced to sell and includes city water, city sewer, electrical and gas onsite. Located in Cleveland School District. Put in your offer today!

Directions from the intersection of Hwy 8 and Hwy 61 Cleveland, MS: Travel West on Hwy 8 for 0.9 miles, turn left onto N. 3rd Ave and in 0.1 miles the destination is on the left.



Call me today!

TRACEY BELL, MANAGING BROKER
Tracey@TomSmithLand.com
662.441.2500 **office** | 662.719.4720 **cell**



TomSmithLandandHomes.com

Information is believed to be accurate but not guaranteed.

AERIAL MAP



[Click for Interactive Map](#)

Call me today!

TRACEY BELL, MANAGING BROKER
Tracey@TomSmithLand.com
662.441.2500 **office** | 662.719.4720 **cell**



TomSmithLandandHomes.com

Information is believed to be accurate but not guaranteed.

OWNERSHIP MAP

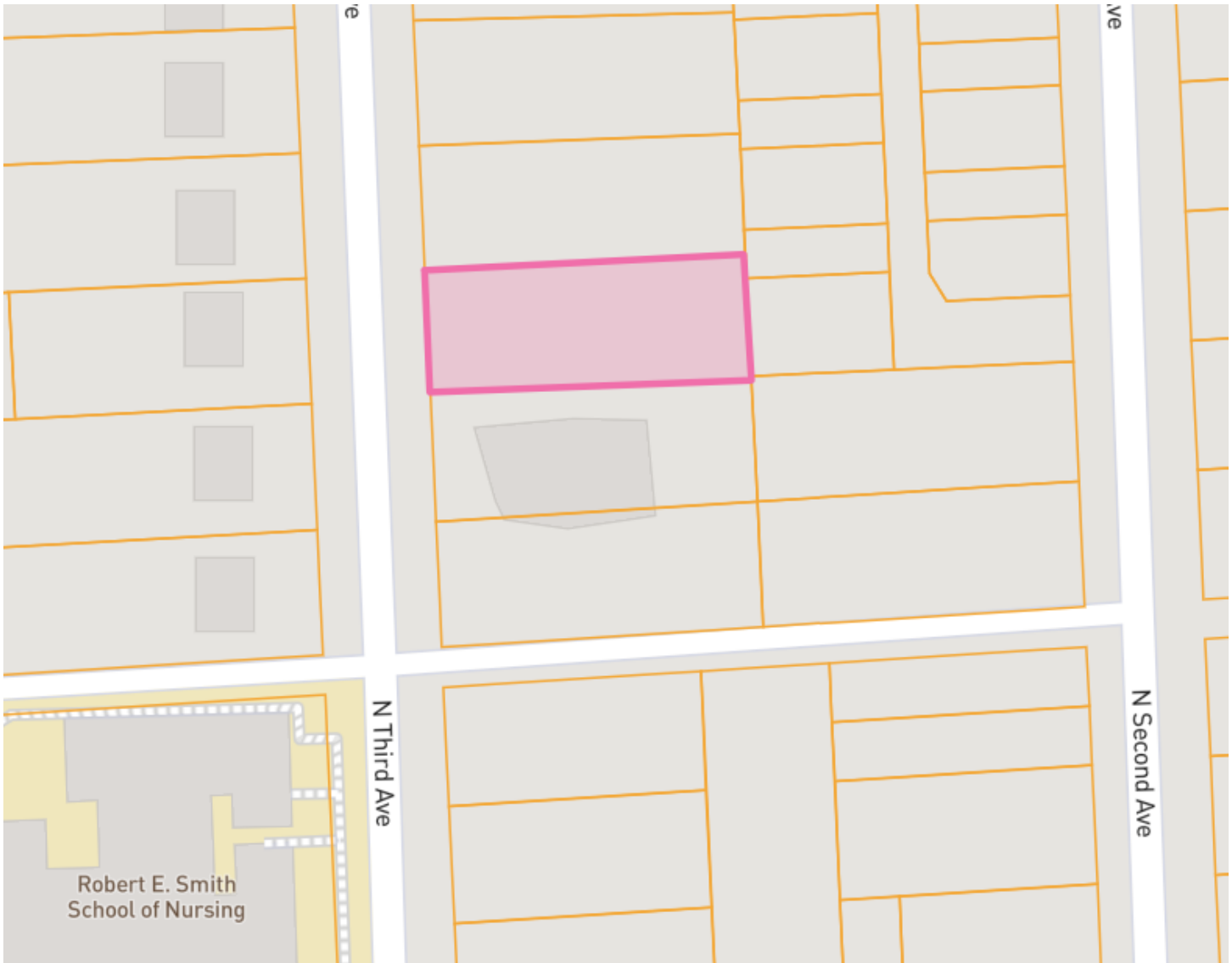

Call me today!

TRACEY BELL, MANAGING BROKER
Tracey@TomSmithLand.com
662.441.2500 **office** | 662.719.4720 **cell**



TomSmithLandandHomes.com

Information is believed to be accurate but not guaranteed.

DIRECTIONAL MAP

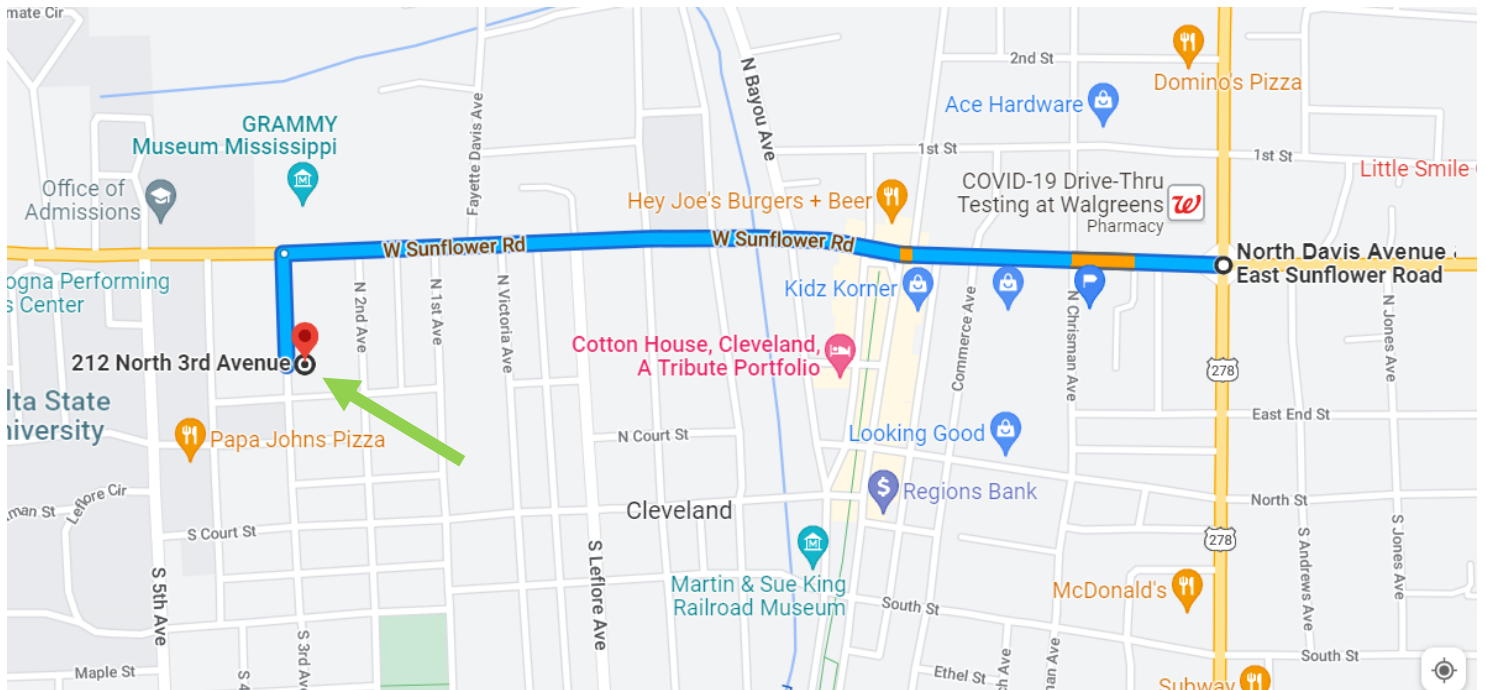

212 North 3rd Ave. Cleveland, MS 38732

Directions from the corner of HWY 61 and HWY 8 in Cleveland, MS: Travel West on Hwy 8 for 0.9 miles, turn left onto N. 3rd Ave and in 0.1 miles the destination is on the left.

Call me today!

TRACEY BELL, MANAGING BROKER
Tracey@TomSmithLand.com
662.441.2500 **office** | 662.719.4720 **cell**



Expect More. Get More.

TomSmithLandandHomes.com

Information is believed to be accurate but not guaranteed.