

Investment Property in Indianola Sunflower County, MS



315 Main Street, Indianola, MS 38751

This 3,700+/- sq/ft space sits on a 1.03+/- acre corner lot in Sunflower County, along Indian Bayou in downtown Indianola. This commercial space was recently renovated, turn-key ready to rent, and conveniently located in the heart of town. The property consists of two separate, rentable spaces. The large event-style space has new carpeted floors, fresh paint, and large natural light windows. The smaller unit is set up perfectly for a food service operation with an installed vent-a-hood system, commercial sinks, stained concrete floors, new exposed industrial HVAC vents and ductwork, ceiling fans, and two large bathrooms. This location is perfect for your business exposure in an extremely high traffic area. Call Emerson today for a private showing!

Directions from the intersection of Hwy 49 & Hwy 82 in Indianola, MS: Travel South on Hwy 49 for 0.4 miles. Turn right onto Main Street and in 0.8 miles the destination is on the right.



Call me today!

EMERSON LOVELACE, REALTOR®
Emerson@TomSmithLand.com
662.441.2500 **office** | 662.715.3302 **cell**



TomSmithLandandHomes.com

Information is believed to be accurate but not guaranteed.



Call me today!

EMERSON LOVELACE, REALTOR®
 Emerson@TomSmithLand.com
 662.441.2500 **office** | 662.715.3302 **cell**



TomSmithLandandHomes.com

Information is believed to be accurate but not guaranteed.

AERIAL MAP



Call me today!

EMERSON LOVELACE, REALTOR®
Emerson@TomSmithLand.com
662.441.2500 **office** | 662.715.3302 **cell**



TomSmithLandandHomes.com

Information is believed to be accurate but not guaranteed.

OWNERSHIP MAP

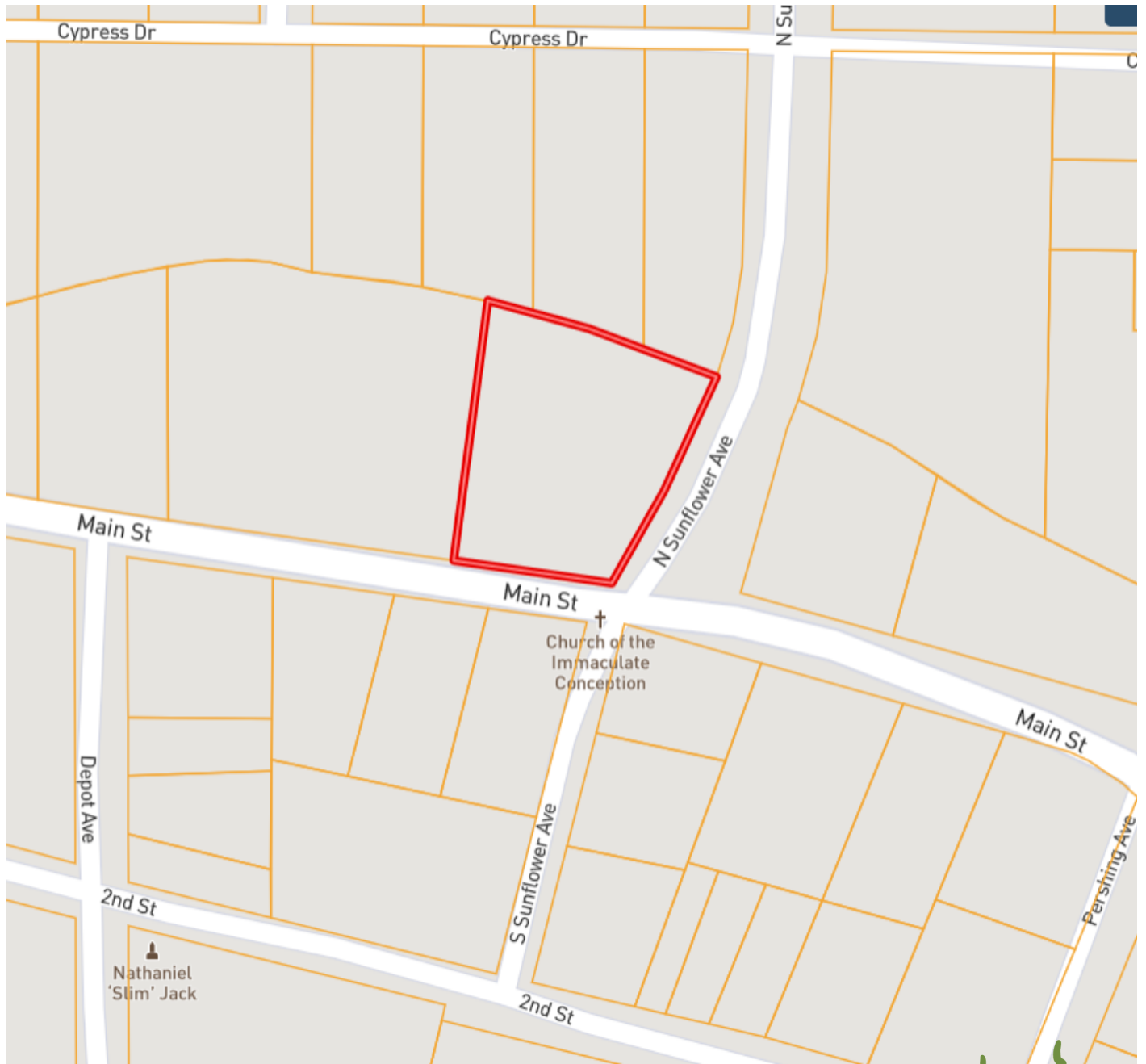

Call me today!

EMERSON LOVELACE, REALTOR®
Emerson@TomSmithLand.com
662.441.2500 **office** | 662.715.3302 **cell**



TomSmithLandandHomes.com

Information is believed to be accurate but not guaranteed.

DIRECTIONAL MAP

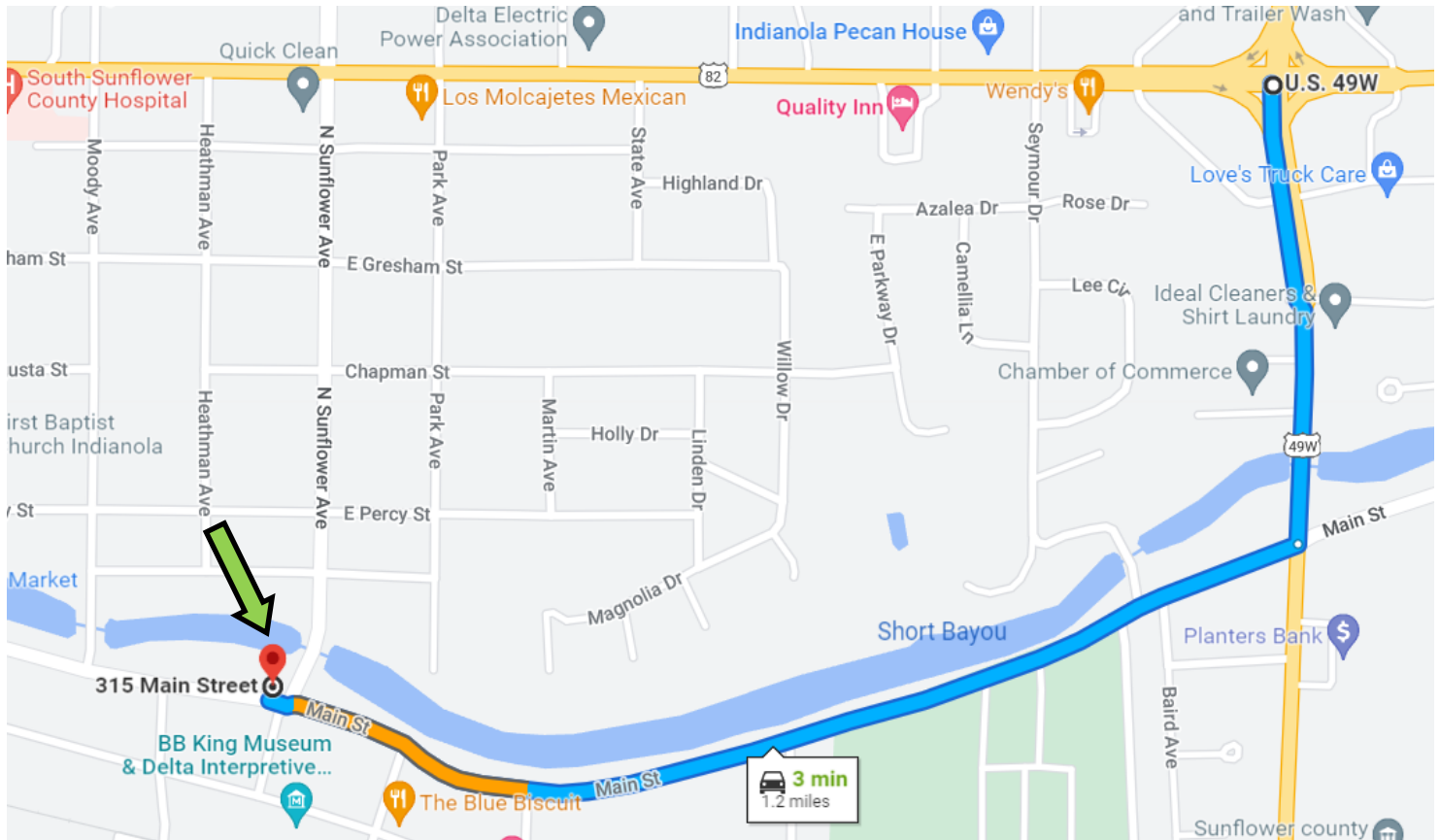

Address: 315 Main Street, Indianola, MS 38751

Directions from the intersection of Hwy 49 & Hwy 82 in Indianola, MS: Travel South on Hwy 49 for 0.4 miles. Turn right onto Main Street and in 0.8 miles the destination is on the right.

Call me today!

EMERSON LOVELACE, REALTOR®
Emerson@TomSmithLand.com
662.441.2500 **office** | 662.715.3302 **cell**



TomSmithLandandHomes.com

Information is believed to be accurate but not guaranteed.