

0.3± Acre Lot in Newton County, MS



This lot in Newton County, located just outside of downtown Newton is the perfect lot to build your dream home. There is already a drive and slab established and ready to go. The lot is approximately 0.3 acres making it perfect for enough yard to have some of your own space but not too much to keep up. Mobile homes are not allowed. Power and water are available. Call Travis Smith today for your private showing!

Directions from four way stop of S Main St. and W Church St. in Newton, MS:

Start south on S Main St. for .07 miles. Turn left on Lillian Ave and travel for .03 miles. Lillian Ave will turn into Parker street at the curve and the property is 148ft on the right.

[108 Parker St, Newton, MS 39345](https://www.google.com/maps/place/108+Parker+St,+Newton,+MS+39345)



Call me today!

TRAVIS SMITH, REALTOR®
Travis@TomSmithLand.com
601.898.2772 **office** | 601.600.0428 **cell**



TomSmithLandandHomes.com

Information is believed to be accurate but not guaranteed.



Call me today!

TRAVIS SMITH, REALTOR®
Travis@TomSmithLand.com
601.898.2772 office | 601.600.0428 cell



Expect More. Get More.

TomSmithLandandHomes.com

Information is believed to be accurate but not guaranteed.



[CLICK HERE FOR AN INTERACTIVE MAP](#)

Call me today!

TRAVIS SMITH, REALTOR®
Travis@TomSmithLand.com
601.898.2772 **office** | 601.600.0428 **cell**



Expect More. Get More.



TomSmithLandandHomes.com

Information is believed to be accurate but not guaranteed.



OWNERSHIP MAP

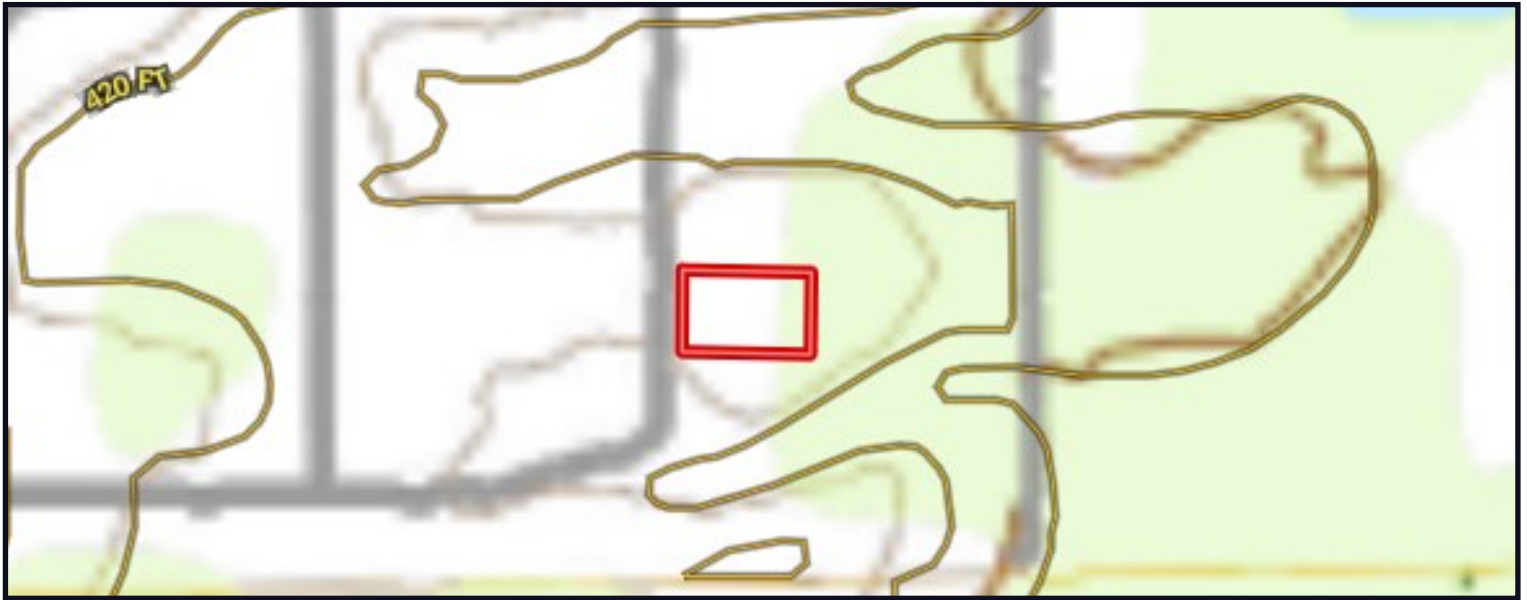

TOPO MAP

Call me today!

TRAVIS SMITH, REALTOR®
Travis@TomSmithLand.com
601.898.2772 office | 601.600.0428 cell



TomSmithLandandHomes.com

Information is believed to be accurate but not guaranteed.

DIRECTIONAL MAP

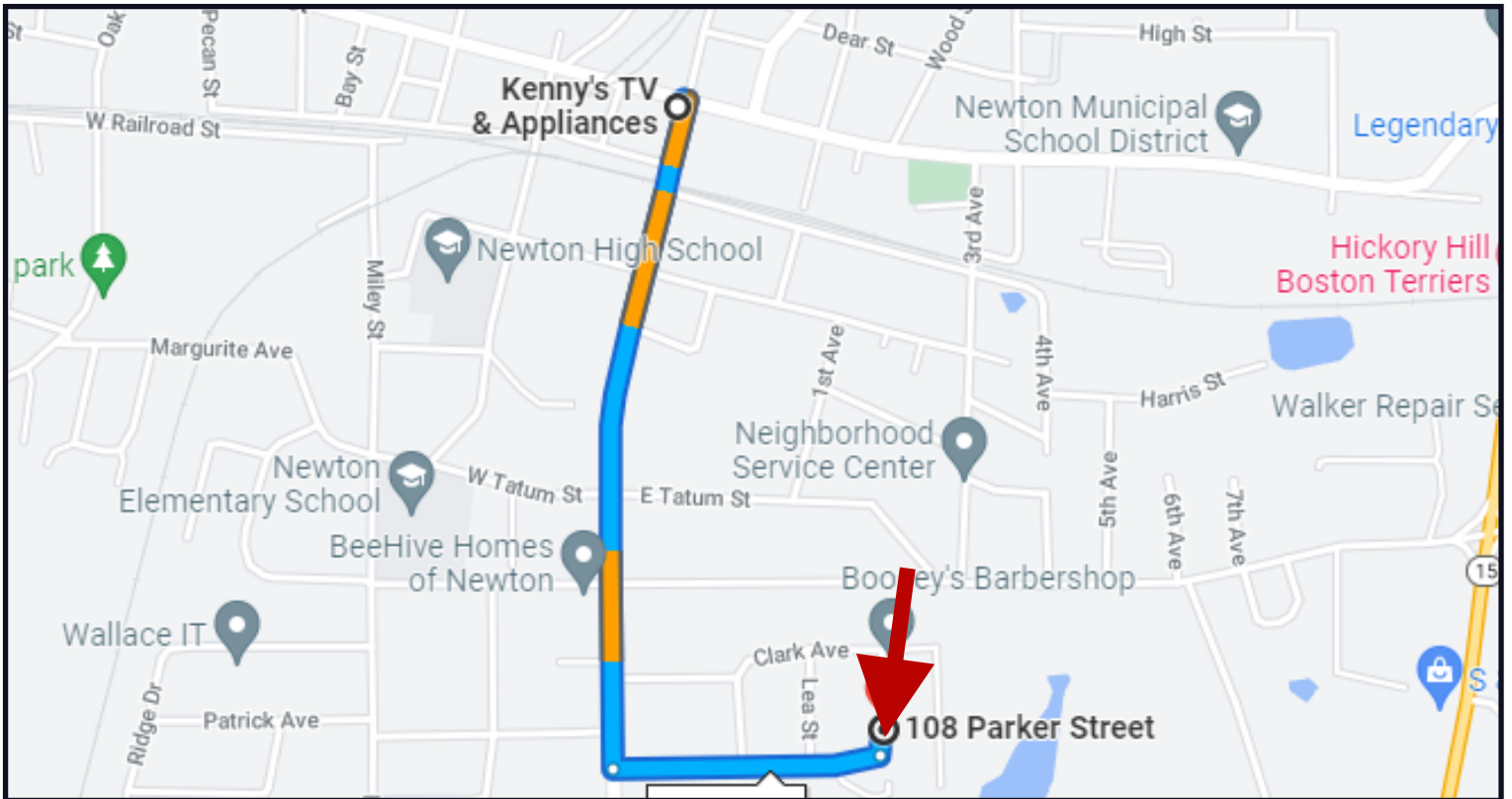

Directions from four way stop of S Main St. and W Church St. in Newton, MS:

Start south on S Main St. for .07 miles. Turn left on Lillian Ave and travel for .03 miles. Lillian Ave will turn into Parker Street at the curve and the property is 148ft on the right.

[108 Parker St, Newton, MS 39345](https://www.google.com/maps/place/108+Parker+St,+Newton,+MS+39345)



Call me today!

TRAVIS SMITH, REALTOR®

Travis@TomSmithLand.com

601.898.2772 office | 601.600.0428 cell



Expect More. Get More.

TomSmithLandandHomes.com

Information is believed to be accurate but not guaranteed.