

Nice Home Sitting 1.5+/- Acres Montgomery County, MS



\$44,900

**43 Stewart Lodi Rd,
Stewart, MS**

Looking for a move-in-ready home in Stewart, MS? Take a look at this three-bedroom, one bath home situated on 1.5 +/- acres in Montgomery County. The property can potentially become an income producing rental house or could be easily fixed up and turned into a nice starter home. This 1698 sqft home also features a two-car carport, shed, and a porch off to the side! The property is being sold "as is." To schedule a private showing, call Walker!

Directions from Hwy 82, Stewart MS: From Stewart MS, head west on US-82 W / MS-182 / Highway 82 toward Stewart Lodi Rd. Then take a right onto Stewart Lodi Rd and the house will be on your left in .3 miles.



Call me today!

WALKER TRANUM, REALTOR®
Walker@TomSmithHomes.com
662.268.6333 office | 662.769.1442 cell



TomSmithLandandHomes.com

LandReport
2011-2022
AMERICA'S
BEST
BROKERAGES



Call me today!

WALKER TRANUM, REALTOR®
Walker@TomSmithHomes.com
662.268.6333 office | 662.769.1442 cell



TomSmithLandandHomes.com

Information is believed to be accurate but not guaranteed.



Call me today!

WALKER TRANUM, REALTOR®
Walker@TomSmithHomes.com
662.268.6333 office | 662.769.1442 cell



LandReport
2011-2022
AMERICA'S
BEST
BROKERAGES

TomSmithLandandHomes.com

Information is believed to be accurate but not guaranteed.

Aerial Map



33.4537,
-89.4353

[Click Here
Interactive Map](#)

1.5+/-
Acres



Stewart

82

82



Call me today!

WALKER TRANUM, REALTOR®
Walker@TomSmithHomes.com
662.268.6333 office | 662.769.1442 cell



TomSmithLandandHomes.com

Information is believed to be accurate but not guaranteed

Ownership Map

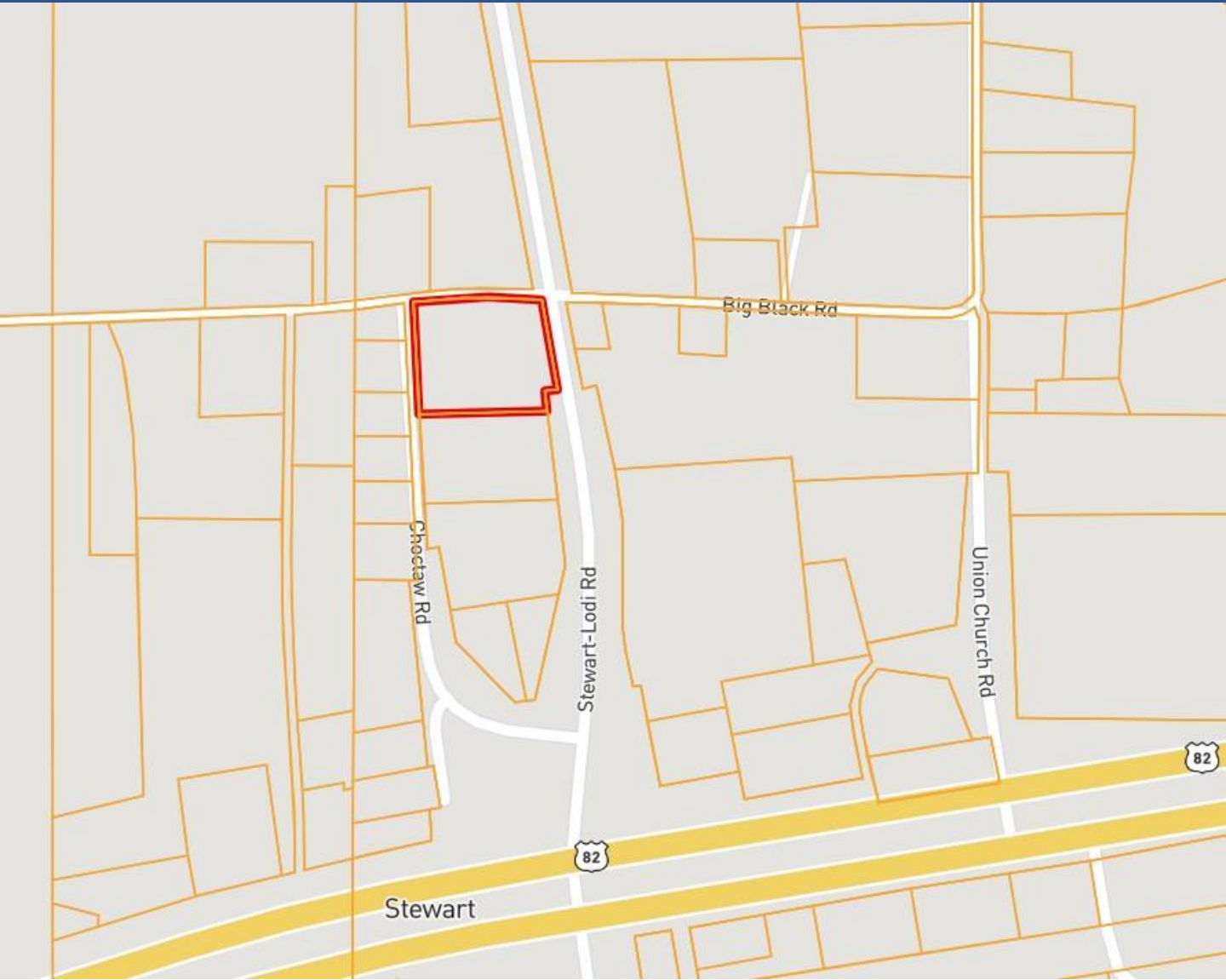

Call me today!

WALKER TRANUM, REALTOR®
Walker@TomSmithHomes.com
662.268.6333 office | 662.769.1442 cell



TomSmithLandandHomes.com

Information is believed to be accurate but not guaranteed.

LandReport
2011-2022
AMERICA'S
BEST
BROKERAGES

Directional Map

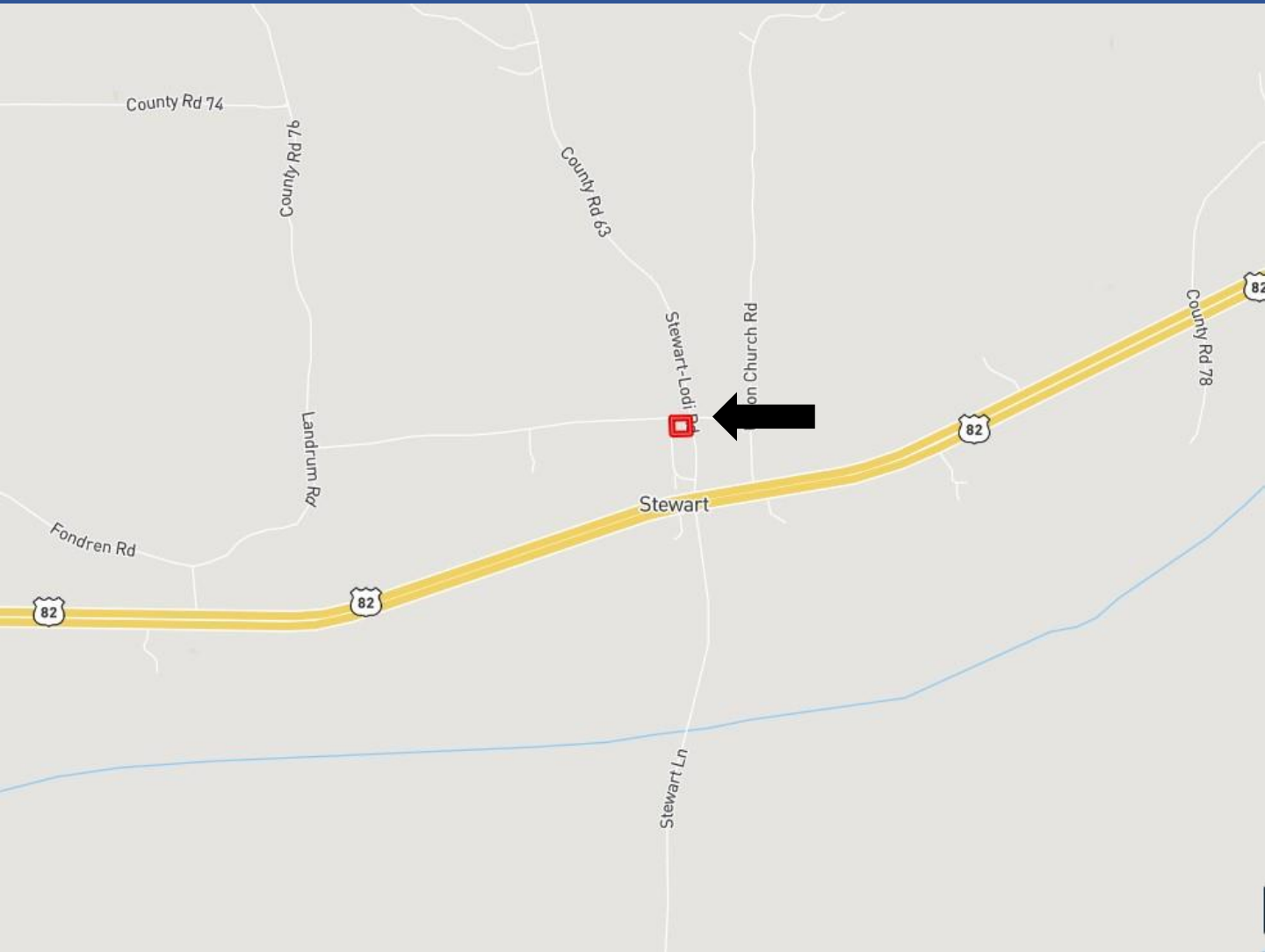

Directions from Hwy 82, Stewart MS: From 4 D Gas Station in Stewart MS, head west on US-82 W / MS-182 / Highway 82 toward Stewart Lodi Rd. Then take a right onto Stewart Lodi Rd and the house will be on your left in .3 miles.



Call me today!

WALKER TRANUM, REALTOR®
Walker@TomSmithHomes.com
662.268.6333 office | 662.769.1442 cell



TomSmithLandandHomes.com

Information is believed to be accurate but not guaranteed.