



COMMERCIAL INVESTMENT OPPORTUNITY LAKE WASHINGTON, WASHINGTON COUNTY, MS



\$300,000

927 Eastside Lake Washington Rd, Glen Allan, MS

Endless investment opportunity on Lake Washington waterfront in Washington County!! Amazing location!! This could be the perfect place for a full time living or a weekend sanctuary getaway overlooking the lake. Lake Washington features great fishing and boating in the summer and is just a few miles from the Mississippi River for winter hunting opportunities. Those of you that are familiar with the town of Glen Allan, MS, fondly recall this 6,107-square foot building being formerly know as the “Kountry Market” with some of the best food after a day of being out on the lake. The other half of this building was formerly used as a fishing camp with its own private pier and boat ramp. This gated property has been vacant for years and will be a perfect fixer upper with an amazing lakefront view. The outdoor possibilities are endless and ready for your enjoyment!! **Call Clay or Bruce and schedule your private showing today!**

Directions from Greenville, MS: Take Hwy 1 South for 25.96 miles; Turn Right on to 436/MS-436 and go 1.64 miles to a stop sign; Take a left onto Lake Washington Road and building is 0.5 miles on the right. Building has red awning and is across from the postal office.



CLAY SIMMONS, REALTOR®
Clay@TomSmithHomes.com
601.898.2772 office | 601.672.6864 cell



Expect More. Get More.

Call us today!



BRUCE WEST, REALTOR®
Bruce@TomSmithLand.com
662.441.2500 office | 662.873.3007 cell

TomSmithLandandHomes.com

Information is believed to be accurate but not guaranteed.





CLAY SIMMONS, REALTOR®
 Clay@TomSmithHomes.com
 601.898.2772 office | 601.672.6864 cell



Expect More. Get More.

Call us today!



BRUCE WEST, REALTOR®
 Bruce@TomSmithLand.com
 662.441.2500 office | 662.873.3007 cell

TomSmithLandandHomes.com

Information is believed to be accurate but not guaranteed.





CLAY SIMMONS, REALTOR®
Clay@TomSmithHomes.com
601.898.2772 office | 601.672.6864 cell



Expect More. Get More.

Call us today!



BRUCE WEST, REALTOR®
Bruce@TomSmithLand.com
662.441.2500 office | 662.873.3007 cell

TomSmithLandandHomes.com

Information is believed to be accurate but not guaranteed.



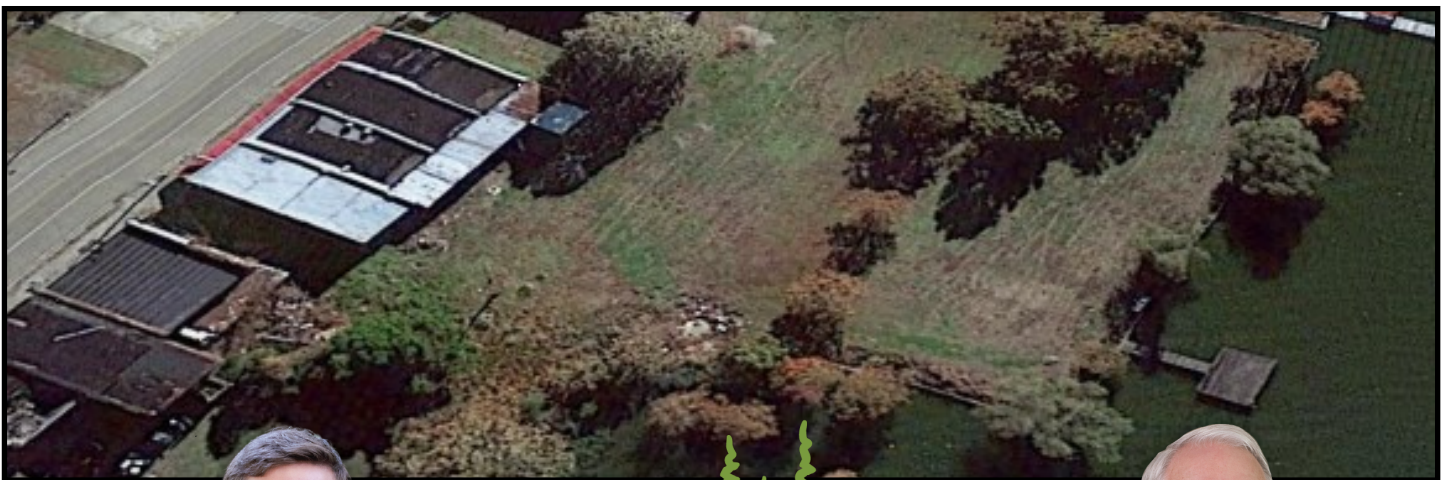

CLAY SIMMONS, REALTOR®
Clay@TomSmithHomes.com
601.898.2772 office | 601.672.6864 cell



Expect More. Get More.

Call us today!



BRUCE WEST, REALTOR®
Bruce@TomSmithLand.com
662.441.2500 office | 662.873.3007 cell

TomSmithLandandHomes.com

Information is believed to be accurate but not guaranteed.



AERIAL MAP

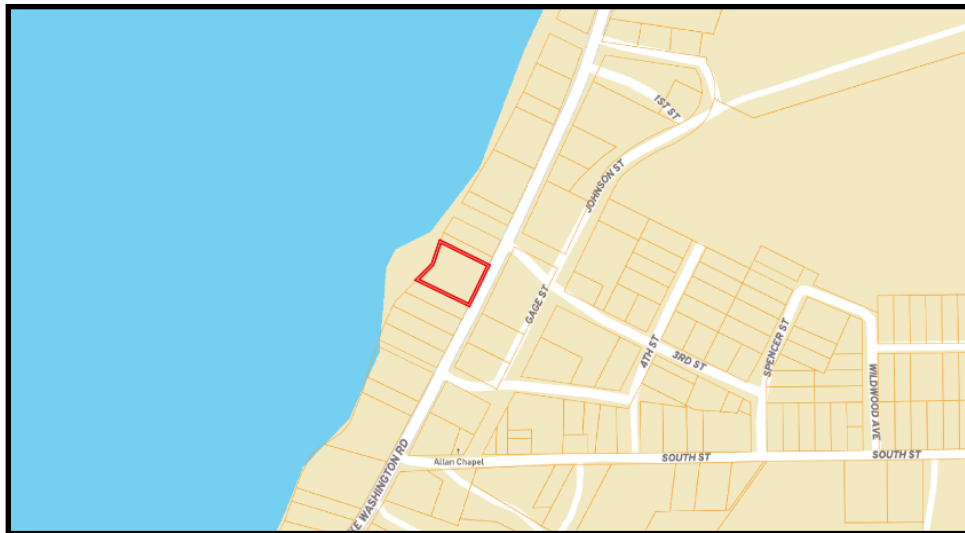

OWNERSHIP MAP

INTERACTIVE MAP

[CLICK HERE](#)



CLAY SIMMONS, REALTOR®
Clay@TomSmithHomes.com
601.898.2772 office | 601.672.6864 cell



Expect More. Get More.

Call us today!



BRUCE WEST, REALTOR®
Bruce@TomSmithLand.com
662.441.2500 office | 662.873.3007 cell

TomSmithLandandHomes.com

Information is believed to be accurate but not guaranteed.



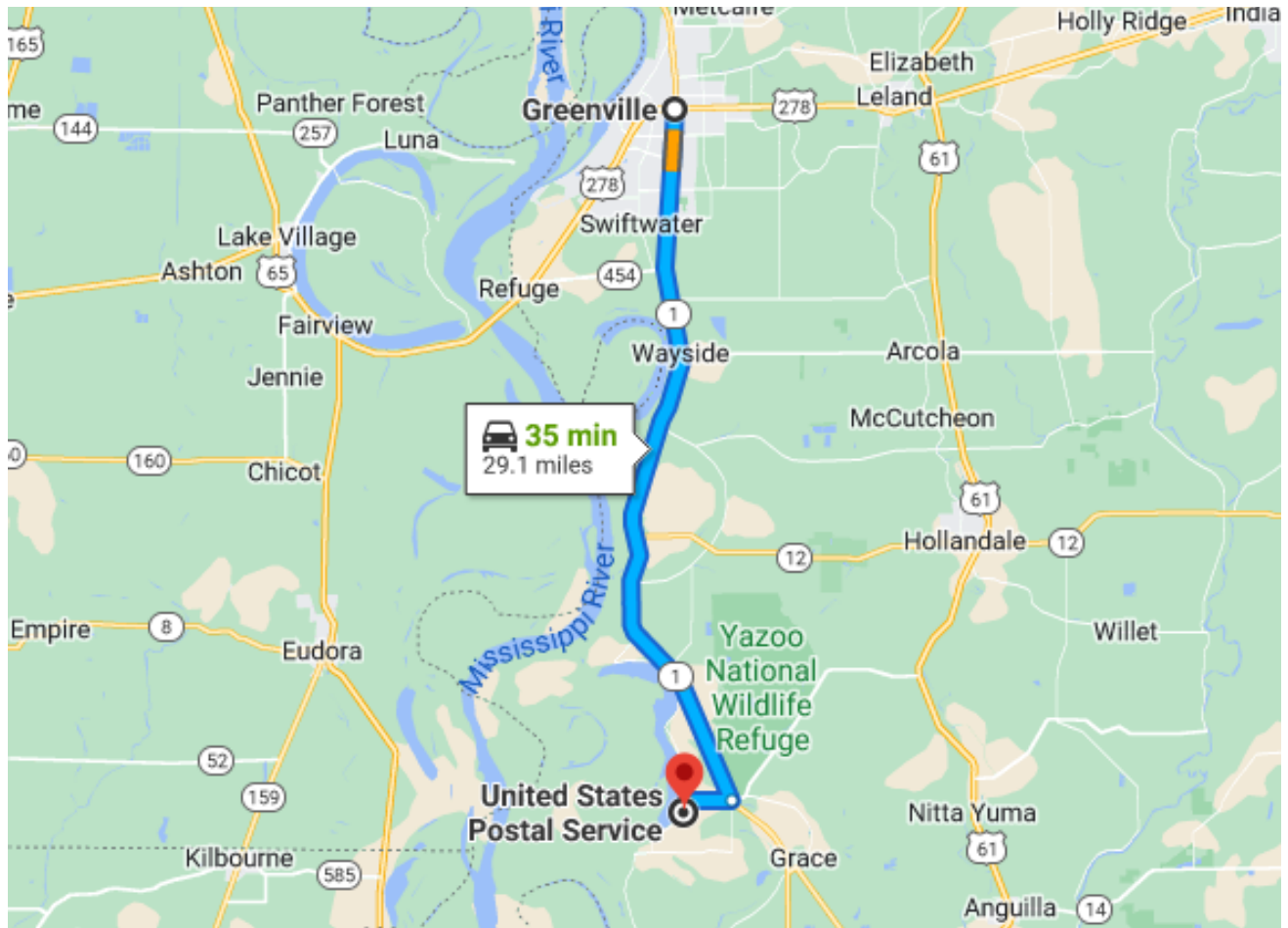

DIRECTIONAL MAP

927 Eastside Lake Washington Rd, Glen Allan, MS

Directions from Greenville, MS: Take Hwy 1 South for 25.96 miles; Turn Right on to 436/MS-436 and go 1.64 miles to a stop sign; Take a left onto Lake Washington Road and building is 0.5 miles on the right. Building has red awning and is across from the postal office.



CLAY SIMMONS, REALTOR®
Clay@TomSmithHomes.com
601.898.2772 office | 601.672.6864 cell



Expect More. Get More.

Call us today!



BRUCE WEST, REALTOR®
Bruce@TomSmithLand.com
662.441.2500 office | 662.873.3007 cell

TomSmithLandandHomes.com

Information is believed to be accurate but not guaranteed.

