

BEAUTIFUL HOME IN THE WRIGHT'S MILL SUBDIVISION IN MADISON COUNTY, MS

349 Kingsbridge Road Madison, MS 39110



\$519,000

- 3,155 SF HOME LOCATED IN MADISON COUNTY, MS
- 4 BED/3.5 BATH
- 10FT TO 12FT CEILINGS
- GOURMET KITCHEN WITH QUARTZ COUNTERTOPS
- TWO LIVING AREAS EACH WITH A FIREPLACE
- LARGE OWNER'S SUITE WITH STEAM SHOWER
- FORMAL DINING ROOM
- COVERED PATIO
- GORGEOUS BACKYARD THAT BACKS UP TO THE NATCHEZ TRACE
- LOUISIANA-STYLE COURTYARD WITH FOUNTAIN
- 3 CAR GARAGE WITH LOTS OF STORAGE
- SECURITY, SPRINKLER AND SOUND SYSTEMS
- EXCELLENT NEIGHBORHOOD POOL AND AMENITIES
- CONVENIENTLY LOCATED TO SHOPPING AND THE INTERSTATE
- MADISON COUNTY SCHOOLS



call me today!

ELLEN SMITH, MANAGING BROKER®

Ellen@TomSmithHomes.com

601.898.2772 office | 601.954.9395 cell



TomSmithLandandHomes.com

Information is believed to be accurate but not guaranteed.

349 Kingsbridge Road Madison, MS 39110

Welcome to your beautiful brick home in the Wright's Mill subdivision in Madison County, MS. This home features four bedrooms, 3.5 baths, a split plan, a gourmet kitchen with stainless steel appliances, quartz countertops, and a large quartz island. The home has two living areas, a great room with built-ins, and a fireplace right next to the kitchen, and then there is another big room with a formal dining room and living room together, built-ins, and a fireplace with French doors leading out to a covered patio. The Backyard is truly a relaxing oasis! The large, .5± acre lot overlooks the Natchez Trace and is fully fenced. Very private and peaceful. You have a lovely cozy Louisiana-style courtyard in front of the house with a fountain, creating a perfect atmosphere to relax and enjoy a book or a cup of iced tea! This house has so many areas to sit and relax! There is so much more to this home, tall 10 ft and 12 ft ceilings throughout the home, arches, a steam shower in the primary room, floor-to-ceiling windows, a central vacuum, security system, sprinklers system, sound system, plus a 3-car garage with extra storage and all on a single level! The subdivision has a fantastic resort-like pool. Home is super convenient to stores and the Interstate and is located in the Madison School District! Call Ellen to schedule your showing today!



ELLEN SMITH, MANAGING BROKER®
Ellen@TomSmithHomes.com
601.898.2772 office | 601.954.9395 cell



TomSmithLandandHomes.com

Information is believed to be accurate but not guaranteed.



ELLEN SMITH, MANAGING BROKER®
 Ellen@TomSmithHomes.com
 601.898.2772 office | 601.954.9395 cell



TomSmithLandandHomes.com

Information is believed to be accurate but not guaranteed.



ELLEN SMITH, MANAGING BROKER®
Ellen@TomSmithHomes.com
601.898.2772 office | 601.954.9395 cell



TomSmithLandandHomes.com

Information is believed to be accurate but not guaranteed.



ELLEN SMITH, MANAGING BROKER®
 Ellen@TomSmithHomes.com
 601.898.2772 office | 601.954.9395 cell



TomSmithLandandHomes.com

Information is believed to be accurate but not guaranteed.



ELLEN SMITH, MANAGING BROKER®
 Ellen@TomSmithHomes.com
 601.898.2772 office | 601.954.9395 cell



TomSmithLandandHomes.com

Information is believed to be accurate but not guaranteed.

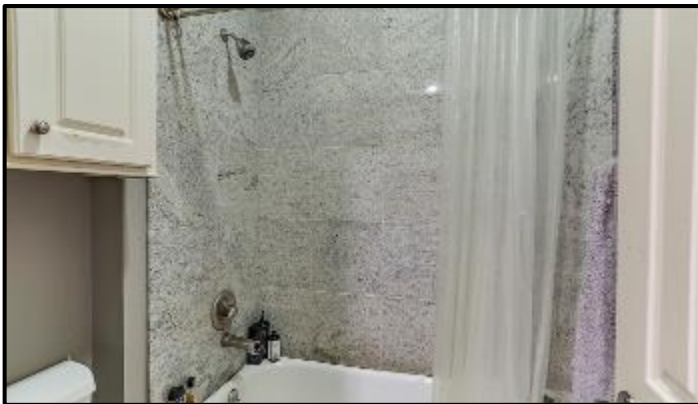

ELLEN SMITH, MANAGING BROKER®
 Ellen@TomSmithHomes.com
 601.898.2772 office | 601.954.9395 cell



TomSmithLandandHomes.com

Information is believed to be accurate but not guaranteed.



ELLEN SMITH, MANAGING BROKER®
 Ellen@TomSmithHomes.com
 601.898.2772 office | 601.954.9395 cell



TomSmithLandandHomes.com

Information is believed to be accurate but not guaranteed.

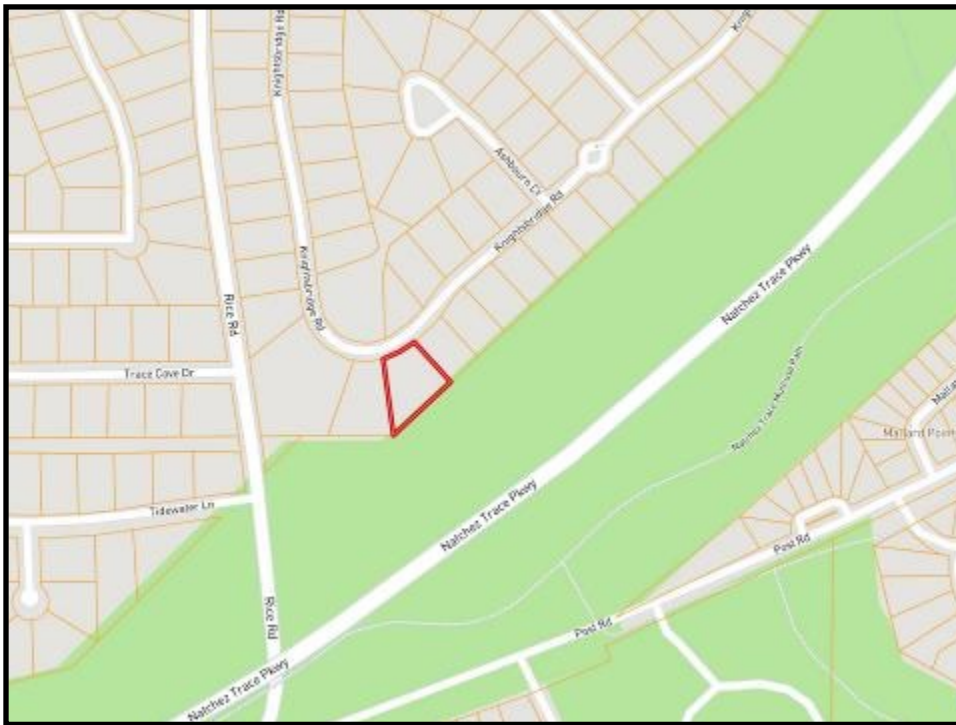

OWNERSHIP MAP



AERIAL MAP

[Click Here for an
Interactive Map](#)



ELLEN SMITH, MANAGING BROKER®
Ellen@TomSmithHomes.com
601.898.2772 office | 601.954.9395 cell



TomSmithLandandHomes.com

Information is believed to be accurate but not guaranteed.

DIRECTIONAL MAP

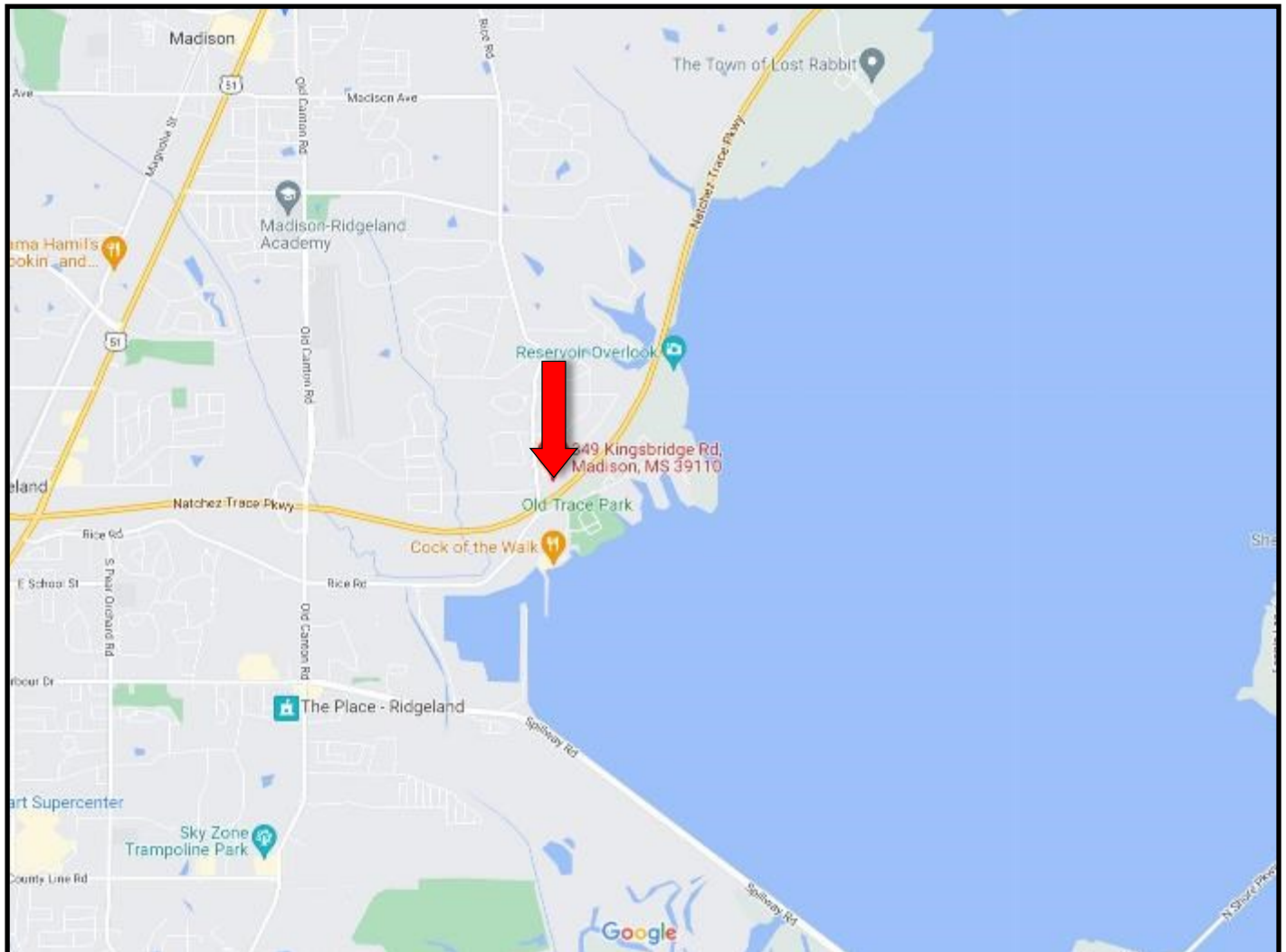

DIRECTIONS FROM HARBOR ROAD AND RICE ROAD IN RIDGELAND, MS: TRAVEL RICE ROAD FOR 1.2 MILES. TURN RIGHT INTO WRIGHT'S MILL SUBDIVISION AND MAKE AN IMMEDIATE RIGHT ONTO KINGSBRIDGE DRIVE, AFTER .2 MILES THE HOUSE WILL BE ON THE RIGHT.

[349 KINGSBRIDGE ROAD MADISON, MS 39110 - CLICK FOR DIRECTIONS](#)



call me today!

ELLEN SMITH, MANAGING BROKER®

Ellen@TomSmithHomes.com

601.898.2772 office | 601.954.9395 cell



Expect More. Get More.

TomSmithLandandHomes.com

Information is believed to be accurate but not guaranteed.