

Prime Commercial Property

233 North Street Cleveland
Bolivar County, MS



Check out this prime location for a commercial property in Bolivar County, MS. 233 North Street Cleveland, MS is located 0.2 of a mile from the main intersection of Hwy 8 and 278, on the corner across the street from the newly built Rick's gas station. The 1,750 sqft building was renovated 7 years and is divided in half allowing for 2 businesses to operate out of the building. Each office space is 875 sqft featuring one bathroom and a small kitchenette. One unit features a large open floor plan, while the other has a small wall dividing the room creating a waiting room with 2 reception windows. The wall could easily be removed to create one large open space. This is a great investment property bringing in monthly income with great road frontage on North Street! Parking is located behind the building.

Directions from the intersection of Hwy 8 and 278 in Cleveland, MS: Travel south on N Davis Ave toward East End Street for .2 of a mile. Turn right onto North Street. In 217 feet the destination is on your right.



Call me today!

ANTHONY STEEN, REALTOR®
Anthony@TomSmithLand.com
662.441.2500 office | 662.645.5151 cell



TomSmithLandandHomes.com

Information is believed to be accurate but not guaranteed.



Call me today!

ANTHONY STEEN, REALTOR®
Anthony@TomSmithLand.com
662.441.2500 office | 662.645.5151 cell



TomSmithLandandHomes.com

Information is believed to be accurate but not guaranteed.



2011-2022
BEST
BROKERAGES

ANTHONY STEEN, REALTOR
Anthony@TomSmithLand.com
• 662.441.2500 office | 662.645.5151 cell

Tom Smith
LAND AND HOMES
Expect More. Get More.

TomSmithLandandHomes.com

Information is believed to be accurate but not guaranteed.



Call me today!

ANTHONY STEEN, REALTOR
Anthony@TomSmithLand.com

662.441.2500 **office** | 662.645.5151 **cell**



Expect More. Get More.

TomSmithLandandHomes.com

Information is believed to be accurate but not guaranteed.

Aerial Map



[Click to view interactive map](#)

Call me today!

ANTHONY STEEN, REALTOR®
Anthony@TomSmithLand.com
662.441.2500 **office** | 662.645.5151 **cell**



TomSmithLandandHomes.com

Information is believed to be accurate but not guaranteed.

Ownership Map

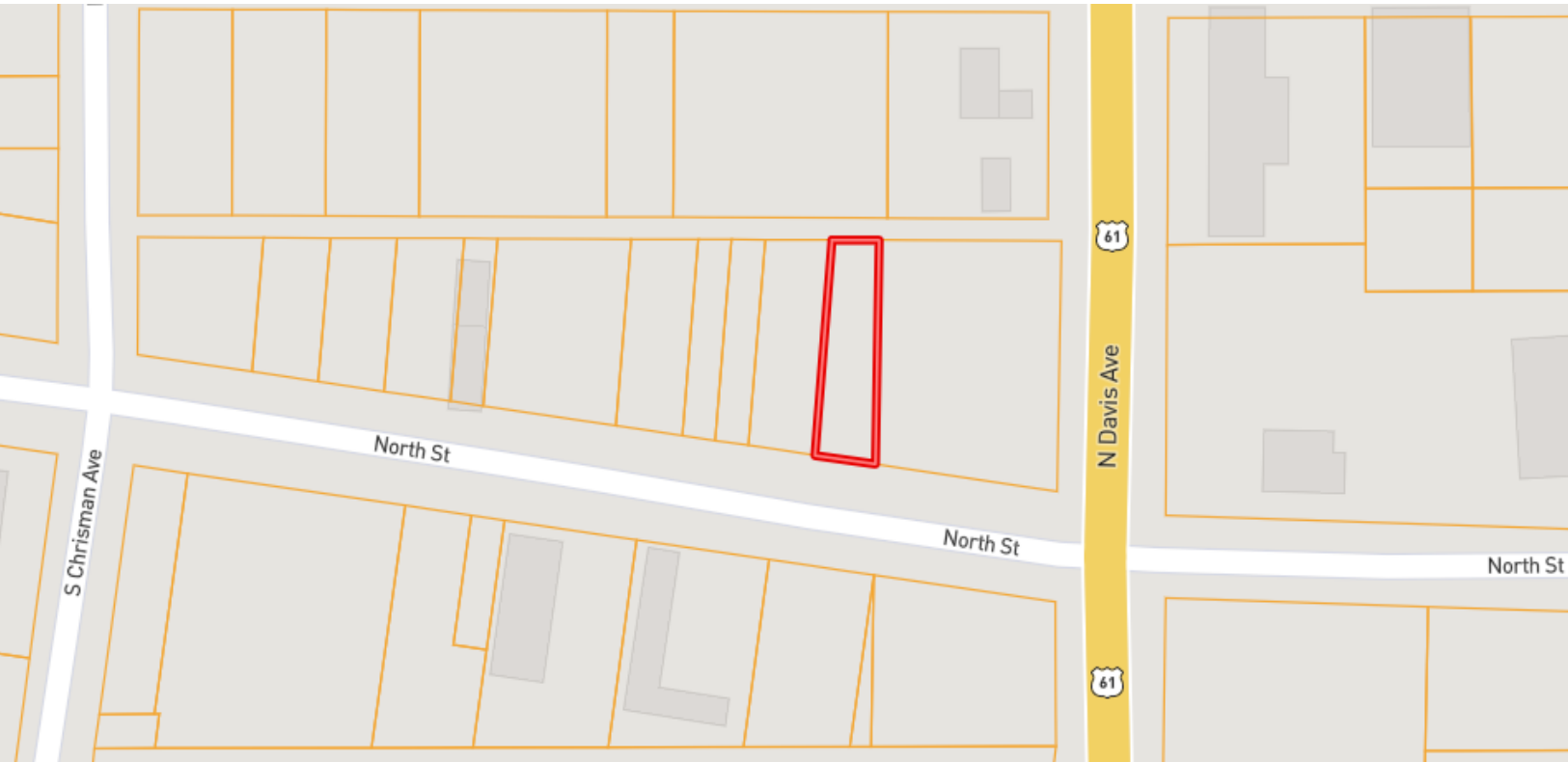

[Click to view interactive map](#)

Call me today!

ANTHONY STEEN, REALTOR®
Anthony@TomSmithLand.com
662.441.2500 **office** | 662.645.5151 **cell**



TomSmithLandandHomes.com

Information is believed to be accurate but not guaranteed.

Google Map

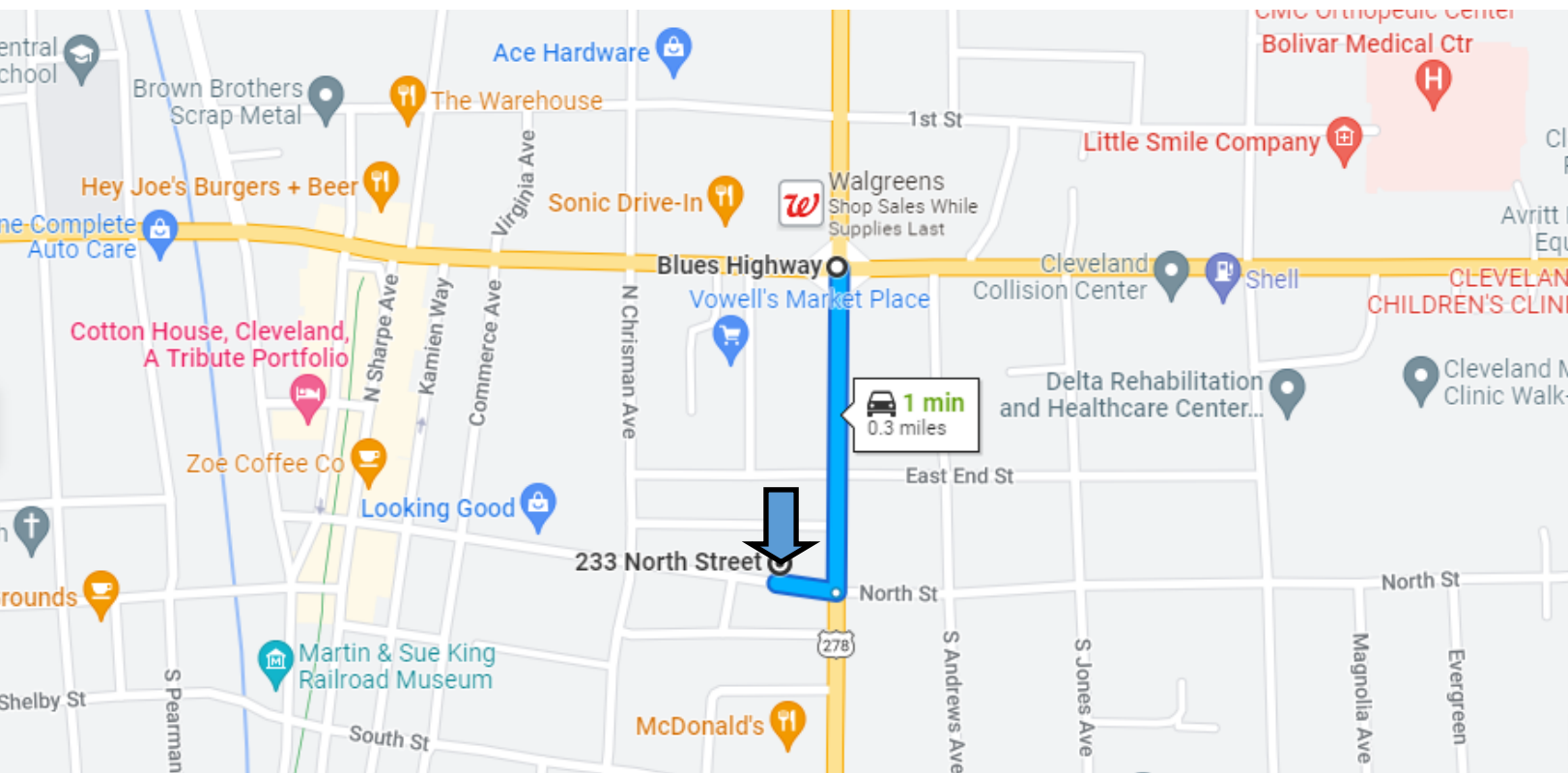

Directions from the intersection of Hwy 8 and 278 in Cleveland, MS: Travel south on N Davis Ave toward East End Street for .2 of a mile. Turn right onto North Street. In 217 feet the destination is on your right.

[Google Map Directions](#)

Call me today!

ANTHONY STEEN, REALTOR®
Anthony@TomSmithLand.com
662.441.2500 **office** | 662.645.5151 **cell**



TomSmithLandandHomes.com

Information is believed to be accurate but not guaranteed.