

# Golf Course Home in Bolivar County

Cleveland, MS



\$750,000

**Address: 411 Norman Circle Cleveland, MS 38732**

Look at this spacious home, which backs up to the Cleveland Country Club golf course in Bolivar County, MS. This home has five bedrooms and three and a half bathrooms. When you walk in the front door, you have a gorgeous stair rail with high ceilings, the study is off to the right with private glass doors, and to the left, you have a formal dining room for all your holiday events. The kitchen has a double oven and gas cooktop with a bar area for the kids to sit in that has a little kitchen table nestled by the rear window to watch the golfers. The den can hold the tallest Christmas tree you could ever want. The spacious primary bedroom is tucked away with a romantic gas fireplace and master bath with double vanity, private toilet, shower, and tub. The second floor has four bedrooms and two full bathrooms. The third floor is a great recreational room with breathtaking views. Call today for your private showing! (662)441-2500

**Directions from the intersection of Hwy 8 and Hwy 61 Cleveland, MS: Travel West on Hwy 8 for approximately 1.7 miles, turn right onto Ronaldman Road. In 0.6 miles turn right onto Norman Circle and in 0.1 miles the house is on the right.**



*Call me today!*

**TRACEY BELL**, MANAGING BROKER  
Tracey@TomSmithLand.com  
662.441.2500 **office** | 662.719.4720 **cell**



**TomSmithLandandHomes.com**

Information is believed to be accurate but not guaranteed.



*Call me today!*

**TRACEY BELL**, MANAGING BROKER  
Tracey@TomSmithLand.com  
662.441.2500 **office** | 662.719.4720 **cell**



**TomSmithLandandHomes.com**

Information is believed to be accurate but not guaranteed.

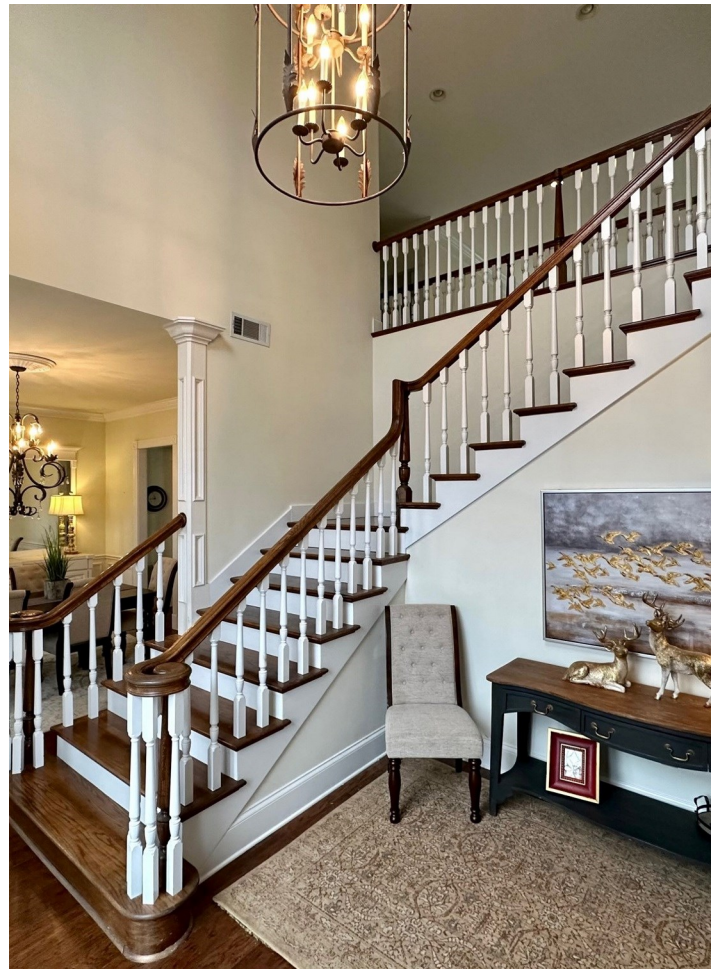

*Call me today!*

**TRACEY BELL**, MANAGING BROKER  
Tracey@TomSmithLand.com  
662.441.2500 **office** | 662.719.4720 **cell**



**TomSmithLandandHomes.com**

Information is believed to be accurate but not guaranteed.



*Call me today!*

**TRACEY BELL**, MANAGING BROKER  
Tracey@TomSmithLand.com  
662.441.2500 **office** | 662.719.4720 **cell**



**TomSmithLandandHomes.com**

Information is believed to be accurate but not guaranteed.



*Call me today!*

**TRACEY BELL**, MANAGING BROKER  
Tracey@TomSmithLand.com  
662.441.2500 **office** | 662.719.4720 **cell**



**TomSmithLandandHomes.com**

Information is believed to be accurate but not guaranteed.



*Call me today!*

**TRACEY BELL**, MANAGING BROKER  
Tracey@TomSmithLand.com  
662.441.2500 **office** | 662.719.4720 **cell**



**TomSmithLandandHomes.com**

Information is believed to be accurate but not guaranteed.

# OWNERSHIP MAP

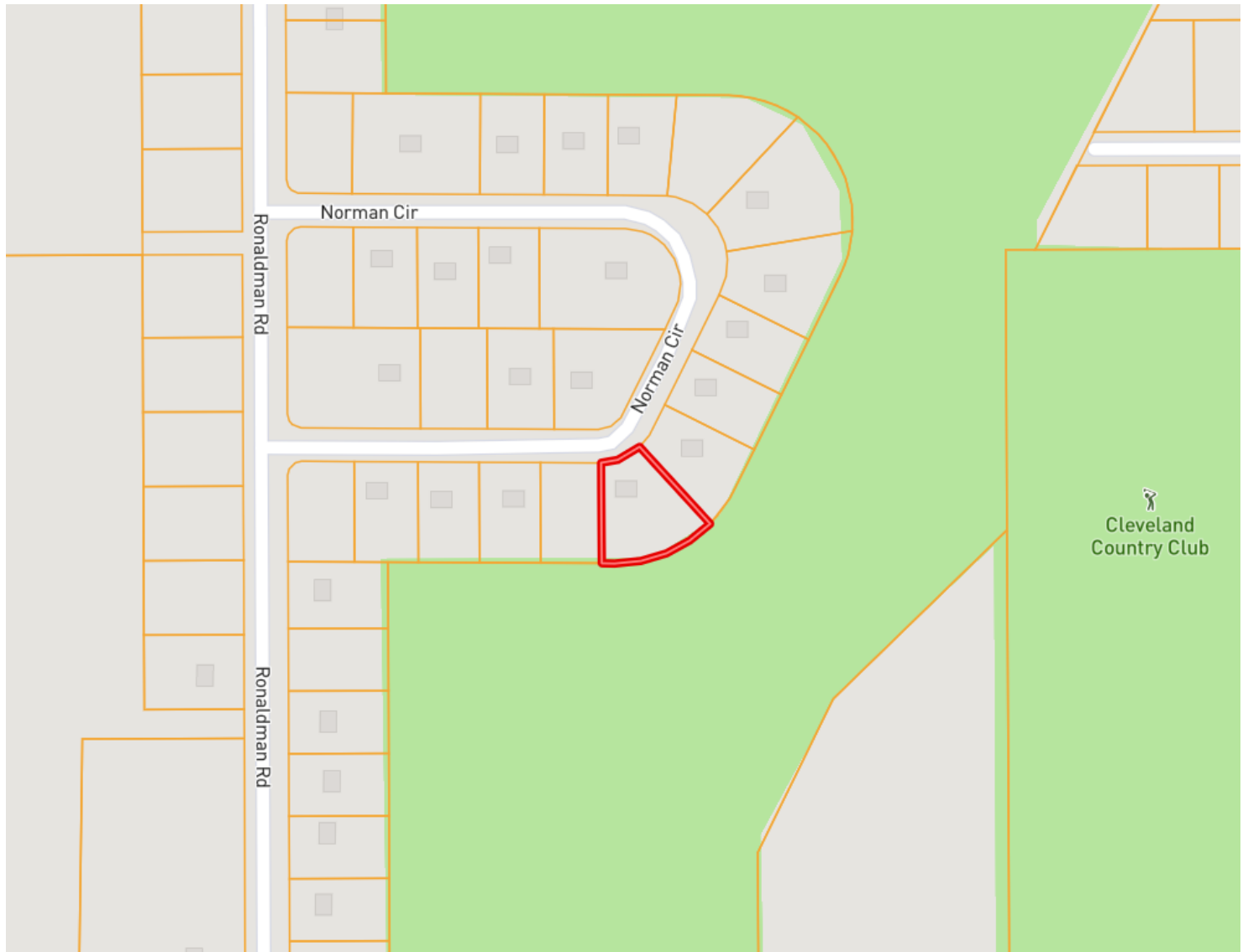

*Call me today!*

**TRACEY BELL**, MANAGING BROKER  
Tracey@TomSmithLand.com  
662.441.2500 **office** | 662.719.4720 **cell**



**TomSmithLandandHomes.com**

Information is believed to be accurate but not guaranteed.

# AERIAL MAP



[Click for Interactive Map](#)

*Call me today!*

**TRACEY BELL**, MANAGING BROKER  
Tracey@TomSmithLand.com  
662.441.2500 **office** | 662.719.4720 **cell**



Expect More. Get More.

**TomSmithLandandHomes.com**

Information is believed to be accurate but not guaranteed.



# DIRECTIONAL MAP

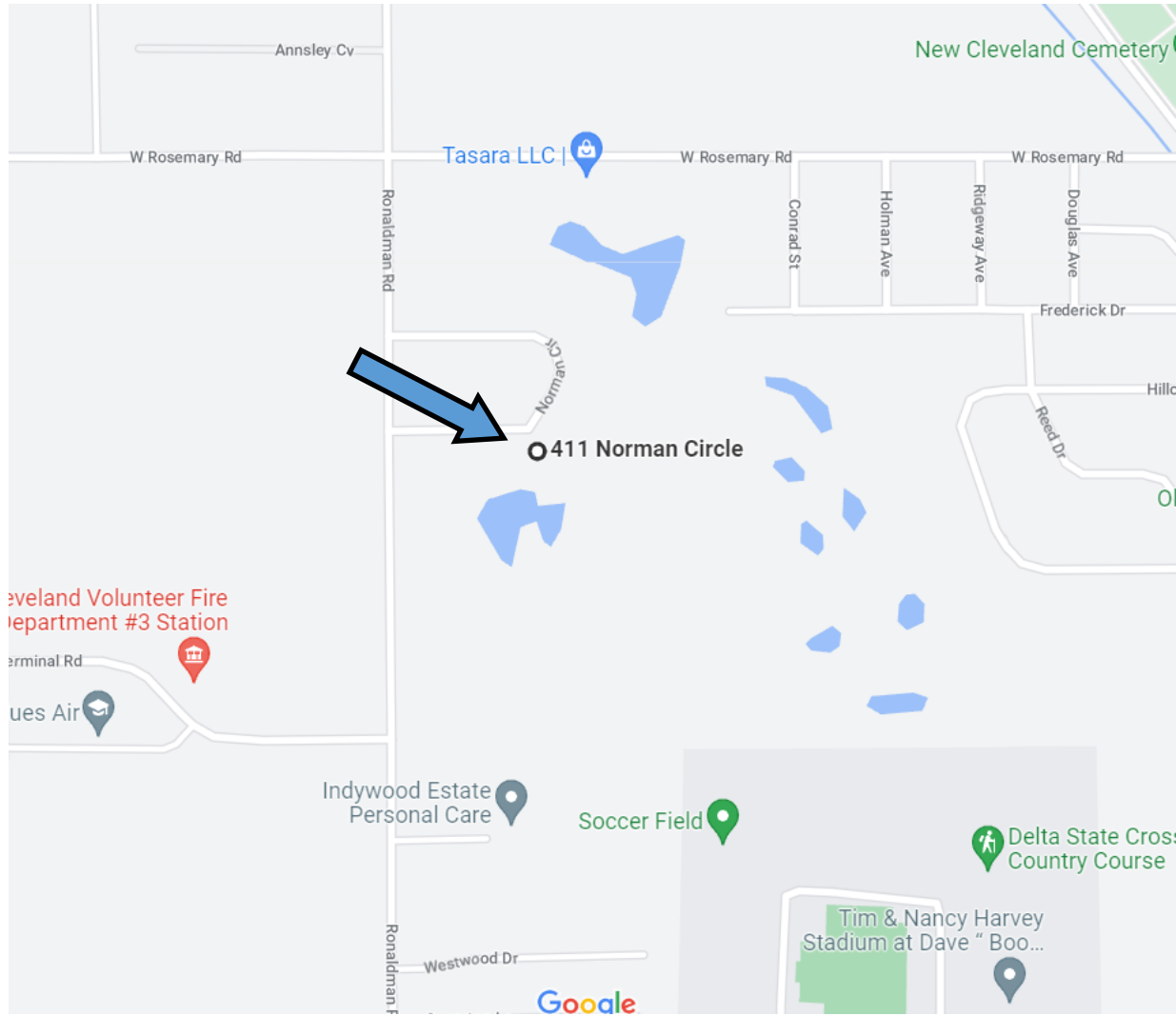

**Address: 411 Noraman Circle Cleveland, MS 38732**

**Directions from the intersection of Hwy 8 and Hwy 61 Cleveland, MS:** Travel West on Hwy 8 for approximately 1.7 miles, turn right onto Ronaldman Road. In 0.6 miles turn right onto Norman Circle and in 0.1 miles the house is on the right. [Click for Google Maps.](#)



*Call me today!*

**TRACEY BELL**, MANAGING BROKER  
Tracey@TomSmithLand.com  
662.441.2500 **office** | 662.719.4720 **cell**



**TomSmithLandandHomes.com**

Information is believed to be accurate but not guaranteed.