



**1311 West Sunflower Road Cleveland, MS 38732**



## **Wonderful Family Home in Bolivar County, MS**

**\$215,000**

Welcome to your new wonderful family home in Bolivar County, MS. This lovely renovated house features three bedrooms, two and a half bathrooms, 2,050 heated and cooled SF, and a fenced-in backyard for privacy. The backyard also features an excellent shed for extra storage. This house sits on a conventional slab foundation and has a year old 30-year architectural roof. The interior has been freshly painted, and the exterior pressure washed for its new owner! One of this home's best features is the large primary suite featuring a jacuzzi tub, walk-in shower, and large walk-in closet with built-in shelving. There is also plenty of room to entertain family and friends in the dining or living room. 1311 West Sunflower Road is conveniently located in the heart of Cleveland, MS, within walking distance to Dollar General or Uncle Jo's and No Way Jose for a quick bite to eat!



*Call me  
today!*

**ANTHONY STEEN, REALTOR®**  
Anthony@TomSmithLand.com  
662.441.2500 **office** | 662.645.5151 **cell**



**TomSmithLandandHomes.com**

Information is believed to be accurate but not guaranteed.





*Call me today!*

**ANTHONY STEEN, REALTOR®**

Anthony@TomSmithLand.com

662.441.2500 **office** | 662.645.5151 **cell**

**Tom  
Smith  
LAND AND  
HOMES**

Expect More. Get More.



**TomSmithLandandHomes.com**

Information is believed to be accurate but not guaranteed.





*Call me today!*

**ANTHONY STEEN, REALTOR**  
Anthony@TomSmithLand.com  
662.441.2500 office | 662.645.5151 cell



Expect More. Get More.



**TomSmithLandandHomes.com**

Information is believed to be accurate but not guaranteed.





*Call me today!*

**ANTHONY STEEN, REALTOR®**

Anthony@TomSmithLand.com

662.441.2500 office | 662.645.5151 cell



**TomSmithLandandHomes.com**

Information is believed to be accurate but not guaranteed.

# Aerial Map

[Click to view interactive map](#)

33.7464, -90.7407



# Ownership Map

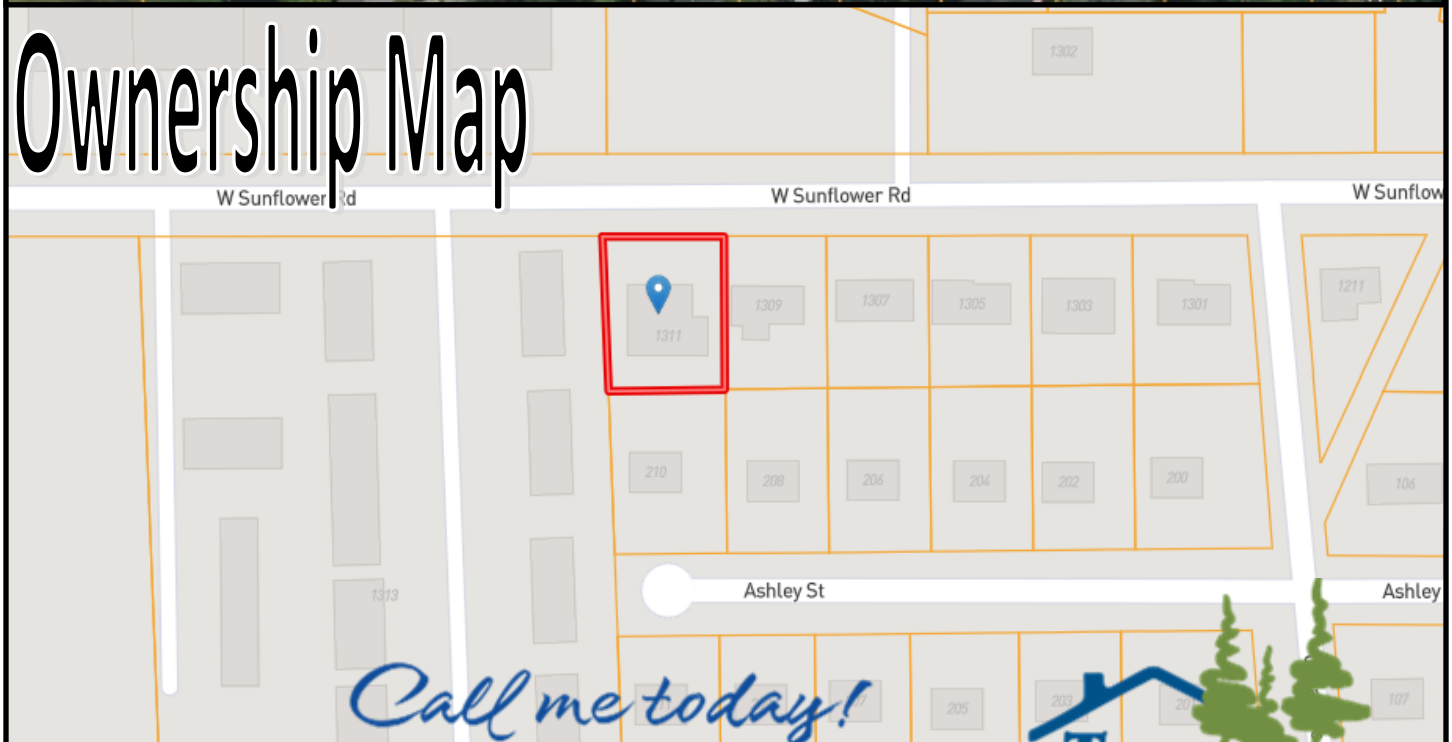

*Call me today!*



**ANTHONY STEEN, REALTOR®**  
Anthony@TomSmithLand.com  
662.441.2500 **office** | 662.645.5151 **cell**

**TomSmithLandandHomes.com**

Information is believed to be accurate but not guaranteed.



# Directional Map

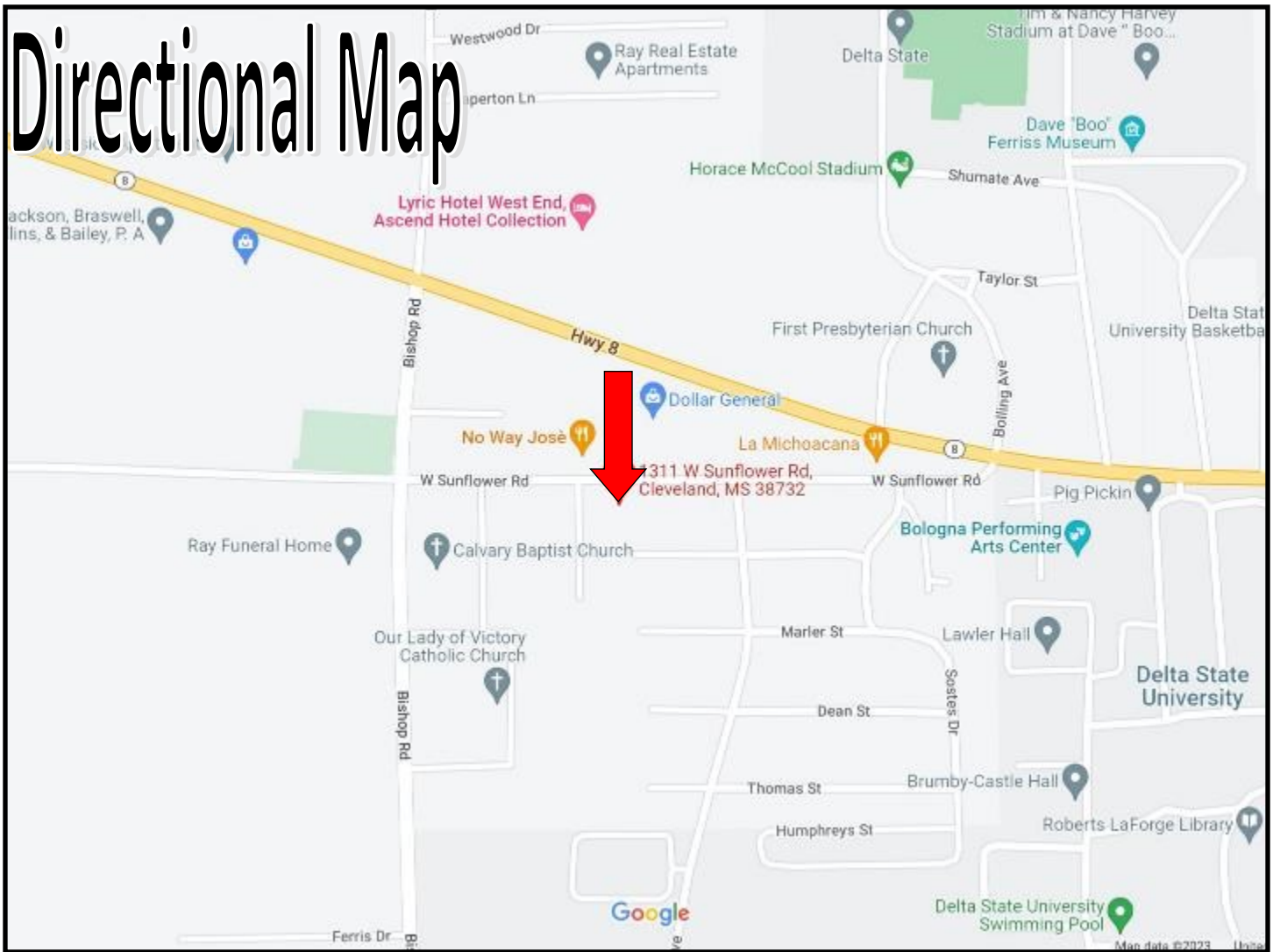

**Directions From the Intersection of Hwy 8 and Hwy 61 in Cleveland, MS:** Travel west on Hwy 8/ Sunflower Road toward N Chrisman Avenue for 1.3 miles. Turn left on to Sunflower Road for .3 of a mile. The house will be on your left.  
1311 W Sunflower Rd. Cleveland, MS 38732

[Google Map Directions](#)



*Call me today!*

**ANTHONY STEEN, REALTOR®**  
Anthony@TomSmithLand.com  
662.441.2500 office | 662.645.5151 cell



Expect More. Get More.

**TomSmithLandandHomes.com**

Information is believed to be accurate but not guaranteed.