

# Charming Brick Home BOLIVAR COUNTY, MS



49 Stanton Road Cleveland, MS 38732

Discover this charming home located just North of Bayou Academy in Cleveland, Bolivar County, MS. The property features two shops, including a 25x25 insulated metal shop on a concrete slab, providing ample storage space for your belongings. The large backyard is perfect for family gatherings. With 0.68+/- acres, the house offers 2,190 sqft of living space, featuring four bedrooms, two and a half bathrooms, and a beautiful sunroom overlooking the backyard. The primary bedroom has two walk-in closets and a relaxing jacuzzi tub. Contact Anthony today for a private showing!

Directions from HWY 61 and HWY 8 in Cleveland, MS: Travel West on Hwy 8 for approximately 2.8 miles. Turn right onto Crosby Road and travel 1.8 miles. Turn right onto Thelma Road, and then in 0.1 miles turn right onto Stanton Road. After 72 feet, the house will be on the right.



**ANTHONY  
STEEN**  
REALTOR®

Office: 662.441.2500  
Cell: 662.645.5151

Anthony@TomSmithLand.com



**A Real Estate Expert You Can Trust**

TomSmithLandandHomes.com

Information is believed to be accurate but not guaranteed.







**ANTHONY STEEN**

REALTOR®

Office: 662.441.2500

Cell: 662.645.5151

Anthony@TomSmithLand.com



**A Real Estate Expert You Can Trust**

TomSmithLandandHomes.com

Information is believed to be accurate but not guaranteed.







**ANTHONY STEEN**

REALTOR®

Office: 662.441.2500

Cell: 662.645.5151

Anthony@TomSmithLand.com



**A Real Estate Expert You Can Trust**

TomSmithLandandHomes.com

Information is believed to be accurate but not guaranteed.







**ANTHONY STEEN**

REALTOR®

Office: 662.441.2500

Cell: 662.645.5151

Anthony@TomSmithLand.com



**A Real Estate Expert You Can Trust**

TomSmithLandandHomes.com

Information is believed to be accurate but not guaranteed.







**ANTHONY STEEN**

REALTOR®

Office: 662.441.2500

Cell: 662.645.5151

Anthony@TomSmithLand.com



**A Real Estate Expert You Can Trust**

TomSmithLandandHomes.com

Information is believed to be accurate but not guaranteed.







**ANTHONY STEEN**

REALTOR®

Office: 662.441.2500

Cell: 662.645.5151

Anthony@TomSmithLand.com



**A Real Estate Expert You Can Trust**

TomSmithLandandHomes.com

Information is believed to be accurate but not guaranteed.





# AERIAL MAP



[Click for Here for an Interactive Map](#)

**ANTHONY STEEN**  
REALTOR®

Office: 662.441.2500

Cell: 662.645.5151

Anthony@TomSmithLand.com



**A Real Estate Expert You Can Trust**  
TomSmithLandandHomes.com

Information is believed to be accurate but not guaranteed.



# OWNERSHIP MAP

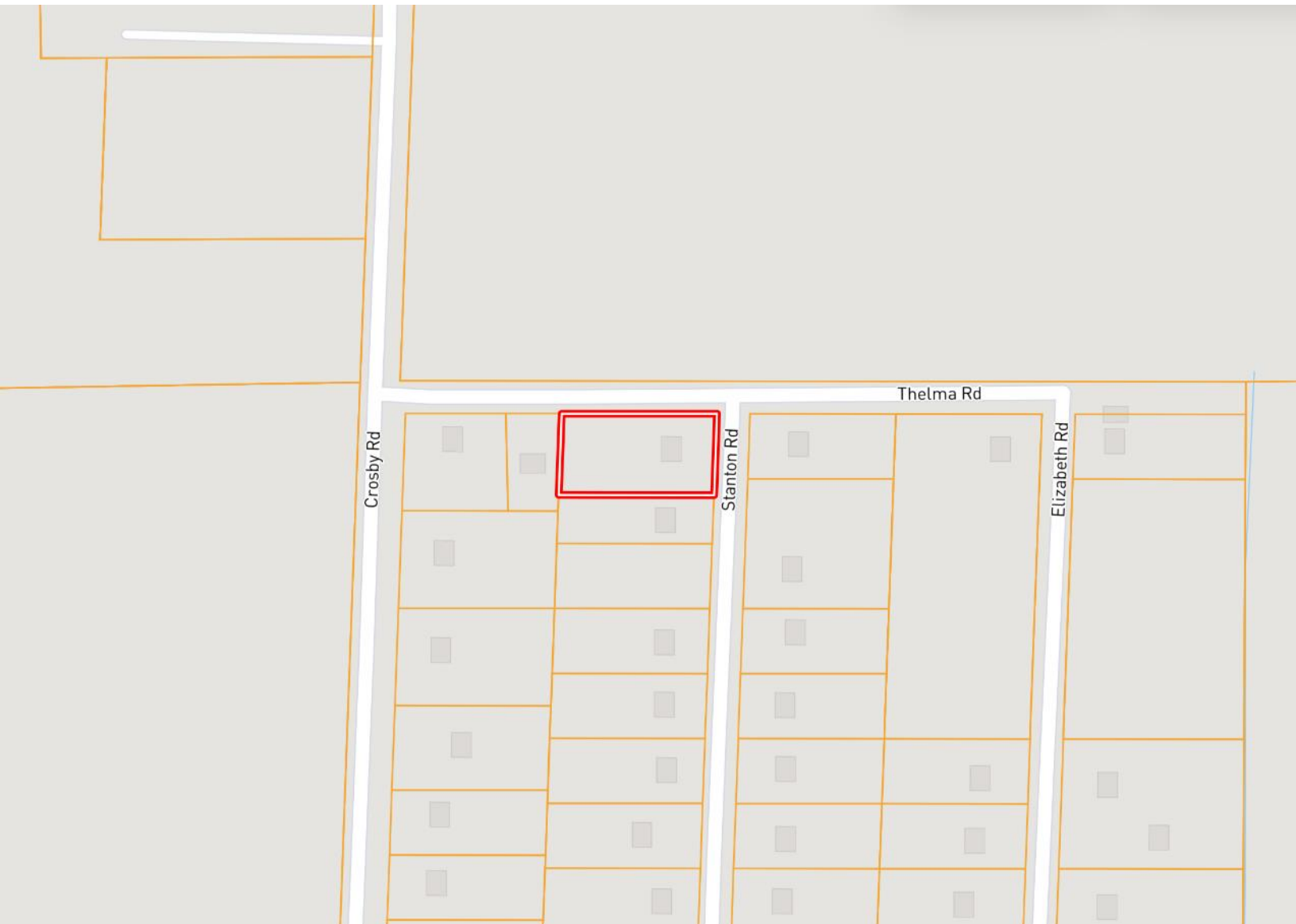

**ANTHONY STEEN**  
REALTOR®

Office: 662.441.2500

Cell: 662.645.5151

Anthony@TomSmithLand.com



**A Real Estate Expert You Can Trust**  
TomSmithLandandHomes.com

Information is believed to be accurate but not guaranteed.





# DIRECTIONAL MAP

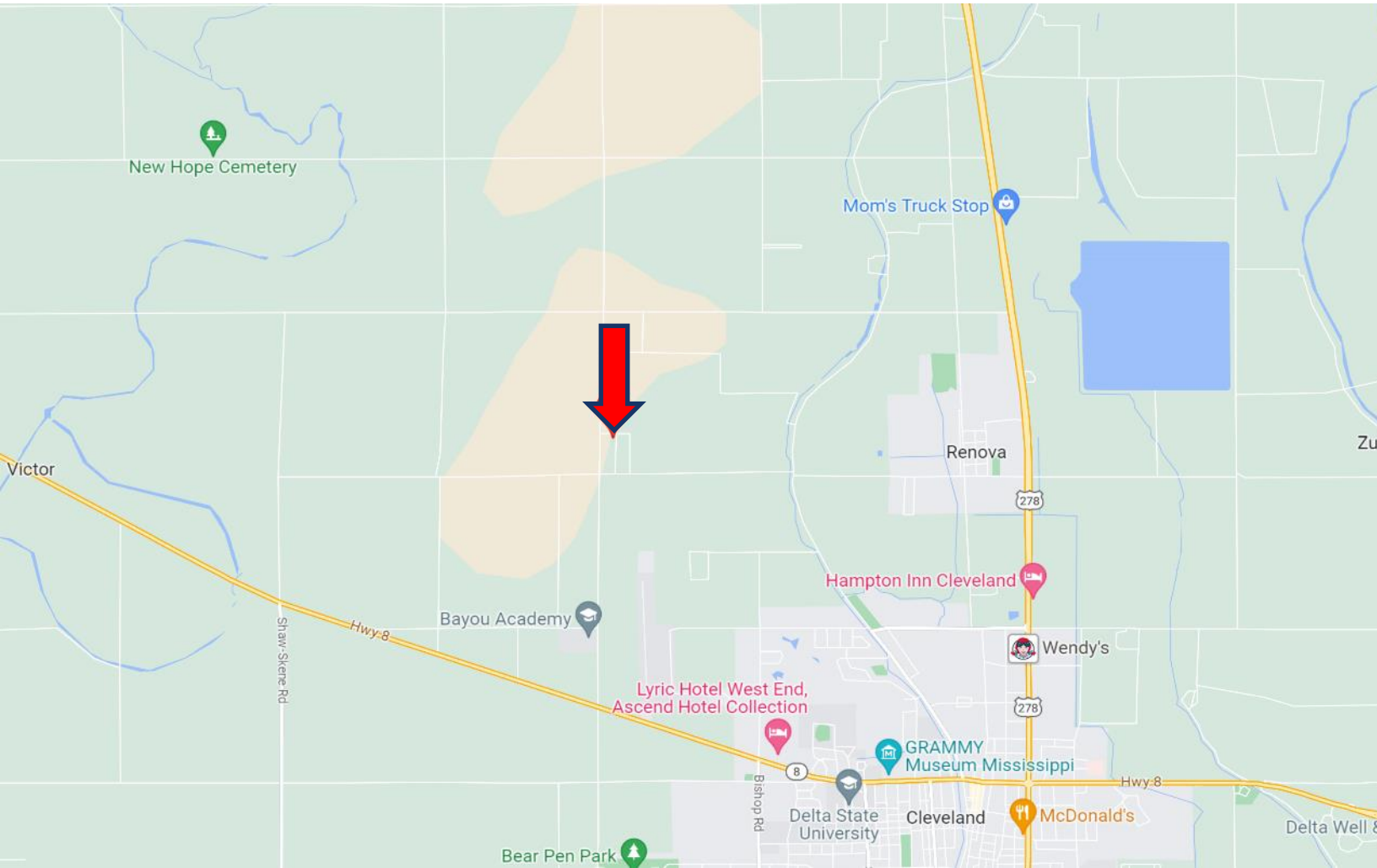

**Address: 49 Stanton Rd. Cleveland, MS 38732**

**Directions from HWY 61 and HWY 8 in Cleveland, MS:** Travel West on Hwy 8 for approximately 2.8 miles. Turn right onto Crosby Road and travel 1.8 miles. Turn right onto Thelma Road, then in 0.1 miles turn right onto Stanton Road. After 72 feet, the house will be on the right. [Click for Google Maps](#)



**ANTHONY  
STEEN**  
REALTOR®

Office: 662.441.2500

Cell: 662.645.5151

Anthony@TomSmithLand.com



Expect More. Get More.

**A Real Estate Expert You Can Trust**

TomSmithLandandHomes.com

Information is believed to be accurate but not guaranteed.

