

# Charming Brick Home

Bolivar County, MS



**\$235,000**

## 49 Stanton Road Cleveland, MS 38732

Discover this charming home situated North of Bayou Academy in Cleveland, Bolivar County, MS. This house offers two shops, one of which is an insulated 25x25 metal shop on a concrete slab providing plenty of space to store your toys. The big backyard has plenty of room for you and the family to get together. The house sits on 0.68+/- acres and has 2,190 sqft with four bedrooms, two and a half bathrooms, and a lovely sun room looking out the back yard. The primary bedroom features two walk-in closets and a jacuzzi tub. Call Anthony today for a private showing!

**Directions from HWY 61 and HWY 8 in Cleveland, MS:** Travel West on Hwy 8 for approximately 2.8 miles and turn right onto Crosby Road. Travel 1.8 miles then turn right onto Thelma Road. In 0.1 miles turn right onto Stanton Road. After 72 feet, the house will be on the right.



**ANTHONY  
STEEN**  
REALTOR®

Office: 662.441.2500

Cell: 662.645.5151

[Anthony@TomSmithLand.com](mailto:Anthony@TomSmithLand.com)



## A Real Estate Expert You Can Trust

[TomSmithLandandHomes.com](http://TomSmithLandandHomes.com)

Information is believed to be accurate but not guaranteed.







**ANTHONY STEEN**

REALTOR®

Office: 662.441.2500

Cell: 662.645.5151

[Anthony@TomSmithLand.com](mailto:Anthony@TomSmithLand.com)



**A Real Estate Expert You Can Trust**

[TomSmithLandandHomes.com](http://TomSmithLandandHomes.com)

Information is believed to be accurate but not guaranteed.





**ANTHONY STEEN**

REALTOR®

Office: 662.441.2500

Cell: 662.645.5151

Anthony@TomSmithLand.com



**A Real Estate Expert You Can Trust**

TomSmithLandandHomes.com

Information is believed to be accurate but not guaranteed.







**ANTHONY STEEN**  
 REALTOR®  
 Office: 662.441.2500  
 Cell: 662.645.5151  
[Anthony@TomSmithLand.com](mailto:Anthony@TomSmithLand.com)



**A Real Estate Expert You Can Trust**  
[TomSmithLandandHomes.com](http://TomSmithLandandHomes.com)

Information is believed to be accurate but not guaranteed.





# AERIAL MAP



[Click for Interactive Map](#)

**ANTHONY STEEN**  
REALTOR®

Office: 662.441.2500

Cell: 662.645.5151

Anthony@TomSmithLand.com



**A Real Estate Expert You Can Trust**  
TomSmithLandandHomes.com

Information is believed to be accurate but not guaranteed.



# OWNERSHIP MAP

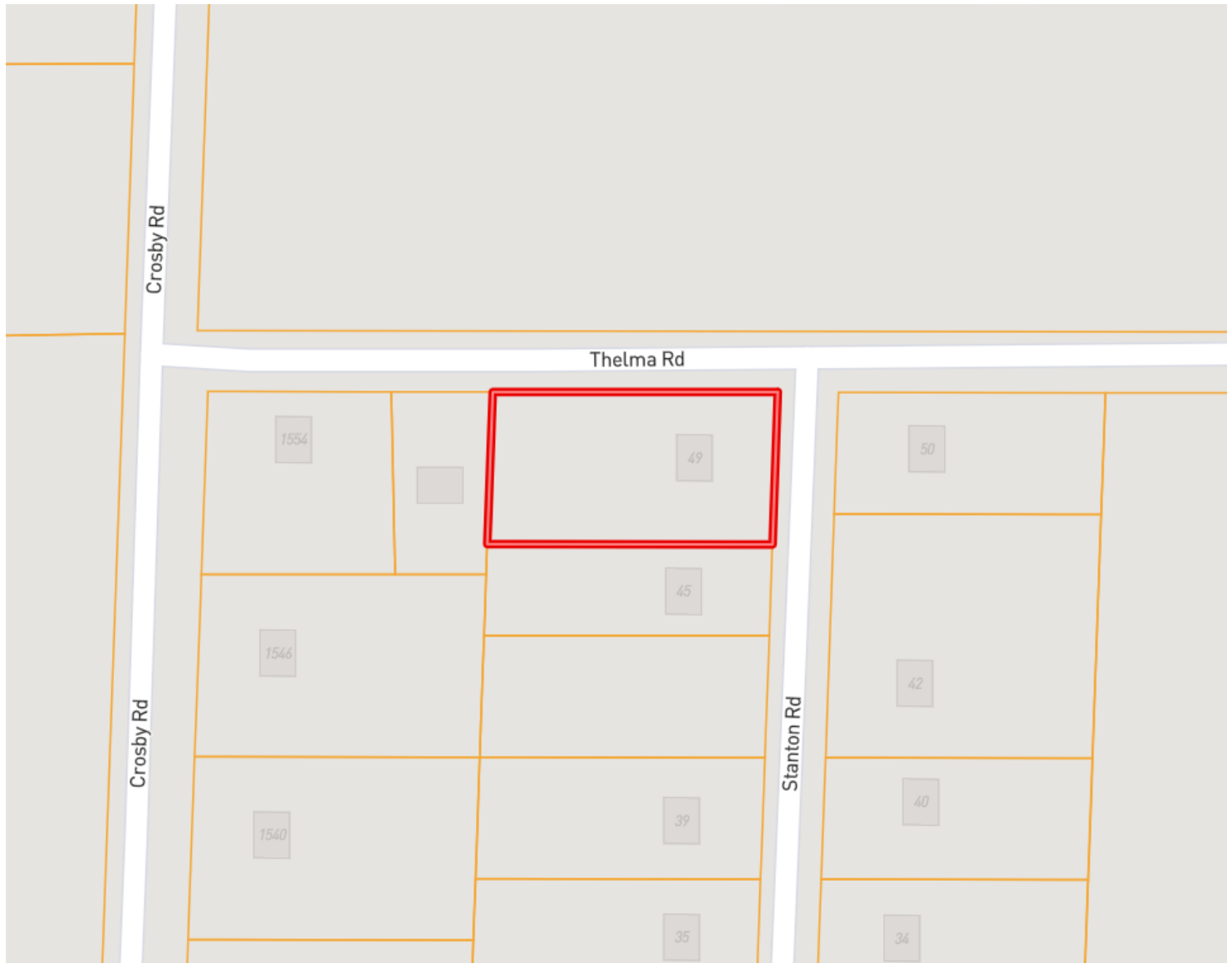

**ANTHONY STEEN**

REALTOR®

Office: 662.441.2500

Cell: 662.645.5151

Anthony@TomSmithLand.com



**A Real Estate Expert You Can Trust**

TomSmithLandandHomes.com

Information is believed to be accurate but not guaranteed.



# DIRECTIONAL MAP

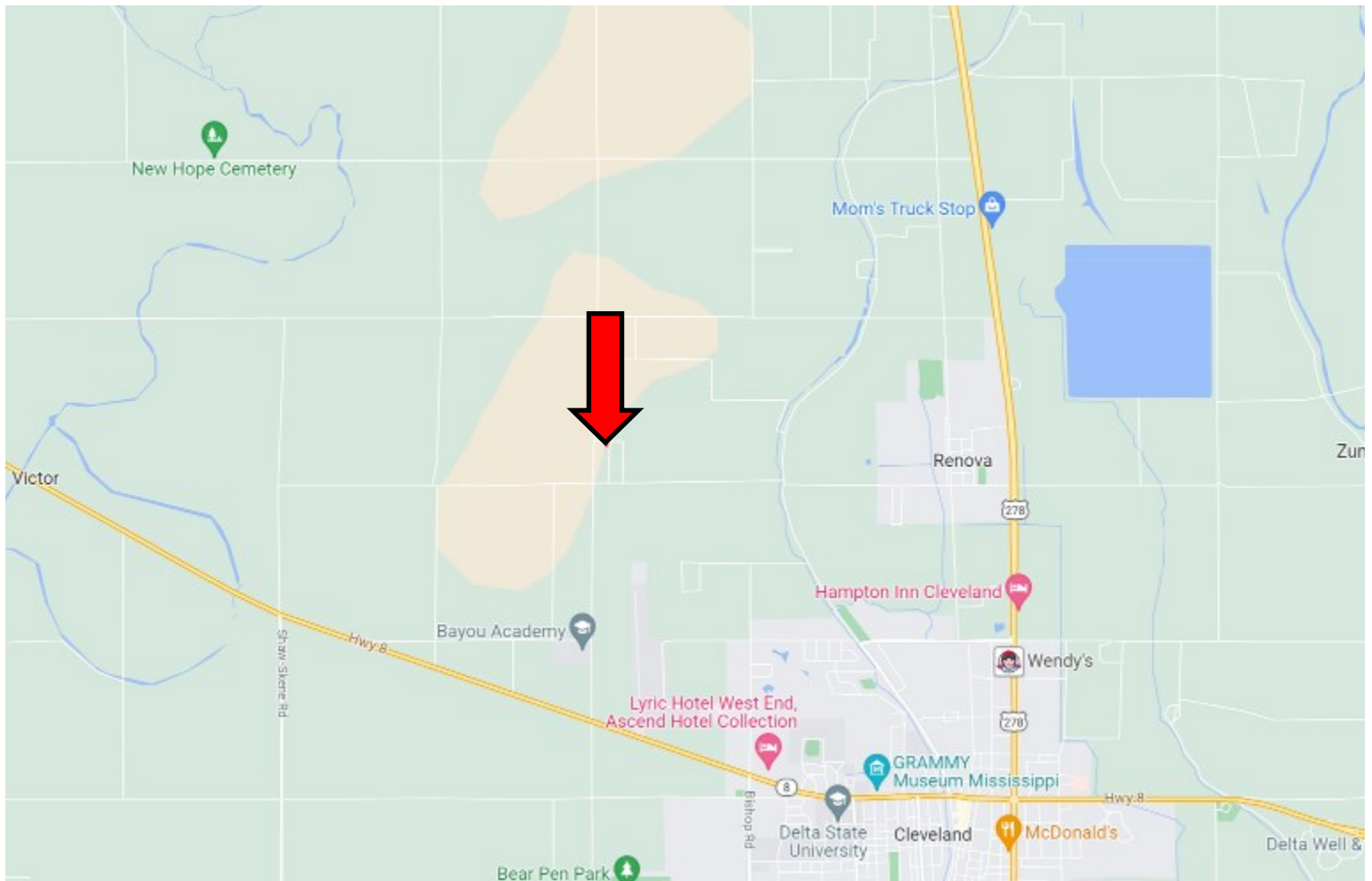

**Address: 49 Stanton Rd. Cleveland, MS 38732**

**Directions from HWY 61 and HWY 8 in Cleveland, MS:** Travel West on Hwy 8 for approximately 2.8 miles and turn right onto Crosby Road. Travel 1.8 miles then turn right onto Thelma Road. In 0.1 miles turn right onto Stanton Road. After 72 feet, the house will be on the right. [Click for Google Maps](#)



**ANTHONY  
STEEN**  
REALTOR®

Office: 662.441.2500

Cell: 662.645.5151

[Anthony@TomSmithLand.com](mailto:Anthony@TomSmithLand.com)



**A Real Estate Expert You Can Trust**

[TomSmithLandandHomes.com](http://TomSmithLandandHomes.com)

Information is believed to be accurate but not guaranteed.

