

SUNFLOWER COUNTY INVESTMENT PROPERTY

806 Second Street Inverness, MS 38753



This 0.29+/- acre commercial lot is 130x100 and located just off Old Highway 49 in Sunflower County, MS. This is an excellent potential spot for your business and commercial needs. Onsite is one large 1,980 sqft metal building with plenty of room for onsite improvements and parking. Concrete slab with two bay doors for loading and unloading make this a functional addition to your logistics in Inverness. Call Emerson today at 662-441-2500!

Directions from the intersection of Hwy 49 and Hwy 82 in Indianola, MS: Travel South on Hwy 49 for approximately 7.3 miles and turn right towards Old Hwy 49. Continue for 1 mile and turn right onto 2nd Street. After 167 feet, the property will be on the right. [Click for Google Maps](#)



Call me today!

EMERSON LOVELACE, REALTOR®
Emerson@TomSmithLand.com
662.441.2500 **office** | 662.715.3302 **cell**



TomSmithLandandHomes.com

Information is believed to be accurate but not guaranteed.

AERIAL MAP



[Click for Interactive Map](#)

Call me today!

EMERSON LOVELACE, REALTOR®
Emerson@TomSmithLand.com
662.441.2500 **office** | 662.715.3302 **cell**



TomSmithLandandHomes.com

Information is believed to be accurate but not guaranteed.

OWNERSHIP MAP

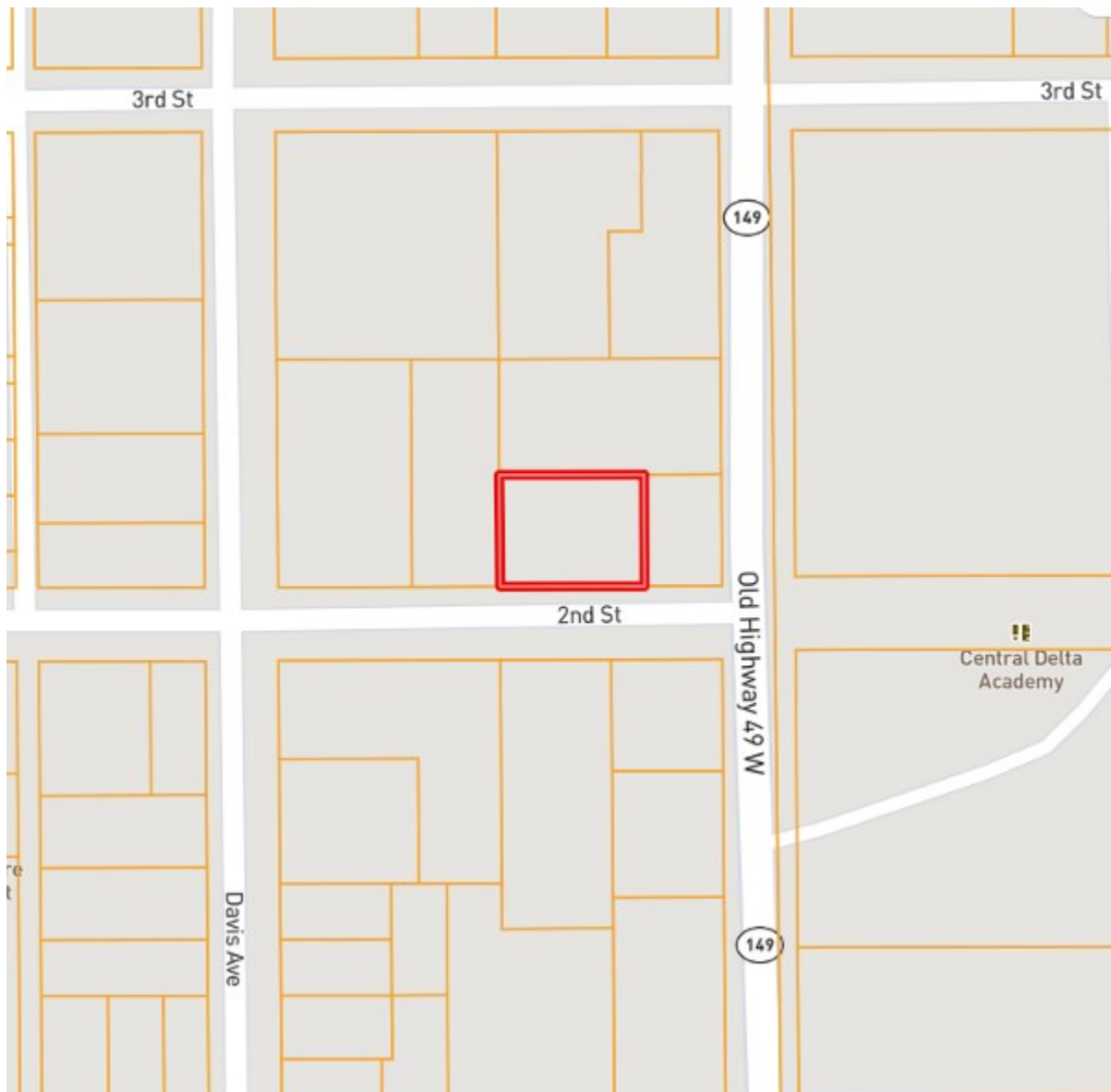

Call me today!

EMERSON LOVELACE, REALTOR®
Emerson@TomSmithLand.com
662.441.2500 **office** | 662.715.3302 **cell**



Expect More. Get More.

TomSmithLandandHomes.com

Information is believed to be accurate but not guaranteed.

DIRECTIONAL MAP

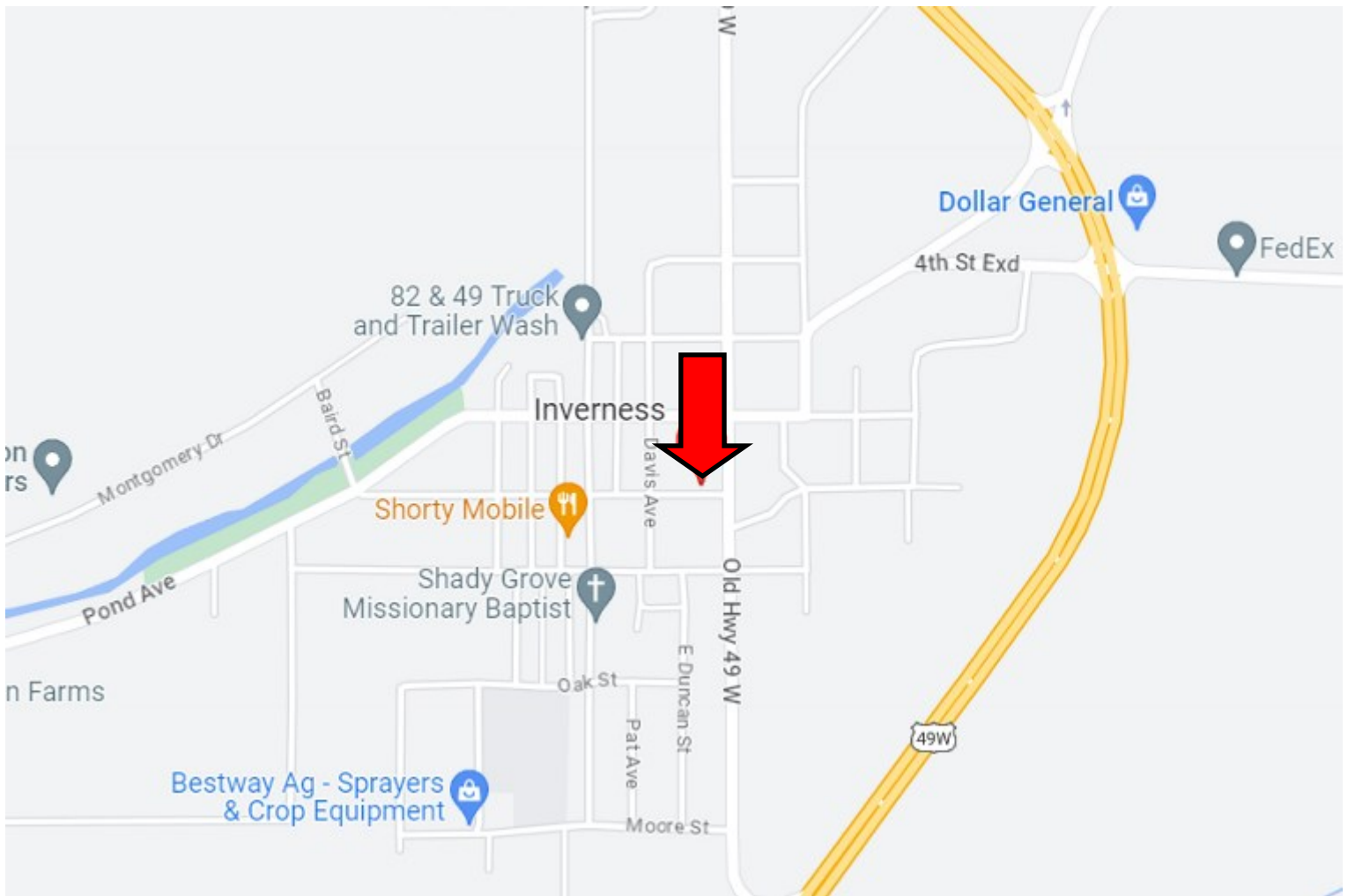

Address: 806 Second Street Inverness, MS 38753

Directions from the intersection of Hwy 49 and Hwy 82 in Indianola, MS: Travel South on Hwy 49 for approximately 7.3 miles and turn right towards Old Hwy 49. Continue for 1 mile and turn right onto 2nd Street. After 167 feet, the property will be on the right. [Click for Google Maps](#)



Call me today!

EMERSON LOVELACE, REALTOR®
Emerson@TomSmithLand.com
662.441.2500 **office** | 662.715.3302 **cell**



TomSmithLandandHomes.com

Information is believed to be accurate but not guaranteed.