



# Beautiful Indianola Home Sunflower County, MS

411 West Augusta Street Indianola, MS 38751



**\$140,000**

Discover this wonderful four-bedroom, three-bath home in the heart of Sunflower County, MS, just a few blocks from downtown Indianola. With a generous 2,400 sqft of space, this residence features twelve-foot ceilings, stainless steel appliances, and beautiful hardwood floors throughout. The two-car covered carport and spacious 0.45± acre lot add practicality and room for outdoor enjoyment. Take advantage of the opportunity to make this your family's new home. Schedule a private showing with Emerson today by giving him a call. You won't want to let this home slip away!

**Directions from the intersection of Hwy 49 & Hwy 82 in Indianola, MS:** Travel West on Highway 82 for 1.5 miles. Turn left onto Marie Ave and travel 0.2 miles. Turn left onto W. Augusta Street. After 62 feet, the house will be on the right. [Click for Google Maps](#)



*Call me today!*

**EMERSON LOVELACE, REALTOR®**  
Emerson@TomSmithLand.com  
662.441.2500 **office** | 662.715.3302 **cell**



**TomSmithLandandHomes.com**

Information is believed to be accurate but not guaranteed.



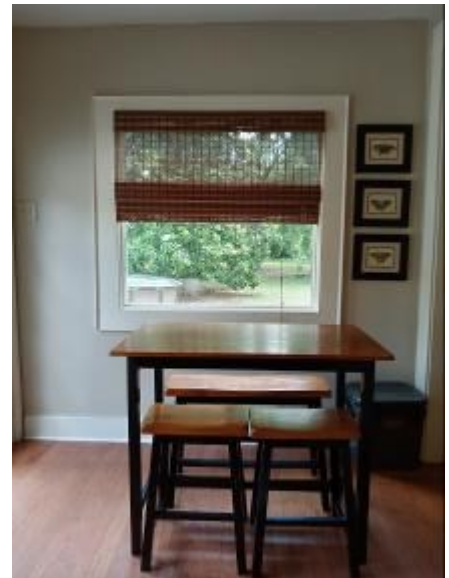

*Call me today!*

**EMERSON LOVELACE, REALTOR®**  
 Emerson@TomSmithLand.com  
 662.441.2500 **office** | 662.715.3302 **cell**



**TomSmithLandandHomes.com**

Information is believed to be accurate but not guaranteed.





*Call me today!*

**EMERSON LOVELACE, REALTOR®**  
 Emerson@TomSmithLand.com  
 662.441.2500 **office** | 662.715.3302 **cell**



**TomSmithLandandHomes.com**

Information is believed to be accurate but not guaranteed.

# Aerial Map



[Click for Interactive Map](#)

*Call me today!*

**EMERSON LOVELACE**, REALTOR®  
Emerson@TomSmithLand.com  
662.441.2500 **office** | 662.715.3302 **cell**



**TomSmithLandandHomes.com**

Information is believed to be accurate but not guaranteed.



# Ownership Map

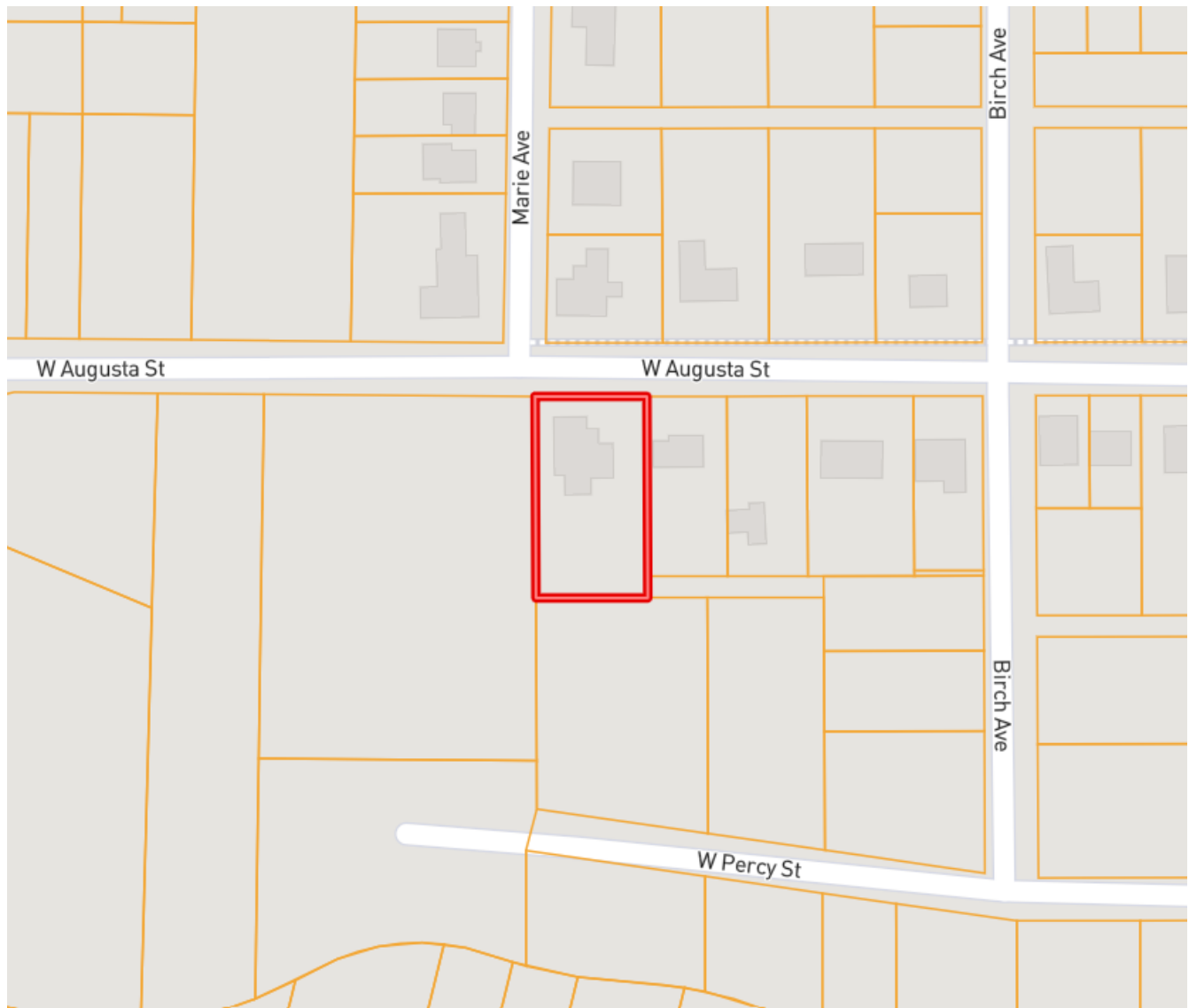

*Call me today!*

**EMERSON LOVELACE**, REALTOR®  
Emerson@TomSmithLand.com  
662.441.2500 **office** | 662.715.3302 **cell**



**TomSmithLandandHomes.com**

Information is believed to be accurate but not guaranteed.

# Directional Map

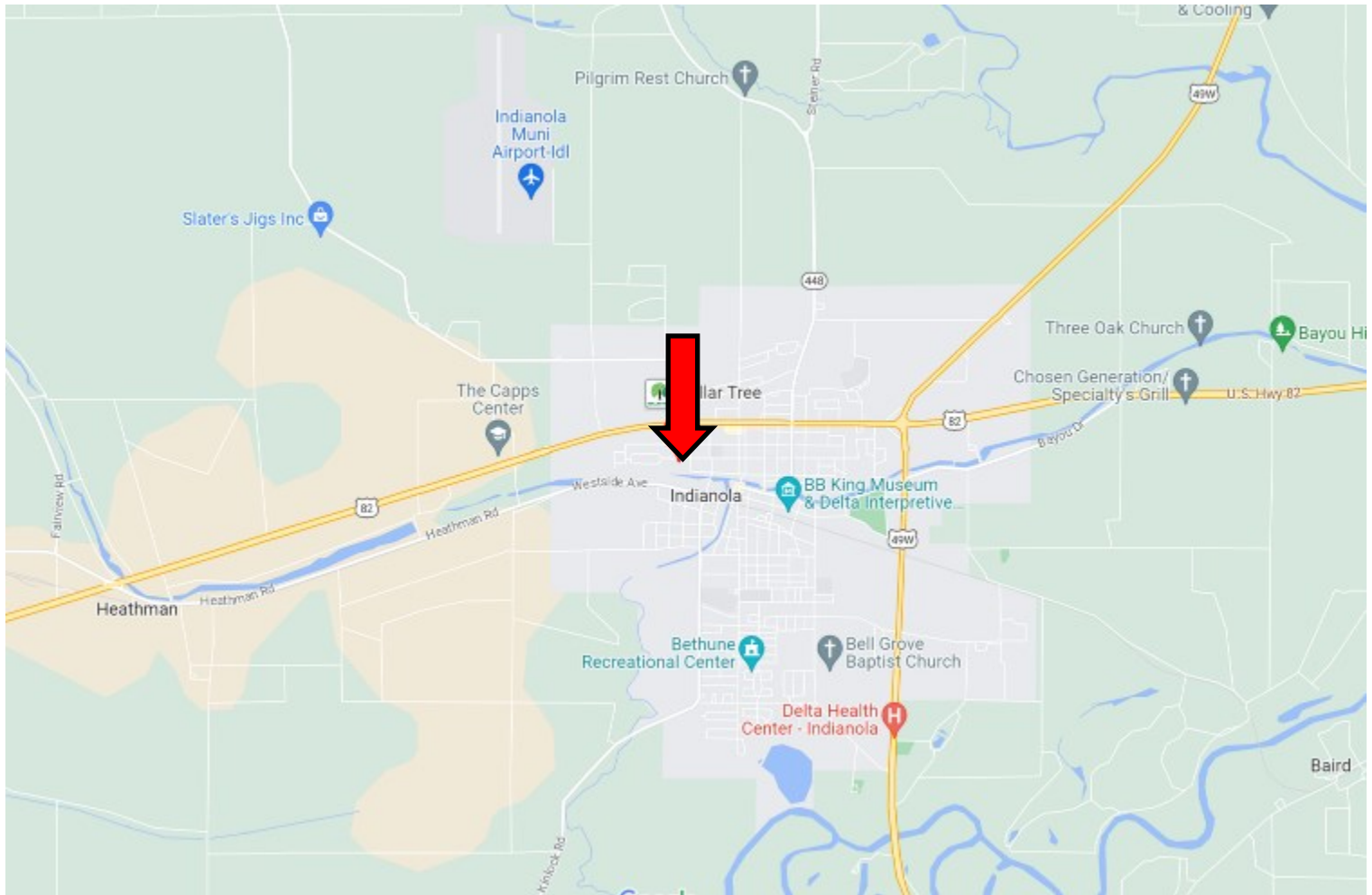

**411 West Augusta St. Indianola, MS 38751**

**Directions from the intersection of Hwy 49 & Hwy 82 in Indianola, MS:** Travel West on Highway 82 for 1.5 miles. Turn left onto Marie Ave and travel 0.2 miles. Turn left onto W. Augusta Street. After 62 feet, the house will be on the right.

[Click for Google Maps](#)

*Call me today!*

**EMERSON LOVELACE, REALTOR®**  
Emerson@TomSmithLand.com  
662.441.2500 **office** | 662.715.3302 **cell**



**TomSmithLandandHomes.com**

Information is believed to be accurate but not guaranteed.