

# Lot 4 Sunset Estates Bolivar County, MS



**\$36,000**

## Lot 4 Cannon Drive Cleveland, MS 38732

Discover your perfect country home site on this spacious 1.70± acre lot located just North of Cleveland in beautiful Bolivar County, MS. This secluded property rests off a peaceful road, offering an ideal setting for your forever home. With multiple available lots, seize the opportunity to build dream home you've always wanted. Call Anthony now to secure your dream property!

**Directions from HWY 8 and Hwy 61 in Cleveland, MS:** Travel North on Hwy 61 for approximately 3.1 miles. Turn left onto Township Rd. and travel 1.2 miles. Turn left at the 3rd cross street onto Cannon Rd. After 0.1 miles, the lot will be on the right. [Click for Google Maps](#)



**ANTHONY  
STEEN**  
REALTOR®

Office: 662.441.2500

Cell: 662.645.5151

[Anthony@TomSmithLand.com](mailto:Anthony@TomSmithLand.com)



## A Real Estate Expert You Can Trust

[TomSmithLandandHomes.com](http://TomSmithLandandHomes.com)

Information is believed to be accurate but not guaranteed.





## AERIAL MAP

[Click Here for an Interactive Map](#)

**ANTHONY STEEN**

REALTOR®

Office: 662.441.2500

Cell: 662.645.5151

Anthony@TomSmithLand.com



**A Real Estate Expert You Can Trust**

TomSmithLandandHomes.com

Information is believed to be accurate but not guaranteed.



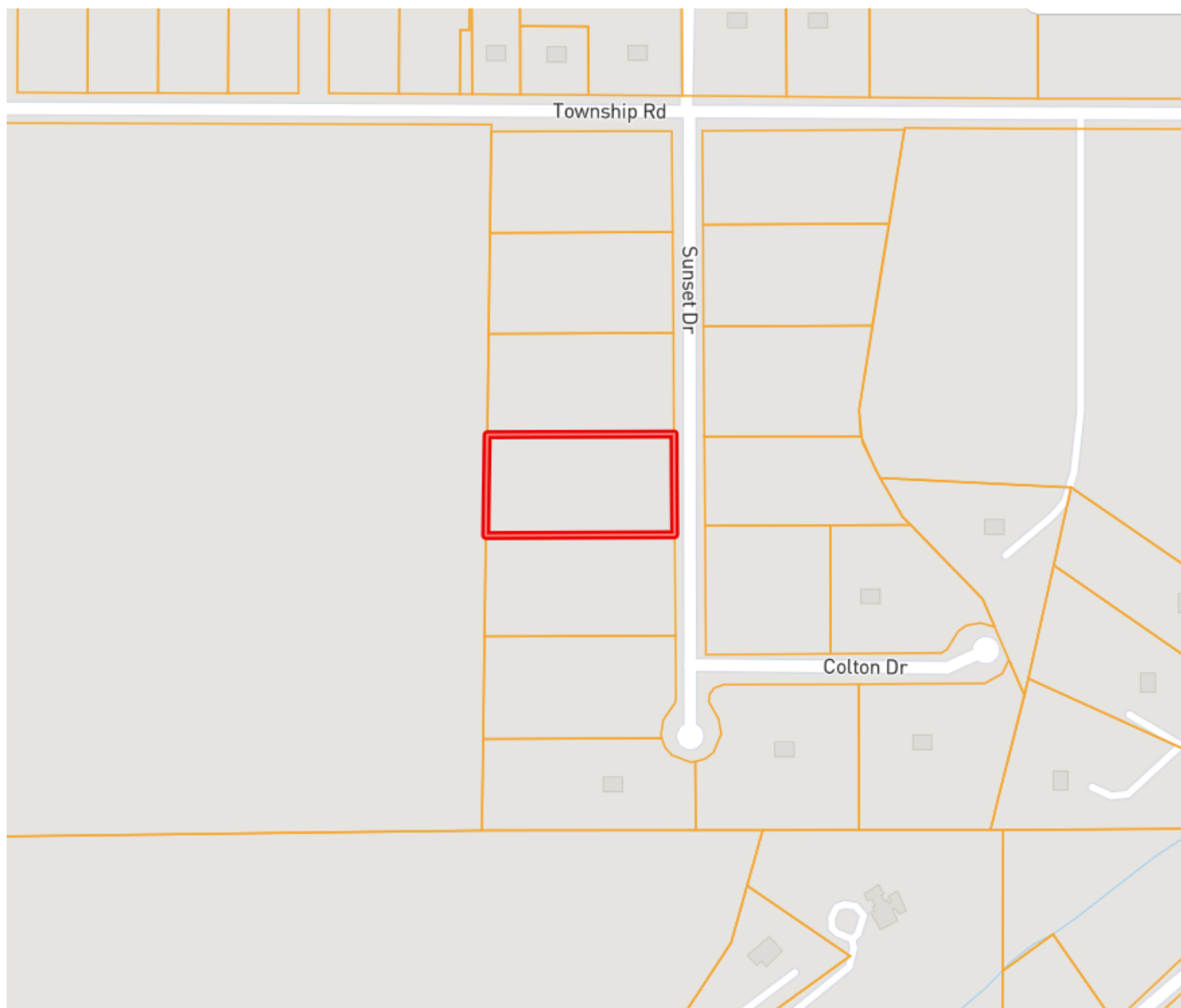

## OWNERSHIP MAP

**ANTHONY STEEN**

REALTOR®

Office: 662.441.2500

Cell: 662.645.5151

[Anthony@TomSmithLand.com](mailto:Anthony@TomSmithLand.com)



**A Real Estate Expert You Can Trust**

[TomSmithLandandHomes.com](http://TomSmithLandandHomes.com)

Information is believed to be accurate but not guaranteed.





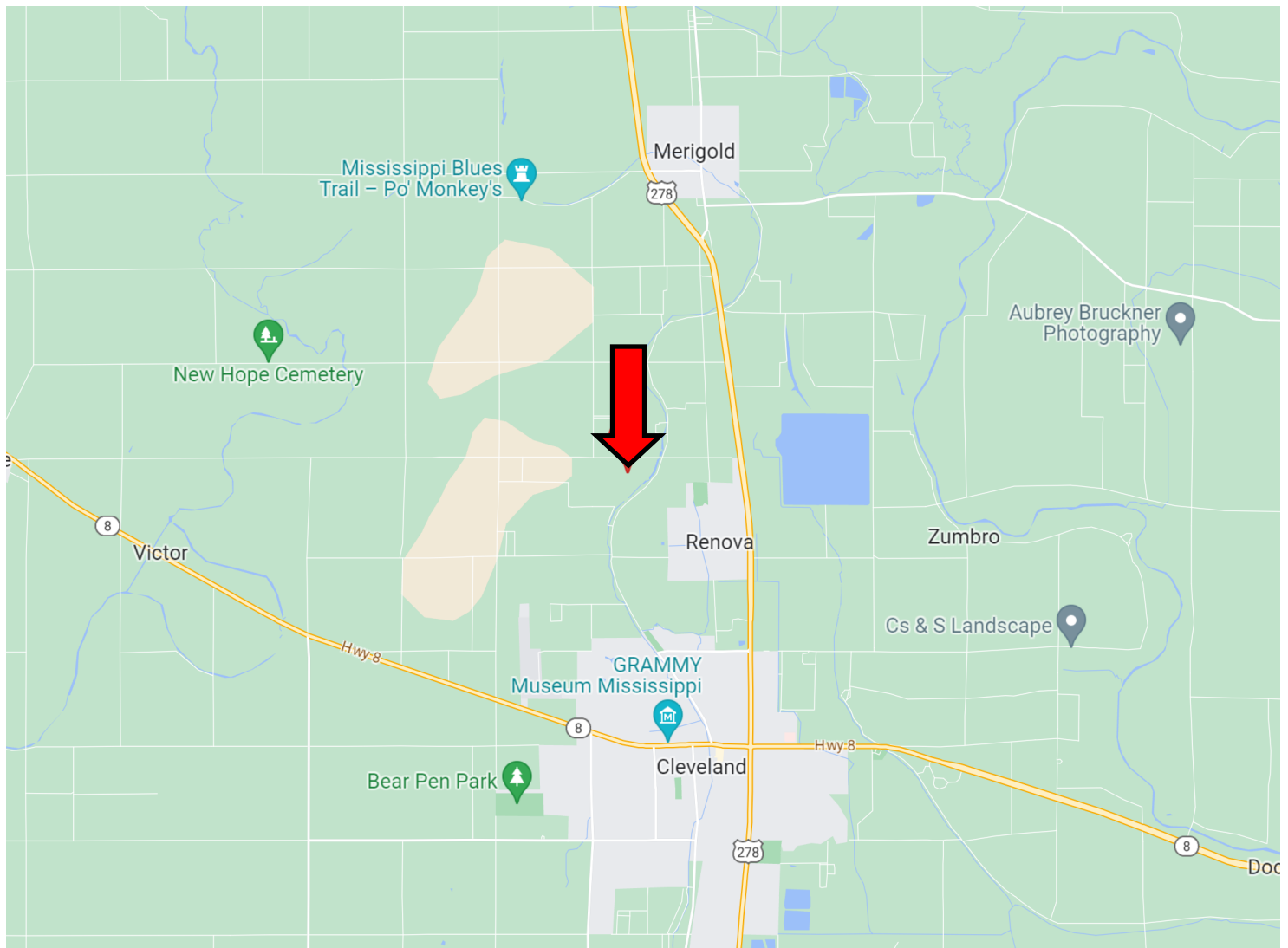

## DIRECTIONAL MAP

### Lot 4 Cannon Drive Cleveland, MS 38732

**Directions from HWY 8 and Hwy 61 in Cleveland, MS:** Travel North on Hwy 61 for approximately 3.1 miles. Turn left onto Township Rd. and travel 1.2 miles. Turn left at the 3rd cross street onto Cannon Rd. After 0.1 miles, the lot will be on the right. [Click for Google Maps](#)



**ANTHONY  
STEEN**  
REALTOR®

Office: 662.441.2500

Cell: 662.645.5151

[Anthony@TomSmithLand.com](mailto:Anthony@TomSmithLand.com)



**A Real Estate Expert You Can Trust**

[TomSmithLandandHomes.com](http://TomSmithLandandHomes.com)

Information is believed to be accurate but not guaranteed.

