

1.54± Acre Commercial Lot on HWY 61 in Bolivar County
1418 HWY 61 S. Cleveland, MS 38732
\$90,000



This 1.54± acre lot boasts 210 feet of frontage along the bustling HWY 61/South Davis Avenue in Cleveland, MS. Featuring two paved entrances, it presents a versatile canvas for your business development ambitions. Give Charlie a call for additional details on this Bolivar County Commercial Property!



**CHARLIE
HEINSZ**
REALTOR®

Office: 662.441.2500
Cell: 662.719.7218
Charlie@TomSmithLand.com



A Real Estate Expert You Can Trust

TomSmithLandandHomes.com

Information is believed to be accurate but not guaranteed.



AERIAL MAP



[Click for Interactive Map](#)

CHARLIE HEINSZ
REALTOR®

Office: 662.441.2500

Cell: 662.719.7218

Charlie@TomSmithLand.com



A Real Estate Expert You Can Trust
TomSmithLandandHomes.com

Information is believed to be accurate but not guaranteed.



OWNERSHIP MAP

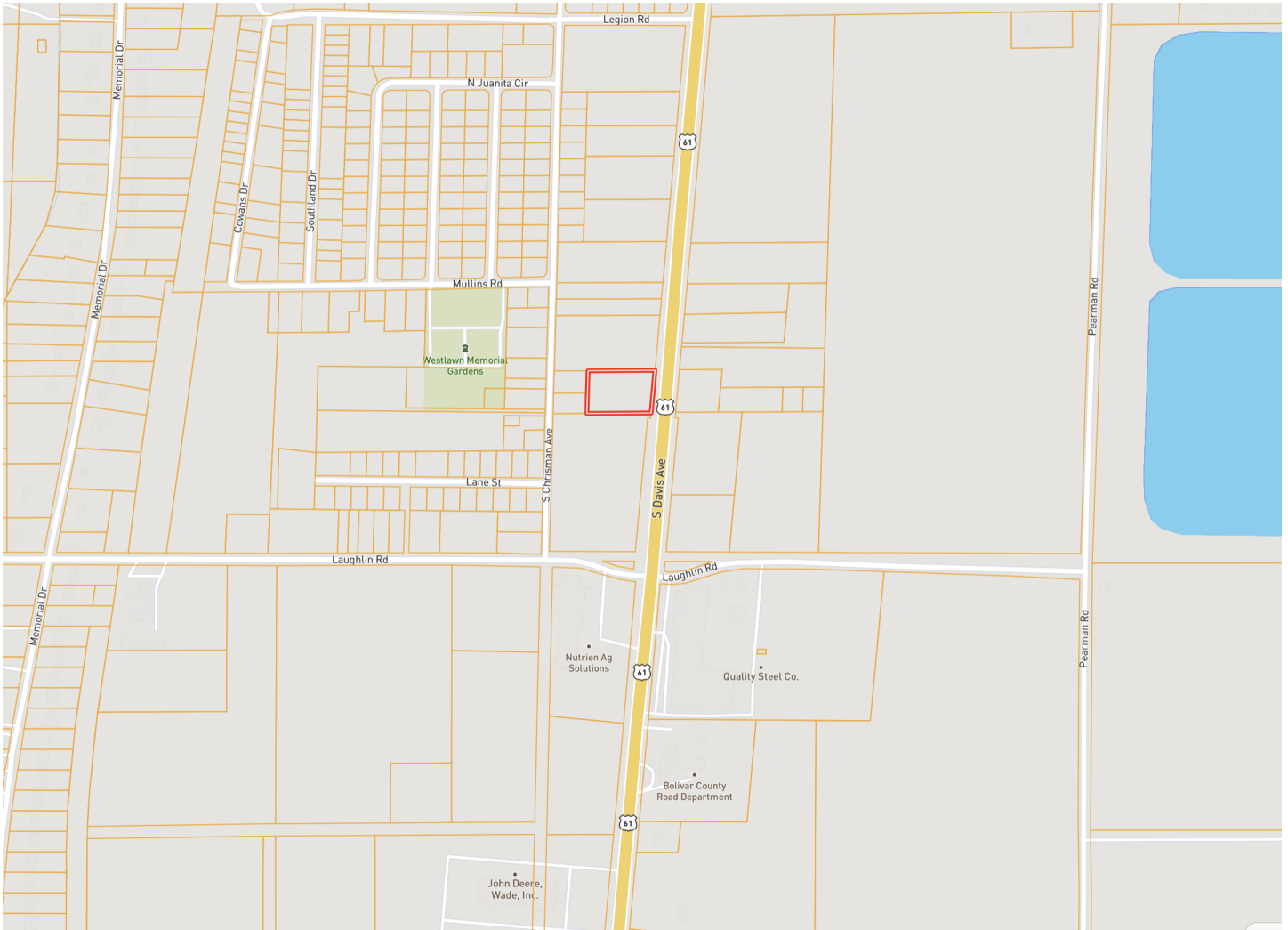

CHARLIE HEINSZ
REALTOR®

Office: 662.441.2500

Cell: 662.719.7218

Charlie@TomSmithLand.com



A Real Estate Expert You Can Trust
TomSmithLandandHomes.com

Information is believed to be accurate but not guaranteed.



DIRECTIONAL MAP

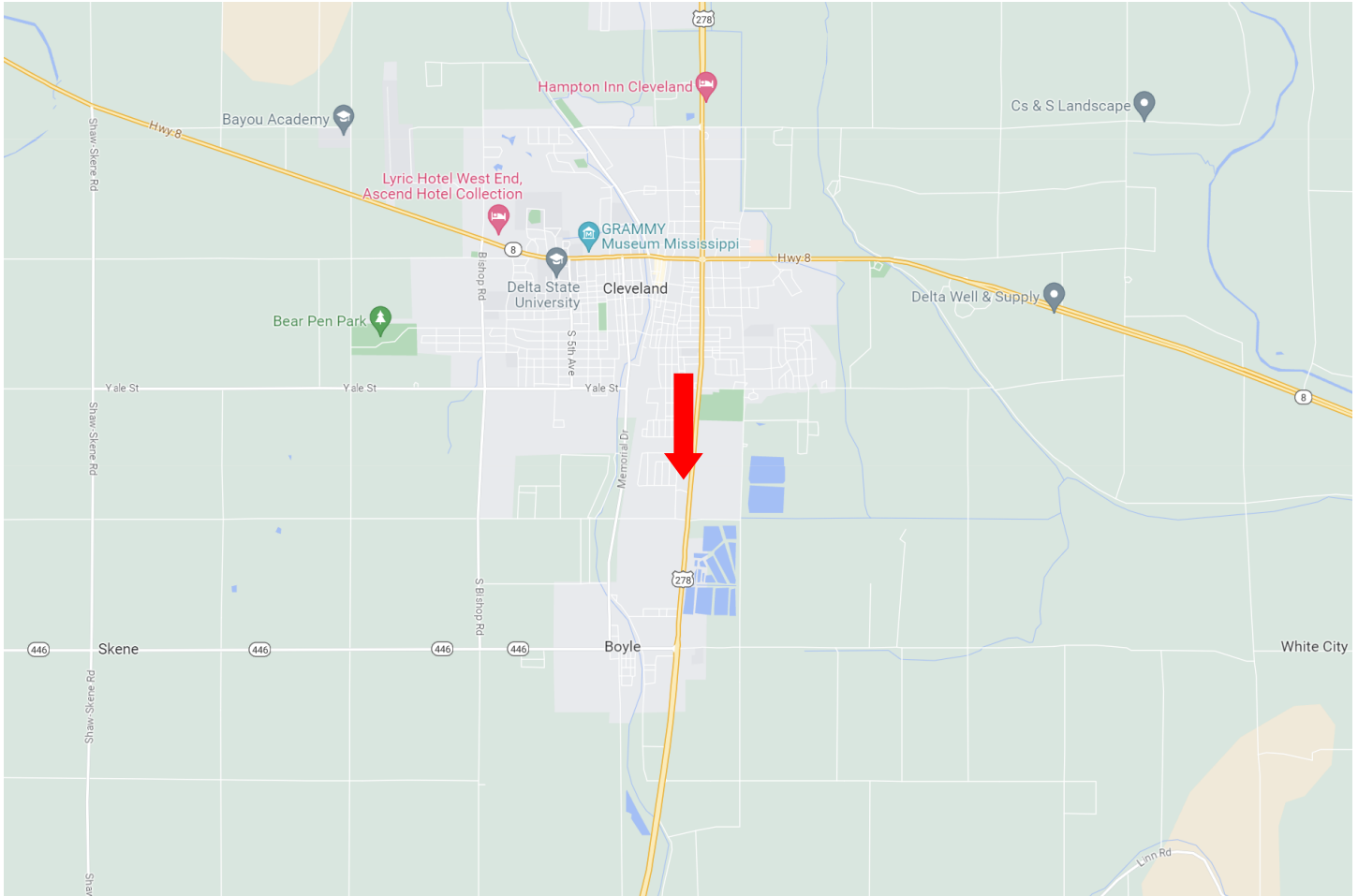

ADDRESS: 1418 HWY 61 S., Cleveland, MS 38732

Directions from the Intersection of Hwy 8 and Hwy 61 in Cleveland, MS: Travel south on Hwy 61 toward Boyle for 1.9 miles, and the property will be on your right. [Google Map Link](#)



**CHARLIE
HEINSZ**
REALTOR®

Office: 662.441.2500

Cell: 662.719.7218

Charlie@TomSmithLand.com



A Real Estate Expert You Can Trust

TomSmithLandandHomes.com

Information is believed to be accurate but not guaranteed.

