

LUXURIOUS ESTATE ON 20± ACRES MADISON COUNTY, MS



 VIRTUAL TOUR

619 Old Agency Road Ridgeland, MS 39157

\$1,699,999

- 20± Acre Family Estate in Madison County, MS
- 4,552 SF 4 Bed/3.5 Bath Home
- Extensive Outdoor Living Spaces
- Grand Entrance, Spacious Living Areas, and 12ft Ceilings
- Gourmet Kitchen with Modern Appliances, a Center Island, and Plenty of Storage
- Large Living and Dining Areas Designed for Comfortable Living and Entertaining
- Primary Suite has a Private Bathroom, Walk-in Closets, and Sitting Area with a Fireplace
- Additional Bedrooms have Private Bathrooms Providing Comfort and Privacy
- Additional Bedroom/Flex Room Currently Utilized as Office
- Dazzling Pool with Hot Tub, Fountain, Lounge Area and an Outdoor Shower
- Stone Pond with Multiple Stone Waterfalls
- Small Lake at the Back of the Property Ideal for Fishing
- Mature Trees, Open Spaces, Abundant Wildlife and Possibilities for Outdoor Adventures
- Located on Old Agency Road in Ridgeland, with the Convenience of Nearby Amenities, and Shopping



**ALLYSON
MIZE**
REALTOR®

Office: 601.898.2772

Cell: 662.607.1703

Allyson@TomSmithLand.com



A Real Estate Expert You Can Trust

TomSmithLandandHomes.com

Information is believed to be accurate but not guaranteed.





This exceptional 4,552 sq ft, five-bedroom, three-and-a-half bath home is located on 20± picturesque acres and offers elegance, comfort, and unbelievable beauty in Madison County, MS. The seller has gone above and beyond with excellent structural quality and craftsmanship. Located in the heart of Ridgeland, MS, this private oasis combines spacious living with serene outdoor spaces, making it a dream retreat for those seeking both luxury and tranquility. This unique property in Ridgeland, MS, presents an unparalleled opportunity for those who appreciate the finer things in life and the allure of expansive, private grounds. For more information and to schedule a private tour, contact Allyson today. Take advantage of this chance to experience the best of Mississippi living!



**ALLYSON
MIZE**
REALTOR®

Office: 601.898.2772

Cell: 662.607.1703

Allyson@TomSmithLand.com



A Real Estate Expert You Can Trust

TomSmithLandandHomes.com

Information is believed to be accurate but not guaranteed.





**ALLYSON
MIZE**
REALTOR®

Office: 601.898.2772

Cell: 662.607.1703

Allyson@TomSmithLand.com



A Real Estate Expert You Can Trust

TomSmithLandandHomes.com

Information is believed to be accurate but not guaranteed.





**ALLYSON
MIZE**
REALTOR®

Office: 601.898.2772

Cell: 662.607.1703

Allyson@TomSmithLand.com



A Real Estate Expert You Can Trust

TomSmithLandandHomes.com

Information is believed to be accurate but not guaranteed.





**ALLYSON
MIZE**
REALTOR®

Office: 601.898.2772

Cell: 662.607.1703

Allyson@TomSmithLand.com



A Real Estate Expert You Can Trust

TomSmithLandandHomes.com

Information is believed to be accurate but not guaranteed.





**ALLYSON
MIZE**
REALTOR®

Office: 601.898.2772

Cell: 662.607.1703

Allyson@TomSmithLand.com



A Real Estate Expert You Can Trust

TomSmithLandandHomes.com

Information is believed to be accurate but not guaranteed.





**ALLYSON
MIZE**
REALTOR®

Office: 601.898.2772

Cell: 662.607.1703

Allyson@TomSmithLand.com



A Real Estate Expert You Can Trust

TomSmithLandandHomes.com

Information is believed to be accurate but not guaranteed.





**ALLYSON
MIZE**
REALTOR®

Office: 601.898.2772

Cell: 662.607.1703

Allyson@TomSmithLand.com



A Real Estate Expert You Can Trust

TomSmithLandandHomes.com

Information is believed to be accurate but not guaranteed.





**ALLYSON
MIZE**
REALTOR®

Office: 601.898.2772

Cell: 662.607.1703

Allyson@TomSmithLand.com



A Real Estate Expert You Can Trust

TomSmithLandandHomes.com

Information is believed to be accurate but not guaranteed.





**ALLYSON
MIZE**
REALTOR®

Office: 601.898.2772

Cell: 662.607.1703

Allyson@TomSmithLand.com



A Real Estate Expert You Can Trust

TomSmithLandandHomes.com

Information is believed to be accurate but not guaranteed.



OWNERSHIP MAP



**ALLYSON
MIZE**
REALTOR®

Office: 601.898.2772

Cell: 662.607.1703

Allyson@TomSmithLand.com



A Real Estate Expert You Can Trust

TomSmithLandandHomes.com

Information is believed to be accurate but not guaranteed.



AERIAL MAP



[CLICK HERE FOR AN INTERACTIVE MAP LINK](#)



**ALLYSON
MIZE**
REALTOR®

Office: 601.898.2772

Cell: 662.607.1703

Allyson@TomSmithLand.com



A Real Estate Expert You Can Trust

TomSmithLandandHomes.com

Information is believed to be accurate but not guaranteed.



TOPOGRAPHY MAP

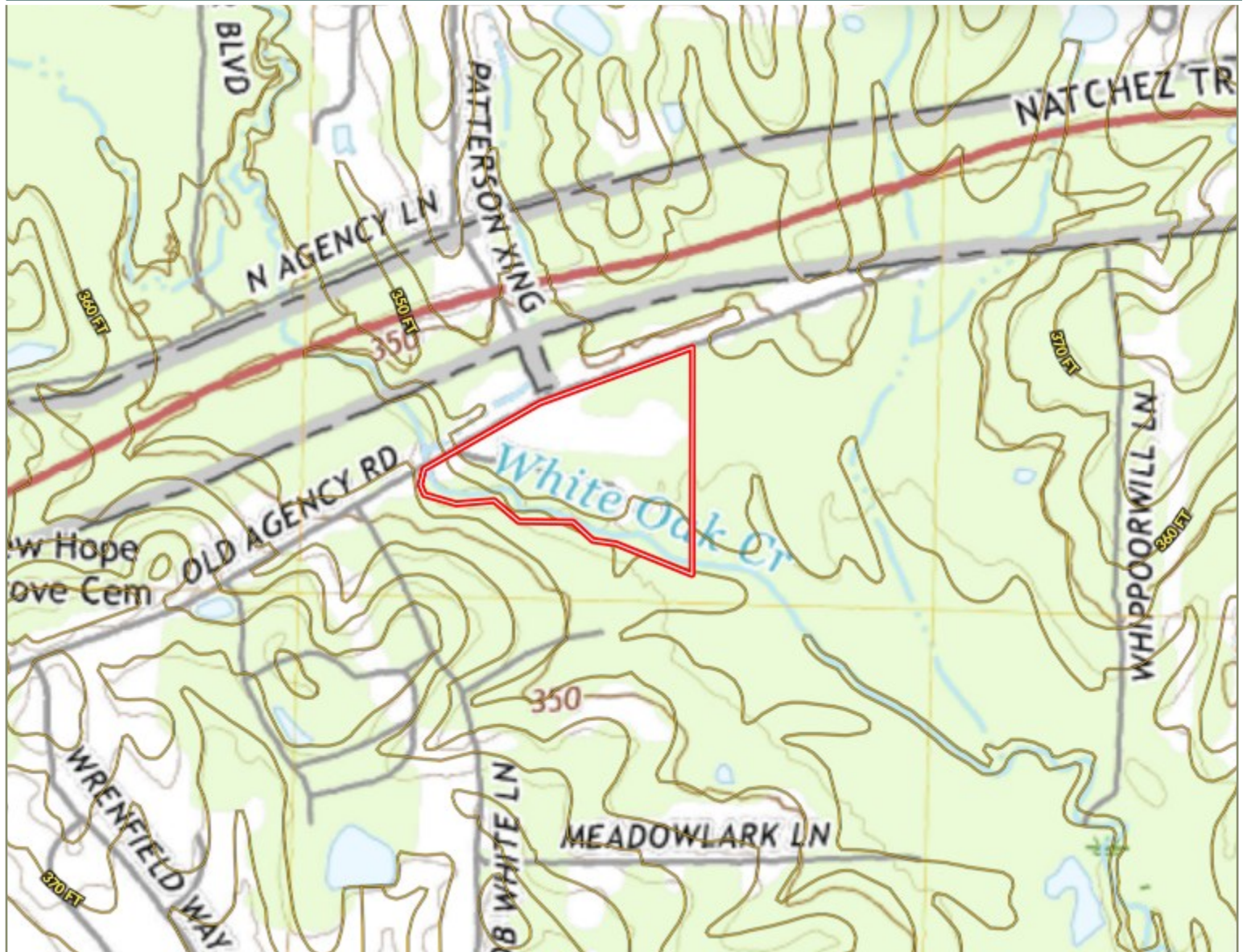

**ALLYSON
MIZE**
REALTOR®

Office: 601.898.2772

Cell: 662.607.1703

Allyson@TomSmithLand.com



A Real Estate Expert You Can Trust

TomSmithLandandHomes.com

Information is believed to be accurate but not guaranteed.



DIRECTIONAL MAP

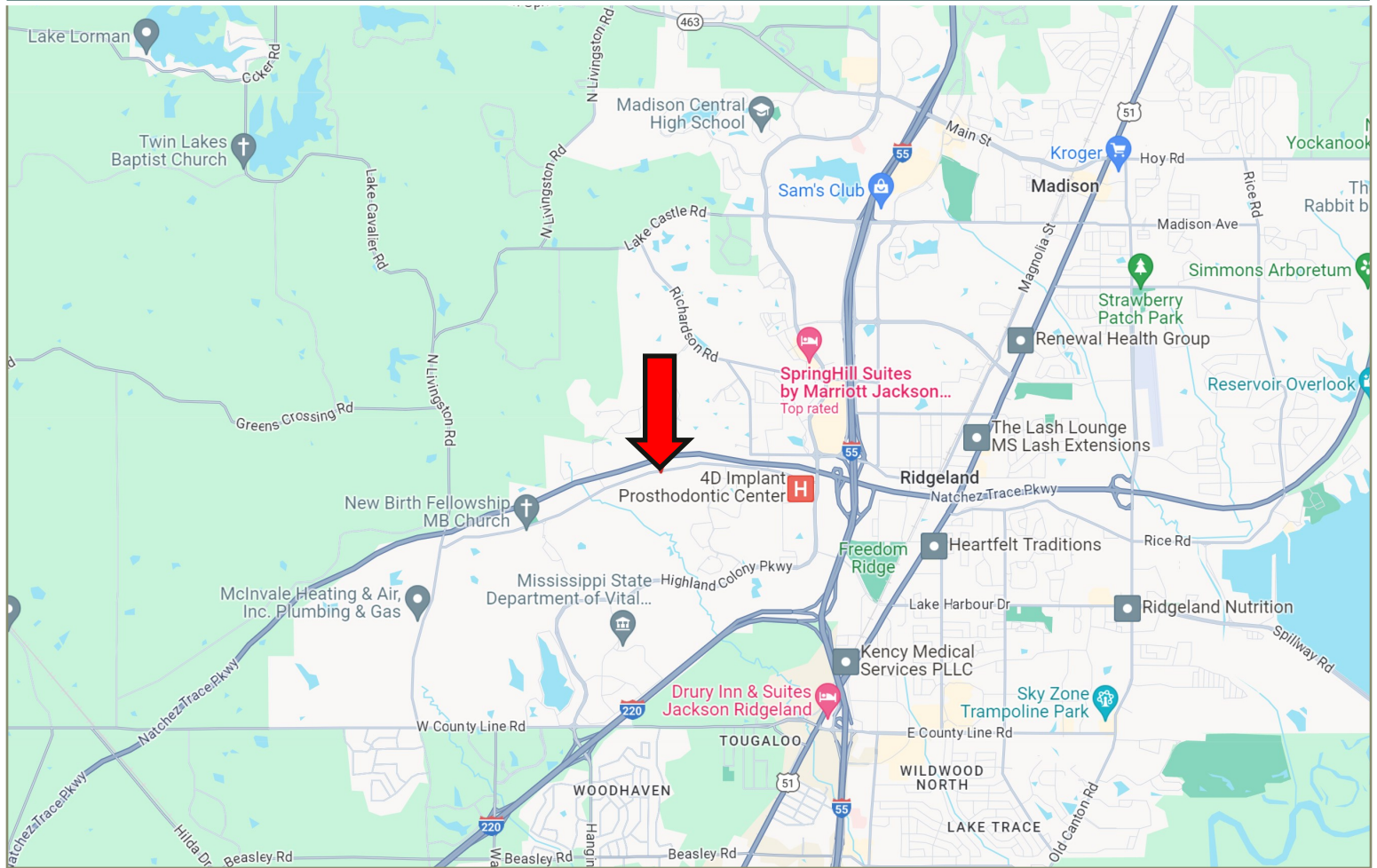

DIRECTIONS FROM I-55 AND OLD AGENCY ROAD IN RIDGELAND, MS: Take exit 105B towards Ridgeland and turn left onto Old Agency Road. Travel .4 miles and at the traffic circle take the third exit onto Highland Colony Parkway. Turn right onto Old Agency Parkway and travel 1.3 miles. The entrance to the property will be on the left.

[619 Old Agency Road Ridgeland, MS 39157—Click for Google Map Link](#)



**ALLYSON
MIZE**
REALTOR®

Office: 601.898.2772

Cell: 662.607.1703

Allyson@TomSmithLand.com



A Real Estate Expert You Can Trust

TomSmithLandandHomes.com

Information is believed to be accurate but not guaranteed.

