



Dedicated to Land and Landowners Since 1946  
SALES | AUCTIONS | FINANCE | APPRAISALS | MANAGEMENT

## HICKERT RANCH | YUMA, COLORADO | \$9,000,000



### EXECUTIVE SUMMARY

The Hickert Ranch offers an outstanding opportunity for a person looking for a good cow-calf ranch or feeder cattle ranch that is ready to go. The 6,274± acres of the 9,656± acre property are under a grazing CRP contract that provides a dual entity property owner \$100,000 of yearly income while at the same time allowing for grazing. The balance of the property consists of 3,382± acres of state land. A new scale has been installed allowing the new owner to weigh cattle coming and going right on the property. Corrals and the feeding facility are first-rate pipe built and include 1,200± feet of bunk space. The shop buildings are all fully insulated with numerous extras right where you need them. There is also a well-thought-out horse facility with all the extras. There are two recently remodeled homes at the headquarters that can be used for ranch labor or guest quarters. The main house is new construction carefully planned for infinite possibilities. This is truly a unique Colorado ranch that will provide income and pride of ownership.

This information is subject to errors, omissions, prior sale, change, withdrawal and approval of purchase by owner. All information from sources deemed reliable but it is not guaranteed by Hall and Hall. A partner at Hall and Hall is the agent of the Seller. A full disclosure of our agency relationships is included in the property brochure available at [www.hallandhall.com](http://www.hallandhall.com) or by contacting the Listing Broker.



Dedicated to Land and Landowners Since 1946  
SALES | AUCTIONS | FINANCE | APPRAISALS | MANAGEMENT

## JUST THE FACTS

- 9,656± acres (6,274± deeded; 3,382± state land)
  - CRP grazing income
  - Great hunting possibilities
- New executive home with four car garage
  - New bunk house
- Insulated shop with meeting quarters, kitchen, and many extras
  - Horse vet facility with pipe fence and Ritchie waterers
- 1,200-foot bunk space feeding facility with pipe corrals, loading chute, and working corrals

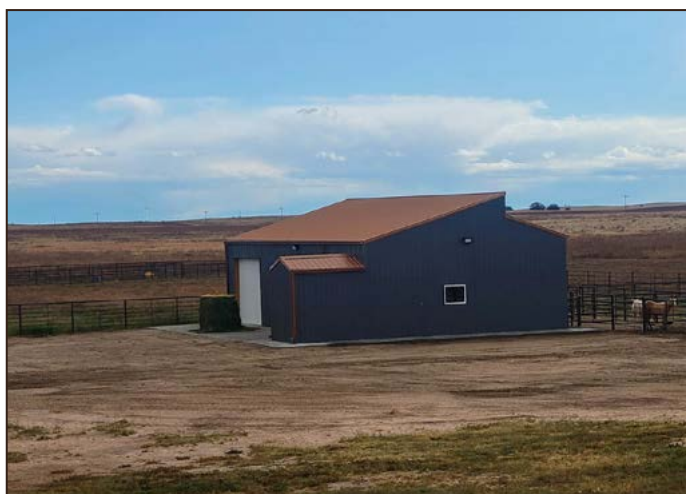

SCOTT SHUMAN | [scott@hallandhall.com](mailto:scott@hallandhall.com)  
100 SOUTH CHERRY AVE., UNIT 5B | EATON, CO 80615  
(O) 970-716-2120 | (M) 970-631-7009

This information is subject to errors, omissions, prior sale, change, withdrawal and approval of purchase by owner. All information from sources deemed reliable but it is not guaranteed by Hall and Hall. A partner at Hall and Hall is the agent of the Seller. A full disclosure of our agency relationships is included in the property brochure available at [www.hallandhall.com](http://www.hallandhall.com) or by contacting the Listing Broker.

# Hickert Ranch

YUMA, COLORADO

-  Property Boundary
-  Blacktop roads

This map is for visual aid only and the accuracy is not guaranteed.



# Hickert Ranch

YUMA, COLORADO

-  Property Boundry
-  Blacktop roads

This map is for visual aid only and the accuracy is not guaranteed.

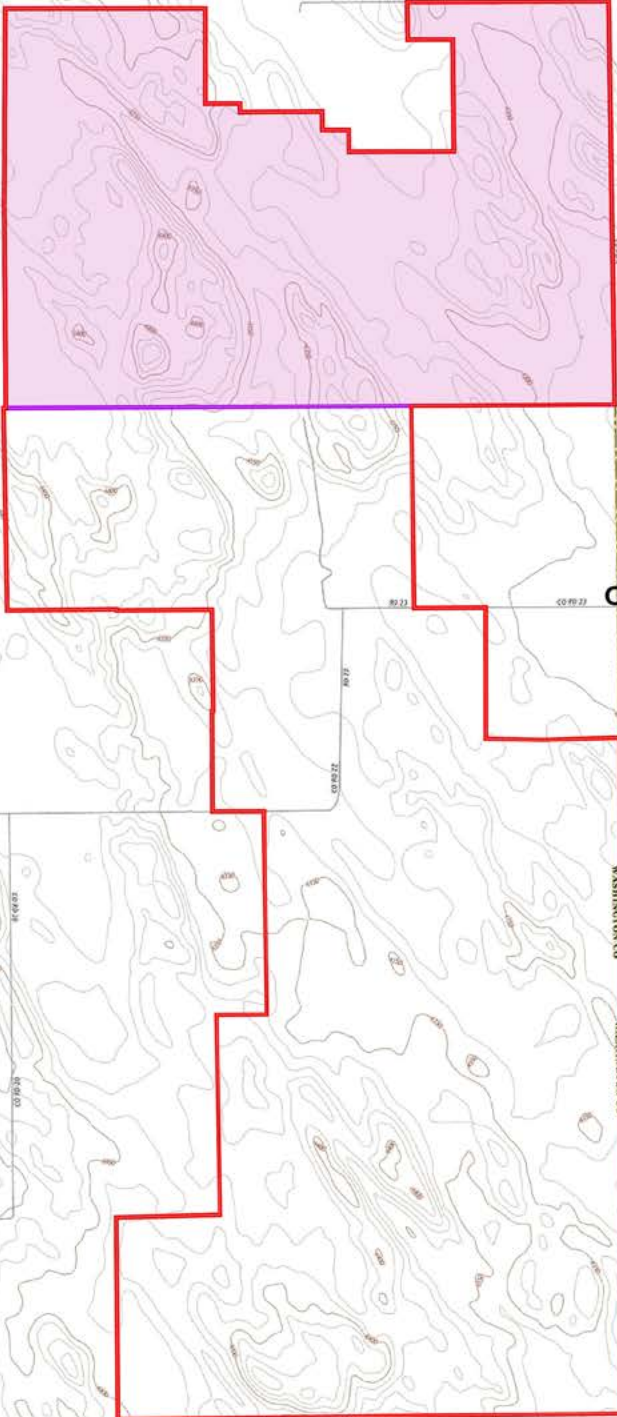

County Rd 23

Washington  
County

