

**411 Smith Road
Cleveland, MS 38732
Bolivar County
\$135,000**



Experience comfort and style in this charming 1,400± SF residence, offering three bedrooms and one and a half bathrooms. As you enter, discover an inviting open-concept kitchen, ideal for entertaining. The backyard is equipped with a practical storage shed and a porch, enhancing the overall convenience of the property. Whether you envision it as your dream home or a valuable addition to your rental portfolio, contact Tracey Bell to arrange your private showing!



**TRACEY
BELL**

MANAGING BROKER

Office: 662.441.2500

Cell: 662.719.4720

Tracey@TomSmithLand.com



A Real Estate Expert You Can Trust

TomSmithLandandHomes.com

Information is believed to be accurate but not guaranteed.





**TRACEY
BELL**

MANAGING BROKER

Office: 662.441.2500

Cell: 662.719.4720

Tracey@TomSmithLand.com



A Real Estate Expert You Can Trust
TomSmithLandandHomes.com

Information is believed to be accurate but not guaranteed.





**TRACEY
BELL**

MANAGING BROKER

Office: 662.441.2500

Cell: 662.719.4720

Tracey@TomSmithLand.com



A Real Estate Expert You Can Trust
TomSmithLandandHomes.com

Information is believed to be accurate but not guaranteed.



AERIAL MAP

33.7657, -90.6755



0.66±
Acres

BUSBY LN

BUSBY LN

SMITH RD

DOGWOOD DR

DOGWOOD DR

SMITH RD

HICKORY DR

[Click for Interactive Map](#)

**TRACEY
BELL**

MANAGING BROKER

Office: 662.441.2500

Cell: 662.719.4720

Tracey@TomSmithLand.com



A Real Estate Expert You Can Trust
TomSmithLandandHomes.com

Information is believed to be accurate but not guaranteed.



OWNERSHIP MAP

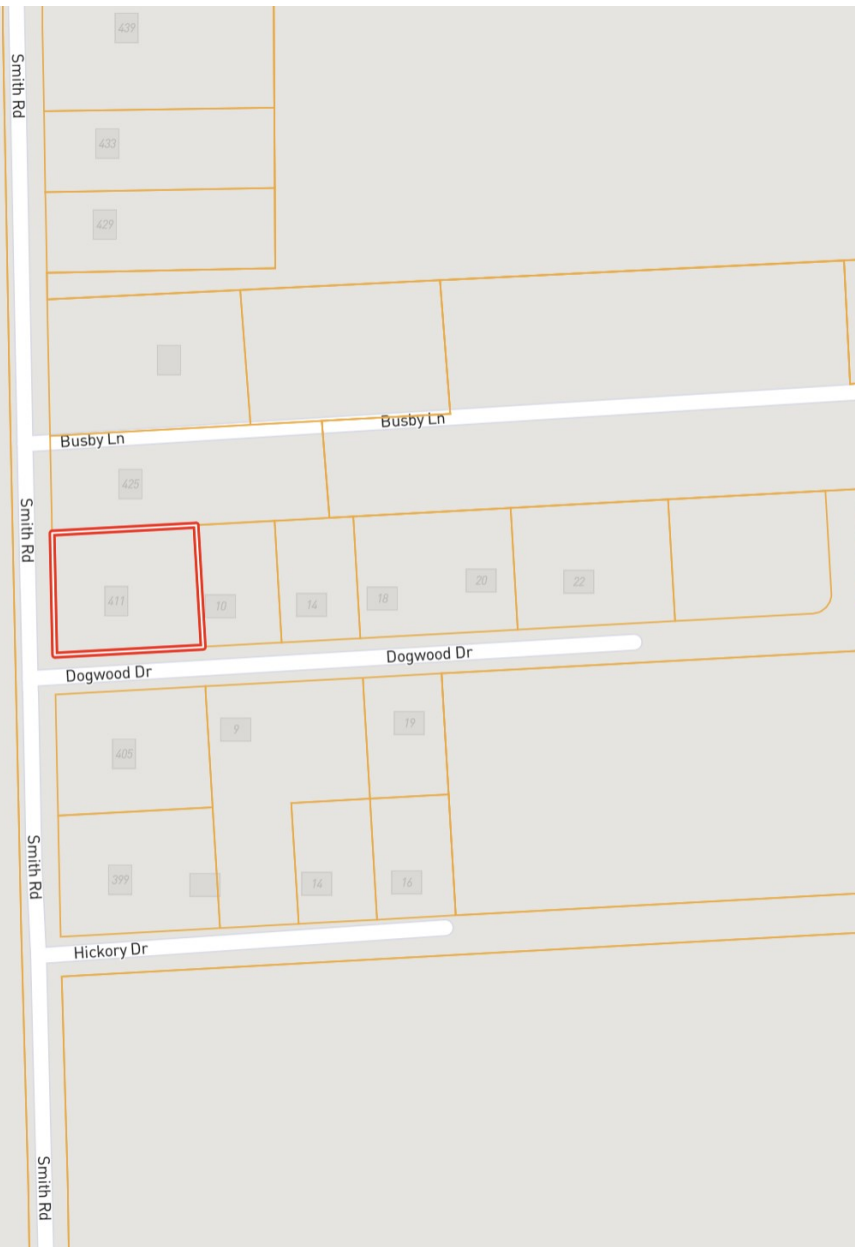

**TRACEY
BELL**

MANAGING BROKER

Office: 662.441.2500

Cell: 662.719.4720

Tracey@TomSmithLand.com



A Real Estate Expert You Can Trust

TomSmithLandandHomes.com

Information is believed to be accurate but not guaranteed.



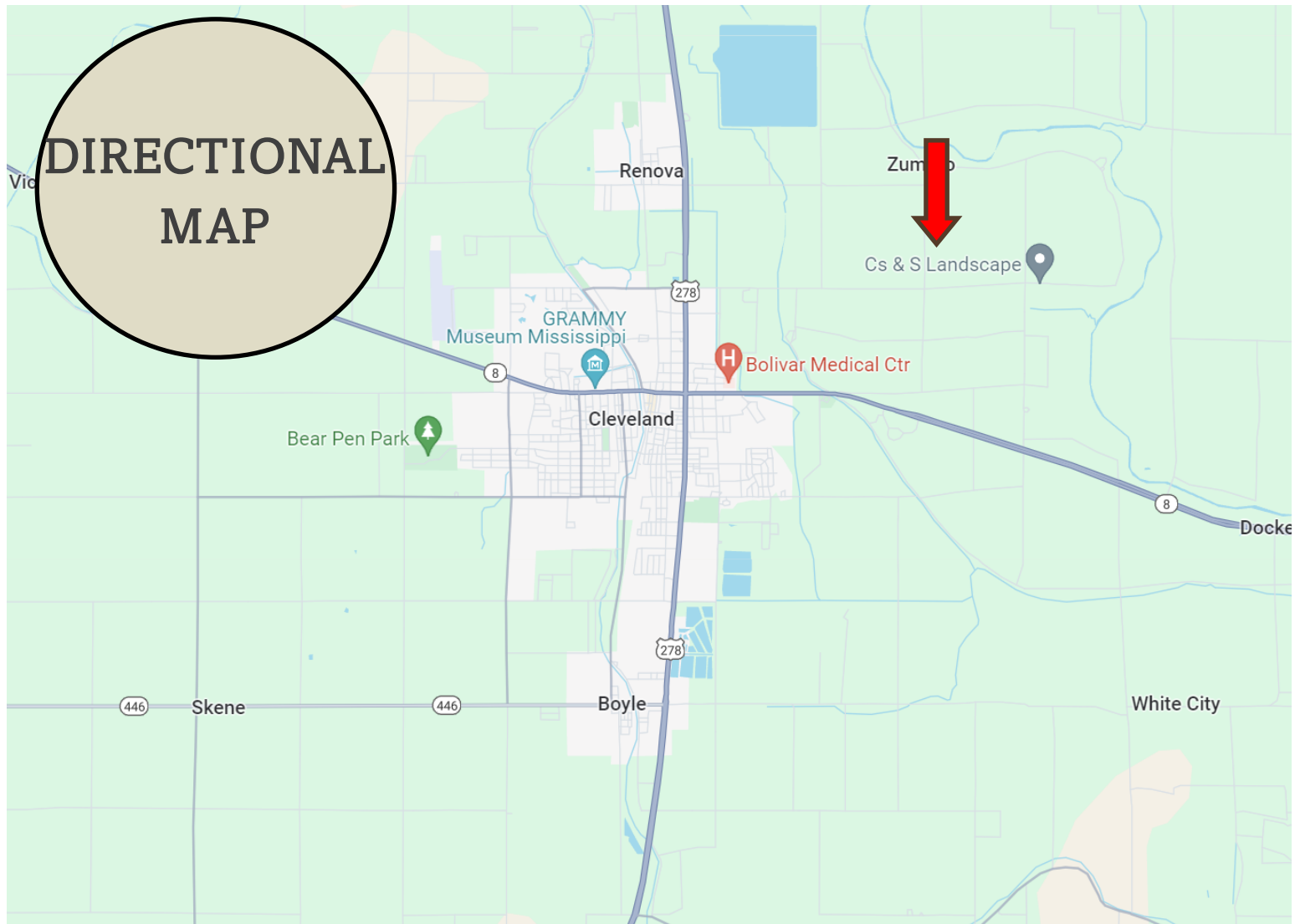

Address: 411 Smith Road, Cleveland, MS 38732

Directions from Hwy 8 and Hwy 61 Cleveland, MS: Travel north on N. Davis Road for 1 mile. Turn right onto E. Rosemary Road. Travel for 2.3 miles, then turn left onto Smith Road. After 0.3 miles, the house will be on the right. [Click for Google Maps.](#)



**TRACEY
BELL**

MANAGING BROKER

Office: 662.441.2500

Cell: 662.719.4720

Tracey@TomSmithLand.com



A Real Estate Expert You Can Trust

TomSmithLandandHomes.com

Information is believed to be accurate but not guaranteed.

