

BEAUTIFUL COPIAH COUNTY HOME ON 2± ACRES

2160 Monticello Road Wesson, MS 39191



\$150,000

Take a look at this beautiful three-bedroom, two-bathroom home on 2+/- acres in Copiah County, MS. This 1,350+/- square foot brick home in the Stronghope Community offers quiet relaxation while having the convenience of being close to town. The home features spacious bedrooms, a large living room, and beautiful hardwood floors, making this home a must-see. A large, fenced backyard and large front yard provide plenty of space for a growing family. Additional acreage is available for purchase.

[Google Map Link](#)



**CLIF
CANNON**
REALTOR®

Office: 601.990.5070

Cell: 601.565.1070

Clif@TomSmithLand.com



A Real Estate Expert You Can Trust

TomSmithLandandHomes.com

Information is believed to be accurate but not guaranteed.





Call me today!

CLIF CANNON, REALTOR

Clif@TomSmithLand.com

601.990.5070 office | 601.565.1070 cell



TomSmithLandandHomes.com



CLIF CANNON

REALTOR®

Office: 601.990.5070

Cell: 601.565.1070

Clif@TomSmithLand.com



A Real Estate Expert You Can Trust

TomSmithLandandHomes.com

Information is believed to be accurate but not guaranteed.



Aerial Map



Interactive Map

CLIF CANNON

REALTOR®

Office: 601.990.5070

Cell: 601.565.1070

Clif@TomSmithLand.com



A Real Estate Expert You Can Trust

TomSmithLandandHomes.com

Information is believed to be accurate but not guaranteed.



Ownership Map

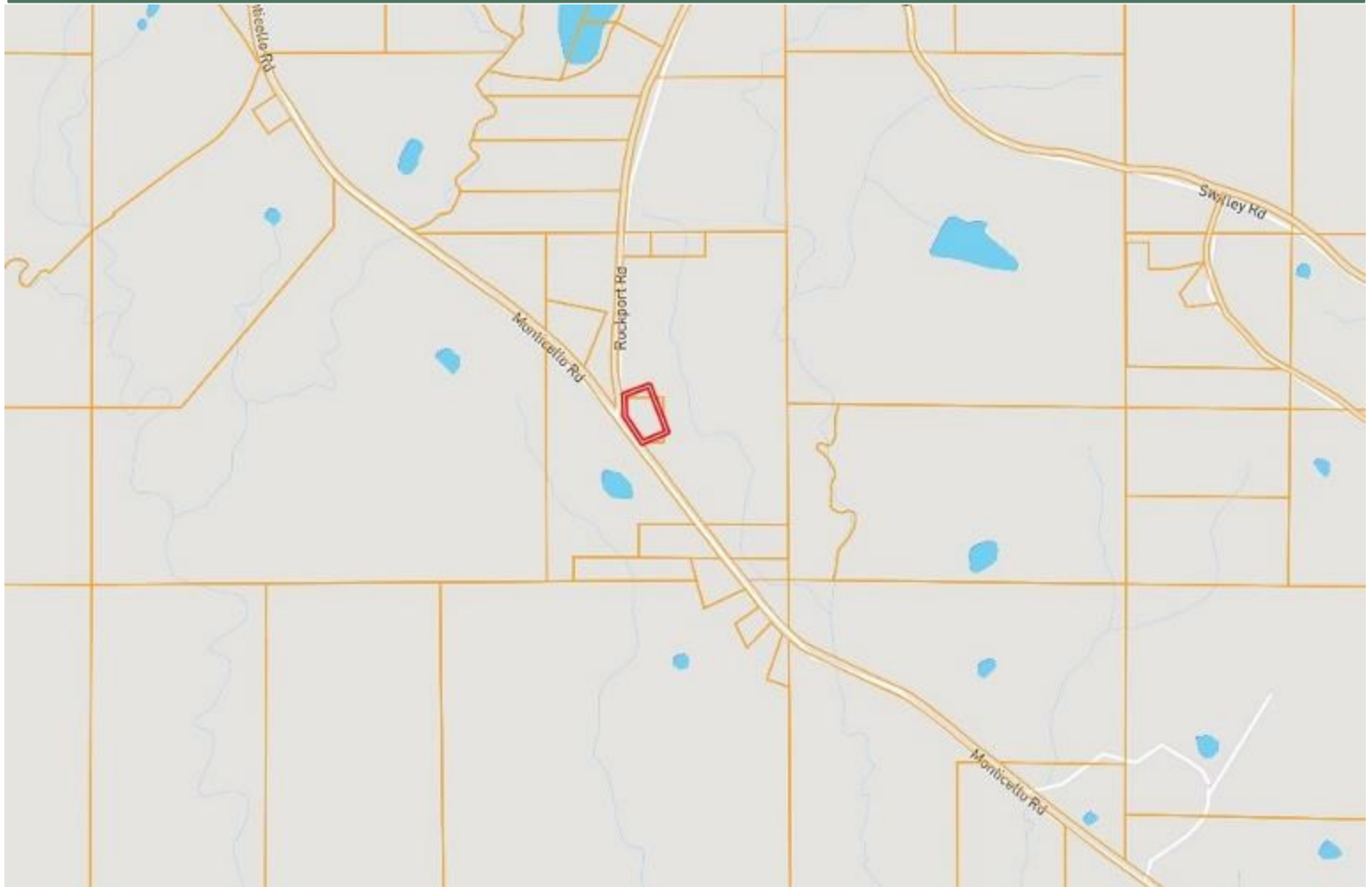

CLIF CANNON

REALTOR®

Office: 601.990.5070

Cell: 601.565.1070

Clif@TomSmithLand.com



A Real Estate Expert You Can Trust

TomSmithLandandHomes.com

Information is believed to be accurate but not guaranteed.



Directional Map

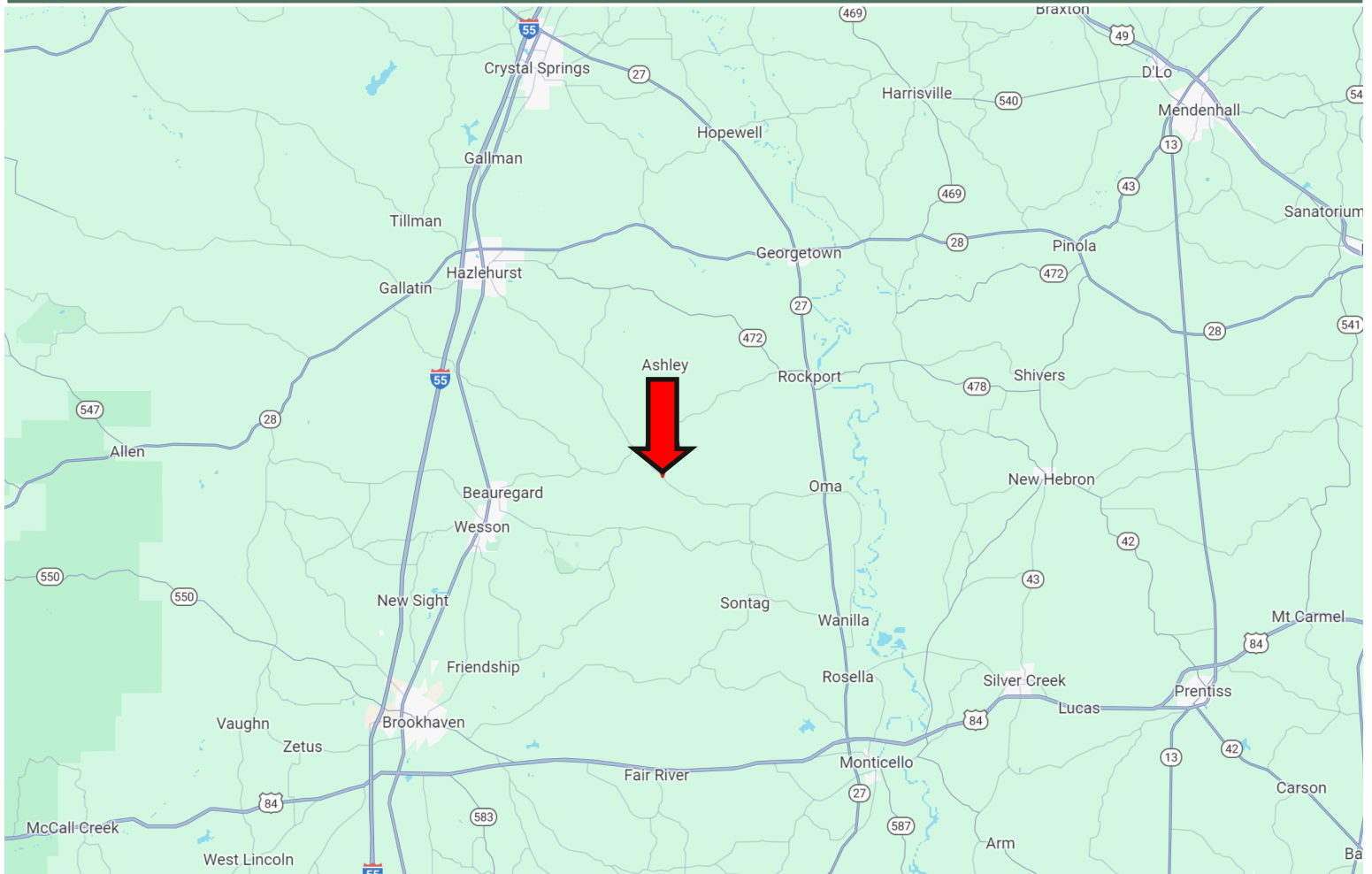

Directions from the intersection of Sylvarena Road and I-55 in Wesson, MS: Take exit 51 (Sylvarena Rd) and travel east on Sylvarena Road for 1.5 miles. Turn left onto Lowery Road and travel 1.7 miles. Turn right onto US-51 and travel for .2 miles. Turn left onto Bahala Road and travel .4 miles. Turn left onto Beauregard Road and travel 9.8 miles. Turn left onto Monticello Road and travel .9 miles. Turn left to remain on Monticello Road and travel 1 mile. The home will be on the left. 2160 Monticello Road Wesson, MS 39191—Click for Google Map Link



**CLIF
CANNON**
REALTOR®

Office: 601.990.5070
Cell: 601.565.1070
Clif@TomSmithLand.com



A Real Estate Expert You Can Trust

TomSmithLandandHomes.com

Information is believed to be accurate but not guaranteed.

