

2280 Sawmill Road, Shaw, MS | \$135,500



This two-bedroom, one-bath home is still under renovation, and many updates have already been completed. While there have been improvements, the character and originality of this home add to its country-living charm. The sunroom overlooks the backyard with mature trees. This 1,140± SF home is on 0.8± acres of Bolivar County land. Along with the one-car carport, the property also has a shed to store all your outdoor equipment. Call Charlie Heinzs to schedule your private showing!

**CHARLIE
HEINSZ**

REALTOR®

Office: 662.441.2500

Cell: 662.719.7218

Charlie@TomSmithLand.com



A Real Estate Expert You Can Trust

TomSmithLandandHomes.com

Information is believed to be accurate but not guaranteed.





CHARLIE HEINSZ

REALTOR®

Office: 662.441.2500

Cell: 662.719.7218

Charlie@TomSmithLand.com



A Real Estate Expert You Can Trust

TomSmithLandandHomes.com

Information is believed to be accurate but not guaranteed.

LandReport
2011-2023
AMERICA'S
BEST
BROKERAGES



CHARLIE HEINSZ
REALTOR®

Office: 662.441.2500

Cell: 662.719.7218

Charlie@TomSmithLand.com



A Real Estate Expert You Can Trust
TomSmithLandandHomes.com

Information is believed to be accurate but not guaranteed.



MAPS | [Click for Interactive Map](#)

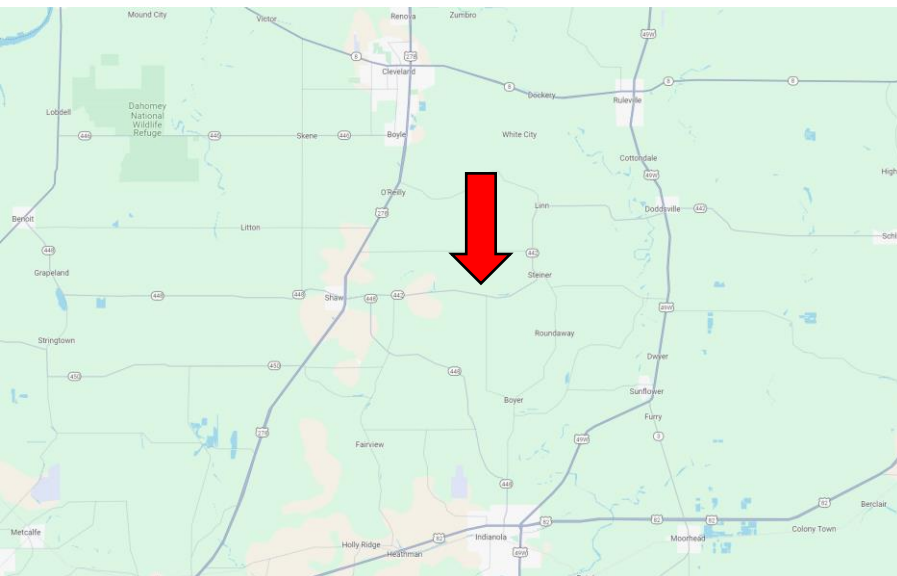
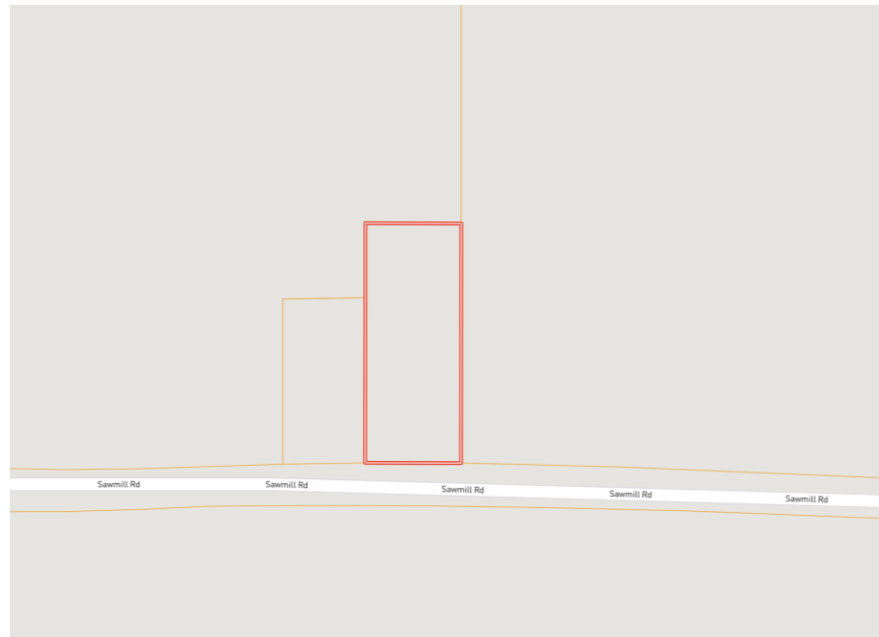

Address: 2280 Sawmill Road, Shaw, MS 38773

Directions from Hwy 8 & Hwy 61 in Cleveland, MS: Travel south on Hwy 61 for 5.1 mile. Turn left onto Jones Bayou Road and travel 1.7 miles. Turn right onto Interstate Road, then turn left onto Sandpit Road and travel 0.8 miles. Turn right onto Prewitt Road and travel 1 mile. Turn left onto Sawmill Road. After 1.2 miles, the home will be on the left. [Click for Google Maps.](#)



**CHARLIE
HEINSZ**
REALTOR®

Office: 662.441.2500
Cell: 662.719.7218

Charlie@TomSmithLand.com



A Real Estate Expert You Can Trust

TomSmithLandandHomes.com

Information is believed to be accurate but not guaranteed.

