

Building Sketch

Client	Stephen L. Sauls				
Property Address	126 Elmer Howell Road				
City	Jayess	County	Walthall	State	MS Zip Code 39641
Appraiser	Chris Barrett				

"Finished square footage calculations for this home were made based on measured dimensions only and may include unfinished areas, openings in floors not associated with stairs, or openings in floors exceeding the area of associated stairs." The "American National Standards Institute" method for calculating square footage was utilized. Interior Partitions may not be exact and are used to illustrate the floorplan.

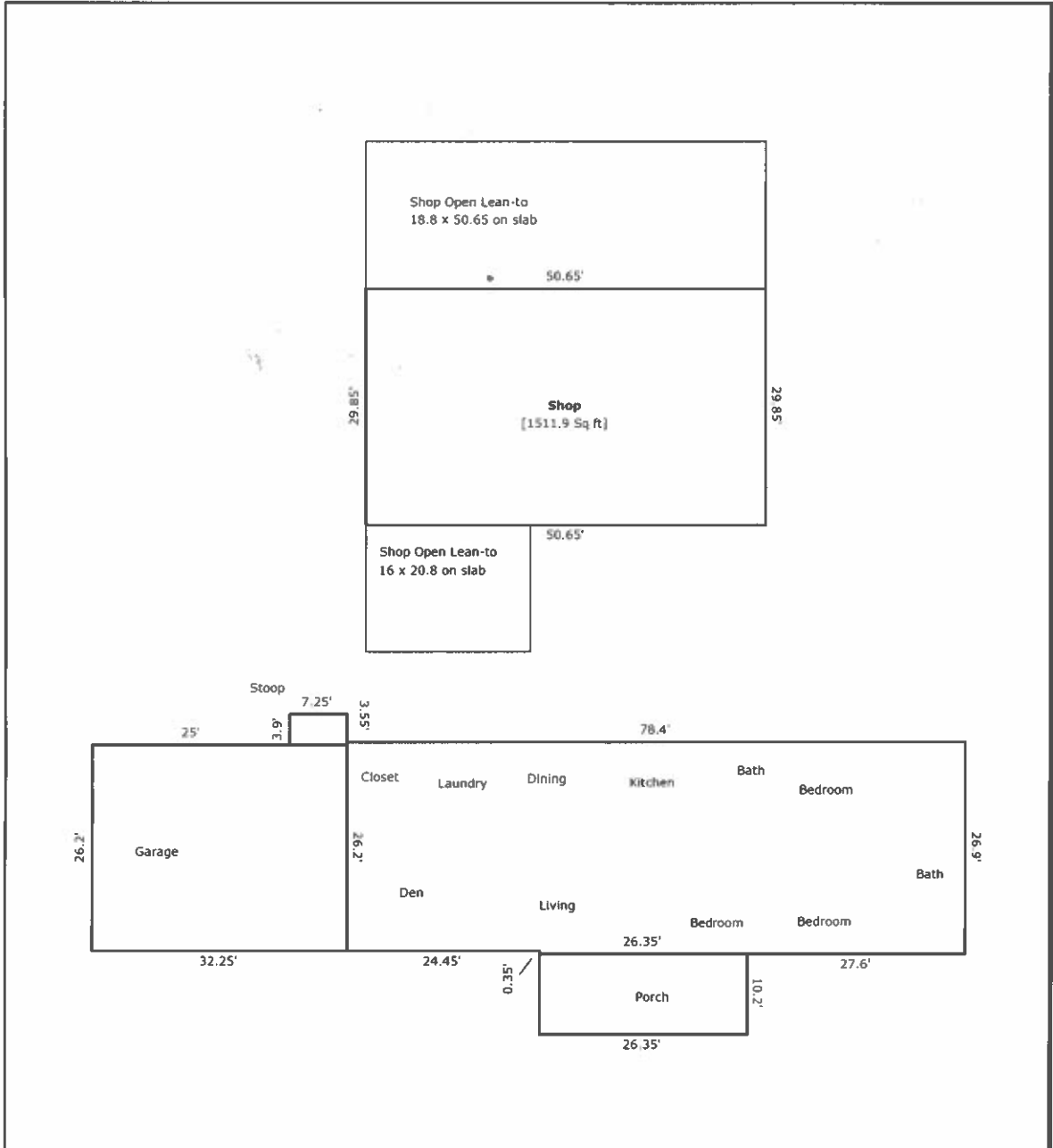

TOTAL Sketch by a la mode, inc

Area Calculations Summary

Living Area	Calculation Details
Living Area	2100.4 Sq ft
	26.55 x 24.45 = 649.15
	26.9 x 53.95 = 1451.26
Total Living Area (Rounded):	2100 Sq ft
Non-living Area	
2 Car Attached	844.95 Sq ft
	26.2 x 32.25 = 844.95
Stoop	28.27 Sq ft
	3.9 x 7.25 = 28.28
Open Porch	268.77 Sq ft
	26.35 x 10.2 = 268.77
Shop	1511.9 Sq ft
	50.65 x 29.85 = 1511.9