

WELL-MAINTAINED HOME IN THE TWIN HARBOR SUBDIVISION OF MADISON COUNTY, MS

133 Harbor Road Madison, MS 39110



Located in the Twin Harbor Subdivision of Madison, MS, this meticulously maintained residence awaits its new owners. This delightful home has so many extras designed for comfortable living and convenience. Its desirable layout features three bedrooms, two baths, and 1,144 square feet. The property includes a spacious 2-car garage complemented by substantial storage solutions. Enjoy the Mississippi weather in the large, fenced-in backyard, with a storage shed and a deck perfect for entertaining or relaxing. With a new roof installed in 2020, this home promises peace of mind and demonstrates the care invested into its upkeep. The large living room with a beautiful fireplace offers a warm welcome, while the spacious kitchen is a cook's dream. Hardwood floors add a touch of elegance throughout, and the home is rich in storage options and spacious closets. This property is move-in ready and designed for those who value comfort and style. Its prime location in the Twin Harbor Subdivision of Madison, MS, enhances its appeal, making it a desirable find in the market. Act quickly because this home with attractive features and competitive pricing won't be available for long. Seize the opportunity to make 133 Harbor Road your new address and enjoy the best of Madison living.



DAVID BELDEN
REALTOR®

O: 601.898.2772 | C: 601.415.3883
DBelden@TomSmithLand.com



HALEY BELDEN
REALTOR®

O: 601.898.2772 | C: 601.209.2310
Haley@TomSmithHomes.com

TomSmithLandandHomes.com

Information is believed to be accurate but not guaranteed.





DAVID BELDEN
REALTOR®

O: 601.898.2772 | C: 601.425.3883
DBelden@TomSmithLand.com



HALEY BELDEN
REALTOR®

O: 601.898.2772 | C: 601.209.2310
Haley@TomSmithHomes.com

TomSmithLandandHomes.com

Information is believed to be accurate but not guaranteed.





DAVID BELDEN
REALTOR®

O: 601.898.2772 | C: 601.425.3883
DBelden@TomSmithLand.com



HALEY BELDEN
REALTOR®

O: 601.898.2772 | C: 601.209.2310
Haley@TomSmithHomes.com

TomSmithLandandHomes.com

Information is believed to be accurate but not guaranteed.





DAVID BELDEN
REALTOR®

O: 601.898.2772 | C: 601.425.3883
DBelden@TomSmithLand.com



HALEY BELDEN
REALTOR®

O: 601.898.2772 | C: 601.209.2310
Haley@TomSmithHomes.com

TomSmithLandandHomes.com

Information is believed to be accurate but not guaranteed.





DAVID BELDEN
REALTOR®

O: 601.898.2772 | C: 601.425.3883
DBelden@TomSmithLand.com



HALEY BELDEN
REALTOR®

O: 601.898.2772 | C: 601.209.2310
Haley@TomSmithHomes.com

TomSmithLandandHomes.com

Information is believed to be accurate but not guaranteed.





Aerial Map

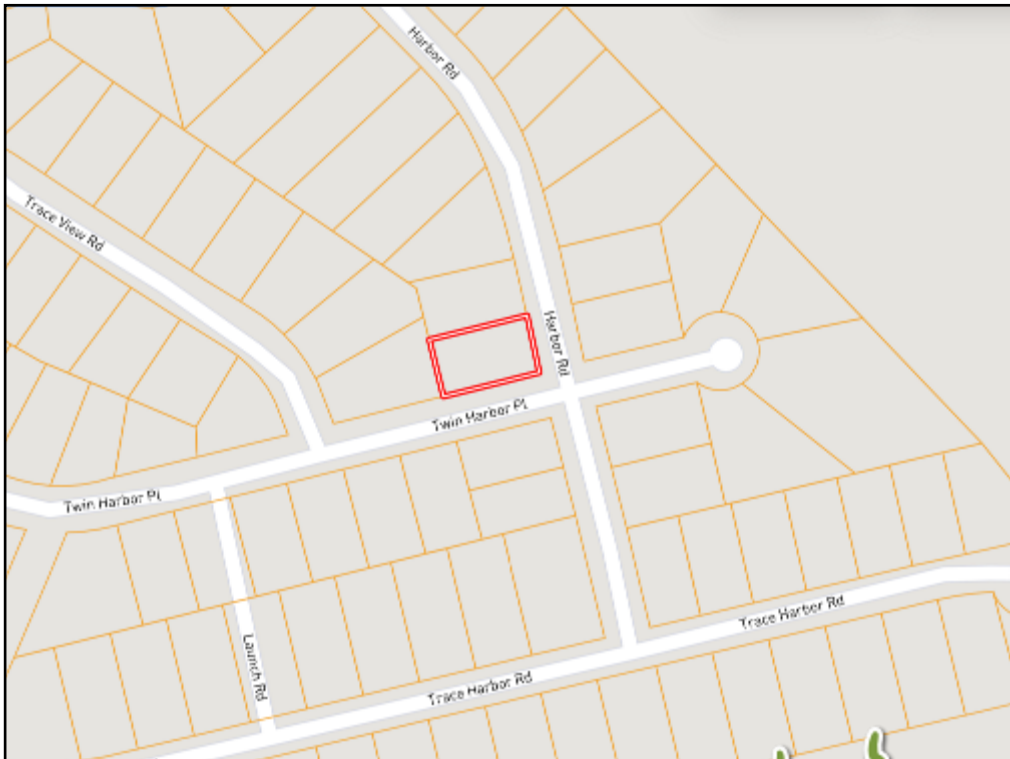

Ownership Map

[LandId Interactive Map Link](#)

DAVID BELDEN
REALTOR®

O: 601.898.2772 | C: 601.425.3883
DBelden@TomSmithLand.com



HALEY BELDEN
REALTOR®

O: 601.898.2772 | C: 601.209.2310
Haley@TomSmithHomes.com

TomSmithLandandHomes.com

Information is believed to be accurate but not guaranteed.



Directional Map

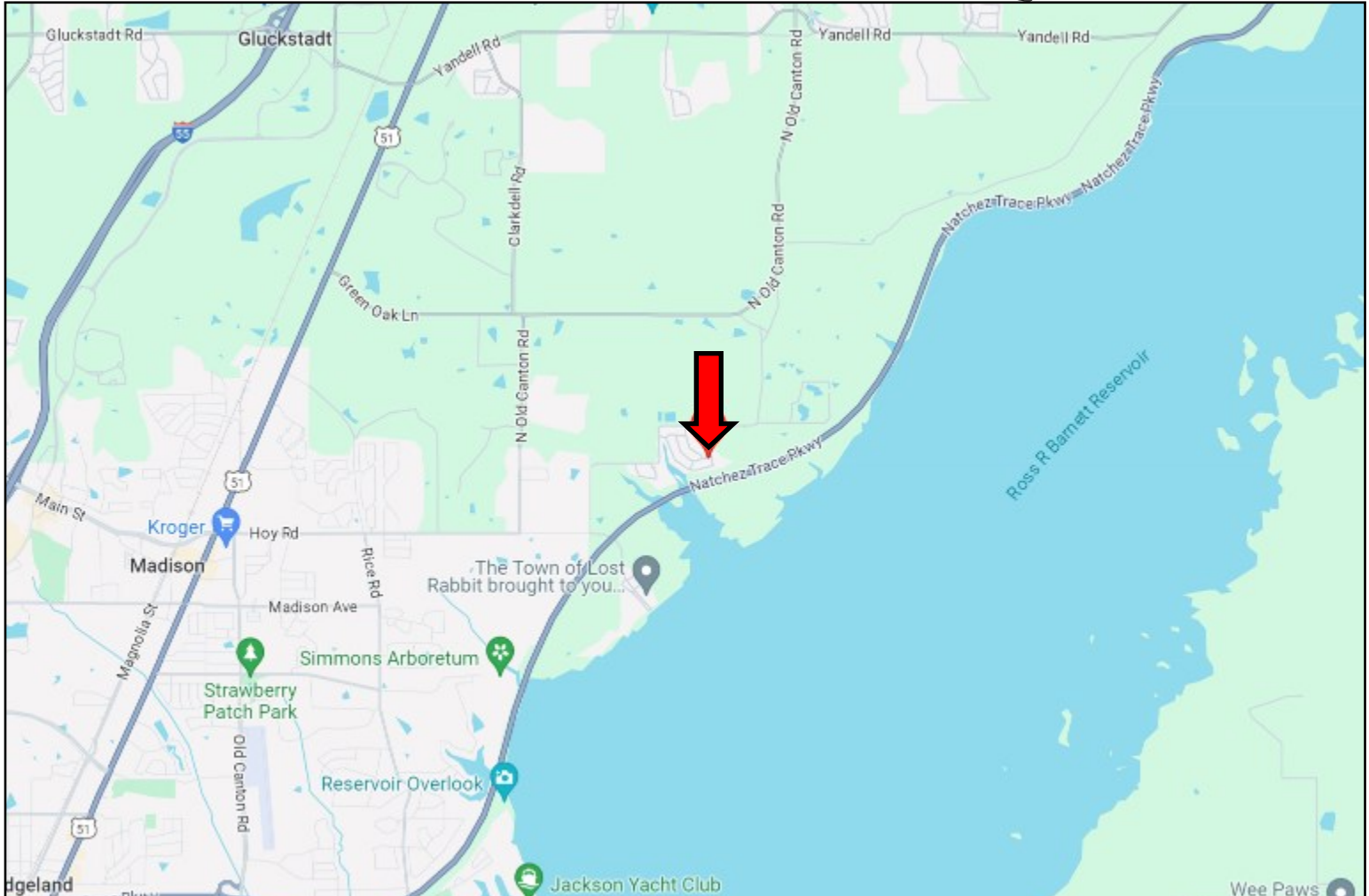

Directions from the Intersection of Hoy Road and Old Canton Road in Madison, MS: Travel Hoy Road for 0.5 miles. Turn left onto Rice Road and travel 1.5 miles. Turn right onto Harbor Road. After 0.2 miles, the home will be on your right.

[133 Harbor Road Madison, MS 39110—Google Map Link](#)



DAVID BELDEN
REALTOR®

O: 601.898.2772 | C: 601.415.3883
DBelden@TomSmithLand.com



HALEY BELDEN
REALTOR®

O: 601.898.2772 | C: 601.209.2310
Haley@TomSmithHomes.com

TomSmithLandandHomes.com

Information is believed to be accurate but not guaranteed.

