

# Charming Corner Lot Home

## 1215 S Fifth Ave Cleveland, MS 38732



**\$239,950**

***Welcome to 1215 S Fifth Ave, Cleveland, MS. This charming three-bed, two-bath house is located on a large corner lot in Bolivar County, MS, giving the family plenty of yard for get-togethers. The 1,713 heated and cooled sqft brick house sits on a slab foundation and has a brand-new architectural roof. Inside the house, you will find a tall ceiling in the living room from the updated kitchen. The main bedroom offers two his and hers walk-in closets and a private bathroom. Outside the house, you have a two-car carport and a covered back patio coming off the carport, giving you plenty of outdoor space to have friends and family over for a cookout! Call today for your very own private showing!***



**ANTHONY  
STEEN**  
REALTOR®

Office: 662.441.2500  
Cell: 662.645.5151

[Anthony@TomSmithLand.com](mailto:Anthony@TomSmithLand.com)



Expect More. Get More.

**A Real Estate Expert You Can Trust**

[TomSmithLandandHomes.com](http://TomSmithLandandHomes.com)

Information is believed to be accurate but not guaranteed.





- **Three-Bed**
- **Two-Bath**
- **Corner Lot Home**
- **1,713 SqFt**
- **Brand New Roof**
- **Updated Kitchen**
- **Walk-In Closets**
- **Two Car Carport**



**ANTHONY STEEN**  
REALTOR®

Office: 662.441.2500

Cell: 662.645.5151

Anthony@TomSmithLand.com



**A Real Estate Expert You Can Trust**  
TomSmithLandandHomes.com

Information is believed to be accurate but not guaranteed.





## ANTHONY STEEN

REALTOR®

Office: 662.441.2500

Cell: 662.645.5151

Anthony@TomSmithLand.com



A Real Estate Expert You Can Trust

TomSmithLandandHomes.com

Information is believed to be accurate but not guaranteed.





**ANTHONY STEEN**

REALTOR®

Office: 662.441.2500

Cell: 662.645.5151

Anthony@TomSmithLand.com



**A Real Estate Expert You Can Trust**

TomSmithLandandHomes.com

Information is believed to be accurate but not guaranteed.





**ANTHONY STEEN**

REALTOR®

Office: 662.441.2500

Cell: 662.645.5151

Anthony@TomSmithLand.com



**A Real Estate Expert You Can Trust**

TomSmithLandandHomes.com

Information is believed to be accurate but not guaranteed.



# MAPS

[Click for Interactive Map](#)

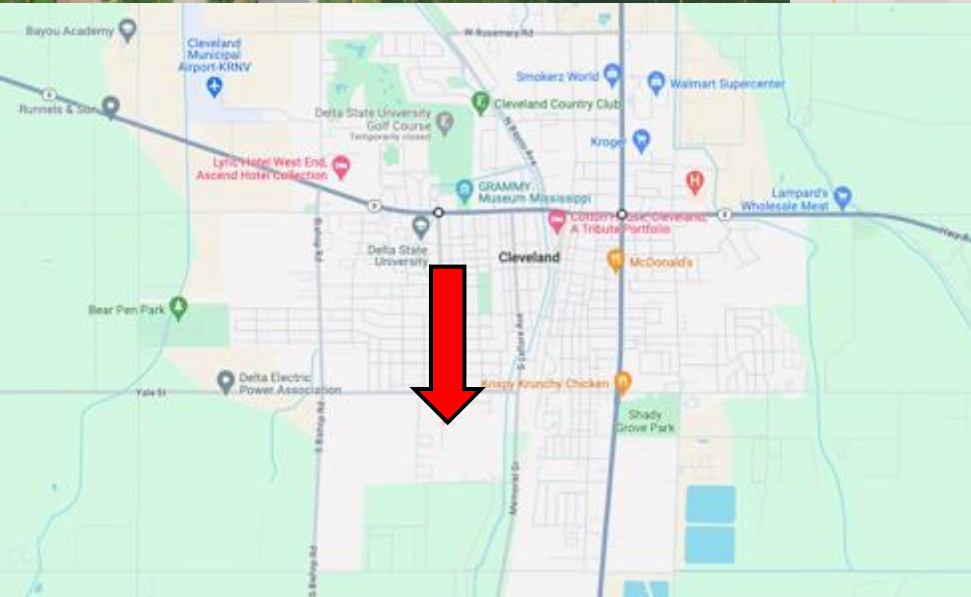

**Address:** 1215 S Fifth Ave  
Cleveland, MS 38732

**Directions from US-61 & MS-8:** Travel west on E Sunflower Road toward N Chrisman Ave for 1 mile. Turn left onto N 5<sup>th</sup> Ave. After 1.2 miles, the house will be on the left. [Click for Google Maps](#)



**ANTHONY  
STEEN**  
REALTOR®

Office: 662.441.2500  
Cell: 662.645.5151  
Anthony@TomSmithLand.com



**A Real Estate Expert You Can Trust**  
TomSmithLandandHomes.com

Information is believed to be accurate but not guaranteed.

