

1505 Terrace Road Cleveland, MS | Bolivar County



3 Bedroom, 2 Bathroom Brick Home | \$169,500

This three-bedroom, two-bathroom brick home sits on a slab with a covered two-car carport. The stainless-steel appliances in the kitchen and a formal dining room are additional perks of this home. The 1,268± SF house sits on 0.3± acres, so the privacy fenced backyard is great for your pets and children to play outside safely. To see the many great features of this home, call Tracey Bell to schedule your private showing!



**TRACEY
BELL**

MANAGING BROKER

Office: 662.441.2500

Cell: 662.719.4720

Tracey@TomSmithLand.com



Expect More. Get More.

A Real Estate Expert You Can Trust

TomSmithLandandHomes.com

Information is believed to be accurate but not guaranteed.





**TRACEY
BELL**

MANAGING BROKER

Office: 662.441.2500

Cell: 662.719.4720

Tracey@TomSmithLand.com



A Real Estate Expert You Can Trust
TomSmithLandandHomes.com

Information is believed to be accurate but not guaranteed.





- 3 Bedrooms
- 2 Bathrooms
- 1,268± SF
- 0.3± Acres
- 2 Car Carport
- Brick Home on Slab
- Privacy Fenced Backyard
- Backyard Shed

**TRACEY
BELL**

MANAGING BROKER

Office: 662.441.2500

Cell: 662.719.4720

Tracey@TomSmithLand.com



A Real Estate Expert You Can Trust
TomSmithLandandHomes.com

Information is believed to be accurate but not guaranteed.



MAPS | [Click for Interactive Map](#)

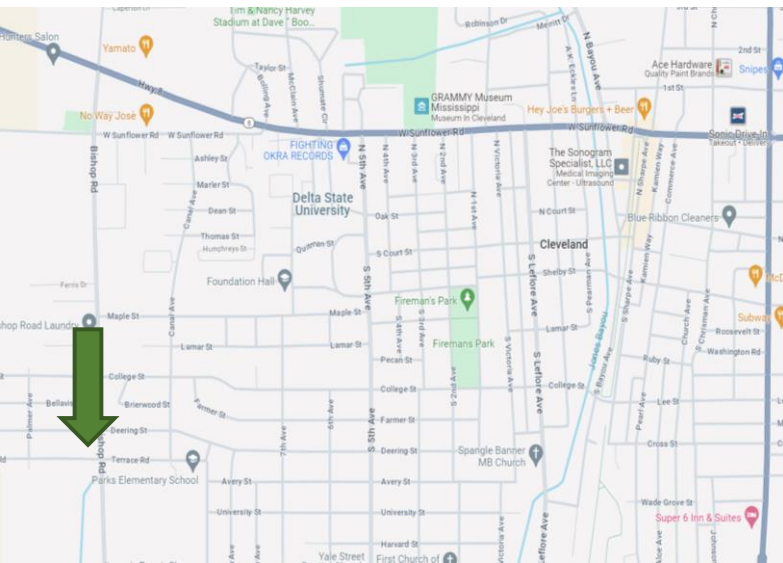
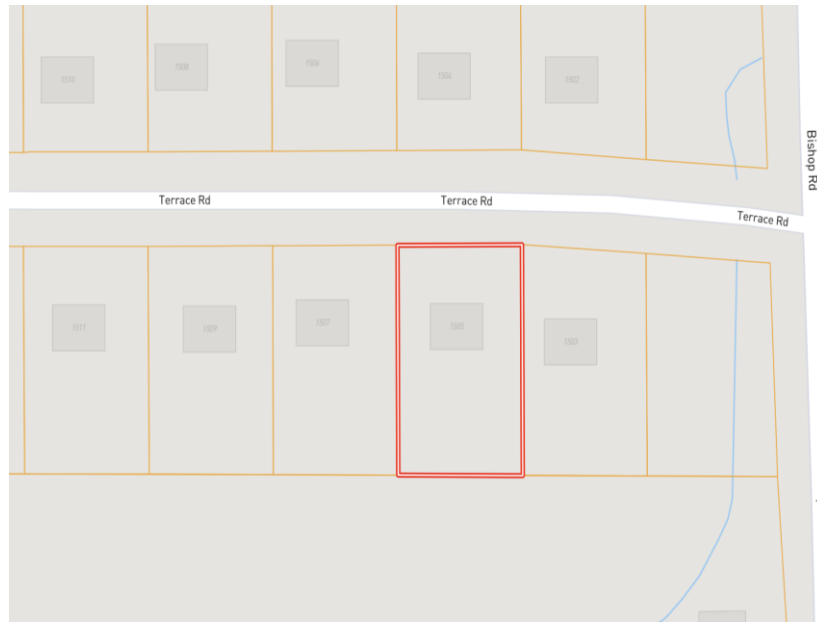

**Address: 1505 Terrace Road,
Cleveland, MS 38732**

Directions from Hwy 8 & Hwy 61 in Cleveland, MS:
Travel west on E. Sunflower Road for 1.7 miles. Turn left onto Bishop Road. After 0.9 miles, turn right onto Terrace Road. The home will be on the left after 272 feet. [Click for Google Maps.](#)



**TRACEY
BELL**
MANAGING BROKER
Office: 662.441.2500
Cell: 662.719.4720
Tracey@TomSmithLand.com



Expect More. Get More.

A Real Estate Expert You Can Trust

TomSmithLandandHomes.com

Information is believed to be accurate but not guaranteed.

