

# SUNFLOWER COUNTY BUSINESS OPPORTUNITY

225 Hwy 82 W, Indianola, MS 38751

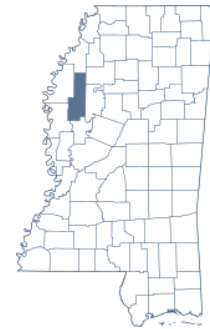

Ideal location! This commercial property features a spacious 3,000 sq/ft building with an adjoining 1,000 sq/ft office situated on a generous 0.83± acre lot. With 181.5 feet of frontage on Highway 82 West, it enjoys high visibility and a daily traffic count of 19,000 vehicles, according to MSDOT. Plus, there's ample parking available. Perfect for your business needs! Call Emerson to view this property today!



**\$199,750**



**EMERSON  
LOVELACE**

REALTOR®

Office: 662.441.2500

Cell: 601.715.3302

Emerson@TomSmithLand.com

**A Real Estate Expert You Can Trust**

TomSmithLandandHomes.com

Information is believed to be accurate but not guaranteed.



# MAPS | LANDID INTERACTIVE MAP LINK

225 Hwy 82 W, Indianola, MS 38751

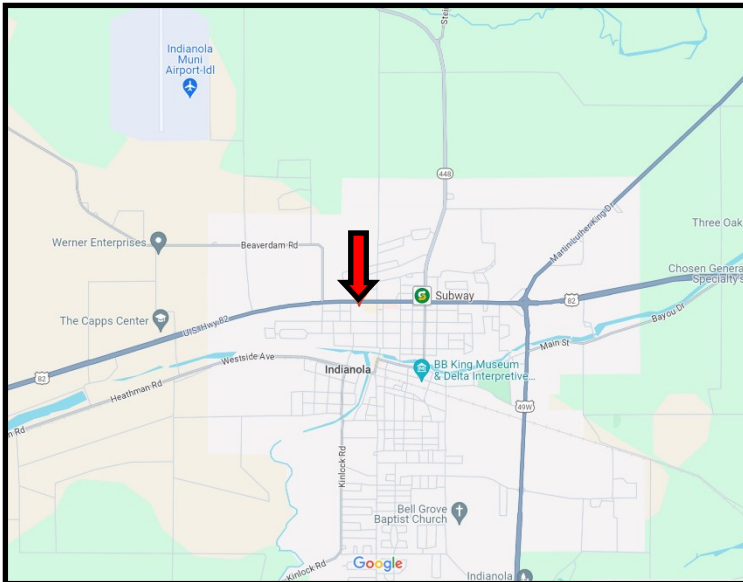
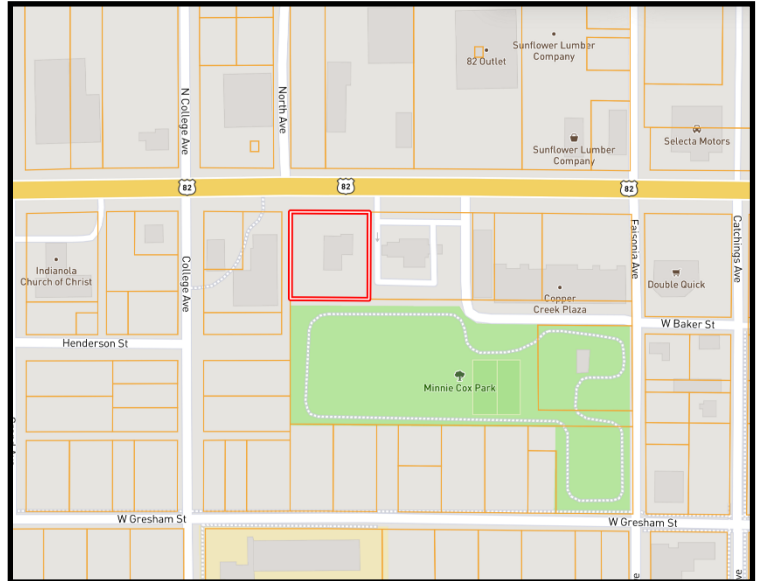

Directions from the intersection of Hwy 82 and Hwy 49 in Indianola, MS: Travel Hwy 82 West for 1.2 miles. The property will be on your left.  
225 HWY 82 W INDIANOLA, MS 38751- CLICK FOR GOOGLE MAP LINK

**A Real Estate Expert**  
*You Can Trust!*

**EMERSON LOVELACE**  
REALTOR®

O: 662.441.2500 C: 601.715.3302

Emerson@TomSmithLand.com

TomSmithLandandHomes.com

**Tom Smith**  
**LAND AND HOMES**

Expect More. Get More.

2011-2024  
**BEST**  
REALTORS

Information is believed to be accurate but not guaranteed.