

58+/- Acres in Smith County | \$150,000 SCR 35-11 Pulaski, MS 39152



HOT NEW LISTING!! Welcome to this 58± acre hunting tract located in Smith County off Hwy 35 South. This property offers timber investment, hunting for deer and squirrels, three private food plots, and a road system. The property has water and utilities located on the road, making it a great location for a house site as well. This property is located just south of Forest, MS. Call Anthony to schedule your tour today!



**ANTHONY
STEEN**

REALTOR®

Office: 662.441.2500

Cell: 662.645.5151

Anthony@TomSmithLand.com



Expect More. Get More.

A Real Estate Expert You Can Trust

TomSmithLandandHomes.com

Information is believed to be accurate but not guaranteed.





A Real Estate Expert *You Can Trust!*

ANTHONY STEEN
REALTOR®

O: 662.441.2500 C: 662.645.5151

Anthony@TomSmithLand.com

TomSmithLandandHomes.com



Expect More. Get More.





A Real Estate Expert *You Can Trust!*

ANTHONY STEEN
REALTOR®

O: 662.441.2500 C: 662.645.5151

Anthony@TomSmithLand.com

TomSmithLandandHomes.com



Expect More. Get More.





A Real Estate Expert *You Can Trust!*

ANTHONY STEEN
REALTOR®

O: 662.441.2500 C: 662.645.5151

Anthony@TomSmithLand.com

TomSmithLandandHomes.com



Expect More. Get More.



AERIAL MAP

Click for the Interactive Map



A Real Estate Expert
You Can Trust!

ANTHONY STEEN
REALTOR®

O: 662.441.2500 C: 662.645.5151

Anthony@TomSmithLand.com

TomSmithLandandHomes.com



Expect More. Get More.



Information is believed to be accurate but not guaranteed.

OWNERSHIP MAP

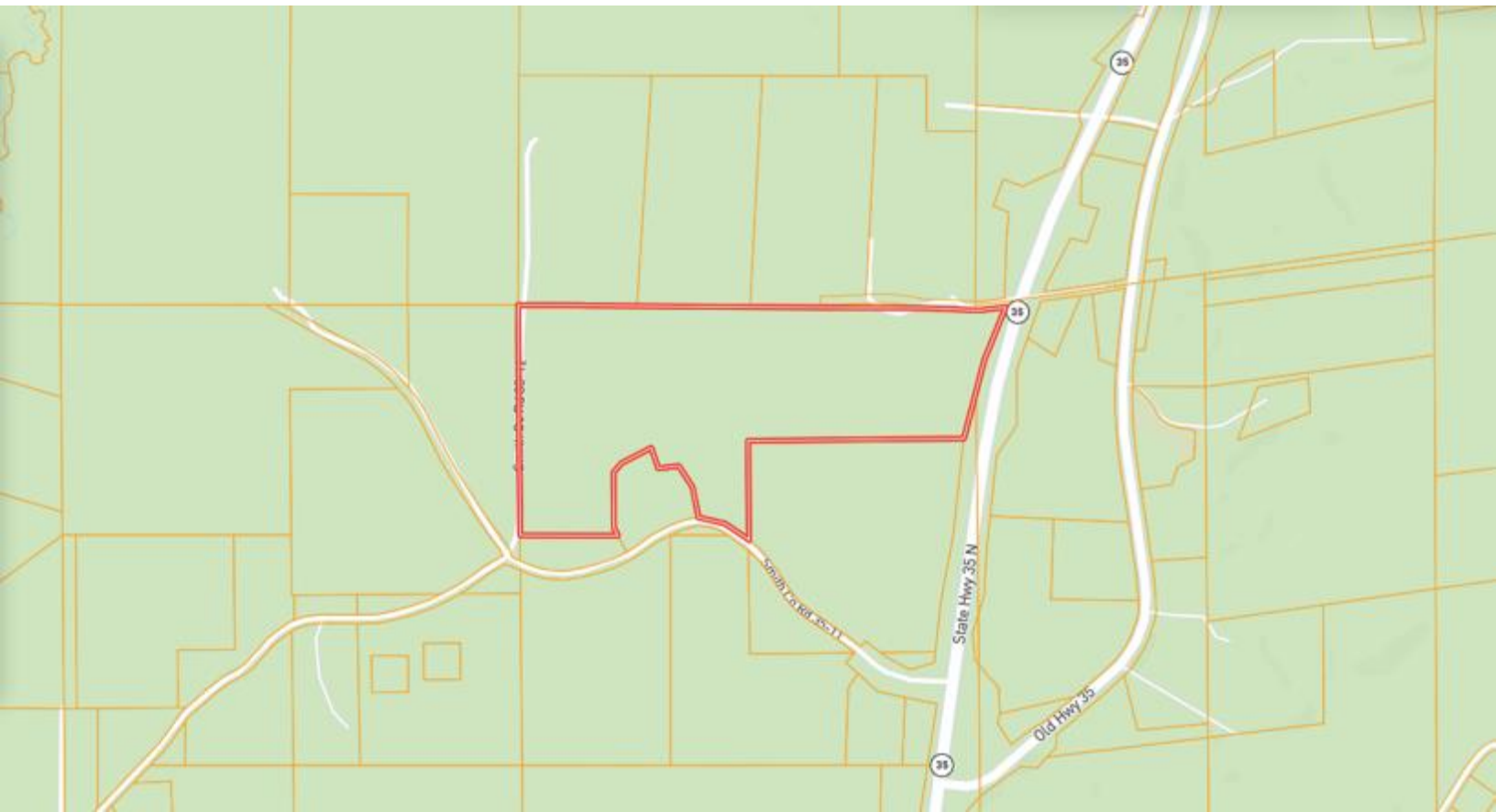

A Real Estate Expert
You Can Trust!

ANTHONY STEEN
REALTOR®

O: 662.441.2500 C: 662.645.5151

Anthony@TomSmithLand.com

TomSmithLandandHomes.com



Expect More. Get More.



TOPOGRAPHY MAP



A Real Estate Expert
You Can Trust!

ANTHONY STEEN
REALTOR®

O: 662.441.2500 C: 662.645.5151

Anthony@TomSmithLand.com

TomSmithLandandHomes.com



Expect More. Get More.



SOIL MAP



SOIL CODE	SOIL DESCRIPTION	ACRES	%	CPI	NCCPI	CAP
SwD	Sweatman fine sandy loam, 8 to 15 percent slopes	37.86	63.99	0	72	6e
SaB	Savannah fine sandy loam, 2 to 5 percent slopes	9.76	16.49	0	54	2e
OrC	Ora fine sandy loam, 5 to 8 percent slopes	5.57	9.41	0	41	3e
SwC	Sweatman fine sandy loam, 5 to 8 percent slopes	3.29	5.56	0	78	4e
OrB	Ora fine sandy loam, 2 to 5 percent slopes	1.55	2.62	0	50	2e
QuA	Quitman fine sandy loam, 0 to 2 percent slopes, occasionally flooded	1.14	1.93	0	76	2w
TOTALS		59.17(*)	100%	-	65.95	4.76

(*) Total acres may differ in the second decimal compared to the sum of each acreage soil. This is due to a round error because we only show the acres of each soil with two decimal.

A Real Estate Expert
You Can Trust!

ANTHONY STEEN
REALTOR®

O: 662.441.2500 C: 662.645.5151

Anthony@TomSmithLand.com

TomSmithLandandHomes.com



Expect More. Get More.



DIRECTIONAL MAP

[Click for Google Maps](#)

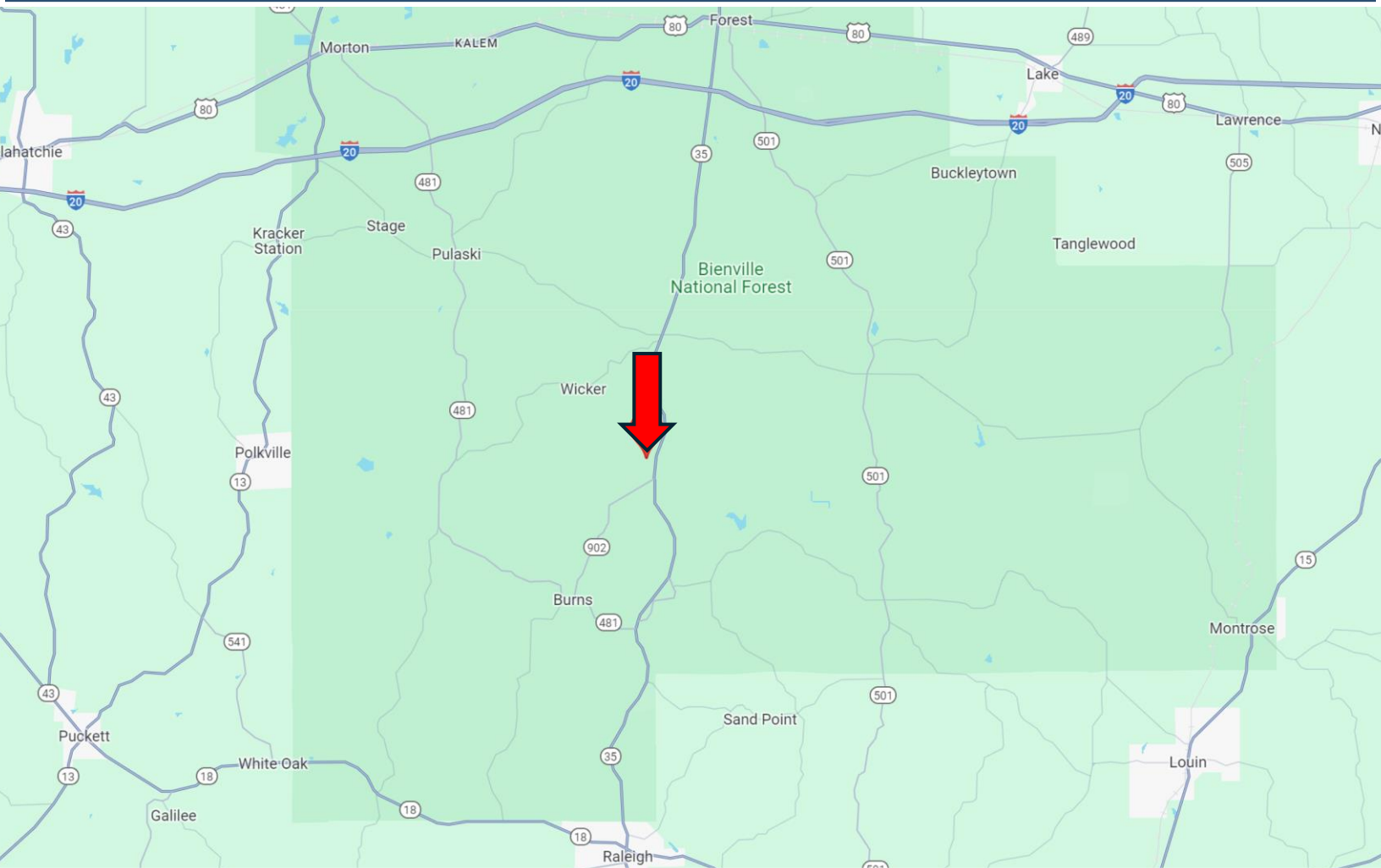

Address: Smith CR 35-11 Pulaski, MS 39152

Directions from I-20 and Hwy 35 in Forest, MS: Take exit 88 towards Raleigh. Travel Hwy 35 S for 10.6 miles. Turn right onto SCR 35-11. After 0.3 miles, the property will be on the right.



**ANTHONY
STEEN**

REALTOR®

Office: 662.441.2500

Cell: 662.645.5151

Anthony@TomSmithLand.com



Expect More. Get More.

A Real Estate Expert You Can Trust

TomSmithLandandHomes.com

Information is believed to be accurate but not guaranteed.

