

New Construction Bolivar County Home

260 N Bolivar County Line Road Cleveland, MS



\$485,000

Welcome to 260 N Bolivar County Line Rd! Have you been looking for a place to build your dream house outside of the city limits, but wanted to avoid dealing with the stress and waiting over a year for it to finish? Look no further! This gorgeous newly constructed house on 2.5 acres has it all with a two-car garage, beautiful 12x12 Cypress columns in the front and back of the house, double pane energy efficient black windows, custom-made cabinets with doors ready to be installed, 4 beds, with an option for a 5th bedroom or an office/theatre room upstairs, 2 bath and over 3,900 total sq ft. There is a back patio looking over the huge yard big enough to install your very own pool. Let's not forget that this property offers a 40x40 insulated shop with water and utilities including a wrap-around porch. This house has extra material to finish the bathrooms and cabinets. This house is ready to be someone's future forever home so call today!



**ANTHONY
STEEN**

REALTOR®

Office: 662.441.2500

Cell: 662.645.5151

Anthony@TomSmithLand.com



Expect More. Get More.

A Real Estate Expert You Can Trust

TomSmithLandandHomes.com

Information is believed to be accurate but not guaranteed.





A Real Estate Expert
You Can Trust!

ANTHONY STEEN
REALTOR®

O: 662.441.2500 C: 662.645.5151

Anthony@TomSmithLand.com

TomSmithLandandHomes.com



Expect More. Get More.



Information is believed to be accurate but not guaranteed.



A Real Estate Expert *You Can Trust!*

ANTHONY STEEN
REALTOR®

O: 662.441.2500 C: 662.645.5151

Anthony@TomSmithLand.com

TomSmithLandandHomes.com



Expect More. Get More.





A Real Estate Expert *You Can Trust!*

ANTHONY STEEN
REALTOR®

O: 662.441.2500 C: 662.645.5151

Anthony@TomSmithLand.com

TomSmithLandandHomes.com



Expect More. Get More.



MAPS

Click for Interactive Map

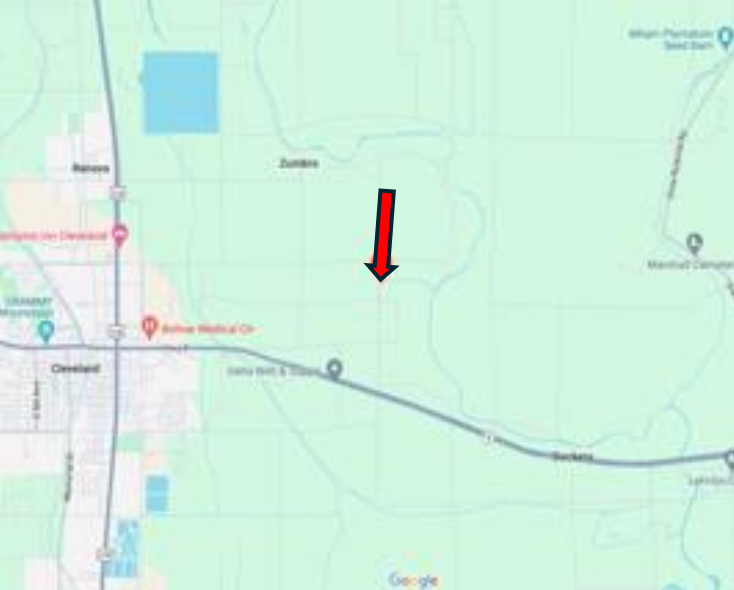

Address: 260 N Bolivar County Line Road Cleveland, MS 38732

Directions from US-278 & MS-8: Head east on MS-8 toward N Andrews Ave for 3.3 miles. Turn left onto N Bolivar County Rd/N Bolivar County Line Rd; after 1.6 miles, after 1.6 miles the house will be on the right. **Click for Google Maps**



**ANTHONY
STEEN**

REALTOR®

Office: 662.441.2500

Cell: 662.645.5151

Anthony@TomSmithLand.com



Expect More. Get More.

A Real Estate Expert You Can Trust

TomSmithLandandHomes.com

Information is believed to be accurate but not guaranteed.

