

# 5.6+/- ACRE HOMESITE IN MADISON COUNTY, MS



## \$92,500

Are you looking for the perfect site to build your dream home in the county? This 5.6± acre wooded property in Madison County, MS, located on Virgin Mary Road, offers the seclusion and privacy you desire. Water and power are available and located just 2 miles from HWY 16. The location is both convenient and peaceful. Enjoy easy access to nearby towns, with Carthage only 15 miles away and Canton just 17 miles away. Don't miss this opportunity—call Brady to schedule a showing today!



BRADY  
**RICHARDSON**  
REALTOR®

Office: 601.898.2772

Cell: 662.418.8791

Brady@TomSmithLand.com



Expect More. Get More.

**A Real Estate Expert You Can Trust**

TomSmithLandandHomes.com

Information is believed to be accurate but not guaranteed.







**A Real Estate Expert**  
*You Can Trust!*

**BRADY RICHARDSON**

REALTOR®

O: 601.898.2772 C: 662.418.8791

Brady@TomSmithLand.com

TomSmithLandandHomes.com



Expect More. Get More.



Information is believed to be accurate but not guaranteed.



# Aerial Map



CLICK [HERE](#) FOR THE INTERACTIVE MAP LINK

A Real Estate Expert  
*You Can Trust!*

**BRADY RICHARDSON**

REALTOR®

O: 601.898.2772 C: 662.418.8791

Brady@TomSmithLand.com

TomSmithLandandHomes.com



Expect More. Get More.



# Ownership Map

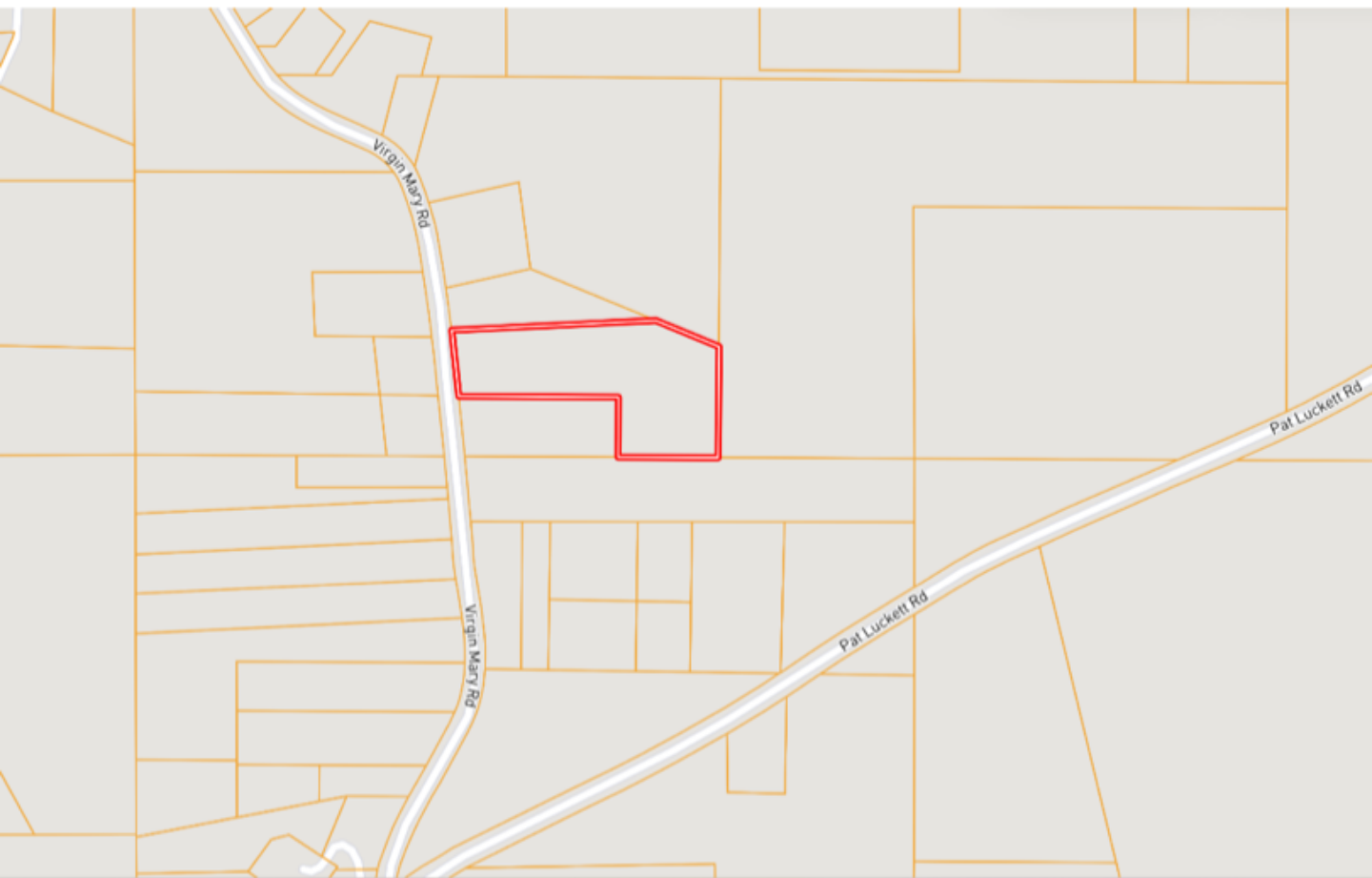

**A Real Estate Expert**  
*You Can Trust!*

**BRADY RICHARDSON**  
REALTOR®

O: 601.898.2772 C: 662.418.8791

Brady@TomSmithLand.com

TomSmithLandandHomes.com



Expect More. Get More.





# Topography Map

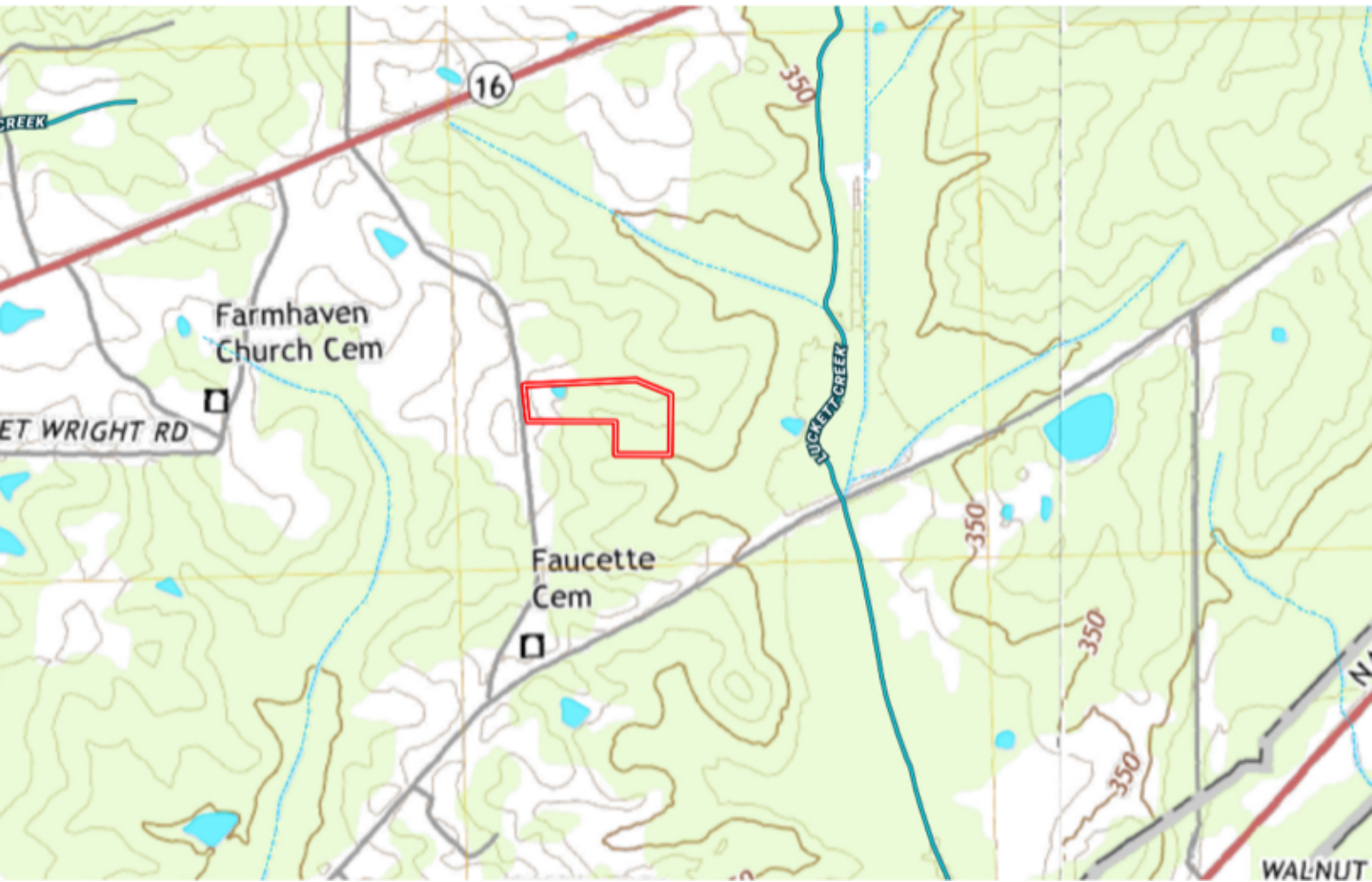

**A Real Estate Expert**  
*You Can Trust!*

**BRADY RICHARDSON**  
REALTOR®

O: 601.898.2772 C: 662.418.8791

Brady@TomSmithLand.com

TomSmithLandandHomes.com



Expect More. Get More.



# Directional Map

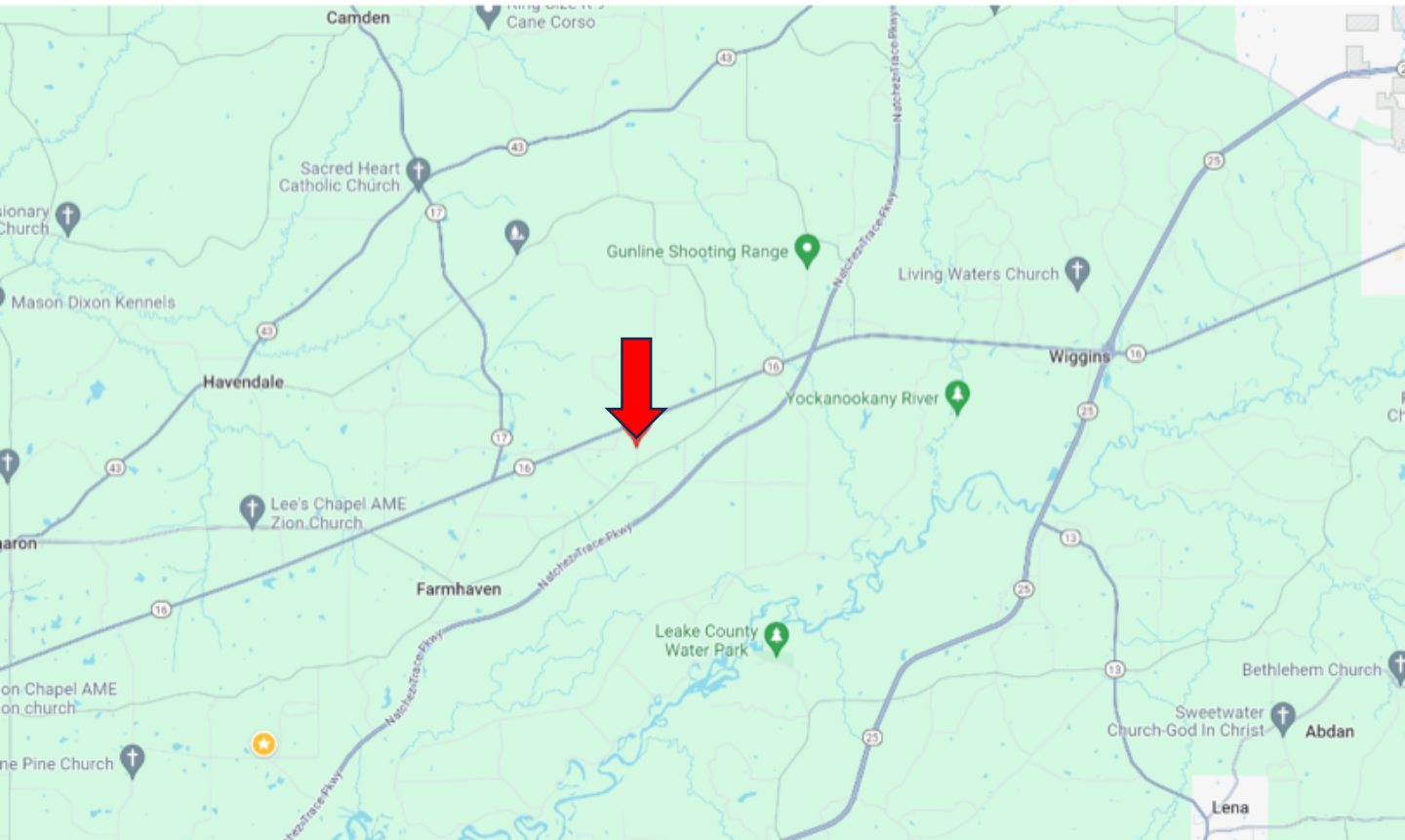

**Directions from the Intersection of Hwy 16 and Hwy 43 in Canton, MS:**  
Travel Hwy 16 E for 15.2 miles. Turn right onto Virgin Mary Road. After 0.4 miles, the property will be on the left. [Google Map Link](#)



**BRADY  
RICHARDSON**  
REALTOR®

Office: 601.898.2772

Cell: 662.418.8791

Brady@TomSmithLand.com



Expect More. Get More.

**A Real Estate Expert You Can Trust**

TomSmithLandandHomes.com

Information is believed to be accurate but not guaranteed.

