

# Investment Property in Bolivar County

## 2544 Highway 8 W, Cleveland, MS 38732



**\$150,000**

This income-generating property, located at 2544 HWY 8 West in Bolivar County, includes four trailers, each currently rented at \$500 monthly. Tenants cover their electricity expenses, and the property generates approximately \$2,000 in monthly rental income. Priced at \$150,000, this property offers an excellent opportunity for anyone looking to generate passive income. Don't miss out on this investment opportunity - call Anthony Steen today!



**ANTHONY  
STEEN**

REALTOR®

Office: 662.441.2500

Cell: 662.645.5151

[Anthony@TomSmithLand.com](mailto:Anthony@TomSmithLand.com)



Expect More. Get More.

**A Real Estate Expert You Can Trust**

[TomSmithLandandHomes.com](http://TomSmithLandandHomes.com)

Information is believed to be accurate but not guaranteed.





**A Real Estate Expert**  
*You Can Trust!*

**ANTHONY STEEN**  
REALTOR®

O: 662.441.2500 C: 662.645.5151

Anthony@TomSmithLand.com

TomSmithLandandHomes.com



Expect More. Get More.



Information is believed to be accurate but not guaranteed.



**A Real Estate Expert**  
*You Can Trust!*

**ANTHONY STEEN**  
REALTOR®

O: 662.441.2500 C: 662.645.5151

Anthony@TomSmithLand.com

TomSmithLandandHomes.com



Expect More. Get More.



Information is believed to be accurate but not guaranteed.

# MAPS

[Click for the Interactive Map](#)

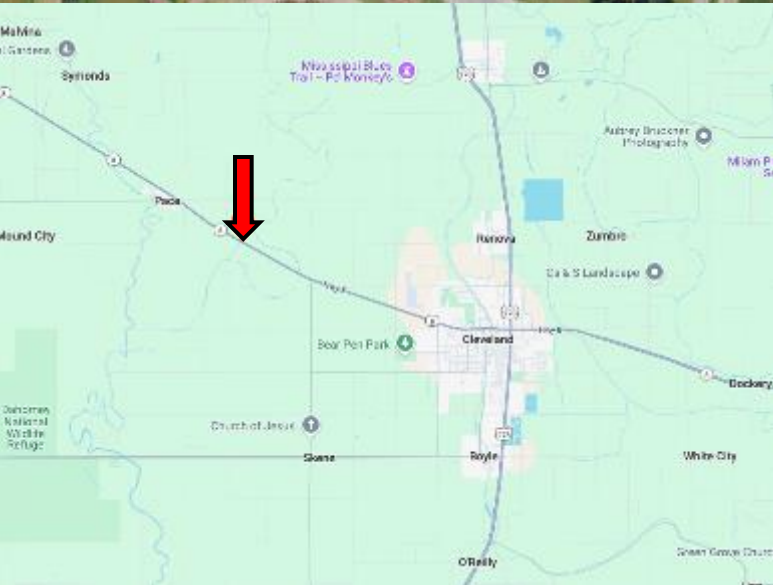
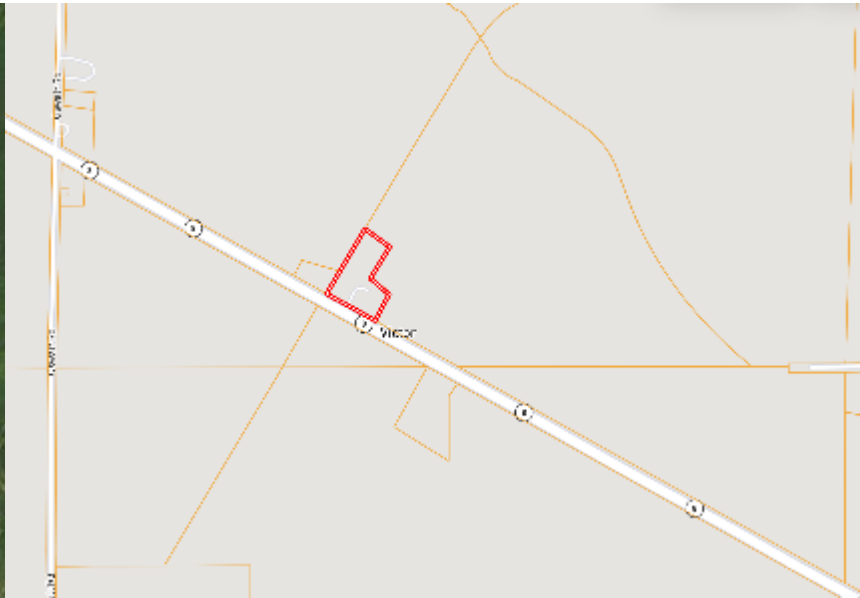

**Address:** 2544 Highway 8 W,  
Cleveland, MS 38732

**Directions from US-278 & MS-8,**  
**in Cleveland, MS:** Travel  
west on MS-8 W for 6.8 miles.  
The property will be on the right.

[Google Map Link](#)



**ANTHONY  
STEEN**

REALTOR®

Office: 662.441.2500

Cell: 662.645.5151

Anthony@TomSmithLand.com



Expect More. Get More.

**A Real Estate Expert You Can Trust**

TomSmithLandandHomes.com

Information is believed to be accurate but not guaranteed.

