

MISSISSIPPI DELTA HOME

207 East Gresham Street, Indianola, MS 38751



This beautiful Mississippi Delta home in Sunflower County, offers three bedrooms and four bathrooms and is 3,132 square feet. It's a must-see in person with original hardwood flooring throughout, updated kitchen and bathrooms, and fresh interior paint. Centrally located in Indianola, this turnkey property is move-in ready. It combines modern updates with the timeless Mississippi Delta charm that's hard to find. Don't miss out—call us today to schedule a viewing!

A Real Estate Expert
You Can Trust!

EMERSON LOVELACE
REALTOR®

O: 662.441.2500 C: 601.715.3302

Emerson@TomSmithLand.com

TomSmithLandandHomes.com



Expect More. Get More.



Information is believed to be accurate but not guaranteed.



A Real Estate Expert
You Can Trust!

EMERSON LOVELACE
REALTOR®

O: 662.441.2500 C: 601.715.3302

Emerson@TomSmithLand.com

TomSmithLandandHomes.com



Expect More. Get More.



Information is believed to be accurate but not guaranteed.



A Real Estate Expert *You Can Trust!*

EMERSON LOVELACE
REALTOR®

O: 662.441.2500 C: 601.715.3302

Emerson@TomSmithLand.com

TomSmithLandandHomes.com



Expect More. Get More.



Information is believed to be accurate but not guaranteed.



A Real Estate Expert You Can Trust!

EMERSON LOVELACE
REALTOR®

O: 662.441.2500 C: 601.715.3302

Emerson@TomSmithLand.com

TomSmithLandandHomes.com



Expect More. Get More.



Information is believed to be accurate but not guaranteed.

Maps

[Click Here for the Interactive Map Link](#)

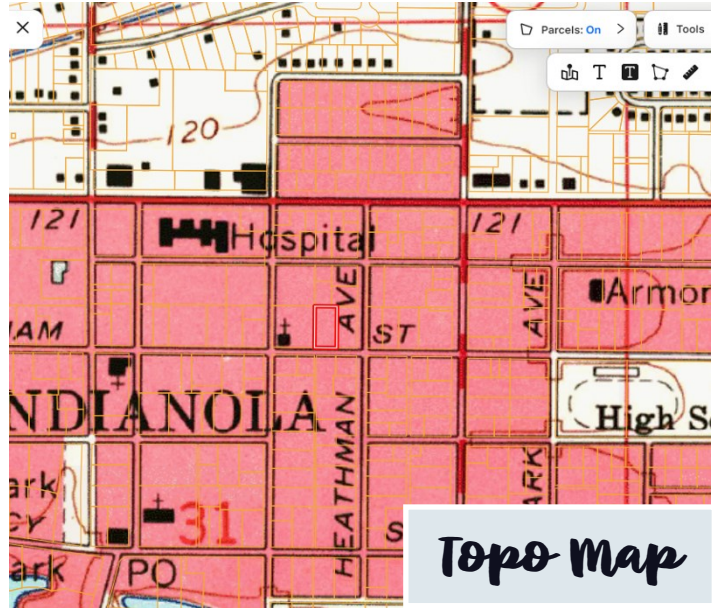
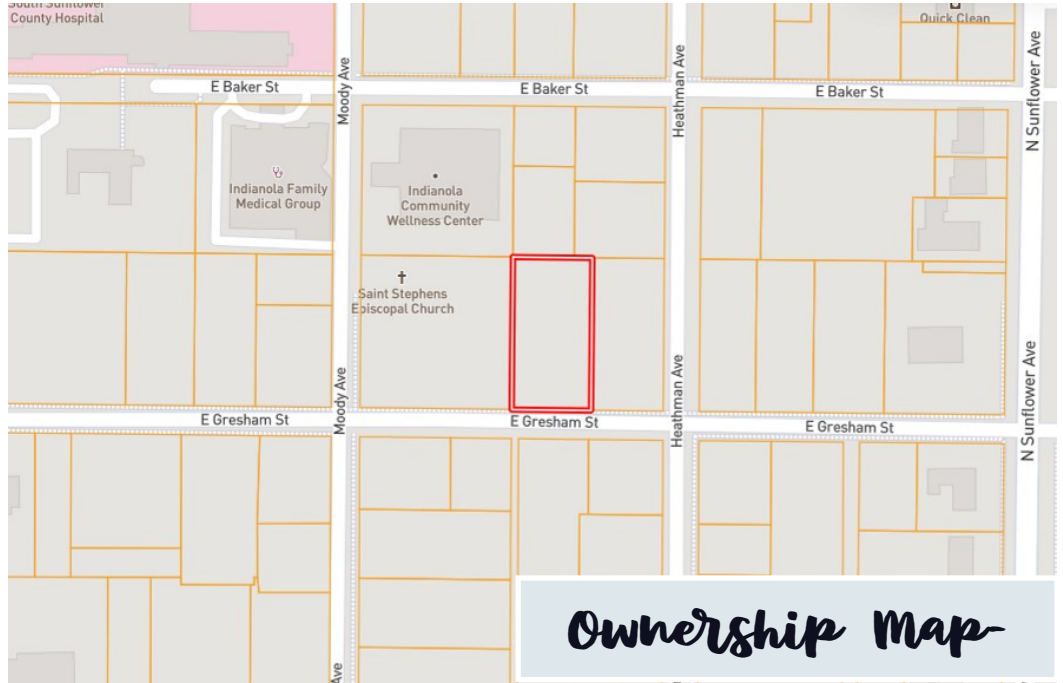

A Real Estate Expert
You Can Trust!

EMERSON LOVELACE
REALTOR®

O: 662.441.2500 C: 601.715.3302
Emerson@TomSmithLand.com
TomSmithLandandHomes.com



Expect More. Get More.



Information is believed to be accurate but not guaranteed.

Directional Map

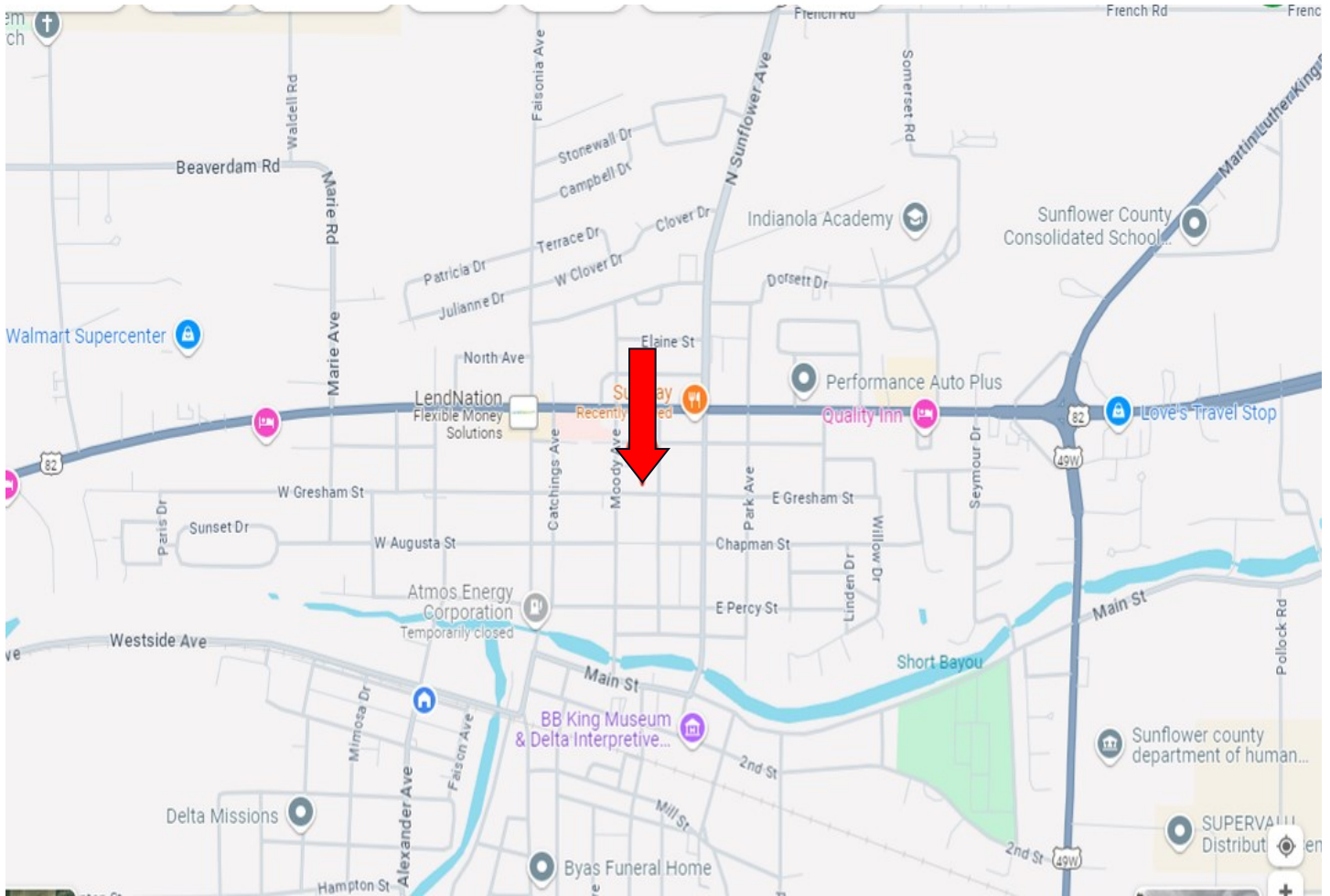

Directions from Hwy 49 and Hwy 82 in Indianola, MS: Travel Hwy 82 for .7 miles. Turn left onto N Sunflower Avenue and travel .2 miles. Turn right on East Gresham Street, after passing Heathman the home will be the second home on the right. Click for Google Map link: [207 East Gresham Street. Indianola, MS 38751](https://www.google.com/maps/place/207+East+Gresham+Street,+Indianola,+MS+38751)

**A Real Estate Expert
You Can Trust!**



EMERSON LOVELACE

REALTOR®

O: 662.441.2500 C: 601.715.3302

Emerson@TomSmithLand.com

TomSmithLandandHomes.com

Expect More. Get More.



Information is believed to be accurate but not guaranteed.