

Spacious Home with Pool and Workshop in Bolivar County

1472 Memorial Drive, Boyle, MS 38730



\$279,500

This four-bedroom, three-bathroom home in Bolivar County offers 2,583 square feet of living space on a 0.74± acre lot. Built in 1978, the house features scored concrete floors, gas fireplace in the living area, and a kitchen equipped with stainless appliances. The backyard includes a swimming pool for enjoying warm days, while the two-car carport provides convenient covered parking. A 1,700-square-foot shop provides space for storage, hobbies, or projects. This property offers a comfortable living space with room to suit various needs. Call Emerson to schedule your tour today!



**EMERSON
LOVELACE**

REALTOR®

Office: 662.441.2500

Cell: 601.715.3302

Emerson@TomSmithLand.com



Expect More. Get More.

A Real Estate Expert You Can Trust

TomSmithLandandHomes.com

Information is believed to be accurate but not guaranteed.





**A Real Estate Expert
You Can Trust!**

EMERSON LOVELACE
REALTOR®

O: 662.441.2500 C: 601.715.3302

Emerson@TomSmithLand.com

TomSmithLandandHomes.com

**Tom
Smith
LAND AND
HOMES**

Expect More. Get More.

1st Report
2011-2024
BEST
BROKERAGES

Information is believed to be accurate but not guaranteed.



A Real Estate Expert *You Can Trust!*

EMERSON LOVELACE
REALTOR®

O: 662.441.2500 C: 601.715.3302

Emerson@TomSmithLand.com

TomSmithLandandHomes.com



Expect More. Get More.



Information is believed to be accurate but not guaranteed.

MAPS

[Click Here for the Interactive Map Link](#)

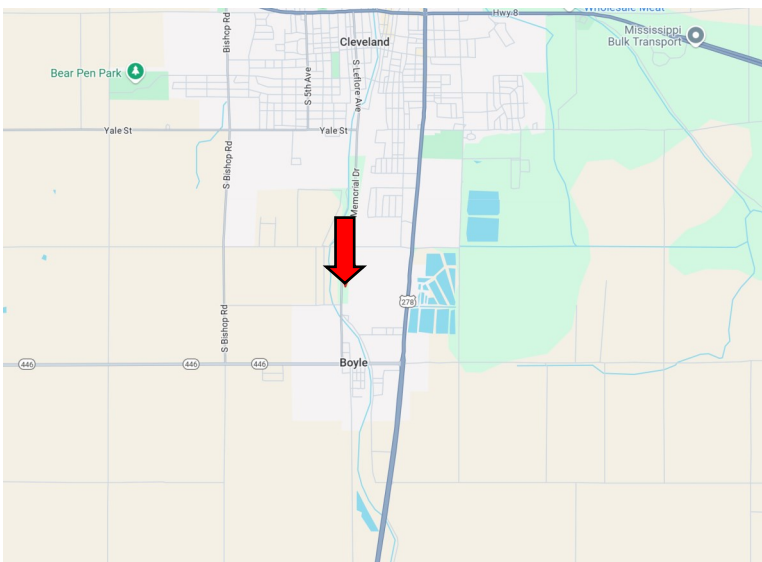
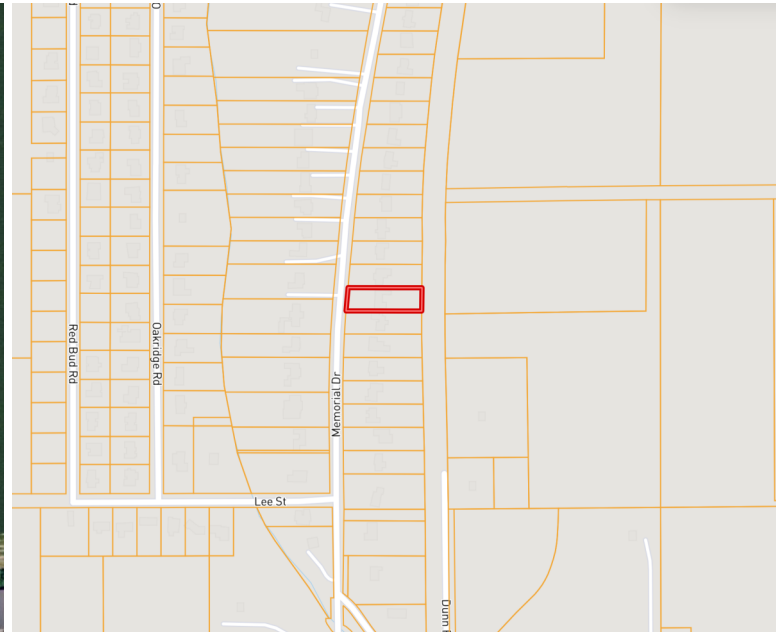

Directions from the Intersection of Hwy 8 and Hwy 278 in Cleveland, MS: Travel Hwy 278W for 2 miles. Turn right onto Laughlin Road and travel 0.6 miles. Turn left onto Memorial Drive. After 0.3 miles, the home will be on your left.

1472 Memorial Drive, Boyle, MS 38730

[Click for Google Map Link](#)



**EMERSON
LOVELACE**

REALTOR®

Office: 662.441.2500

Cell: 601.715.3302

Emerson@TomSmithLand.com



Expect More. Get More.

A Real Estate Expert You Can Trust

TomSmithLandandHomes.com

Information is believed to be accurate but not guaranteed.

