

CHARMING HOME IN THE HEART OF PEARL

203 Pearl Drive, Pearl, MS 39208



\$160,500

Located in the heart of Pearl, this charming 4-bedroom, 1-bathroom home has 1,220+/- sq feet of living space. The former carport has been thoughtfully converted into a spacious primary bedroom, offering added comfort and functionality. Inside, the home features modern updates, including recently installed laminate hardwood flooring throughout and a remodeled bathroom. It has a gas stove, heater, and hot water heater, ensuring efficiency and convenience. Step outside to enjoy the spacious backyard, perfect for outdoor gatherings or relaxation. This property is ideally located just minutes from Pearl's most popular attractions, including the Pearl Senior Center, Pearl Community Center, Outlets of Mississippi, Sam's Club, Bass Pro, Mississippi's minor league baseball stadium, and various dining options. With its blend of updates, location, and charm, this Rankin County home is a must-see!



**COLBY
WATSON**

REALTOR®

Office: 601.898.2772

Cell: 601.668.8096

Colby@TomSmithLand.com



Expect More. Get More.

A Real Estate Expert You Can Trust

TomSmithLandandHomes.com

Information is believed to be accurate but not guaranteed.





A Real Estate Expert You Can Trust!

COLBY WATSON
REALTOR®

O: 601.898.2772 C: 601.668.8096

Colby@TomSmithLand.com

TomSmithLandandHomes.com

**Tom
Smith**
LAND AND
HOMES

Expect More. Get More.

2011-2024
BEST
BROKERAGES

Information is believed to be accurate but not guaranteed.



A Real Estate Expert
You Can Trust!

COLBY WATSON
REALTOR®

O: 601.898.2772 C: 601.668.8096

Colby@TomSmithLand.com

TomSmithLandandHomes.com



Expect More. Get More.



Information is believed to be accurate but not guaranteed.

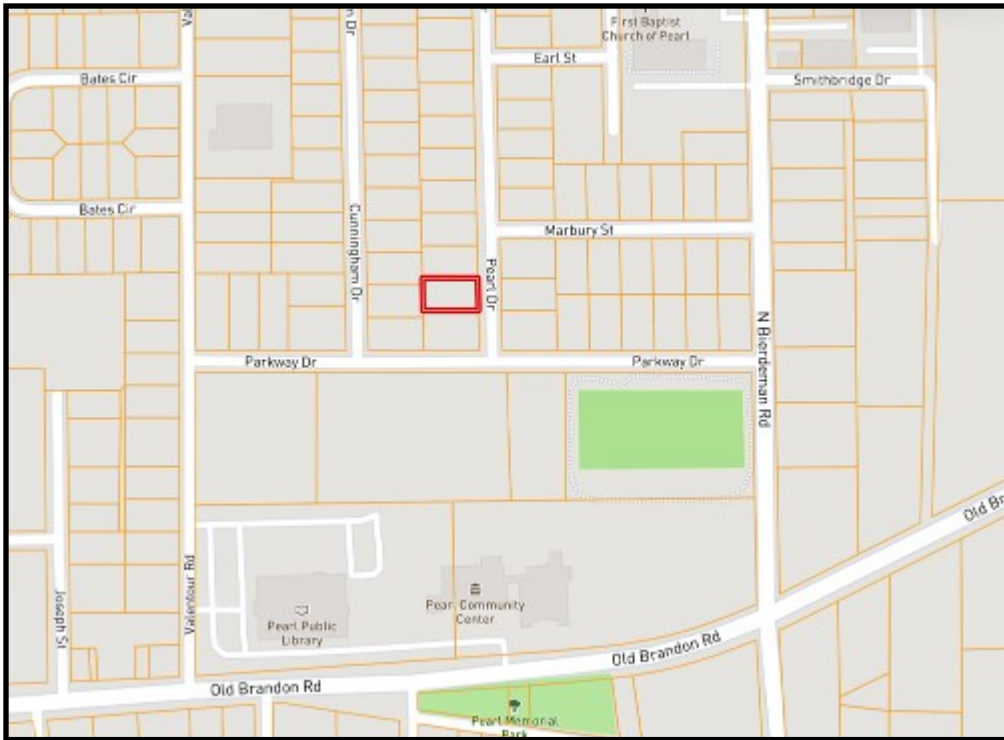

Ownership Map



Aerial Map

[Click Here for an Interactive Map](#)

A Real Estate Expert
You Can Trust!

COLBY WATSON
REALTOR®

O: 601.898.2772 C: 601.668.8096

Colby@TomSmithLand.com

TomSmithLandandHomes.com



Expect More. Get More.



Information is believed to be accurate but not guaranteed.

Directional Map

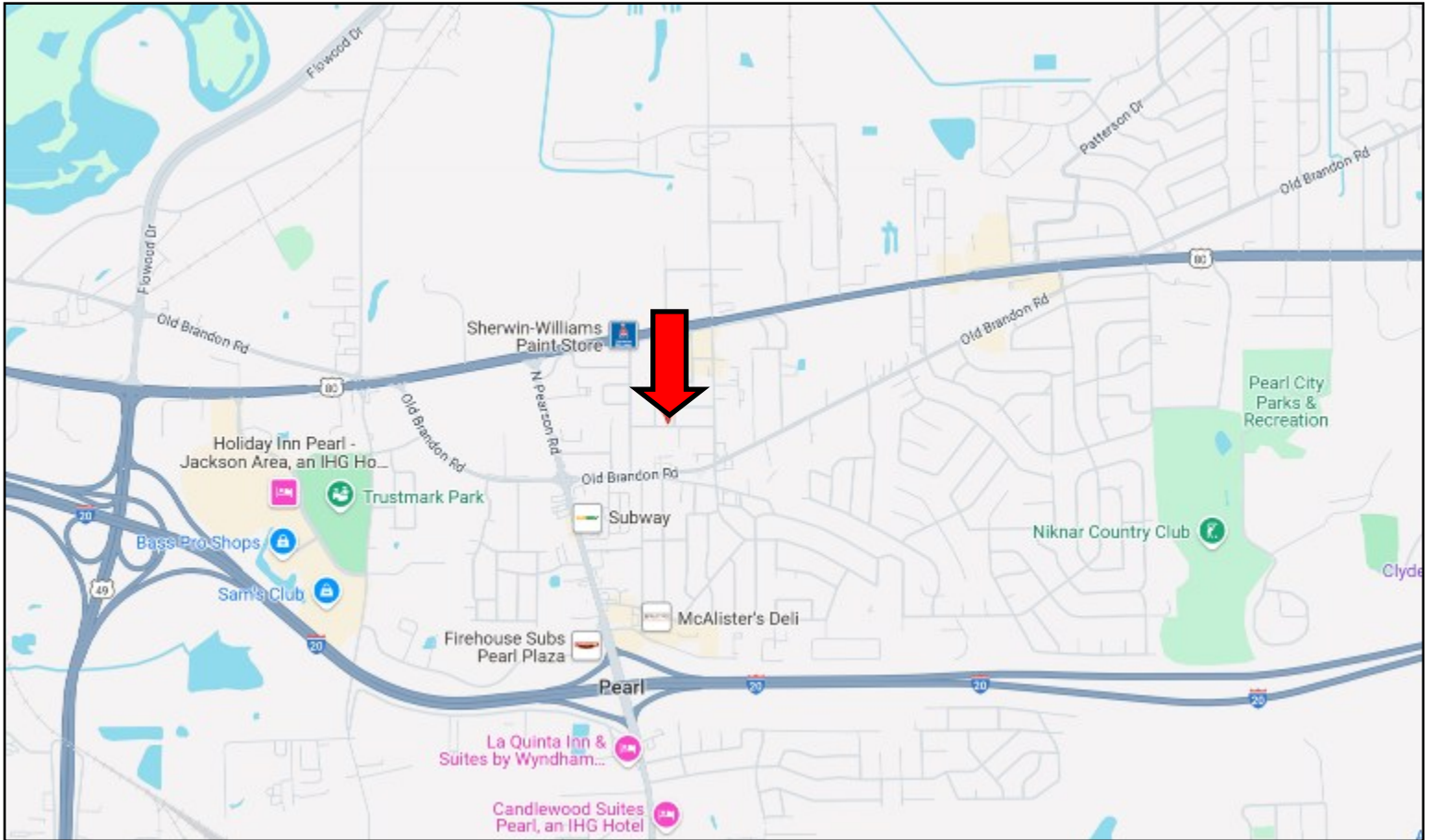

Directions from I-20 in Pearl, MS: Take exit 48 for Pearson Road. Turn onto Pearson Road and travel 0.8 miles. Turn right onto Old Brandon Road and travel .2 miles. Turn left onto Valentour Road and travel 0.1 miles. Turn right onto Parkway Drive and travel 0.1 miles. Turn left onto Pearl Drive. The home will be the first house on the left.

[203 Pearl Drive, Pearl, MS 39208](#)—Click for Google Map Link



**COLBY
WATSON**

REALTOR®

Office: 601.898.2772

Cell: 601.668.8096

Colby@TomSmithLand.com



Expect More. Get More.

A Real Estate Expert You Can Trust

TomSmithLandandHomes.com

Information is believed to be accurate but not guaranteed.

