

Greg West R.P.L.S.
8405 Delavan Ave.
Austin, Texas 78717



Ph. (512) 258-6842
Fax (512) 255-6748
~~Pg. (512) 397-3520~~

FIELDNOTE DESCRIPTION
2.331 Acre cutout for David Stone

BEING A 2.331 ACRE TRACT OF LAND OUT OF A PART OF THE MCKINNEY & WILLIAMS SURVEY, ABSTRACT NO. 460, SITUATED IN WILLIAMSON COUNTY, TEXAS, BEING PART OF THE 92.5 ACRE (LESS 30.36 AC.) AS DESCRIBED IN A DEED TO ERNEST L. RISTER AS RECORDED IN VOLUME 1202, PAGE 760 OFFICIAL RECORDS OF WILLIAMSON COUNTY, TEXAS, AND A PART OF THE TRACT CALLED 61.81 ACRES DESCRIBED IN A DEED TO ERNEST L. RISTER AS RECORDED IN VOLUME 509, PAGE 95 DEED RECORDS OF SAID COUNTY, SAID 2.331 ACRE CUTOUT BEING MORE PARTICULARLY DESCRIBED BY METES AND BOUNDS AS FOLLOWS:

COMMENCING at a ½ inch diameter reinforcing bar found in the South Right of way line of County Road No. 330 for the Northeast corner of Lot 2, Block "A" of RISTER BARAN Subdivision the plat of which is recorded in Cabinet "X", Slide 78 of the Plat Records of Williamson County, Texas, same corner being the most Northerly corner of an original 111.25 acres comprised of the above mentioned tracts minus the said Lot 2, Block "A" of Rister Baran Subdivision;

THENCE departing the said Rister Baran Subdivision and along the South line of the aforementioned County Road No. 330, South 73d 53' 46" East, a distance of 311.04 feet to a point for the Northwest corner and POINT OF BEGINNING of the herein described 2.331 acre tract;

THENCE continuing along said C.R. 330 and the North line of the herein described tract, South 73d 53' 46" East, a distance of 32.74 feet to a point for the Northeast corner of the herein described tract;

THENCE departing the said South line of County Road No. 330 and crossing said Original 111.25 acre tract the following Nine (9) courses:

South 39d 42' 54" West, a distance of 339.48 feet to an angle point;

South 05d 51' 58" West, a distance of 1,595.25 feet to an angle point and entrance to the 1 acre "house site";

South 76d 07' 06" East, a distance of 109.34 feet to a point for the Easterly corner of said "house site";

Page Two: 2.331 acre tract continued.....

South 22d 52' 54" West a distance of 208.42 feet to a point for the Southerly corner of said "house site";

North 67d 07' 06" West, a distance of 209.00 feet to a point for the Westerly corner of said "house site";

North 22d 52' 54" East, a distance of 208.42 feet to a point for the Northerly corner of said "house site";

South 67d 07' 06" East, a distance of 68.29 feet to an angle point and entrance to the said 1 acre "house site";

Departing the "house site", North 05d 51' 58" East, a distance of 1,595.20 feet to an angle point;

North 39d 42' 54" East, a distance of 335.49 feet to the **POINT OF BEGINNING** and containing a calculated area of **2.331 Acres** of land subject to easements, conditions or restrictions of record, if any.

I hereby certify that the foregoing Field Notes were prepared from a survey on-the-ground, under my supervision and are true and correct to the best of my knowledge and belief.

Witness my hand and seal this the 1st day of December 2008.

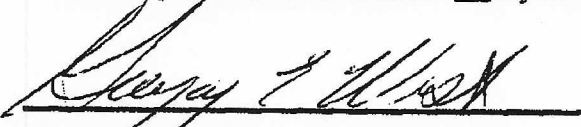
Gregory E. West, R.P.L.S. No. 4188
WEST SURVEYORS, INC.
8405 Delavan Avenue
Austin, Texas 78701
Project No. S094-01

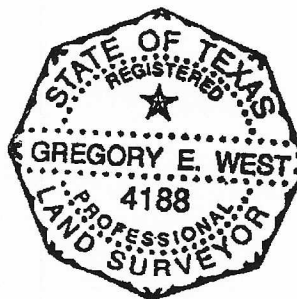

'EXHIBIT'

County Road 330



Scale: 1"=200'

1/2" rebar fnd.
Point of
Commencement

Point of
Beginning

Lot 2, Block "A"
RISTER BARAN Subdivision
Cob. "X", Slide 78

S20°00'00"W 1000.00'

1/2" rebar fnd.
N73°00'00"W
435.60'

1/2" rebar fnd.

S73°53'46"E
311.04'

S73°53'46"E
32.74'

N39°42'54"E
335.49'

S39°42'54"W
339.48'

Original
111.25 Acres

N5°51'58"E 1595.20'

S5°51'58"W 1595.25'

barbed wire fenceline

S67°07'06"E
68.29'

S67°07'06"E
109.34'

Staked
Future House

N22°52'54"E
208.42'

S22°52'54"W
208.42'

N67°07'06"W
209.00'

1/2" rebar set
with lath & ribbon
(typical)

2.331 Acres. (total)

WEST SURVEYORS, INC.

8405 Delavan Avenue
Austin, Texas 78717
Ph. (512) 258-6842
Fax. (512) 255-8748
Project No. S094-01