

0.12± Acre Residential Development Lot in Cleveland, MS

1203 S. Chrisman Avenue, Cleveland, MS | \$7,500



Take advantage of this excellent opportunity to build your dream home on this 0.12± acre lot in Cleveland, Bolivar County! The property is located within the Cleveland city limits and offers easy access to electricity, water, and sewer services.

Don't miss out—Contact Charlie Heinsz today to schedule your private showing and learn more about this property!



**CHARLIE
HEINSZ**

REALTOR®

Office: 662.441.2500

Cell: 662.719.7218

Charlie@TomSmithLand.com



Expect More. Get More.

A Real Estate Expert You Can Trust

TomSmithLandandHomes.com

Information is believed to be accurate but not guaranteed.



MAPS | [Click for Interactive Map](#)

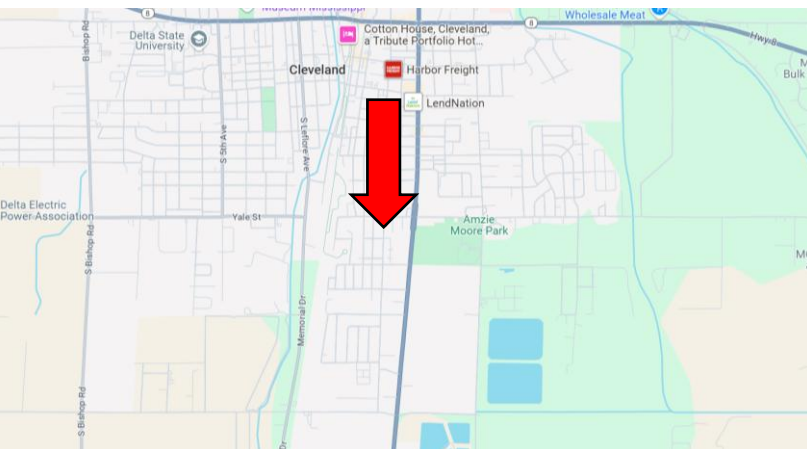
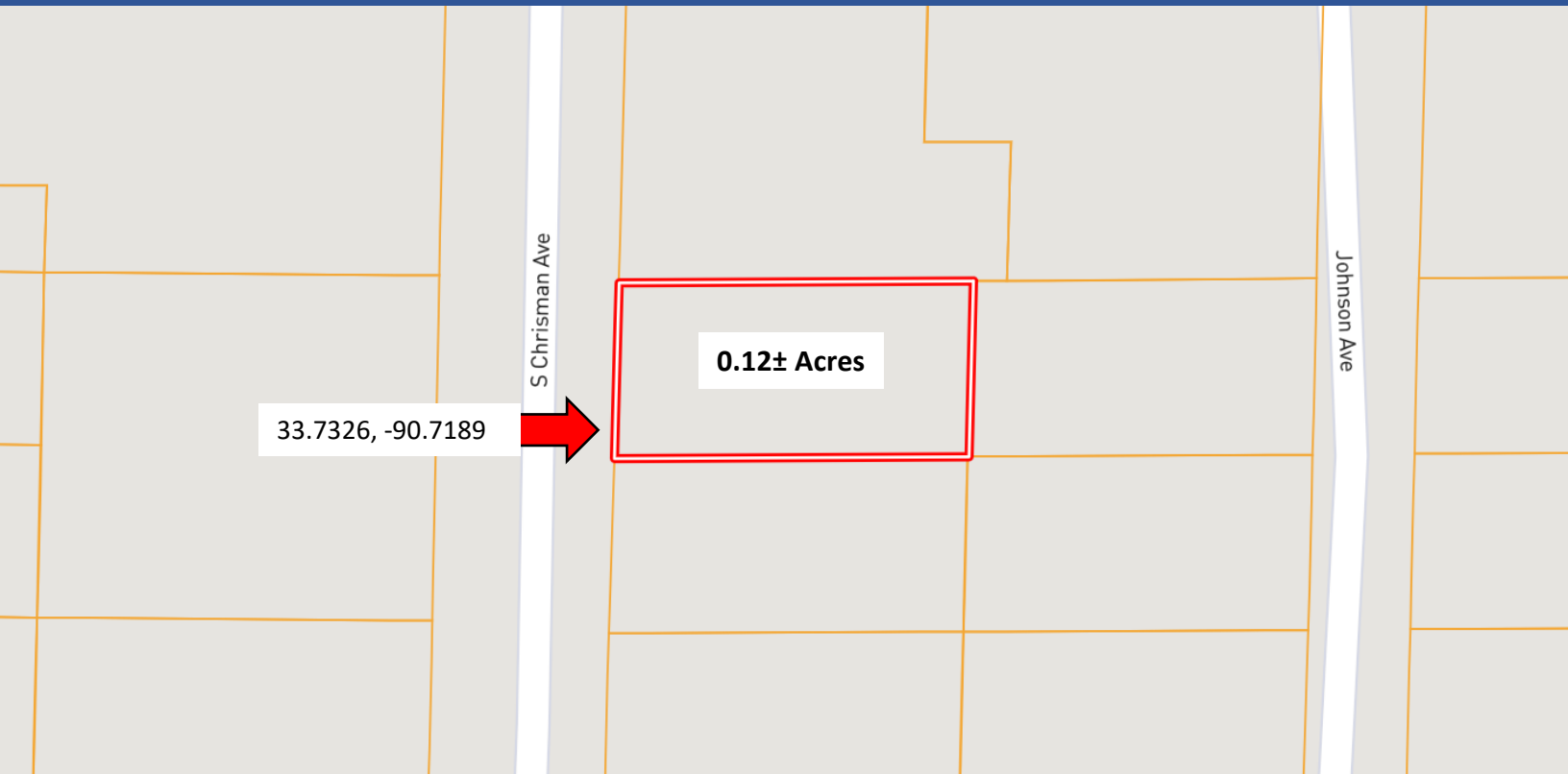

Address: 1203 S. Chrisman Avenue Cleveland, MS 38732

Directions from Hwy 8 & Hwy 61 in Cleveland:

Travel south on Hwy 61 for 1 mile. Turn right on White Street. After 217 feet, the property will be on the left.

[Click for Google Maps](#)



**CHARLIE
HEINSZ**
REALTOR®

Office: 662.441.2500

Cell: 662.719.7218

Charlie@TomSmithLand.com



Expect More. Get More.

A Real Estate Expert You Can Trust

TomSmithLandandHomes.com

Information is believed to be accurate but not guaranteed.

