

0.11± Acre lot in Hinds County

920 Craft St, Jackson, MS 39209

\$30,000



Check out this 0.11± acre lot located at 920 Craft St, Jackson, MS, Hinds County. This lot is ideal for those seeking to invest in a property with excellent potential. This lot features a small fixer-upper home that is waiting for your personal touch. You can build your very own forever house or investment property! Don't miss this unique opportunity to create a customized living space. Schedule a viewing today and envision the possibilities!



LAYTON HORNE
REALTOR®

O: 601.898.2772 | C: 601.624.1282
Layton@TomSmithLand.com



Expect More. Get More.



ANTHONY STEEN
REALTOR®

O: 601.898.2772 | C: 662.645.5151
Anthony@TomSmithLand.com

TomSmithLandandHomes.com

Information is believed to be accurate but not guaranteed





LAYTON HORNE
REALTOR®

O: 601.898.2772 | C: 601.624.1282
Layton@TomSmithLand.com



ANTHONY STEEN
REALTOR®

O: 601.898.2772 | C: 662.645.5151
Anthony@TomSmithLand.com

TomSmithLandandHomes.com

Information is believed to be accurate but not guaranteed





LAYTON HORNE
REALTOR®

O: 601.898.2772 | C: 601.624.1282
Layton@TomSmithLand.com



ANTHONY STEEN
REALTOR®

O: 601.898.2772 | C: 662.645.5151
Anthony@TomSmithLand.com

TomSmithLandandHomes.com

Information is believed to be accurate but not guaranteed.



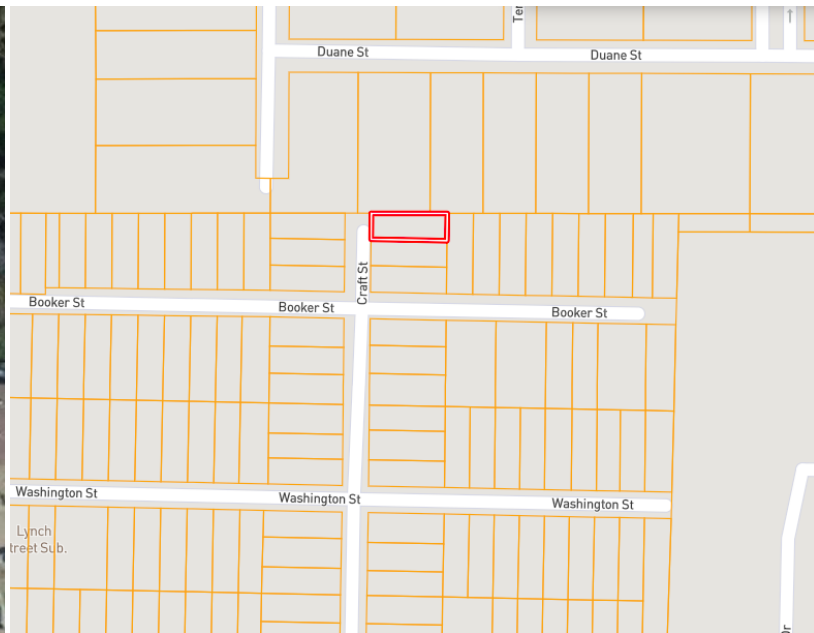

**Address: 920 Craft Street
Jackson, MS 39209**

**Directions from Hwy 18 and I-20,
Jackson, MS:** Travel northeast on MS-18
E for 0.6 miles. Turn right toward John
R. Lynch Street for 410 feet.
Turn left onto John R. Lynch Street for
1.5 miles. Turn left onto Craft St. After
0.3 miles, the lot will be on the right.
[Google Maps Link](#)

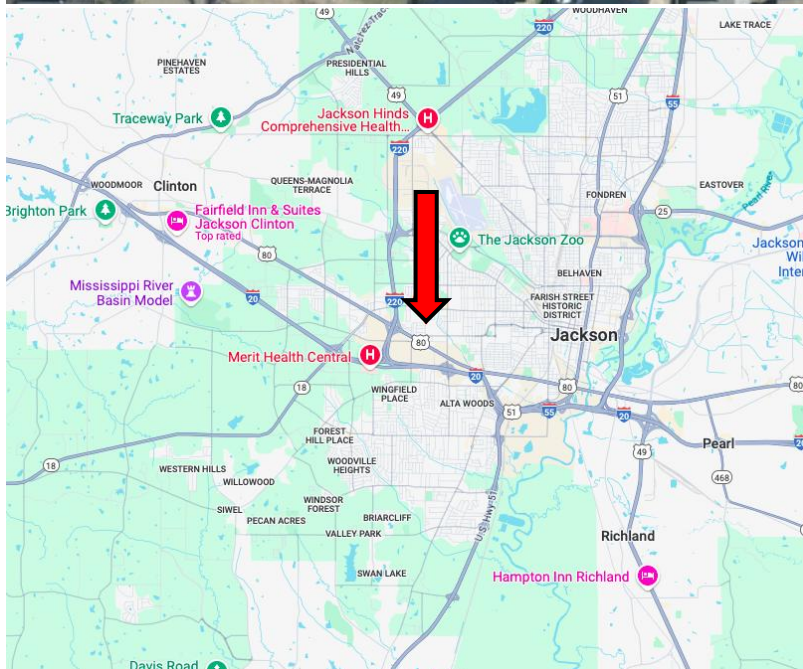

LAYTON HORNE
REALTOR®

O: 601.898.2772 | C: 601.624.1282
Layton@TomSmithLand.com



Expect More. Get More.



ANTHONY STEEN
REALTOR®

O: 601.898.2772 | C: 662.645.5151
Anthony@TomSmithLand.com