

SYMBOL LEGEND

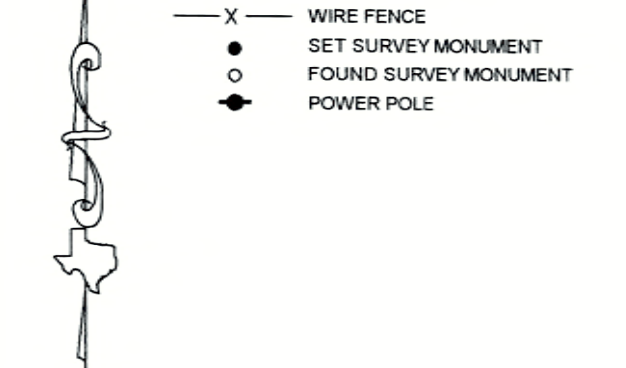

LINE	BEARING	DISTANCE
L1	N 73°18'32" E	65.83'
L2	N 73°42'01" E	245.41'
L3	N 75°39'48" E	86.46'
L4	N 82°42'11" E	105.74'
L5	N 87°39'38" E	245.95'
L6	S 88°36'53" E	208.36'
L7	S 85°28'15" E	213.91'
L8	S 92°43'13" E	219.75'
L9	S 84°02'47" E	221.89'
L10	S 85°22'45" E	228.44'
L11	N 83°40'07" E	205.88'
L12	N 59°12'28" E	220.00'
L13	N 31°18'12" E	177.74'
L14	N 13°56'26" E	194.33'
L15	N 02°14'58" E	86.49'
L16	N 68°19'39" W	125.57'
L17	N 69°12'16" W	305.67'
L18	N 69°03'35" W	679.41'
L19	N 69°11'13" W	297.77'
L20	N 69°00'35" W	769.27'
L21	N 02°28'41" W	100.35'
L22	N 68°51'01" W	400.75'
L23	N 87°13'22" E	420.46'
L24	S 02°40'48" E	210.00'
L25	S 86°54'08" W	418.34'
L26	N 02°59'33" W	212.35'



BEING a 146.600 acre tract situated in the Edward West Survey, Abstract Number 339, Morris County, Texas, being comprised of a portion of that certain called 724.58 acre tract described as "Tract 2", all that same called 46.337 acre tract described as "Tract 3" and the remainder of that certain called 70 acre tract described as "Tract 4", all in instrument to Maya Timber, LLC, recorded in Volume 556, Page 415 of the Official Public Records of Morris County, Texas (O.P.R.M.C.T.), said 146.600 acre tract being more particularly described by attached metes and bounds description.

General Notes
 1) This survey was performed without benefit of a current title report. Surveyor did not abstract title and does not certify to easements or restrictions not shown. Check with your local governing agencies for any additional easements, building lines or other restrictions not reflected on survey.

Job No: 25299
 Scale: 1"=200'
 Date: 09/20/22
 Drawn By: MJW
 Checked By: DM
 Field Crew: GG

Purchaser:
 Address: CR 2115 & CR 4114 Hughes Springs, Tx 75656
 Lot: _____ Block: _____ Section: _____
 Survey: Edward West Abstract No. 339
 Area: 146.600 (net) Acres
 Subdivision: _____
 Cabinet: _____ Sheet: _____ Records: _____
 Morris County, Texas

Bearings shown hereon are based on GPS observations and are referenced to the NAD83, Texas State Plane Coordinate System, North Central Zone (4202).
 Basis of Bearings: grid measurements.

I HEREBY CERTIFY THAT THIS SURVEY WAS THIS DAY MADE UNDER MY SUPERVISION ON THE GROUND OF THE ABOVE DESCRIBED PROPERTY AND THAT THE ABOVE PLAT OR DRAWING REFLECTS THE FINDINGS ON THE GROUND OF THE PROPERTY AT THIS TIME AND THAT THIS SURVEY MEETS THE MINIMUM STANDARDS OF PRACTICE AS APPROVED BY THE TEXAS BOARD OF PROFESSIONAL LAND SURVEYING.

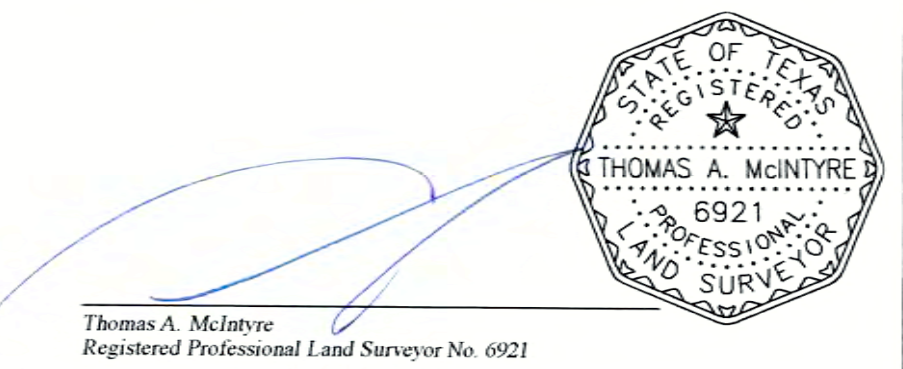

Thomas A. McIntyre
 Registered Professional Land Surveyor No. 6921