

Multi-Use Development Tract in Grenada County, MS 35+/- Acres in the City of Grenada



This 35+/- acres is located in the city of Grenada, Mississippi and is ready for development TODAY! This property has all utilities available with paved road frontage on Perry Road, Commerce Street, and Windmill Street. The property is located directly in the bullseye of growth in Grenada County! Call Tom today!

DIRECTIONS FROM I-55 S: Take exit 206 for MS-7 S/MS-8 toward Grenada/Greenwood, turn left onto MS-7 N/MS-8 E/ Hwy 8 E and travel 2.4 miles, turn right onto US-51 S/Commerce St and travel 3.3 miles, turn right onto Perry Rd. Property is located on right side of Perry Road, just before the Dogwood Apartment Complex Entrance. [Click for Google Map Link](#)



Call The Land Man today!

TOM SMITH, ALC, BROKER®
Tom@TomSmithLand.com
601.898.2772 office | 601.454.9397 cell



TomSmithLand.com

Information is believed to be accurate but not guaranteed.



Expect More. Get More.

TOM SMITH, ALC, BROKER®

Tom@TomSmithLand.com

601.898.2772 office | 601.454.9397 cell



TomSmithLand.com

Information is believed to be accurate but not guaranteed.

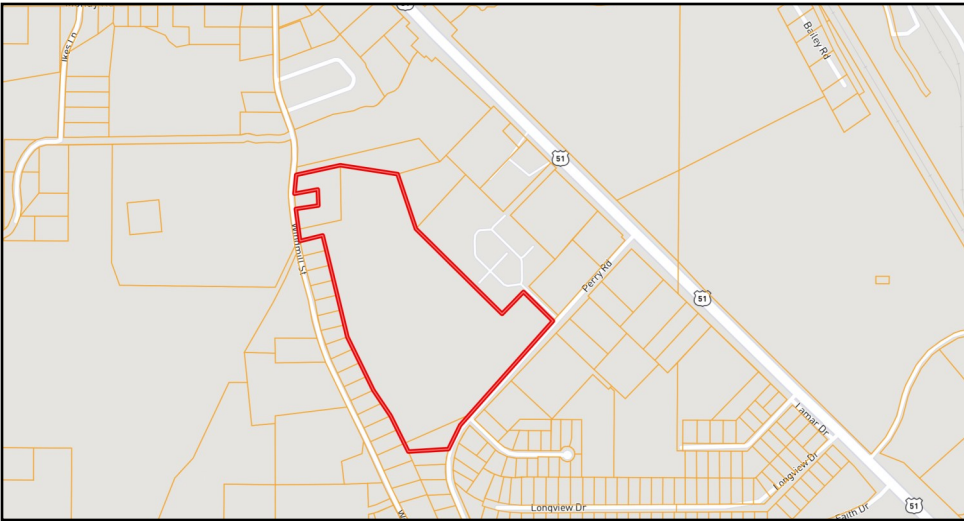

Ownership Map

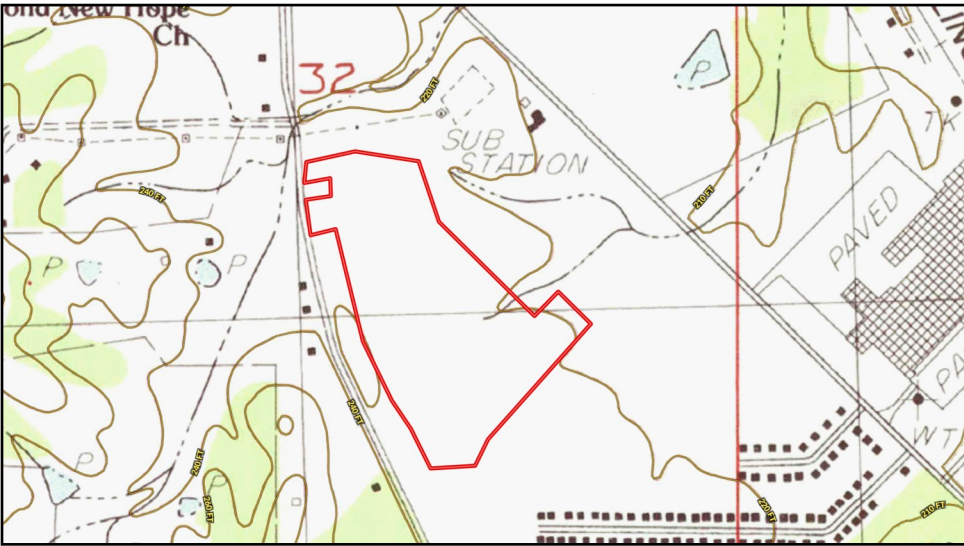

Topo Map



Floodplain



TOM SMITH, ALC, BROKER®

Tom@TomSmithLand.com

601.898.2772 office | 601.454.9397 cell



TomSmithLand.com

Information is believed to be accurate but not guaranteed.

Aerial Map



[Click for Interactive Map](#)

TOM SMITH, ALC, BROKER®
Tom@TomSmithLand.com
601.898.2772 office | 601.454.9397 cell



TomSmithLand.com

Information is believed to be accurate but not guaranteed.

Directional Map

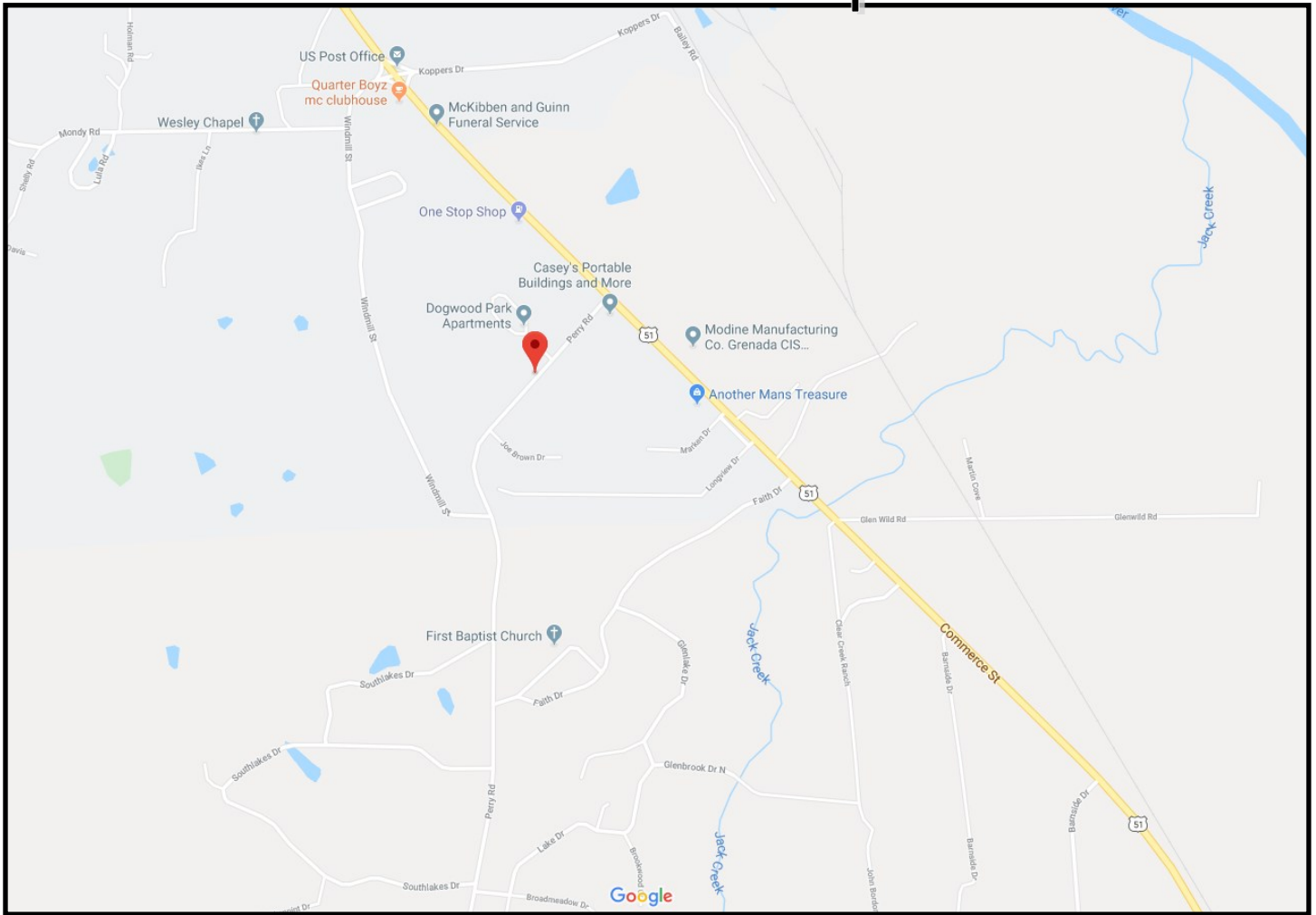

DIRECTIONS FROM I-55 S: Take exit 206 for MS-7 S/MS-8 toward Grenada/Greenwood, turn left onto MS-7 N/MS-8 E/Hwy 8 E and travel 2.4 miles, turn right onto US-51 S/Commerce St. and travel 3.3 miles, turn right onto Perry Rd. Property is located on right side of Perry Road, just before the Dogwood Apartment Complex Entrance.

[Click for Google Map Link](#)



Call The Land Man today!

TOM SMITH, ALC, BROKER®
Tom@TomSmithLand.com
601.898.2772 office | 601.454.9397 cell



TomSmithLand.com

Information is believed to be accurate but not guaranteed.