



244+/- Acre Unique Recreation Tract Kemper County, MS



\$349,900

If you're looking for something different in a Mississippi recreation/timber tract, this is it! With hugely diverse contours and incredible long range lanes, this 244+/- acre property in Kemper County, MS is extremely unique! Its beautiful views and higher elevations offer a one of a kind recreation experience and several ideal camp or home sites. Located in De Kalb, MS within 30 minutes of Meridian or Philadelphia. This tract has it all, with 144+/- acres of replanted cleared areas and mature hardwood bottoms and the remaining 100+/- acres is a 20+ year old pine plantation. Large land tracts surrounding the tract and creeks traversing the property give this tract everything it needs to be the ideal environment for trophy game. Half of the tract can be accessed by vehicle but be sure to arrange an ATV for taking it all in. Call Chris today to schedule a showing!

Directions from Meridian, MS: Take MS 19 N for 12.1 miles. Turn right onto Collinsville Martin Road and travel 3.4 miles. Continue 2.7 miles on Martin Kemper County Road. Continue on Zion Road for 3.2 miles. Turn right onto Chisolm Cemetery Road. The property gate and sign will be on the left.



Call me today!

CHRIS PRICE, REALTOR®
Chris@TomSmithLand.com
601.990.5070 office | 601.818.8576 cell



2011-2020
BEST
BROKERAGES

TomSmithLandandHomes.com

Information is believed to be accurate but not guaranteed.



CHRIS PRICE, REALTOR®
Chris@TomSmithLand.com
601.990.5070 office | 601.818.8576 cell

TomSmithLandandHomes.com

Information is believed to be accurate but not guaranteed.

Aerial Map



CHRIS PRICE, REALTOR®
Chris@TomSmithLand.com
601.990.5070 office | 601.818.8576 cell



TomSmithLandandHomes.com

Information is believed to be accurate but not guaranteed.

Flood Map

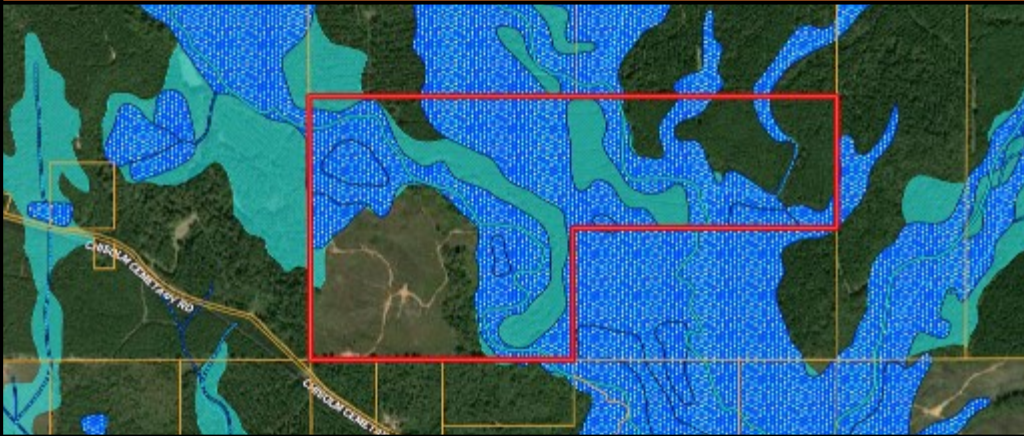

Ownership Map

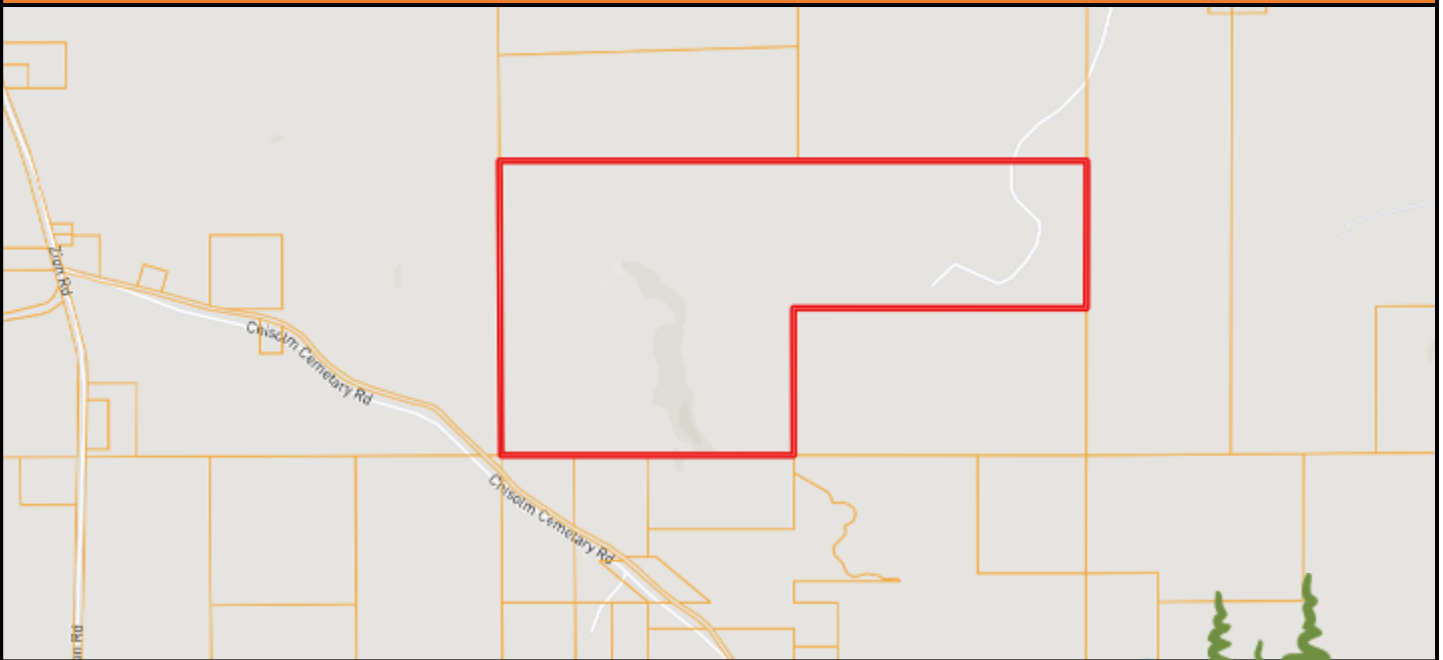

CHRIS PRICE, REALTOR®
Chris@TomSmithLand.com
601.990.5070 office | 601.818.8576 cell

TomSmithLandandHomes.com

Information is believed to be accurate but not guaranteed.

Topography Map



Soil Map

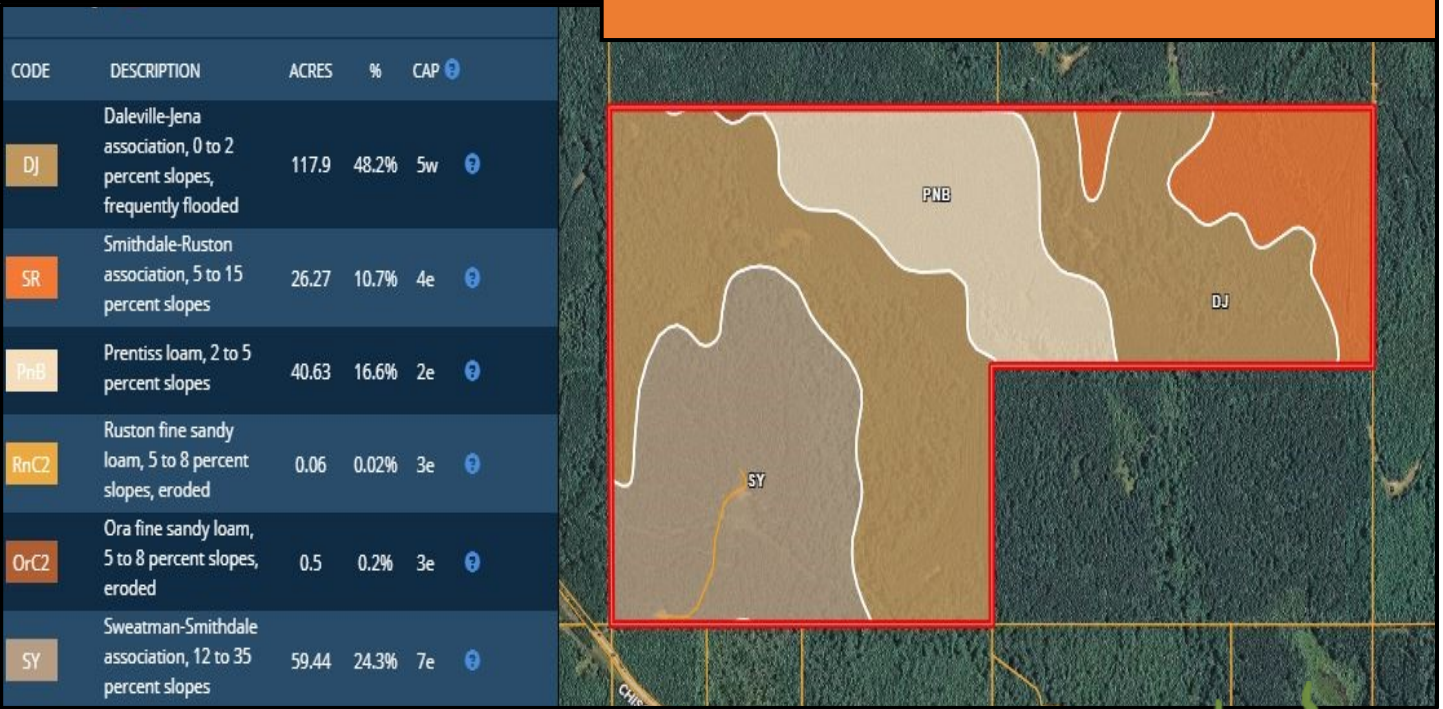

CHRIS PRICE, REALTOR®
Chris@TomSmithLand.com
601.990.5070 office | 601.818.8576 cell



TomSmithLandandHomes.com

Information is believed to be accurate but not guaranteed.

Directional Map

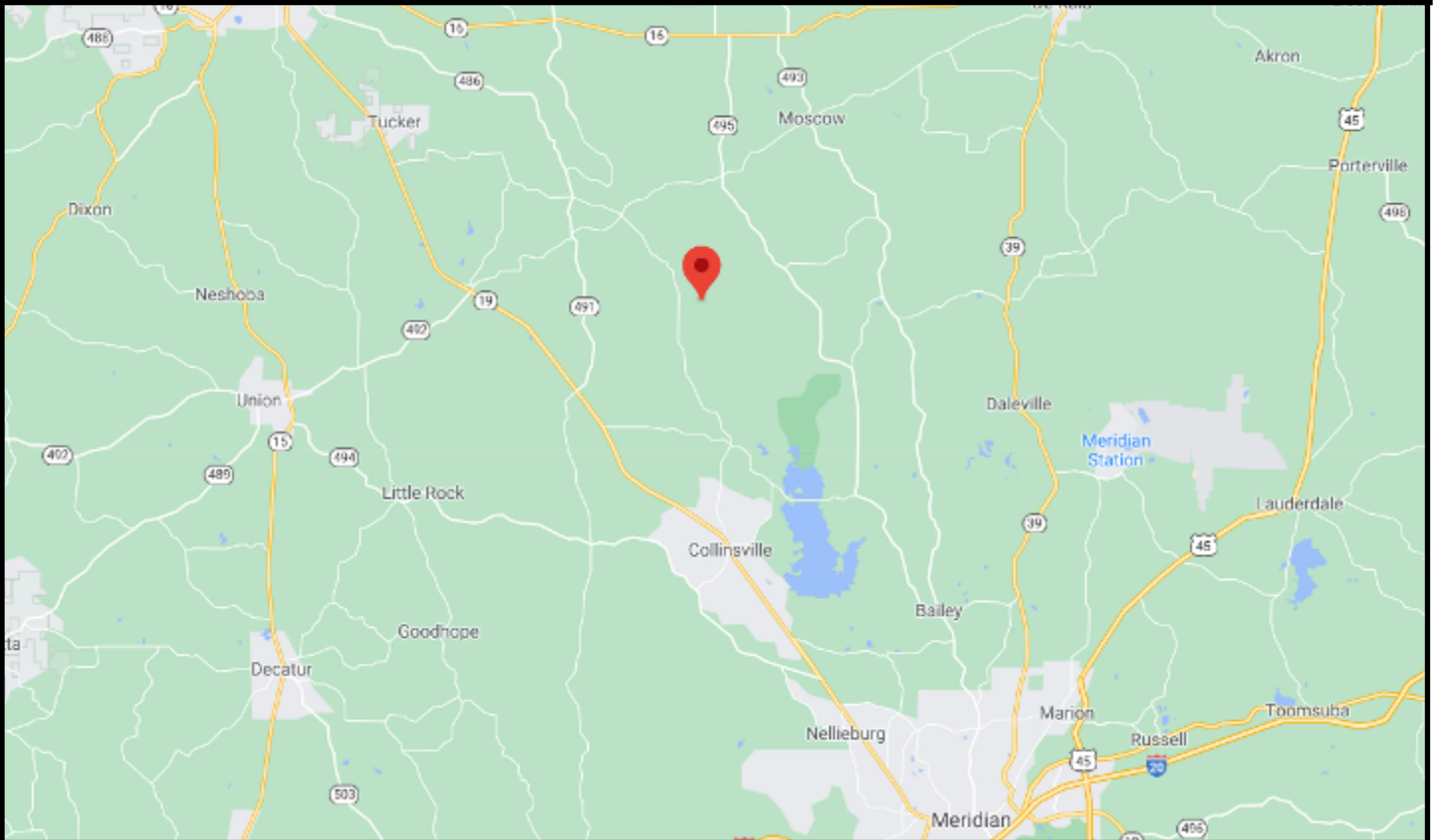

Directions from Meridian, MS: Take MS 19 N for 12.1 miles. Turn right onto Collinsville Martin Road and travel 3.4 miles. Continue 2.7 miles on Martin Kemper County Road. Continue on Zion Road for 3.2 miles. Turn right onto Chisolm Cemetery Road. The property gate and sign will be on the left.



Call me today!

CHRIS PRICE, REALTOR®
Chris@TomSmithLand.com
601.990.5070 office | 601.818.8576 cell



TomSmithLandandHomes.com

Information is believed to be accurate but not guaranteed.