

# Brick home Situated on 3 +/- Acres Lowndes County, MS



**\$172,000**

**1136 Old Yorkville Rd S,  
Columbus, MS 39702**

Looking for a move-in ready home with room to roam in Columbus, MS? Take a look at this three bedroom, two bath home situated on 3 +/- acres in Lowndes County. The property offers lots of privacy as it is located on a dead-end street facing the Lake Lowndes State Park. A large sun-room is off the kitchen and a double carport was converted into a spacious den/game room. There are two large utility rooms for all your storage needs! The property is being sold "as is". To schedule a private showing, call Walker or Kim!

Directions from Hwy 82 Columbus, MS: Take the exit onto Stokes Road toward New Hope. In ½ a mile turn right onto Lee Stokes Road. After that, in 1 mile turn left onto Beersheba Road. Then turn left onto Old Yorkville Road in 2.4 miles. Shortly after turn right onto Old Yorkville Rd S in .4 miles. The home will be on your right in 1.1 miles.



**KIM MARTINEZ, REALTOR®**  
Kim@TomSmithHomes.com  
662.268.6333 office | 662.435.4046 cell



*call us today!*



**WALKER TRANUM, REALTOR®**  
Walker@TomSmithHomes.com  
662.268.6333 office | 662.769.1442 cell

**TomSmithLandandHomes.com**

Information is believed to be accurate but not guaranteed.





**KIM MARTINEZ, REALTOR®**  
Kim@TomSmithHomes.com  
662.268.6333 office | 662.435.4046 cell



Expect More. Get More.  
*call us today!*



**WALKER TRANUM, REALTOR®**  
Walker@TomSmithHomes.com  
662.268.6333 office | 662.769.1442 cell

**TomSmithLandandHomes.com**

Information is believed to be accurate but not guaranteed.





**KIM MARTINEZ, REALTOR®**  
Kim@TomSmithHomes.com  
662.268.6333 office | 662.435.4046 cell



*call us today!*



**WALKER TRANUM, REALTOR®**  
Walker@TomSmithHomes.com  
662.268.6333 office | 662.769.1442 cell

**TomSmithLandandHomes.com**

Information is believed to be accurate but not guaranteed.





**KIM MARTINEZ, REALTOR®**  
Kim@TomSmithHomes.com  
662.268.6333 office | 662.435.4046 cell



Expect More. Get More.

*call us today!*



**WALKER TRANUM, REALTOR®**  
Walker@TomSmithHomes.com  
662.268.6333 office | 662.769.1442 cell

**TomSmithLandandHomes.com**

Information is believed to be accurate but not guaranteed.





**KIM MARTINEZ, REALTOR®**  
Kim@TomSmithHomes.com  
662.268.6333 office | 662.435.4046 cell



*call us today!*



**WALKER TRANUM, REALTOR®**  
Walker@TomSmithHomes.com  
662.268.6333 office | 662.769.1442 cell

**TomSmithLandandHomes.com**

Information is believed to be accurate but not guaranteed.



# Aerial Map



**KIM MARTINEZ**, REALTOR®  
Kim@TomSmithHomes.com  
662.268.6333 office | 662.435.4046 cell



*call us today!*



**WALKER TRANUM**, REALTOR®  
Walker@TomSmithHomes.com  
662.268.6333 office | 662.769.1442 cell

**TomSmithLandandHomes.com**

Information is believed to be accurate but not guaranteed.



# Ownership Map

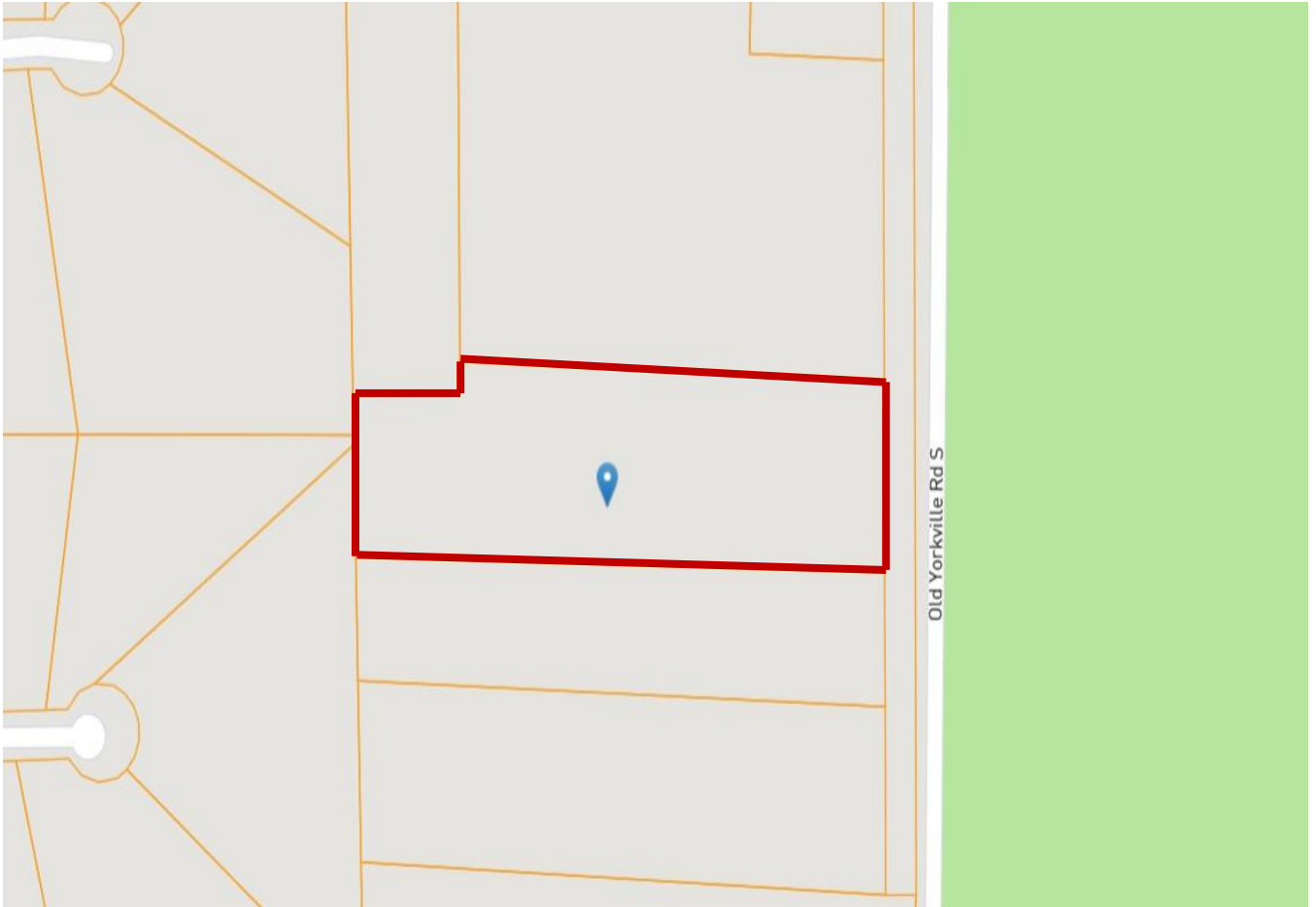

**KIM MARTINEZ, REALTOR®**  
Kim@TomSmithHomes.com  
662.268.6333 office | 662.435.4046 cell



*call us today!*



**WALKER TRANUM, REALTOR®**  
Walker@TomSmithHomes.com  
662.268.6333 office | 662.769.1442 cell

**TomSmithLandandHomes.com**

Information is believed to be accurate but not guaranteed.



# Directional Map

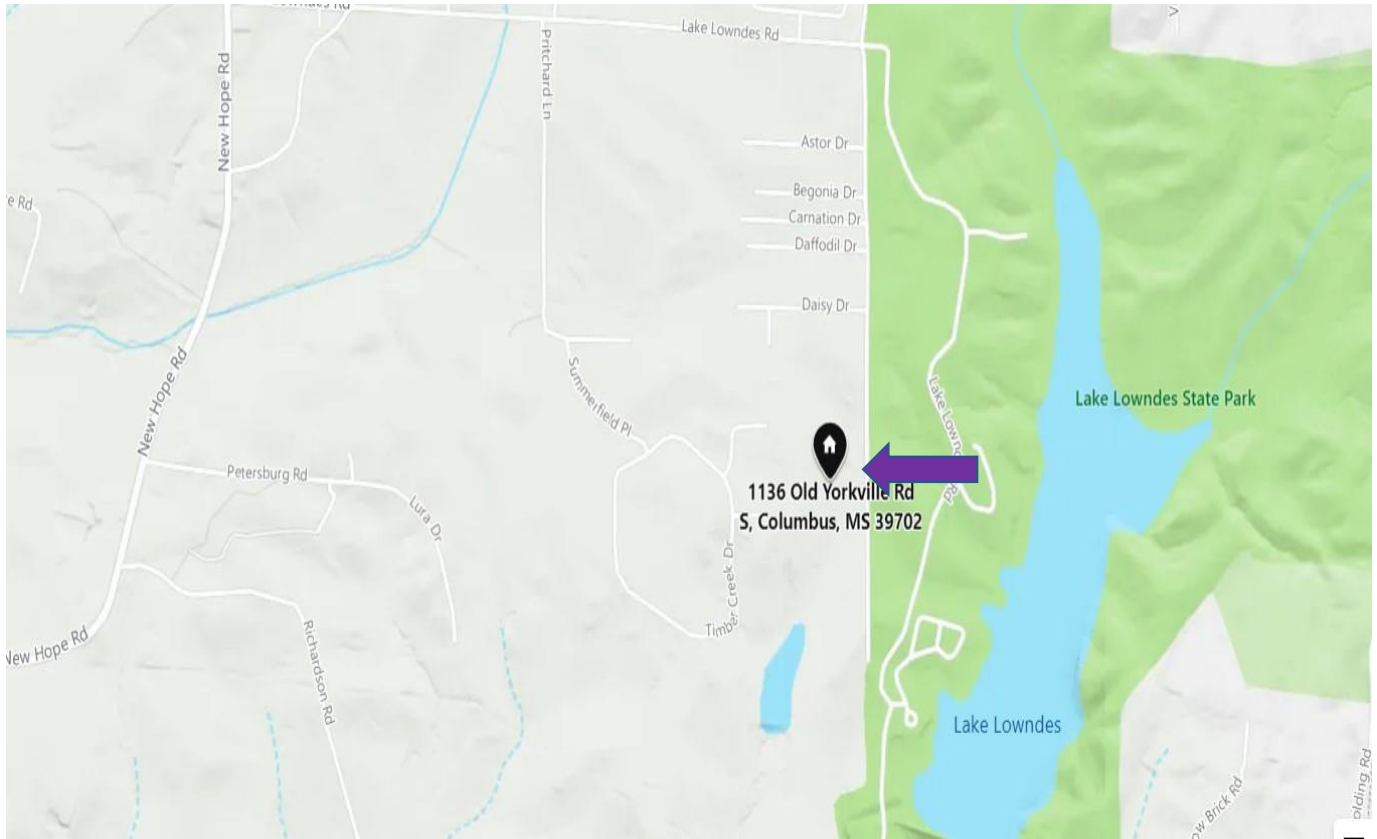

Directions from Hwy 82 Columbus, MS: Take the exit onto Stokes Road toward New Hope. In ½ a mile turn right onto Lee Stokes Road. After that, in 1 mile turn left onto Beersheba Road. Then turn left onto Old Yorkville Road in 2.4 miles. Shortly after turn right onto Old Yorkville Rd S in .4 miles. The home will be on your right in 1.1 miles.



**KIM MARTINEZ**, REALTOR®  
Kim@TomSmithHomes.com  
662.268.6333 office | 662.435.4046 cell



*call us today!*



**WALKER TRANUM**, REALTOR®  
Walker@TomSmithHomes.com  
662.268.6333 office | 662.769.1442 cell

**TomSmithLandandHomes.com**

Information is believed to be accurate but not guaranteed.

