

LOT 89 IN WAKELAND HILLS SUBDIVISION HINDS COUNTY, MS



\$12,000

This beautiful, Hinds County, MS lot is in the well-established Wakeland Hill Subdivision in Raymond. The .60+/- acre corner lot between 2 cul-de-sacs is located at the back of this quiet neighborhood. All utilities are available so start building immediately! For more information, call Jeff today!

Directions from Jackson, MS: Travel I-20W and take exit 40A on to MS-18W. In 5 miles, turn left on Springridge Road. In 3.7 miles, turn left on Big Creek Road. Travel .4 miles and turn left in to Wakeland Hills Subdivision on Huntly Drive, then turn left on Wakeland Drive. Make another left on Devonport Circle. Lot #89 will be on the left at the corner of Devonport Circle and Haverhill Cove.

Address: 0 Devonport Circle Raymond, MS 37154



call me today!

JEFF CUNDALL, REALTOR®

Jeff@TomSmithLand.com

601.898.2772 office | 601.331.7776 cell



Expect More. Get More.

TomSmithLandandHomes.com

Information is believed to be accurate but not guaranteed.



JEFF CUNDALL, REALTOR®
Jeff@TomSmithLand.com
601.898.2772 office | 601.331.7776 cell



TomSmithLandandHomes.com

Information is believed to be accurate but not guaranteed.

AERIAL MAP



Lot 89 in Wakeland Hills Subdivision



JEFF CUNDALL, REALTOR®
Jeff@TomSmithLand.com
601.898.2772 office | 601.331.7776 cell



TomSmithLandandHomes.com

Information is believed to be accurate but not guaranteed.

PROPERTY MAP

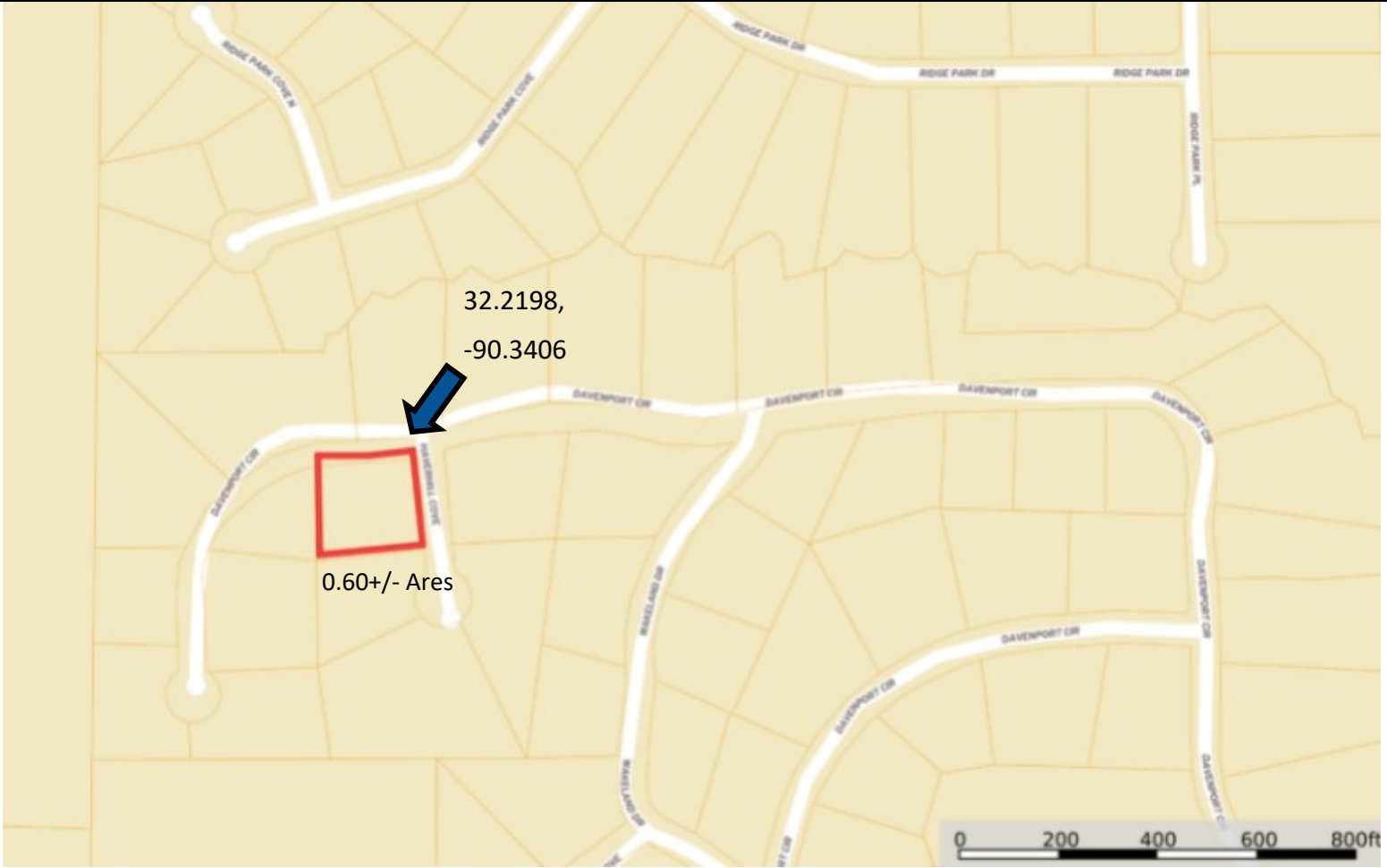

Lot 89 in Wakeland Hills Subdivision



JEFF CUNDALL, REALTOR®
Jeff@TomSmithLand.com
601.898.2772 office | 601.331.7776 cell



TomSmithLandandHomes.com

Information is believed to be accurate but not guaranteed.

DIRECTIONAL MAP

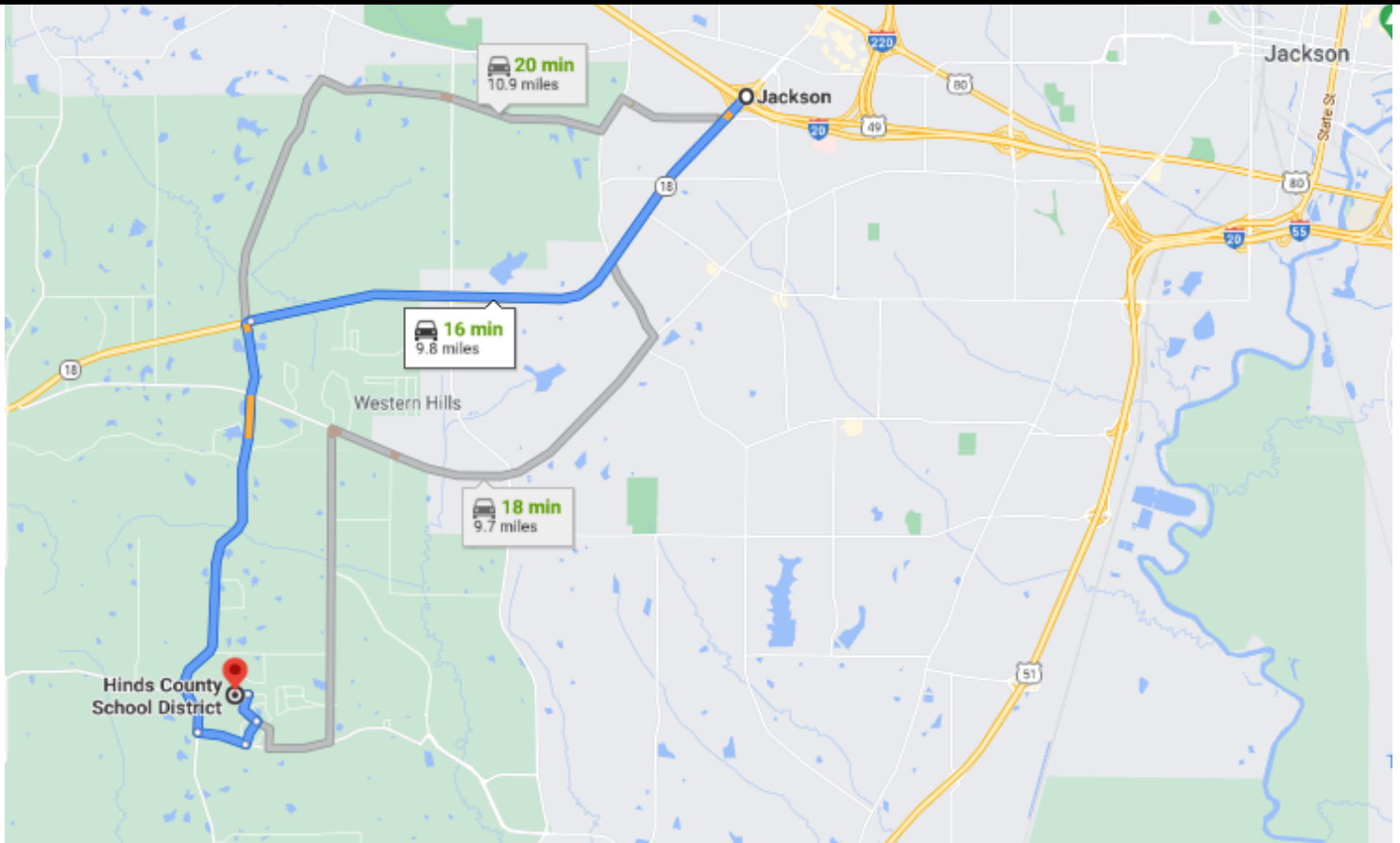

Directions from Jackson, MS: Travel I-20W and take exit 40A on to MS-18W. In 5 miles, turn left on Springridge Road. In 3.7 miles, turn left on Big Creek Road. Travel .4 miles and turn left in to Wakeland Hills Subdivision on Huntly Drive, then turn left on Wakeland Drive. Make another left on Devonport Circle. Lot #89 will be on the left at the corner of Devonport Circle and Haverhill Cove.

Address: 0 Devonport Circle Raymond, MS 37154



JEFF CUNDALL, REALTOR®

Jeff@TomSmithLand.com

601.898.2772 office | 601.331.7776 cell



Expect More. Get More.

TomSmithLandandHomes.com

Information is believed to be accurate but not guaranteed.