

Home on 14+/- Acres in Franklin County, MS



305 Bunkley Road
Meadville, MS 39653

\$325,000

Make an appointment soon to visit this must-see, 14 +/- acre, Franklin County, MS property! Located in the Bunkley community just west of Meadville, is a three bedroom, two and a half bath, 2600 +/- square foot home. Built in 2003, this home has been maintained at such a high level that it still looks brand new! The kitchen features gas cooktop, double ovens, granite counter tops, tile floors, and an island for easy meal preparation. Sitting just off the kitchen is the spacious master bedroom boasting tray ceilings and a huge master bathroom complete with a large soaker tub, shower, and walk-in closet you could get lost in. The gentleman of the home will enjoy the "Man Cave" decked out in pecky cypress. Off the large living room are two bedrooms providing ample space for the messiest teen. A two-car garage completes the wonderful home. This beautiful property is located 7 miles from Lake Okhissa and less than 2 miles from the Homochitto National Forest. Also just 100 yards away is the first hole of the Middle Fork Country Club golf course. Call Clif Cannon to schedule a showing today!



call me today!

CLIF CANNON, REALTOR®
Clif@TomSmithLand.com
601.990.5070 office | 601.565.1070 cell



TomSmithLandandHomes.com

Information is believed to be accurate but not guaranteed.



CLIF CANNON, REALTOR®
 Clif@TomSmithLand.com
 601.990.5070 office | 601.565.1070 cell

Tom Smith
LAND AND HOMES
 Expect More. Get More.

TomSmithLandandHomes.com

Information is believed to be accurate but not guaranteed.



CLIF CANNON, REALTOR®
 Clif@TomSmithLand.com
 601.990.5070 office | 601.565.1070 cell



TomSmithLandandHomes.com

Information is believed to be accurate but not guaranteed.



CLIF CANNON, REALTOR®
 Clif@TomSmithLand.com
 601.990.5070 office | 601.565.1070 cell



TomSmithLandandHomes.com

Information is believed to be accurate but not guaranteed.



Aerial Map



Homochitto National Forest Map



CLIF CANNON, REALTOR®
 Clif@TomSmithLand.com
 601.990.5070 office | 601.565.1070 cell



TomSmithLandandHomes.com

Information is believed to be accurate but not guaranteed.

Flood Map



Topographic Map



CLIF CANNON, REALTOR®
Clif@TomSmithLand.com
601.990.5070 office | 601.565.1070 cell



TomSmithLandandHomes.com

Information is believed to be accurate but not guaranteed.

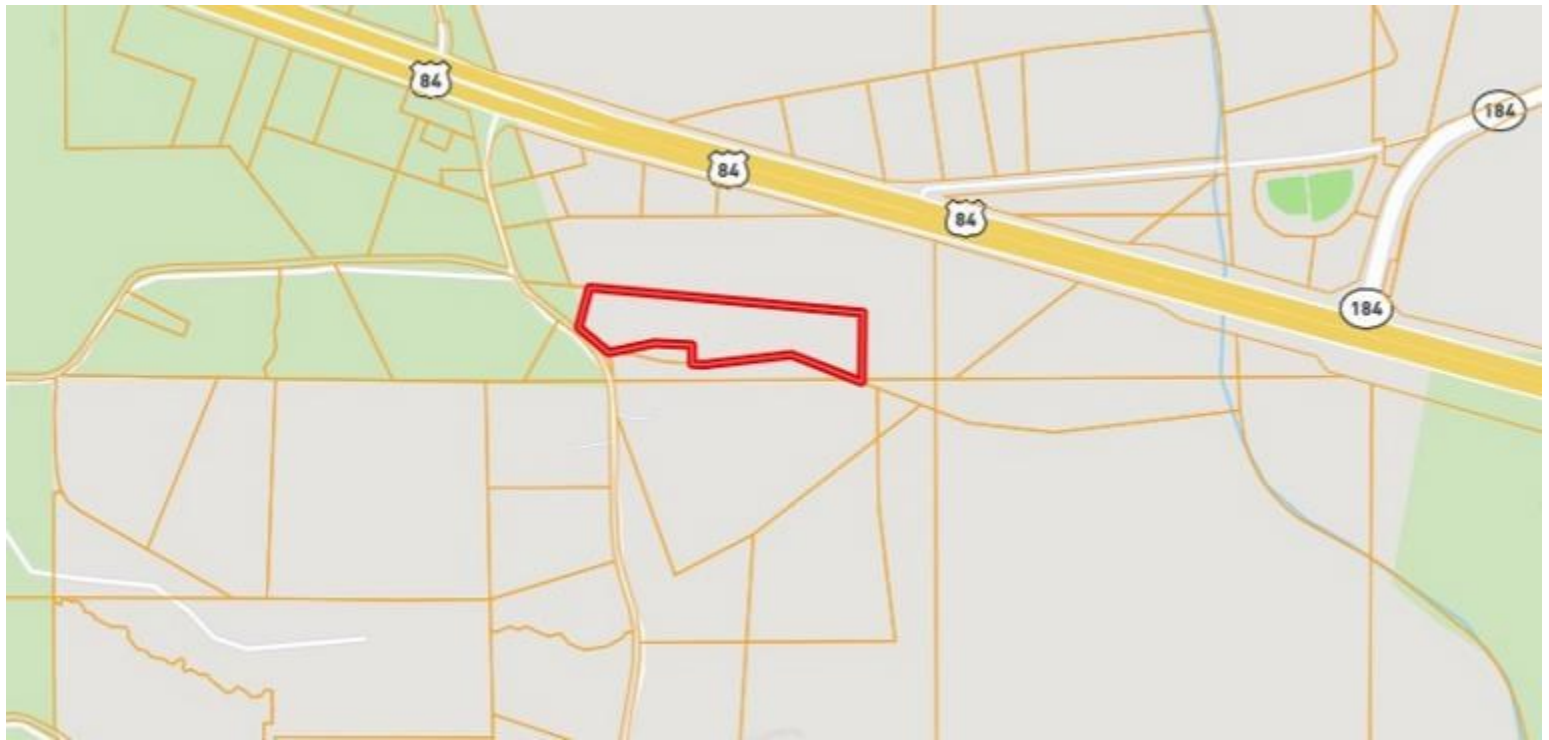

Ownership Map



CLIF CANNON, REALTOR®
Clif@TomSmithLand.com
601.990.5070 **office** | 601.565.1070 **cell**



TomSmithLandandHomes.com

Information is believed to be accurate but not guaranteed.



Directional Map

**305 Bunkley Road
Meadville, MS 39653**

Directions from Sullivan's Grocery in Bude, MS: Travel north on US.98/184 for .8 miles. Turn left onto US-84/US-98 and travel for 3.3 miles. Turn left onto Bunkley Road and travel for .3 miles. The property will be on the left.



CLIF CANNON, REALTOR®
Clif@TomSmithLand.com
601.990.5070 **office** | 601.565.1070 **cell**



TomSmithLandandHomes.com

Information is believed to be accurate but not guaranteed.