

40+/- Acres in Franklin County, MS



\$140,000

If you are looking for an excellent recreational and investment tract in Franklin County, MS, look no further than this 40+/-acre property! Situated in some of the best whitetail deer habitat around, this pine plantation makes for an outstanding opportunity! The 15+/-year old southern yellow pine is ready for its first thinning, meaning immediate income while improving your timber stand and increasing wildlife holding potential for years to come. The pond, tucked away, on the east side of the parcel is just waiting for you and your family. The property boasts over 600 feet of road frontage on Laird / Tabernacle Road and an internal road that bisects the property, north to south. Electricity is available and there are plenty of great home sites to choose from. Take advantage of this great opportunity, call Clif Cannon to schedule a showing today!



call me today!

CLIF CANNON, REALTOR®
Clif@TomSmithLand.com
601.990.5070 office | 601.565.1070 cell



TomSmithLandandHomes.com

Information is believed to be accurate but not guaranteed.



CLIF CANNON, REALTOR®

Clif@TomSmithLand.com

601.990.5070 office | 601.565.1070 cell



Expect More. Get More.

TomSmithLandandHomes.com

Information is believed to be accurate but not guaranteed.

Aerial Map

40+/- Acres

31.4735, -90.6797

LAIRD RD

LAIRD RD

CLIF CANNON, REALTOR®

Clif@TomSmithLand.com

601.990.5070 office | 601.565.1070 cell



Expect More. Get More.



TomSmithLandandHomes.com

Information is believed to be accurate but not guaranteed.

Topographic Map

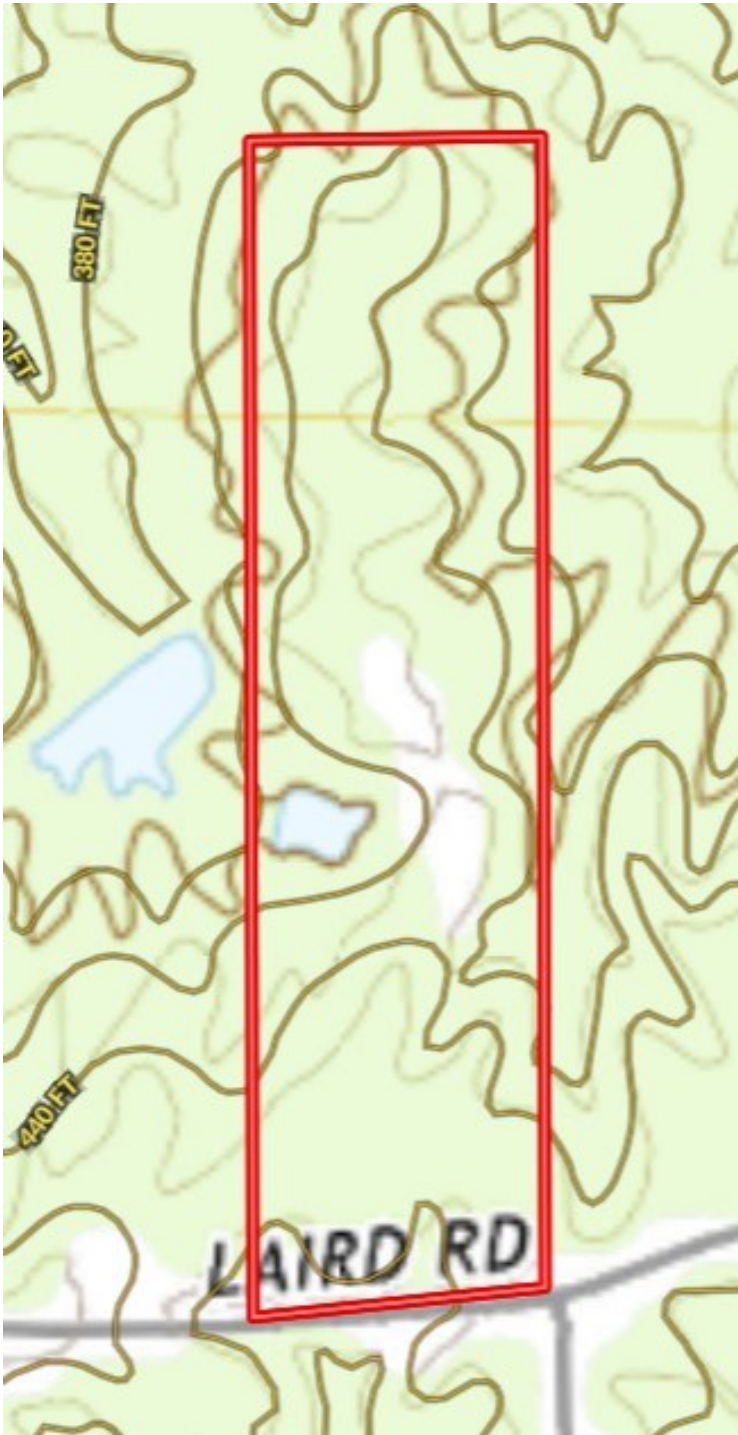

Flood Map



CLIF CANNON, REALTOR®

Clif@TomSmithLand.com

601.990.5070 office | 601.565.1070 cell



Expect More. Get More.

TomSmithLandandHomes.com

Information is believed to be accurate but not guaranteed.



Ownership Map



CLIF CANNON, REALTOR®
Clif@TomSmithLand.com
601.990.5070 office | 601.565.1070 cell



TomSmithLandandHomes.com

Information is believed to be accurate but not guaranteed.



Directional Map

Directions from the intersection of US-98 and Interstate 55 in Summit, MS: Travel west on U.S. 98 west for 10.8 miles. Turn right onto Burt Jordan Rd and travel for 9 miles. Turn right onto Laird/Tabernacle Rd and travel for .5 miles. The property will be on the left.



CLIF CANNON, REALTOR®
Clif@TomSmithLand.com
601.990.5070 office | 601.565.1070 cell



TomSmithLandandHomes.com

Information is believed to be accurate but not guaranteed.